



THALHIMER

RETAIL FOR LEASE

Starbucks Anchored – Harbour View Shoppes

5883-5889 Harbour View Boulevard, Suffolk, VA



For more information, contact:

ERIC STANLEY

Vice President
757 499 2739
eric.stanley@thalhimer.com

ED KIMPLE

Senior Vice President
757 213 4155
ed.kimple@thalhimer.com

DAVID MACHUPA

Senior Vice President
757 213 4156
david.machupa@thalhimer.com

The Town Center of Virginia Beach
222 Central Park Ave., Suite 1500
Virginia Beach, VA 23462
www.thalhimer.com

Independently Owned and Operated / A Member of the Cushman & Wakefield Alliance

Cushman & Wakefield | Thalhimer © 2015. No warranty or representation, express or implied, is made to the accuracy or completeness of the information contained herein, and same is submitted subject to errors, omissions, change of price, rental or other conditions, withdrawal without notice, and to any special listing conditions imposed by the property owner(s). As applicable, we make no representation as to the condition of the property (or properties) in question.

Property Features

- Join Starbucks, Verizon and Subway in Harbour View
- Spaces available:
 - 4,027 SF former mattress store space
- About the Harbour View Submarket:
 - The quickly growing Harbour View submarket in Northern Suffolk boasts extremely favorable demographics and is recognized as having one of the strongest and most highly skilled workforces in the U.S.
 - Home to a number of retailers including Kroger Marketplace, Dick's Sporting Goods, Harris Teeter, Regal Cinemas and Wal-Mart Supercenter.
 - The area contains approximately 1.3 million square feet of office product with the majority being high quality and built within the last ten years. Currently home to the U.S. Atlantic Command Joint Training, Analysis and Simulation Center (JTASC), the Virginia Modeling and Simulation Center (VMASC), Lockheed Martin's Global Center for Innovation and a growing high technology related section of corporate interests in the Region.
 - Recent expansion of both the Sentara Belle Harbour campus and the Bon Secours Harbour View campus.
 - Numerous residential projects recently completed or currently under construction in the Harbour View submarket.



Demographics		
	3 Miles	5 Miles
Population	51,825	86,743
Daytime Population	40,139	69,248
Avg. HH Income	\$87,217	\$90,171

Nearby Retailers

For more information, contact:

ERIC STANLEY
 Vice President
 757 499 2739
eric.stanley@thalhimer.com

ED KIMPLE
 Senior Vice President
 757 213 4155
ed.kimple@thalhimer.com

DAVID MACHUPA
 Senior Vice President
 757 213 4156
david.machupa@thalhimer.com

The Town Center of Virginia Beach
 222 Central Park Ave., Suite 1500
 Virginia Beach, VA 23462
www.thalhimer.com

Former Sleepy's
4,027 SF

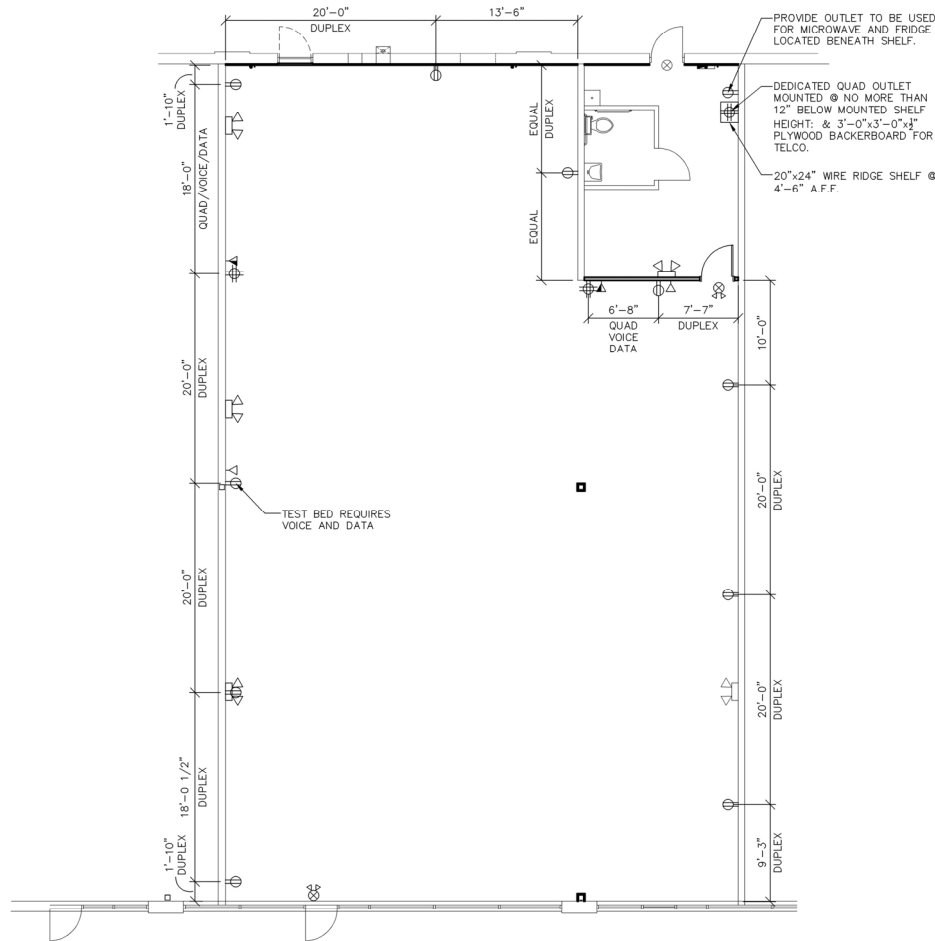

For more information, contact:

ERIC STANLEY
Vice President
757 499 2739
eric.stanley@thalhimer.com

ED KIMPLE
Senior Vice President
757 213 4155
ed.kimple@thalhimer.com

DAVID MACHUPA
Senior Vice President
757 213 4156
david.machupa@thalhimer.com

The Town Center of Virginia Beach
222 Central Park Ave., Suite 1500
Virginia Beach, VA 23462
www.thalhimer.com

