

FOR LEASE

Cityville on 9th

520 & 580 SW 9TH STREET, DES MOINES, IOWA

RETAIL



PROPERTY INFO

- + Available Space:
 - Building 520: 889 SF up to 3,881 SF
 - Building 580: 1,110 SF up to 5,757 SF
- + Lease Rates:
 - \$9.75/SF NNN inline, \$10.75/SF NNN endcap
 - \$21.50/SF NNN - Suite 116: Turn-key, endcap restaurant space
 - 2020 Operating Expenses (property taxes, insurance and CAM):
 - Building 520: \$7.71/SF
 - Building 580: \$3.69/SF
 - TI Allowance: \$25.00/SF over gray shell
- + Property Features:
 - Drive-thru bay available on north endcap of Building 4
 - Ample at the door parking
 - Located on highly visible signalized intersection
 - Storefront & monument signage available facing SW 9th Street
 - Traffic Counts: +/- 28,000 VPD on SW 9th
 - Grease Trap
 - Cityville is a 429 bedroom community - cityvilledm.com at the heart of rapidly growing Downtown Des Moines Riverpoint West neighborhood
 - On MTA bus route
 - Professionally managed by Hubbell Realty Company



CBRE | Hubbell
Commercial

Part of the CBRE affiliate network

FOR LEASE

Cityville on 9th

520 & 580 SW 9TH STREET, DES MOINES, IOWA

RETAIL



FLOOR PLANS

BUILDING 520

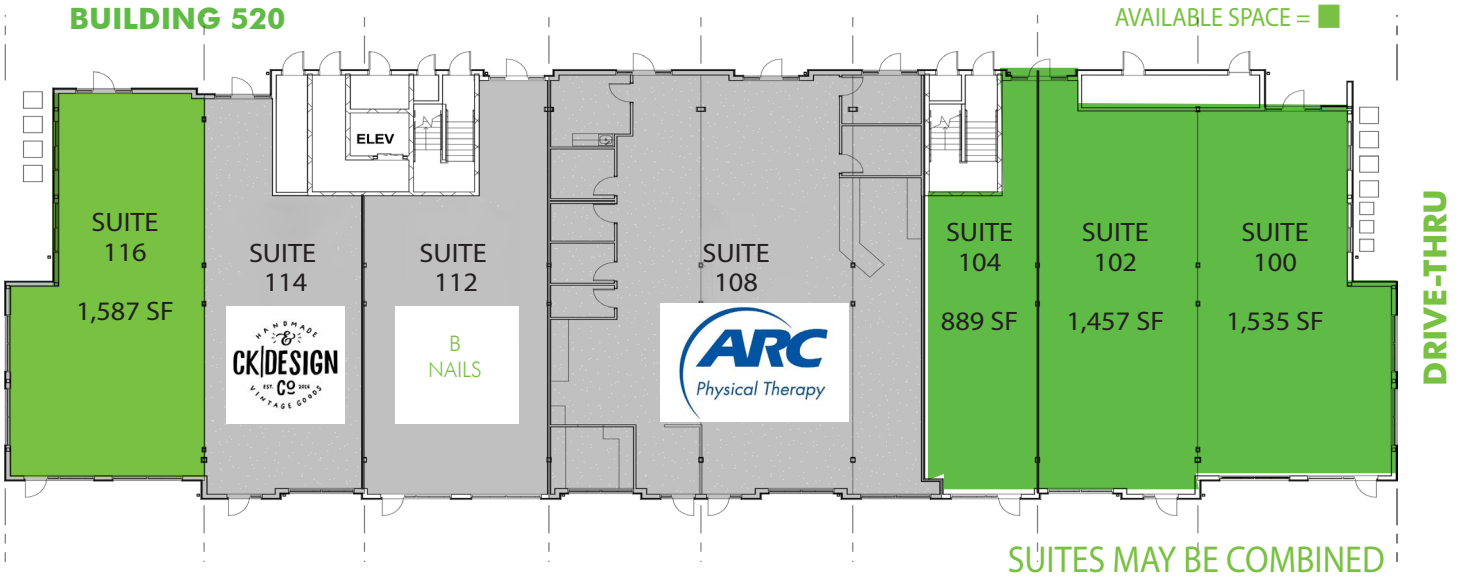

BUILDING 580

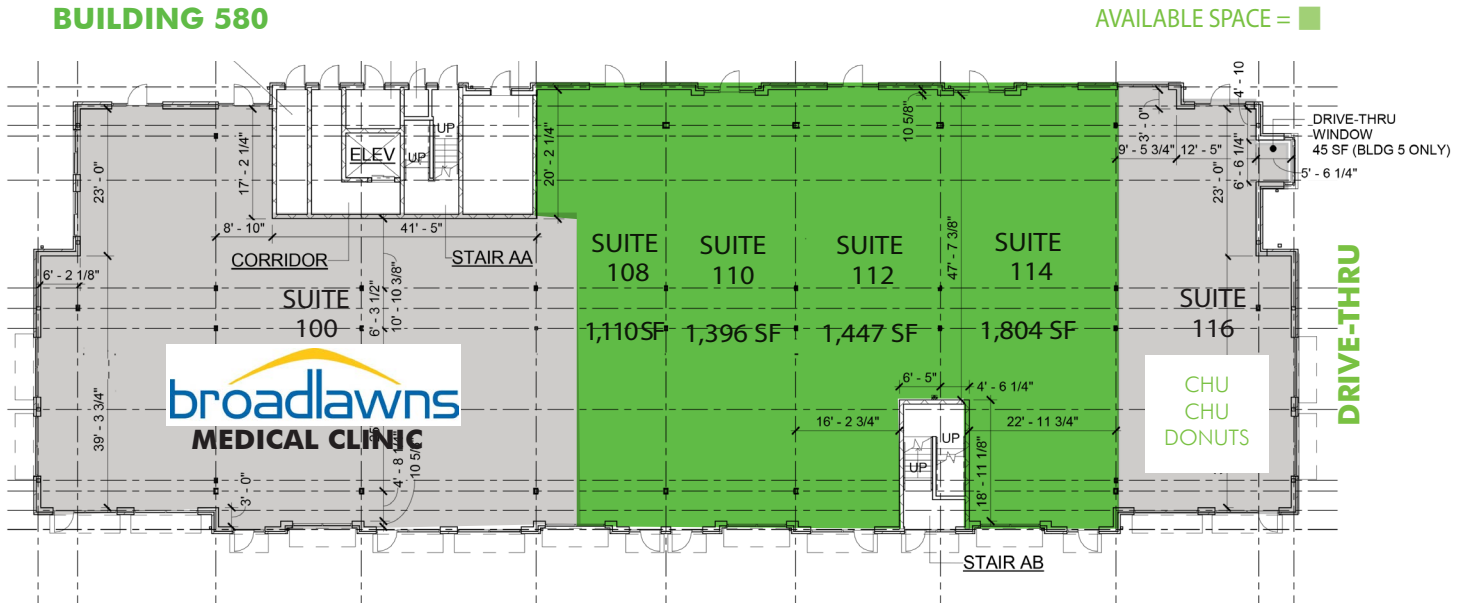

FOR LEASE

Cityville on 9th

520 & 580 SW 9TH STREET, DES MOINES, IOWA

RETAIL



SITE PLAN

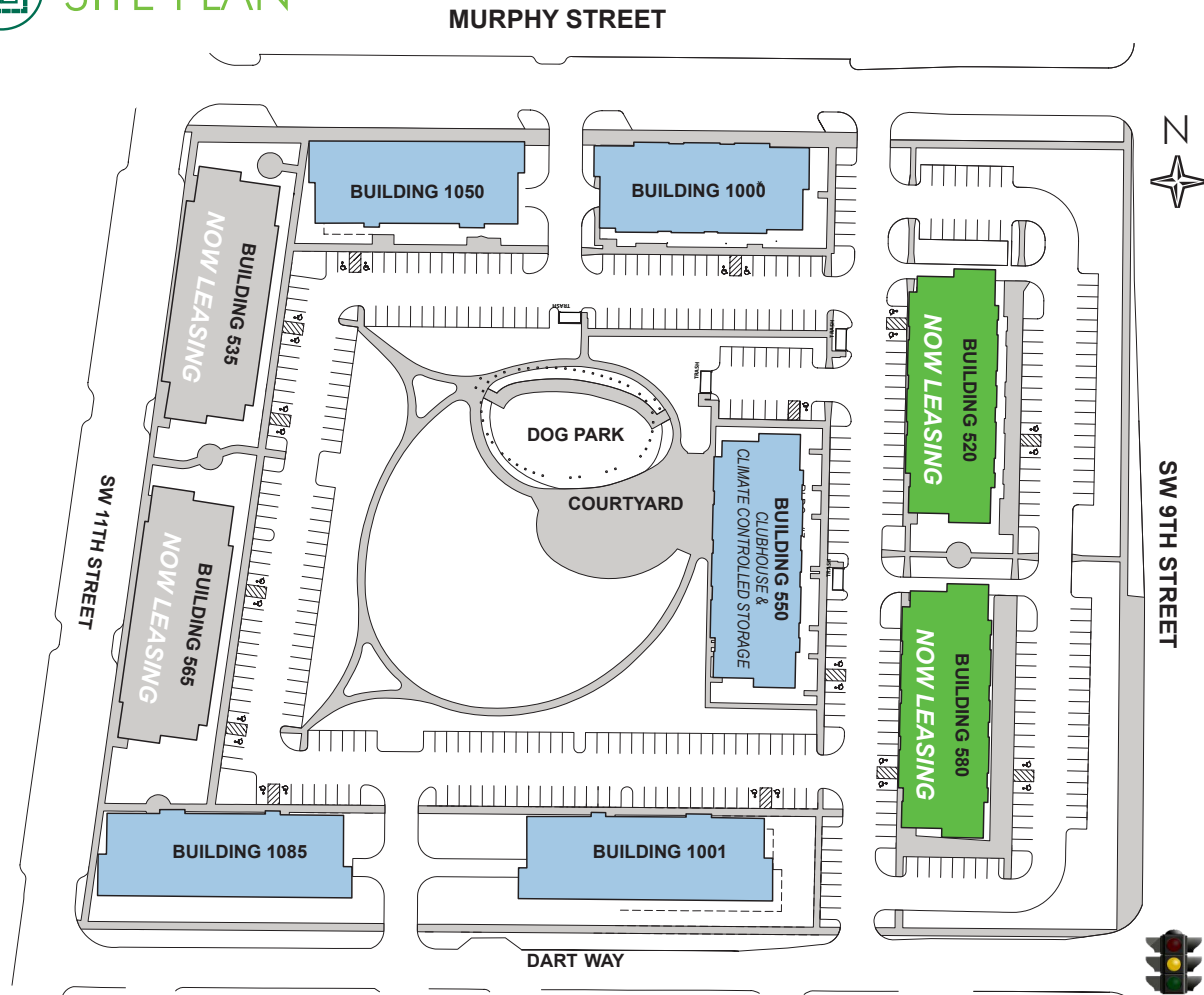

*Covered parking available



2019 Demographics

	1/2-Mile	1-Mile	2-Mile
Population	1,590	9,544	42,373
Daytime Population	2,709	61,604	124,827
Median Household Income	\$37,214	\$42,675	\$44,039
Average Household Income	\$59,926	\$61,105	\$61,533
Median Age	36.4	36.8	34.3

1-Mile Key Facts

61,604

Daytime Population



1,546

Total Businesses



Part of the CBRE affiliate network

FOR LEASE

Cityville on 9th

520 & 580 SW 9TH STREET, DES MOINES, IOWA

RETAIL



NEW AREA MULTI-FAMILY



CONTACT US

Jeff Spence, CCIM

Vice President
+1 515 221 6636
jeff.spence@cbre-hubbell.com

Colleen Johnson

Vice President
+1 515 280 2052
colleen.johnson@cbre-hubbell.com



Part of the CBRE affiliate network
6900 Westtown Parkway
West Des Moines, Iowa 50266
www.cbre.com/desmoines

LISTING# 1467010

© 2020 Hubbell Commercial Brokers, L.C., d/b/a CBRE/Hubbell Commercial. This information has been obtained from sources believed reliable. We have not verified it and make no guarantee, warranty or representation about it. Any projections, opinions, assumptions or estimates used are for example only and do not represent the current or future performance of the property. You and your advisors should conduct a careful, independent investigation of the property to determine to your satisfaction the suitability of the property for your needs. Photos herein are the property of their respective owners and use of these images without the express written consent of the owner is prohibited. CBRE and the CBRE logo are service marks of CBRE, Inc. and/or its affiliated or related companies in the United States and other countries. All other marks displayed on this document are the property of their respective owners.