

An aerial photograph of Boston, Massachusetts, showing a mix of historic brick buildings and modern skyscrapers. The harbor is visible on the left with many boats. A white text box is overlaid in the center of the image.

266  
COMMERCIAL  
STREET

Boston, MA

# The Property

## Four Winds Bar and Grill at 266 Commercial Street

This establishment has been owned and operated by the same family for over five decades. Beyond the property's current use as a restaurant, bar and function facility, this two-story free standing structure has residential development potential. Zoned multifamily residential/local services (MFR/LS), the zoning district allows for a building height up to 55'.



## Development Potential

- ✓ For sale condominiums
- ✓ Multifamily rental
- ✓ Executive suites



## The Neighborhood

### The North End

Considered Boston's oldest residential community, with winding streets and a network of alleyways, the North End provides endless opportunities to relive significant moments in American History. A popular destination for Bostonians and tourists, the neighborhood is home to a vibrant Italian American population with outstanding restaurants, bakeries and shops.



*Photo by Dmitry Fisenko on Unsplash*

# Building Highlights

- Located in North End's Waterfront
- Lot size - 1568± square feet
- 2982± SF total - plus approximately 625± SF partial-height, unfinished lower level (not inc. in sf)
- 22± feet of frontage
- Free standing two-story structure
- Second floor waterviews
- Zoned Multifamily Residential/Local services
- Zoning District allows for 55' building height
- Residential Development Potential
  - For Sale Condominiums
  - Apartment Rentals
  - Executive Suites
- Potential for 3rd and 4th floors
- Steps to the Harborwalk
- Furniture, fixtures and 2am liquor license available for an additional cost

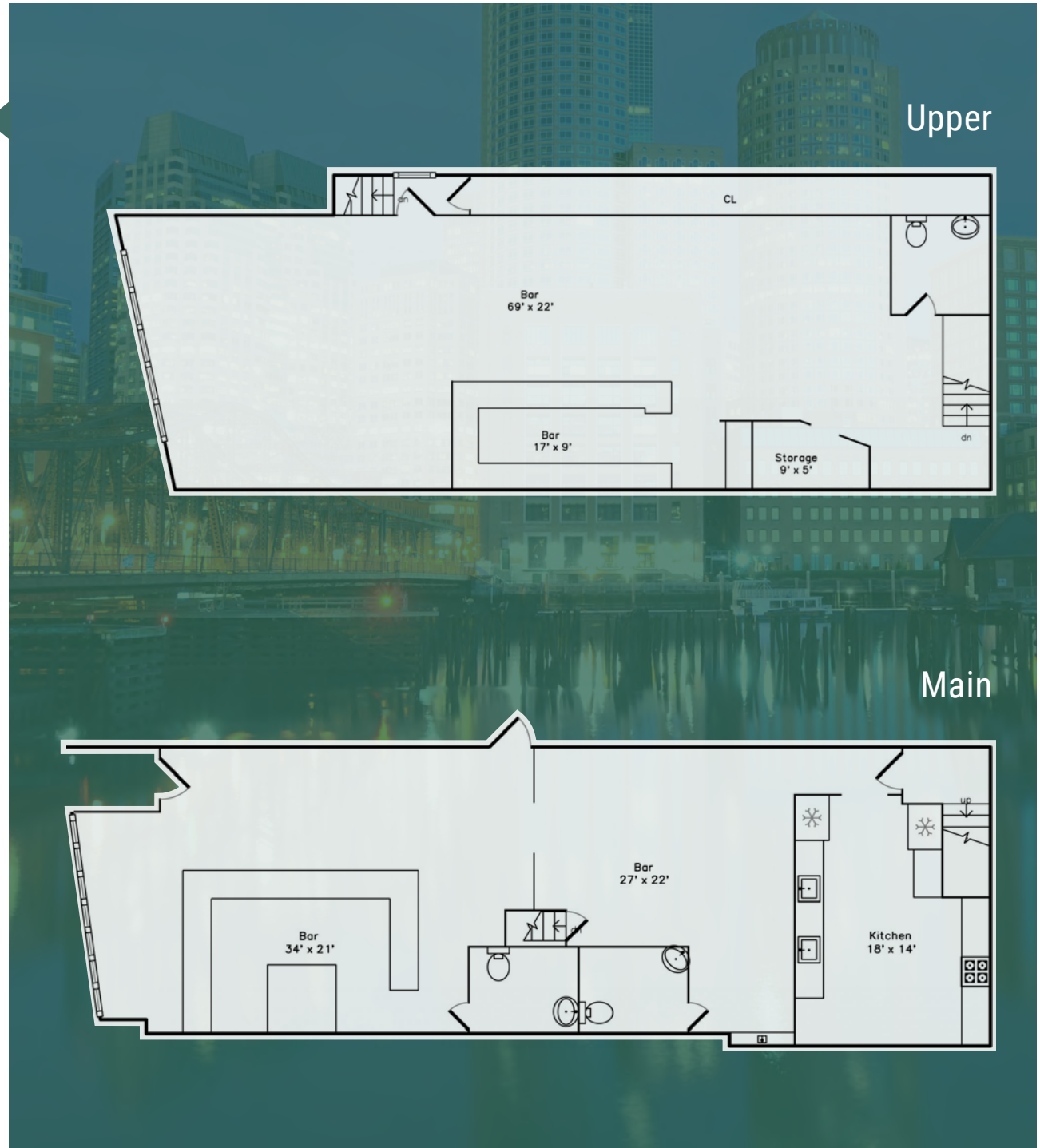

## The Asset

266 Commercial Street is a meticulously maintained, 2-story free-standing structure. A former bar and restaurant, The Four Winds Bar and Grill, was a favored neighborhood location.

## The Opportunity





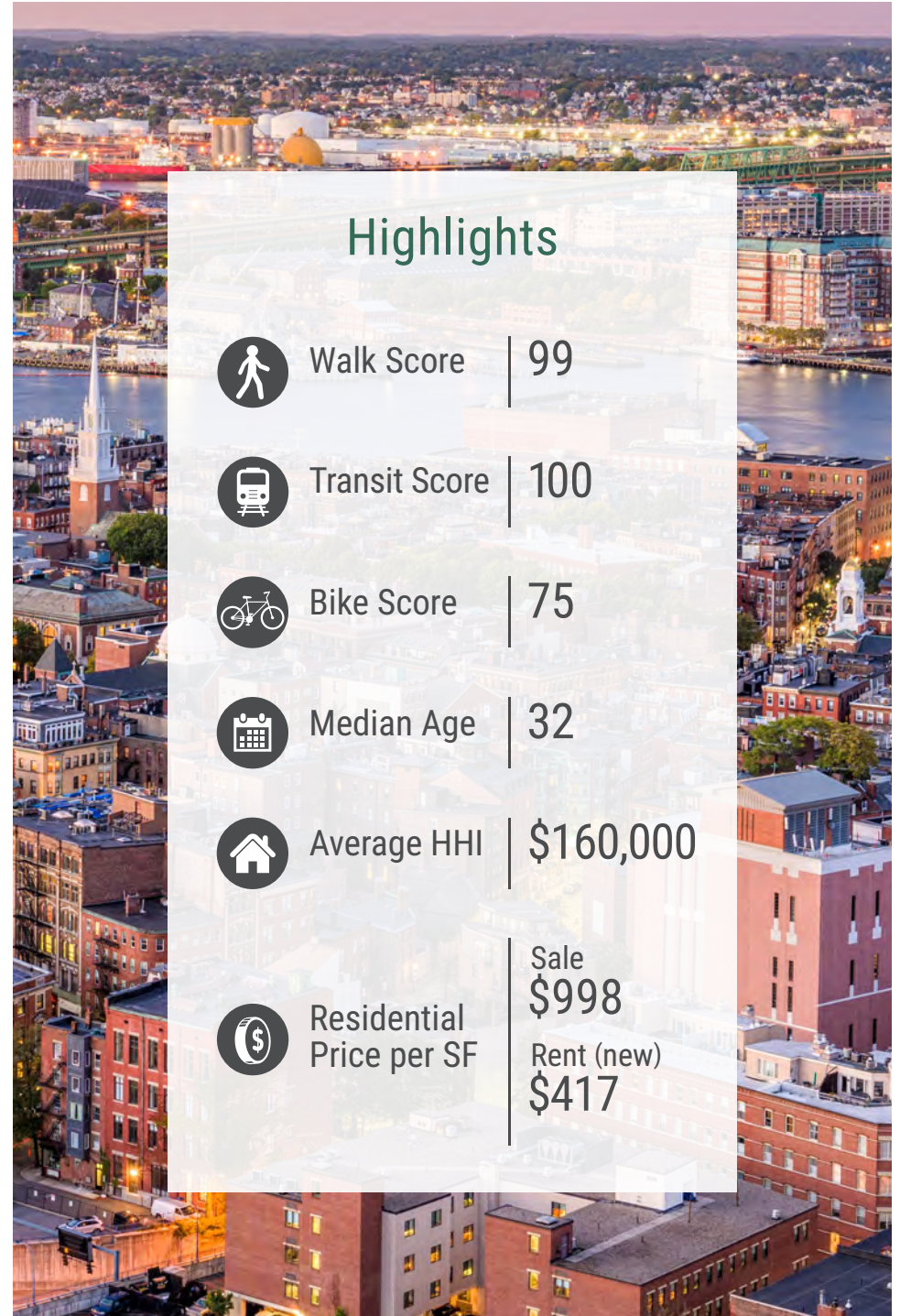

Zoned MFR/LR - Multifamily Residential/Local Services, the property has the potential to be converted to for sale condominiums, multifamily rental or extended stay suites. With a maximum height of 55', the building could possibly add a 3rd and 4th floor capturing significant waterviews. There's a broad range of opportunities as the property may continue as a food service and bar establishment, be converted to residential housing or a combination of both.

## The Area

The North End Waterfront is an active area for residents, tourists and professionals. With quaint streets, historic monuments and renowned restaurants and shops, the North End is a destination neighborhood. 266 Commercial Street is easily accessible to major highways, public transit and within walking distance to major employers in the Financial District and Downtown.



### Highlights

	Walk Score		99
	Transit Score		100
	Bike Score		75
	Median Age		32
	Average HHI		\$160,000
	Residential Price per SF		Sale \$998 Rent (new) \$417

# Location Map

Located at 266 Commercial Street at Sargent's Wharf

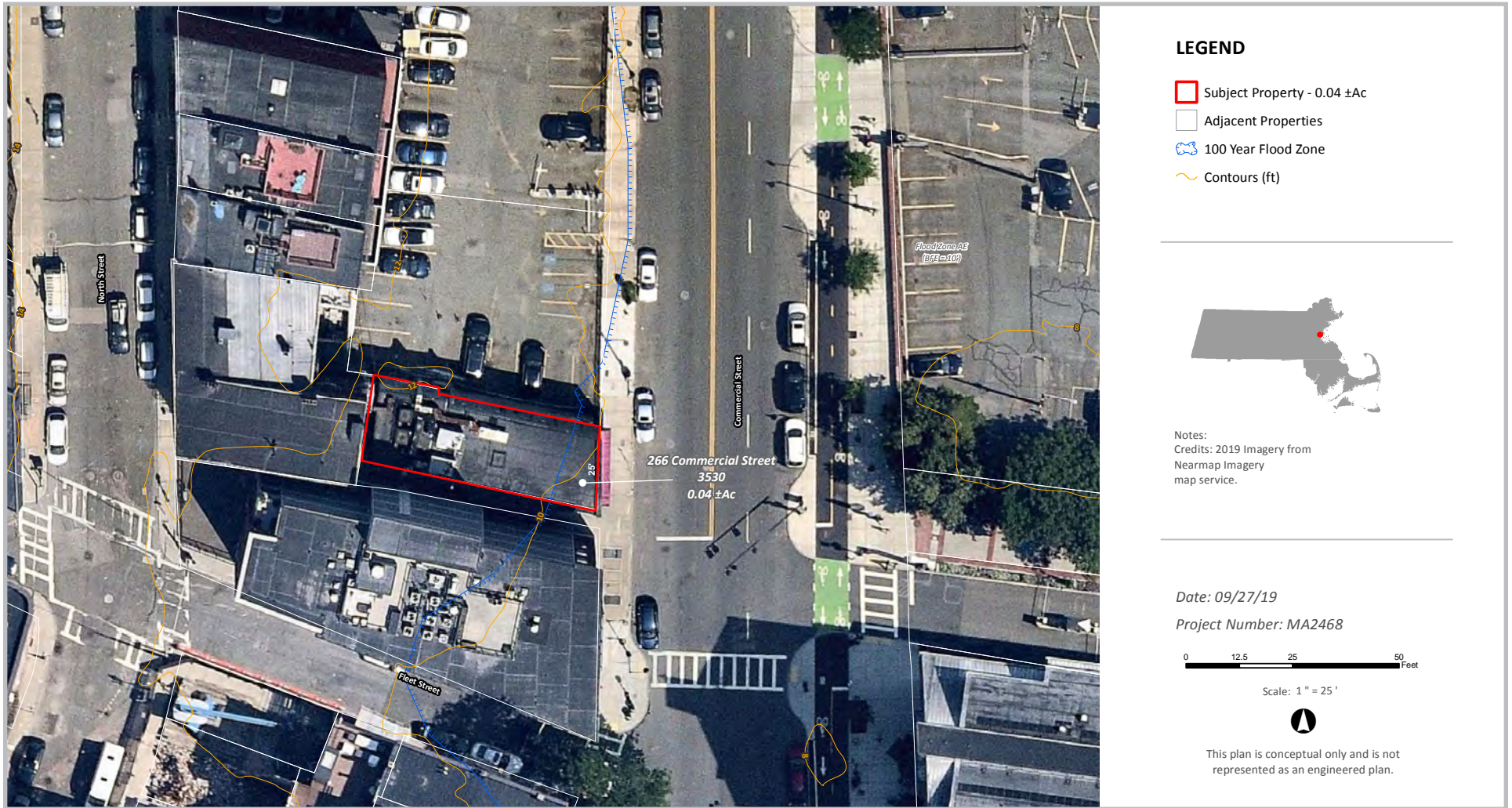

0.7 mile walk



0.4 mile walk



0.4 mile walk

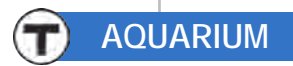

4 mile drive



Easy access to



266 COMMERCIAL STREET  
Boston, Ma



266 COMMERCIAL STREET  
Boston, Ma





## Disclaimer/Confidentiality

This Offering Memorandum has been prepared by LandVest, Inc. for a limited number of parties and is proprietary and confidential. Information contained in this offering was gathered from sources deemed reliable. LandVest, Inc. makes no representation to the accuracy or the completeness of the information contained herein, and nothing contained herein is, or shall be relied on as, a promise or representation as to the future performance of the Property. LandVest, Inc. and its employees disclaim any and all liability for representations and warranties, expressed and implied, contained herein, or for omissions from the Memorandum or any other written or oral communication transmitted or made available to the recipient. No photocopy or duplication of this offering will be made by the recipient. Changes in the business or affairs of the Property or Seller since the date of preparation of the Offering Memorandum are not represented herein. It is the responsibility of the prospective purchaser to obtain analysis and verification of information contained herein. Potential buyers should take steps to verify any information contained within the offering and will be responsible for the costs and expenses of their investigation.

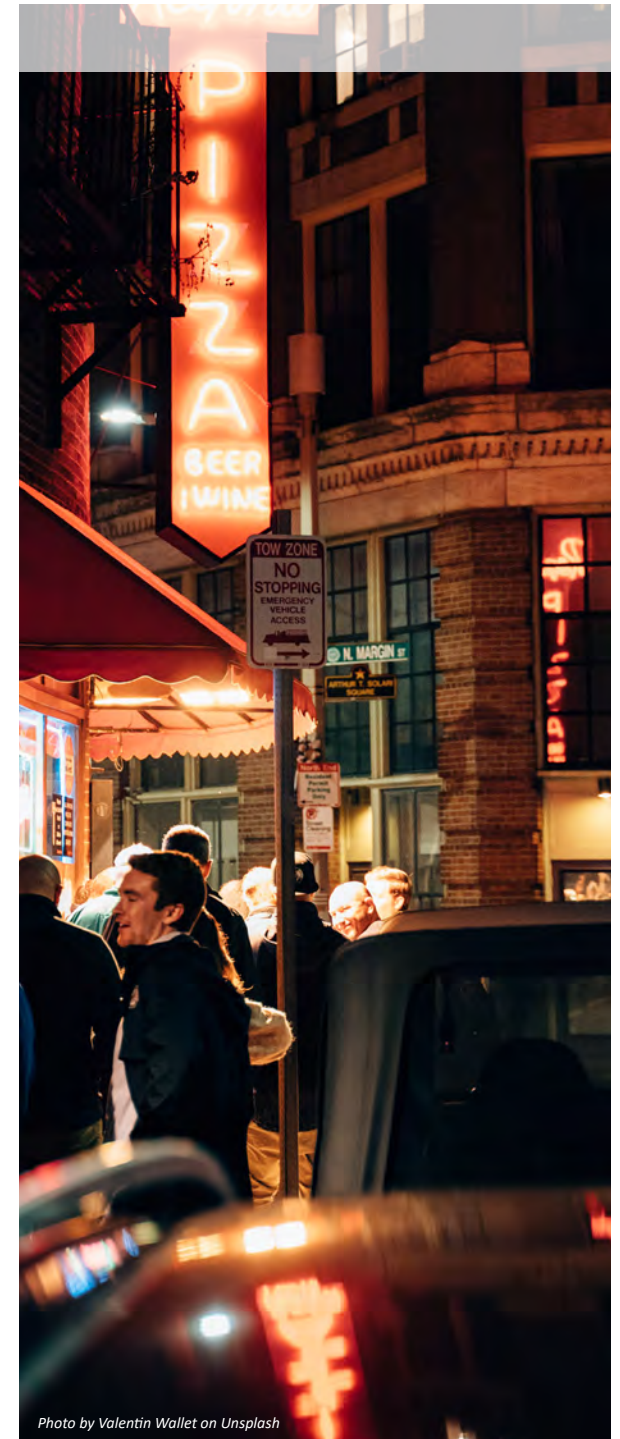

*Photo by Valentin Wallet on Unsplash*



## 266 COMMERCIAL STREET

- 2982± SF total - plus approximately 625± SF unfinished lower level (not inc. in sf)
- Free standing, two-story building
- Second floor water views
- Iconic North End restaurant
- Zoned Multi-family residential/ Local services
- Located at Sargents Wharf
- Close to public transportation

**Offered at \$2,475,000**

**LandVest**<sup>®</sup> | **CHRISTIE'S**  
REAL ESTATE | INTERNATIONAL REAL ESTATE

For more information, please contact:

**GRETA GUSTAFSON**

Managing Director, New Development  
ggustafson@landvest.com • 617-686-6258

HQ - BOSTON: Ten Post Office Square, Suite 1125

[www.landvest.com](http://www.landvest.com)