

# AUTO DEALERSHIP

5300 & 5312 Mt View Road, Antioch, TN

5.3± ACRES / 23,000± SF BUILDING

FOR LEASE



## Property Features

- Located on the corner of Hickory Hollow Parkway and Mt. View Road
- Building contains 9,000 SF of showroom and 14,000 SF of repair space built in 1987
- Showroom and shop can be leased separately
- Commercial PUD allowing for automotive sales and repair
- Located conveniently near I-24
- Proven automotive location for 30 years
- Traffic count exceeds 40,000 cars per day



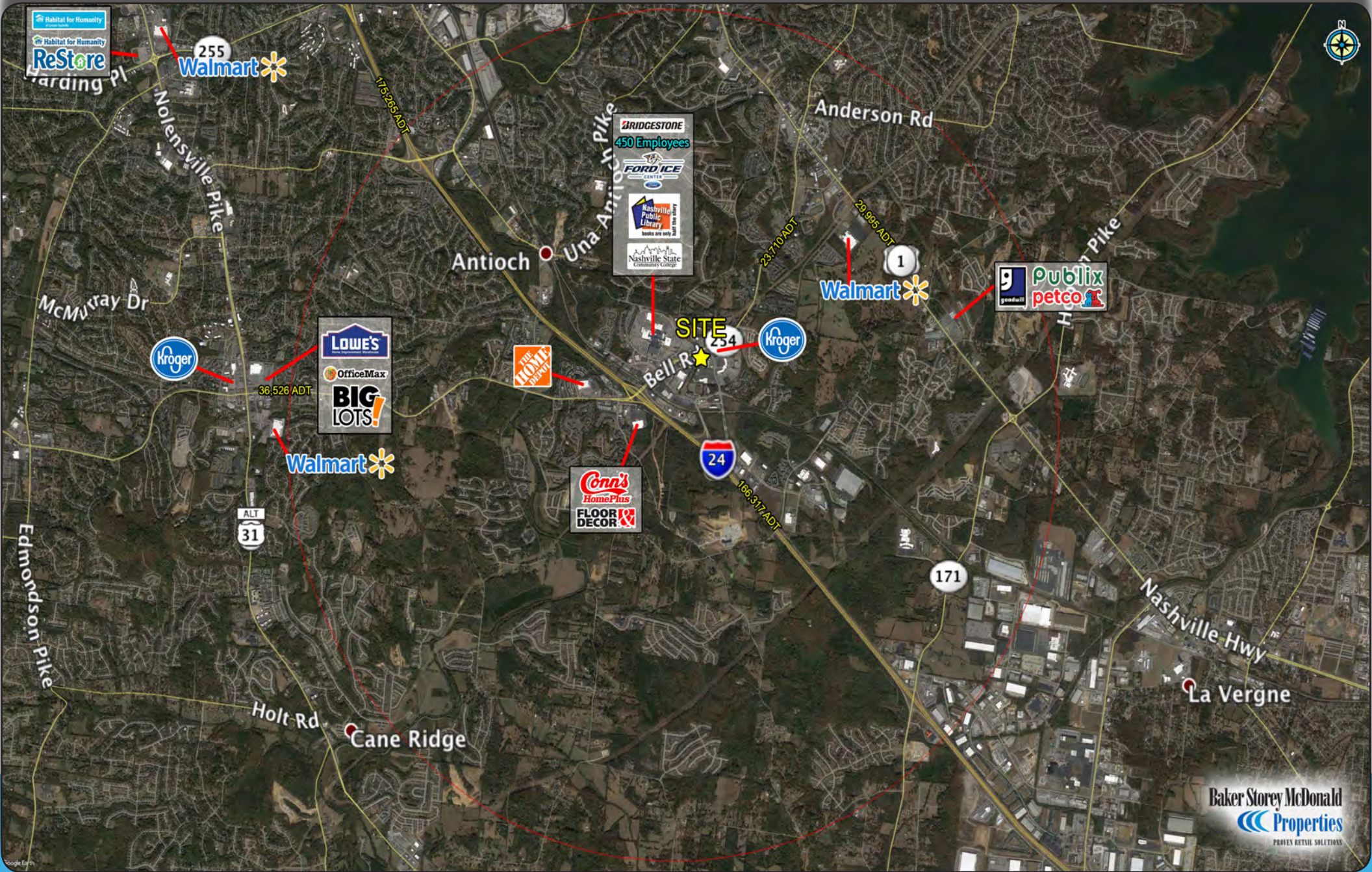

# SUMMARY PROFILE

2000-2010 Census, 2019 Estimates with 2024 Projections

Calculated using Weighted Block Centroid from Block Groups

Lat/Lon: 36.0491/-86.6495

RS1

5300 Mt View Rd		1 mi radius	3 mi radius	5 mi radius
Nashville, TN 37013				
POPULATION	2019 Estimated Population	10,573	78,863	172,092
	2024 Projected Population	10,461	78,970	173,696
	2010 Census Population	8,991	69,031	152,449
	2000 Census Population	6,605	52,058	112,267
	Projected Annual Growth 2019 to 2024	-0.2%	-	0.2%
	Historical Annual Growth 2000 to 2019	3.2%	2.7%	2.8%
	2019 Median Age	29.7	31.3	32.0
HOUSEHOLDS	2019 Estimated Households	5,160	32,583	69,224
	2024 Projected Households	5,414	34,469	73,582
	2010 Census Households	4,168	27,180	58,362
	2000 Census Households	3,249	22,089	46,312
	Projected Annual Growth 2019 to 2024	1.0%	1.2%	1.3%
	Historical Annual Growth 2000 to 2019	3.1%	2.5%	2.6%
RACE AND ETHNICITY	2019 Estimated White	37.0%	46.4%	52.5%
	2019 Estimated Black or African American	47.0%	34.4%	28.0%
	2019 Estimated Asian or Pacific Islander	4.3%	4.9%	6.4%
	2019 Estimated American Indian or Native Alaskan	0.3%	0.3%	0.3%
	2019 Estimated Other Races	11.4%	14.0%	12.8%
	2019 Estimated Hispanic	14.6%	19.9%	18.2%
INCOME	2019 Estimated Average Household Income	\$61,336	\$64,768	\$70,171
	2019 Estimated Median Household Income	\$52,730	\$55,488	\$60,653
	2019 Estimated Per Capita Income	\$30,015	\$26,775	\$28,456
EDUCATION (AGE 25+)	2019 Estimated Elementary (Grade Level 0 to 8)	4.8%	6.3%	6.0%
	2019 Estimated Some High School (Grade Level 9 to 11)	6.6%	6.2%	6.5%
	2019 Estimated High School Graduate	25.4%	26.6%	25.3%
	2019 Estimated Some College	19.5%	19.6%	19.4%
	2019 Estimated Associates Degree Only	7.8%	8.5%	7.9%
	2019 Estimated Bachelors Degree Only	25.6%	23.2%	24.0%
	2019 Estimated Graduate Degree	10.3%	9.5%	10.9%
BUSINESS	2019 Estimated Total Businesses	420	1,395	4,303
	2019 Estimated Total Employees	4,356	12,800	55,852
	2019 Estimated Employee Population per Business	10.4	9.2	13.0
	2019 Estimated Residential Population per Business	25.1	56.5	40.0

This report was produced using data from private and government sources deemed to be reliable. The information herein is provided without representation or warranty.