



Central Parc at Bridgewater Crossings

14393 BRIDGEWATER CROSSINGS BLVD, WINDERMERE, FL 34786



Property Highlights

- ■ Neighborhood Commercial Retail Center
- ■ Perfect For Most Retail and Medical Uses
- ■ Adjacent to New Elementary School and Public Park
- ■ Committed: Pizza, Nail, Ice Cream, Veterinarian & Dental
- ■ No Drive-Thrus



FOR MORE INFORMATION | MILLENIA-PARTNERS.COM

PRESENTED BY

MIGUEL DE ARCOS

407.257.7334

mdearcos@millenia-partners.com

SAM KING

407.341.7728

sking@millenia-partners.com

EXECUTIVE SUMMARY

14393 BRIDGEWATER CROSSINGS BLVD, WINDERMERE, FL 34786
Central Parc at Bridgewater Crossings



OFFERING SUMMARY

| | |
|----------------|------------------|
| Available SF: | 1,142 - 1,395 SF |
| Year Built: | 2017 |
| Building Size: | 10,804 SF |
| Zoning: | Retail/Office |
| Market: | Orlando |
| Submarket: | Windermere |

PROPERTY OVERVIEW

Perfectly situated on Bridgewater Crossings Blvd to service the Summerport, Independence, Windermere and Winter Garden communities. Central Parc at Bridgewater Crossings is designed as a walkable neighborhood retail center immediately adjacent to Keene's Crossing Elementary school and Summerport Park. Ample surface and street side parking leave this site with a well over 5/1,000 parking ratio. The center has restaurant space with patio dining overlooking the park as well as retail and office space also ideal uses. The Neighborhood Commercial zoning allows for: Restaurants, convenience stores, hair salon, dry cleaner, flower shop, jewelry store, gifts, apparel. As well as medical, real estate, insurance, travel, and bank offices. Drive-thrus are prohibited.

PROPERTY HIGHLIGHTS

- Neighborhood Commercial Retail Center
- Perfect For Most Retail and Medical Uses
- Adjacent to New Elementary School and Public Park
- Committed: Pizza, Nail, Ice Cream, Veterinarian & Dental
- No Drive-Thrus

PRESENTED BY
MIGUEL DE ARCOS
407.257.7334
mdearcos@millenia-partners.com

SAM KING
407.341.7728
sking@millenia-partners.com

RETAIL PROPERTY

For Lease

ADDITIONAL PHOTOS

14393 BRIDGEWATER CROSSINGS BLVD, WINDERMERE, FL 34786
Central Parc at Bridgewater Crossings



PRESENTED BY
MIGUEL DE ARCOS
407.257.7334
mdearcos@millenia-partners.com

SAM KING
407.341.7728
sking@millenia-partners.com

RETAIL PROPERTY

For Lease

ADDITIONAL PHOTOS

14393 BRIDGEWATER CROSSINGS BLVD, WINDERMERE, FL 34786
Central Parc at Bridgewater Crossings

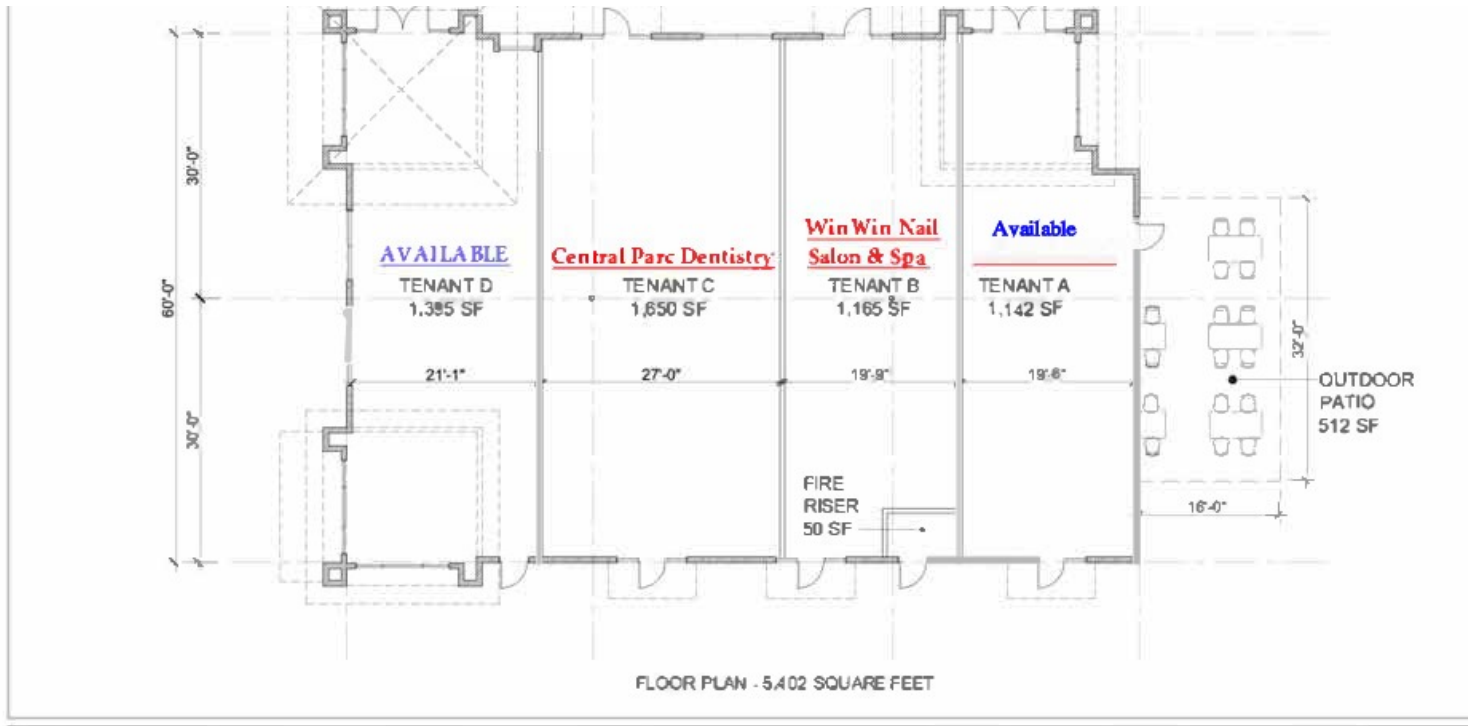

PRESENTED BY
MIGUEL DE ARCOS
407.257.7334
mdearcos@millenia-partners.com

SAM KING
407.341.7728
sking@millenia-partners.com

RETAIL PROPERTY

For Lease

LOCATION MAPS

14393 BRIDGEWATER CROSSINGS BLVD, WINDERMERE, FL 34786

Central Parc at Bridgewater Crossings

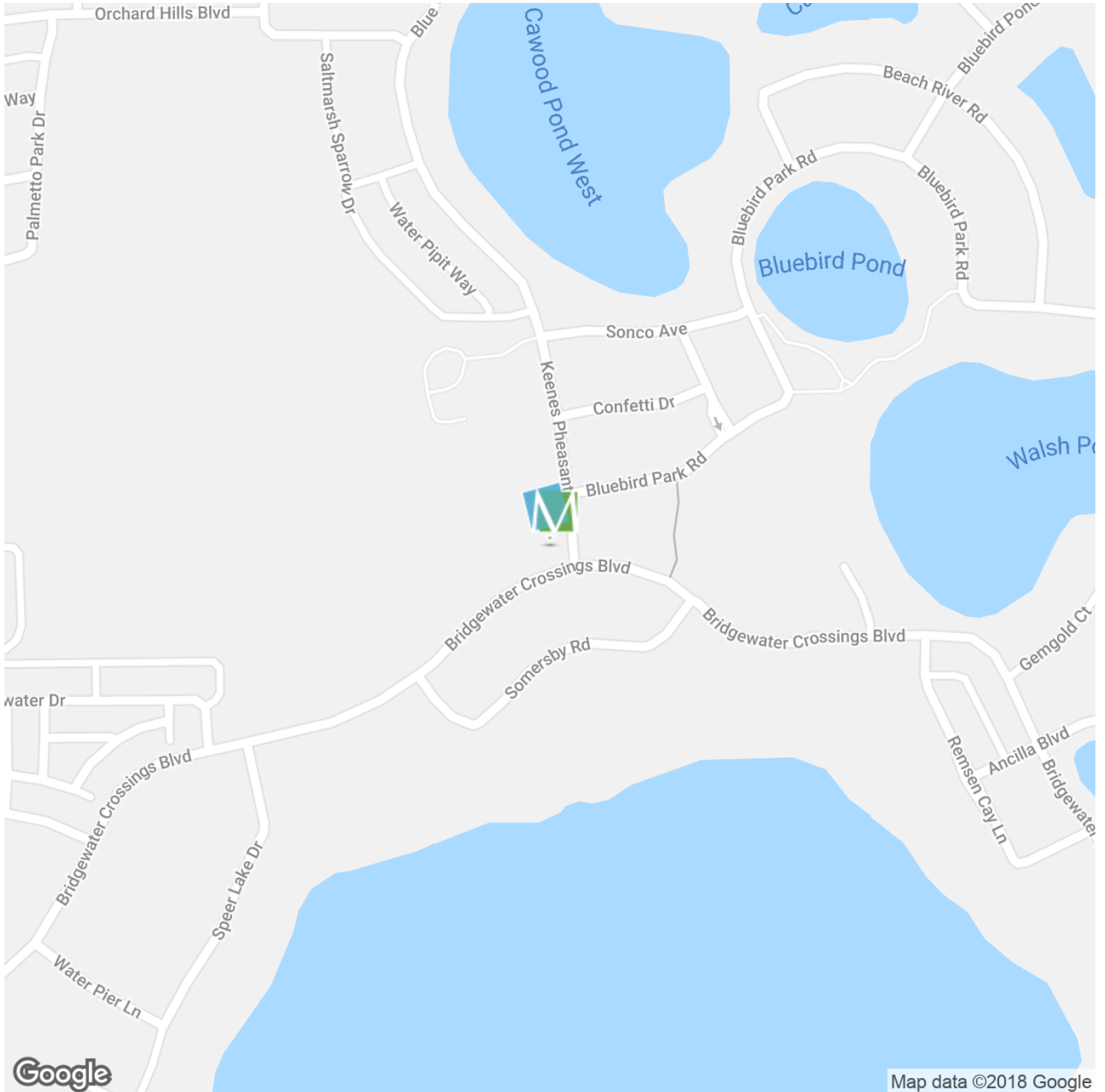

PRESENTED BY
MIGUEL DE ARCOS

407.257.7334

mdearcos@millenia-partners.com

SAM KING

407.341.7728

sking@millenia-partners.com

RETAIL PROPERTY

For Lease

DEMOGRAPHICS MAP & REPORT

14393 BRIDGEWATER CROSSINGS BLVD, WINDERMERE, FL 34786
 Central Parc at Bridgewater Crossings

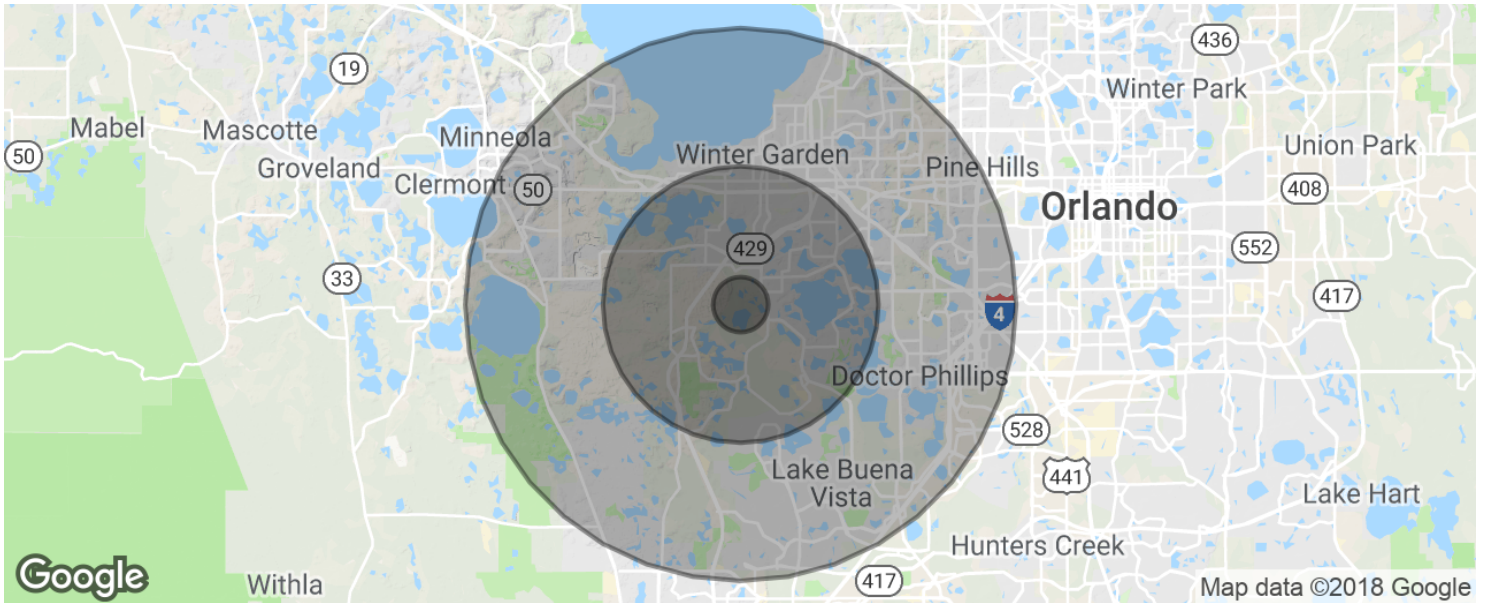

POPULATION

| | 1 MILE | 5 MILES | 10 MILES |
|---------------------|--------|---------|----------|
| Total population | 1,285 | 51,111 | 268,864 |
| Median age | 36.8 | 36.3 | 36.1 |
| Median age (Male) | 38.2 | 35.9 | 35.5 |
| Median age (Female) | 35.8 | 36.7 | 36.8 |

HOUSEHOLDS & INCOME

| | 1 MILE | 5 MILES | 10 MILES |
|---------------------|-----------|-----------|-----------|
| Total households | 416 | 17,066 | 94,890 |
| # of persons per HH | 3.1 | 3.0 | 2.8 |
| Average HH income | \$129,326 | \$111,173 | \$86,786 |
| Average house value | | \$355,437 | \$358,702 |

* Demographic data derived from 2010 US Census

PRESENTED BY
MIGUEL DE ARCOS
 407.257.7334
 mdearcos@millenia-partners.com

SAM KING
 407.341.7728
 sking@millenia-partners.com

RETAIL PROPERTY

For Lease