

LA COSTA PLAZA

Retail / Restaurant For Lease

7690 El Camino Real, Carlsbad, CA 92009



PRIME RETAIL LOCATION AVAILABLE FRONTING EL CAMINO REAL

2,400 SF + Additional ±400 SF Outdoor Patio

Description:

- Anchored by Gelson's Market and includes other notable tenants as Starbucks, Opus Bank, Broken Yolk Cafe, Bruegger's Bagels, Golden Spoon, Supercuts and more.
- Centrally located in one of the most affluent communities in San Diego County.
- Center benefits from a desirable mix of daily needs, service and restaurant tenants that promote repeat customer visits.
- Located on the corner of El Camino Real and La Costa Avenue with signalized ingress and egress.
- Close proximity to the world renowned Omni La Costa Resort & Spa.

Traffic Counts:

- ± 46,200 average daily traffic on El Camino Real.
- ± 17,900 average daily traffic on La Costa Avenue.

Demographics:

	1 MILE	3 MILES	5 MILES
Population '16	10,156	95,704	164,113
Population '21	10,735	101,922	175,288
Average H.H. Income	\$133,276	\$137,191	\$128,703
Daytime Population	1,919	41,922	101,785

Source: ESRI



For further information, please contact our exclusive agents:

AARON HILL

Managing Director

858.875.5923

aaronhill@ngkf.com

CA RE License #01365975

**Newmark Grubb
Knight Frank**

Retail

4655 Executive Drive, Suite 800, San Diego, CA 92121 T 858.875.3600

Corporate CA RE License #01355491 www.ngkf.com

LA COSTA PLAZA

Retail / Restaurant For Lease

7690 El Camino Real, Carlsbad, CA 92009



Tenant Roster

SUITE		TENANT
7660		Gelson's Market
7662	# 101	H&R Block
7662	# 102	Rudy's Taco Shop
7662	# 103	Flippin Pizza
7668	# 101	La Costa Animal Hospital
7668	# 102	Beasley Cleaners
7668	# 103	Nail 2000 Plus
7668	# 104	Postal Annex
7670	# 101	Supercuts
7670	# 102	Coastal Premier Properties
7670	# 103	Golden Spoon
7670	# 104	Broken Yolk Café
7680	# 101	Starbucks
7680	# 102	Bruegger's Bagel Bakery
7680	# 103	Thai Pasta
7690	# 100	Opus Bank
7690	# 101	Available - 2,400 SF (Plus Additional ±400 SF Outdoor Patio)

CONTACT:

AARON HILL
 Managing Director
 858.875.5923
 aaronhill@ngkf.com
 CA RE License #01365975



Newmark Grubb Knight Frank

Retail

4655 Executive Drive, Suite 800, San Diego, CA 92121 T 858.875.3600

Corporate CA RE License #01355491

www.ngkf.com

The information contained herein has been obtained from sources deemed reliable but has not been verified and no guarantee, warranty or representation, either express or implied, is made with respect to such information. Terms of sale or lease and availability are subject to change or withdrawal without notice.

LA COSTA PLAZA

Retail / Restaurant For Lease

7690 El Camino Real, Carlsbad, CA 92009



- El Camino Real -

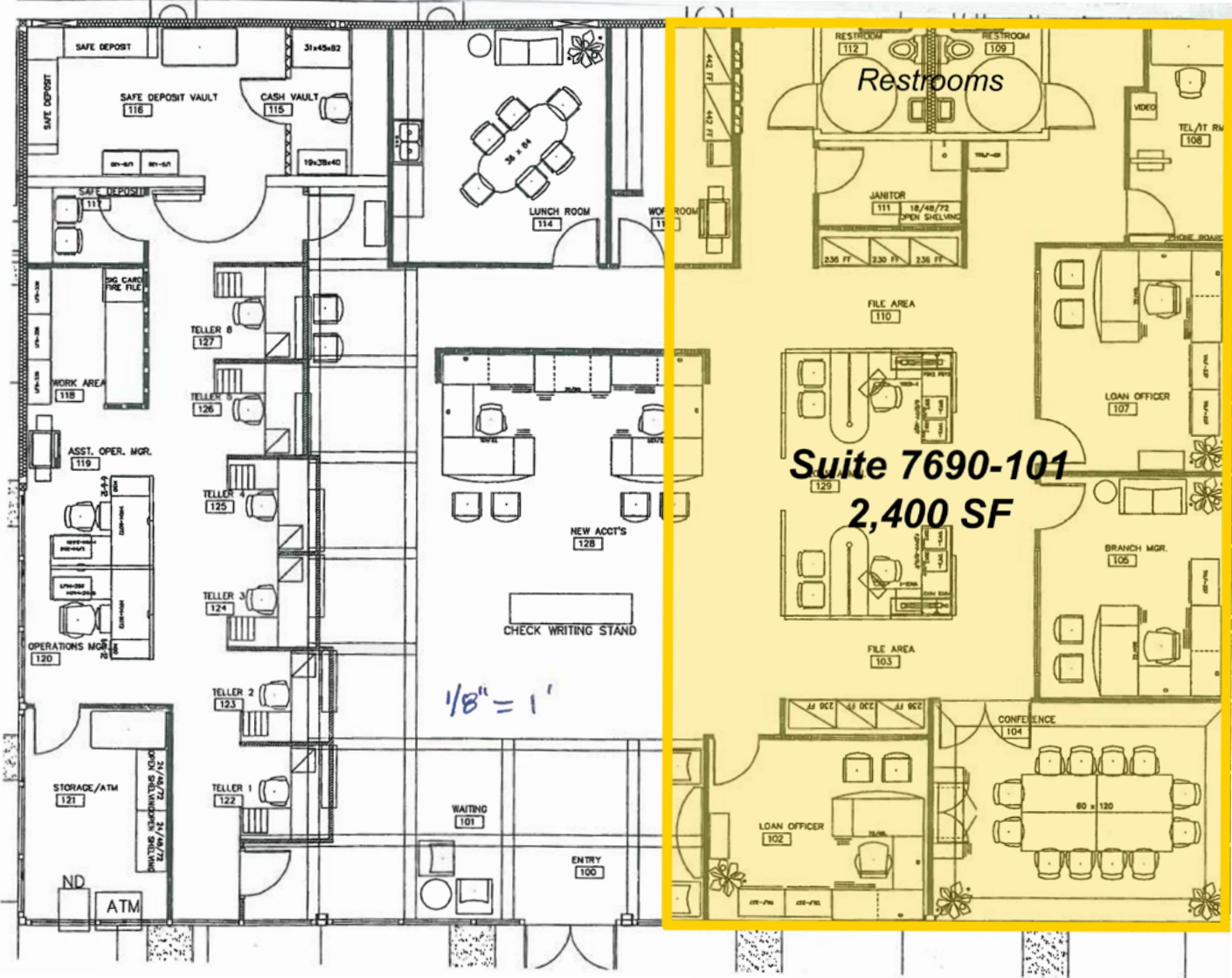

**±400 SF Proposed
Outdoor Patio
(Fronting El Camino Real)**

**Newmark Grubb
Knight Frank**

Retail

For further information, please contact our exclusive agents:

AARON HILL

Managing Director

858.875.5923

aaronhill@ngkf.com

CA RE License #01365975

4655 Executive Drive, Suite 800, San Diego, CA 92121 T 858.875.3600

Corporate CA RE License #01355491 www.ngkf.com

LA COSTA PLAZA

Retail / Restaurant For Lease

7690 El Camino Real, Carlsbad, CA 92009

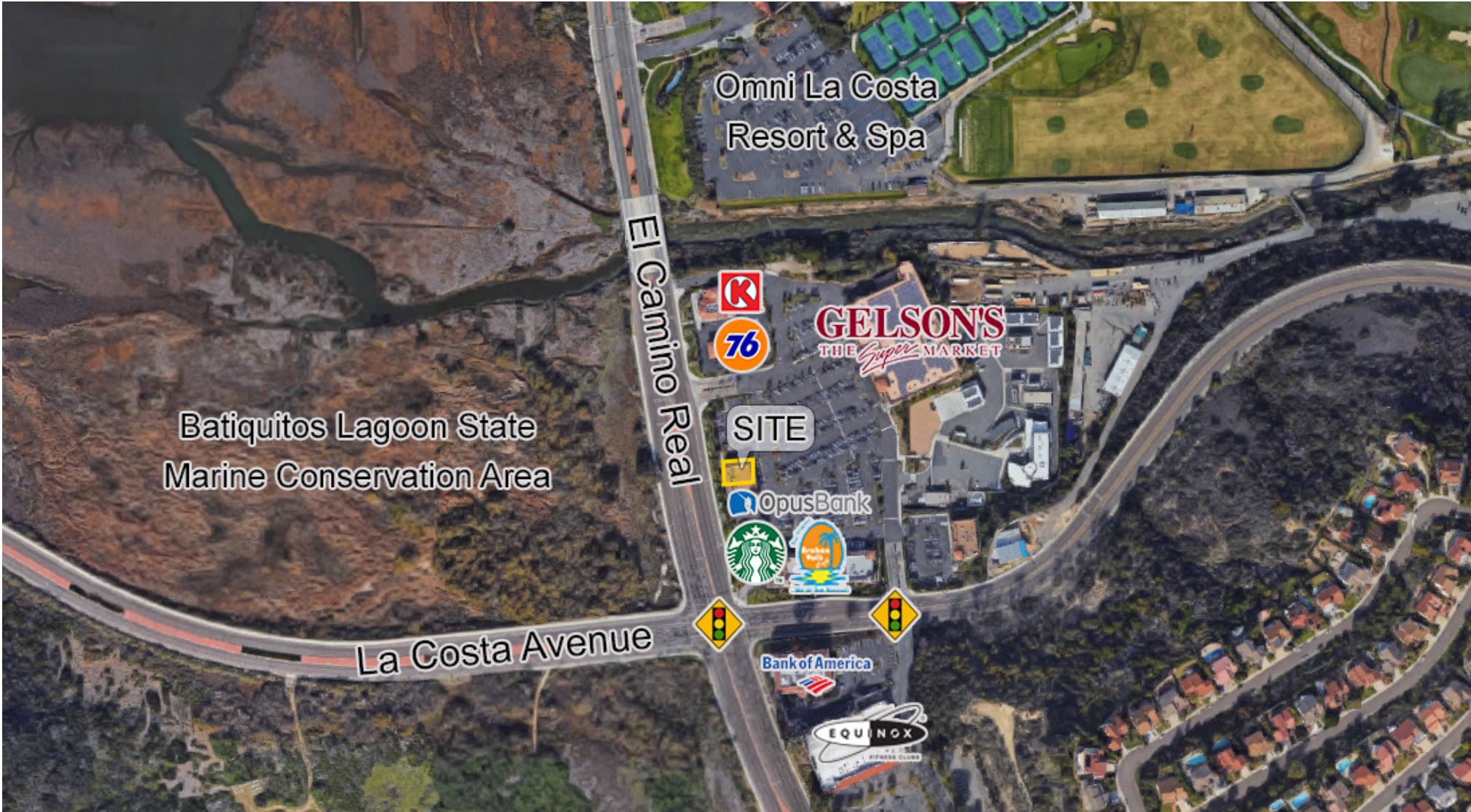

Newmark Grubb
Knight Frank

Retail

For further information, please contact our exclusive agents:

AARON HILL Managing Director 858.875.5923 aaronhill@ngkf.com CA RE License #01365975

4655 Executive Drive, Suite 800, San Diego, CA 92121 T 858.875.3600 Corporate CA RE License #01355491 www.ngkf.com

LA COSTA PLAZA

Retail / Restaurant For Lease

7690 El Camino Real, Carlsbad, CA 92009

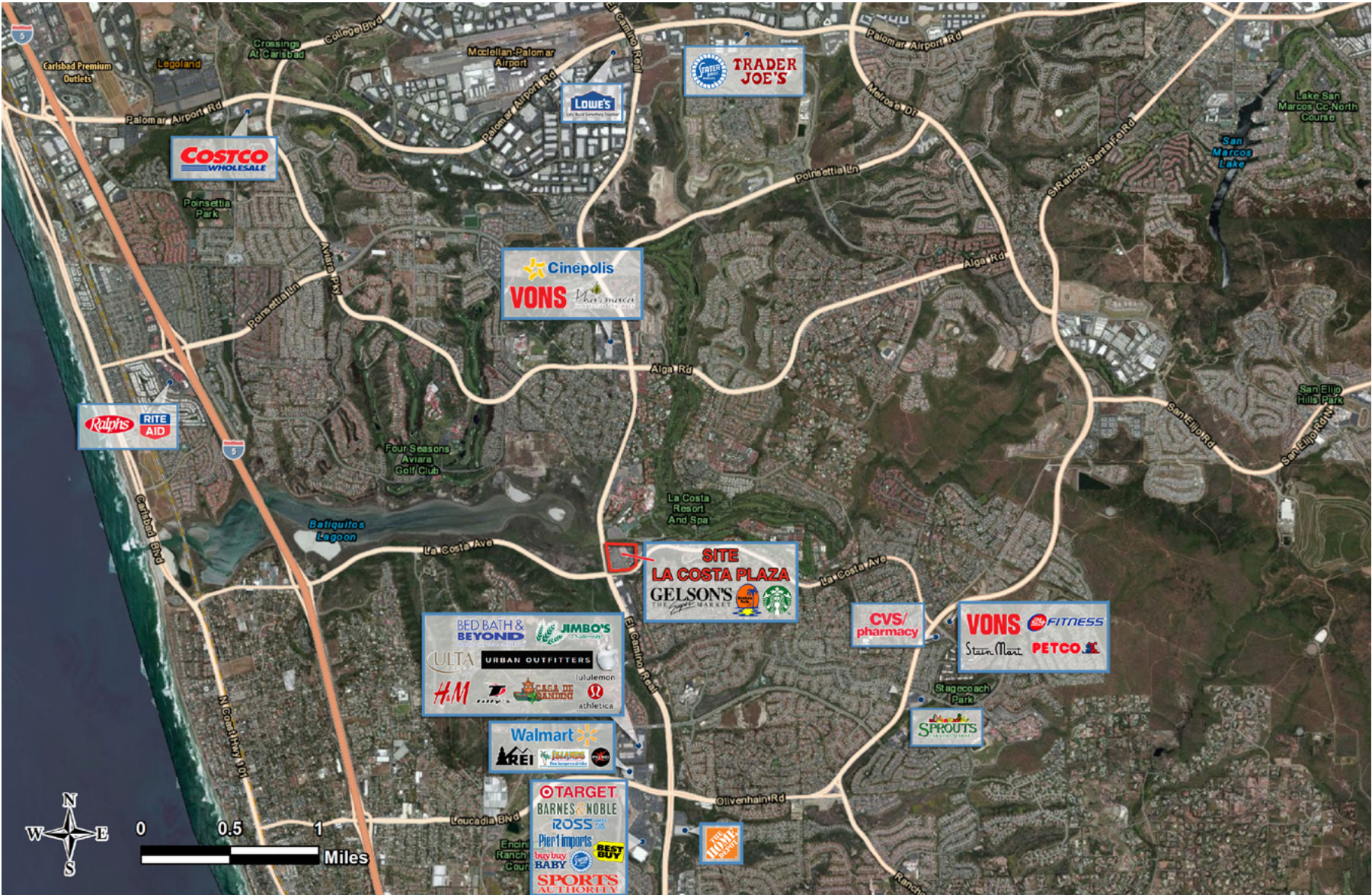

For further information, please contact our exclusive agents:

AARON HILL

Managing Director

858.875.5923

aaronhill@ngkf.com

CA RE License #01365975

**Newmark Grubb
Knight Frank**

Retail

4655 Executive Drive, Suite 800, San Diego, CA 92121 T 858.875.3600

Corporate CA RE License #01355491 www.ngkf.com

LA COSTA PLAZA

Retail / Restaurant For Lease

7690 El Camino Real, Carlsbad, CA 92009



Executive Summary

7690 El Camino Real, Carlsbad, California, 92009
Rings: 1, 3, 5 mile radii

Prepared by Esri
Latitude: 33.08607
Longitude: -117.26861

	1 mile	3 miles	5 miles
Population			
2000 Population	7,964	70,401	116,941
2010 Population	9,623	89,183	152,792
2016 Population	10,156	95,704	164,113
2021 Population	10,735	101,922	175,288
2000-2010 Annual Rate	1.91%	2.39%	2.71%
2010-2016 Annual Rate	0.87%	1.14%	1.15%
2016-2021 Annual Rate	1.12%	1.27%	1.33%
2016 Male Population	47.3%	48.6%	48.5%
2016 Female Population	52.7%	51.4%	51.5%
2016 Median Age	49.3	42.5	42.5
Households			
2000 Households	3,313	27,916	47,384
2010 Households	4,166	34,856	60,467
2016 Total Households	4,346	36,781	63,732
2021 Total Households	4,580	38,926	67,571
2000-2010 Annual Rate	2.32%	2.25%	2.47%
2010-2016 Annual Rate	0.68%	0.86%	0.84%
2016-2021 Annual Rate	1.05%	1.14%	1.18%
2016 Average Household Size	2.31	2.59	2.56
Median Household Income			
2016 Median Household Income	\$99,752	\$102,538	\$94,008
2021 Median Household Income	\$108,583	\$111,821	\$104,444
2016-2021 Annual Rate	1.71%	1.75%	2.13%
Average Household Income			
2016 Average Household Income	\$133,276	\$137,191	\$128,703
2021 Average Household Income	\$145,511	\$149,494	\$140,165
2016-2021 Annual Rate	1.77%	1.73%	1.72%
Per Capita Income			
2016 Per Capita Income	\$56,703	\$52,936	\$50,011
2021 Per Capita Income	\$61,607	\$57,286	\$54,029
2016-2021 Annual Rate	1.67%	1.59%	1.56%

CONTACT:

AARON HILL
Managing Director
858.875.5923
aaronhill@ngkf.com
CA RE License #01365975



Site Map

7690 El Camino Real, Carlsbad, California, 92009
Rings: 1, 3, 5 mile radii

Prepared by Esri
Latitude: 33.08607
Longitude: -117.26861

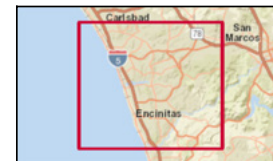
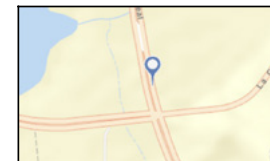
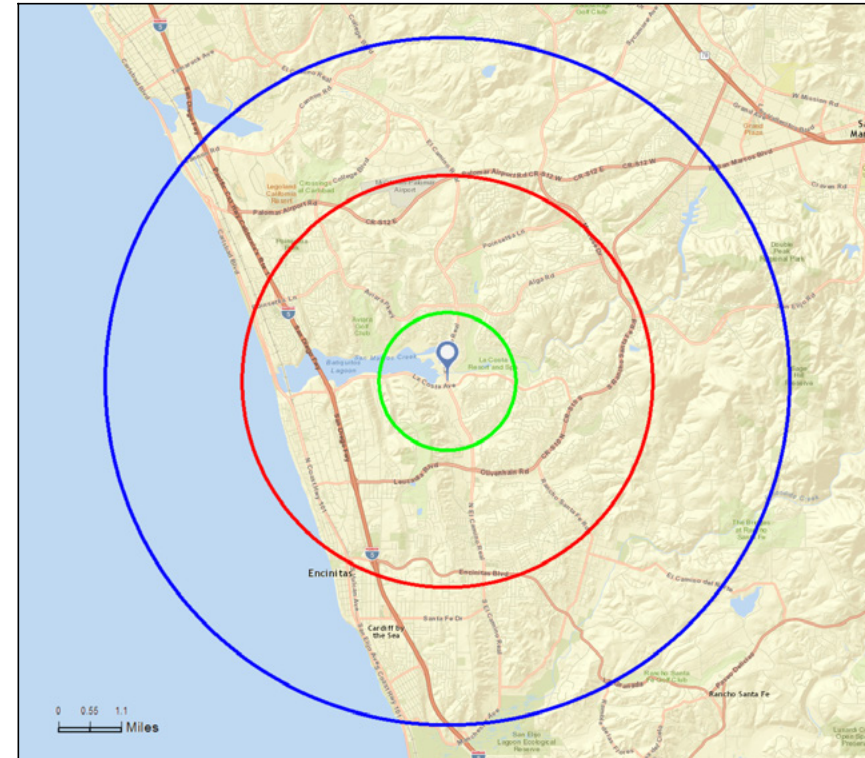

**Newmark Grubb
Knight Frank**

Retail

4655 Executive Drive, Suite 800, San Diego, CA 92121 T 858.875.3600 Corporate CA RE License #1355491

www.ngkf.com

The information contained herein has been obtained from sources deemed reliable but has not been verified and no guarantee, warranty or representation, either express or implied, is made with respect to such information. Terms of sale or lease and availability are subject to change or withdrawal without notice.