

COMMERCIAL BUILDING

For Sale or Lease



MARK BOTTLES
REAL ESTATE SERVICES



PROPERTY INFORMATION:

Address:	615 N Main St Hailey, Idaho 83333
Location:	Hwy 75 (Main St) N into Hailey, past Myrtle St
Building Size:	± 19,400 SF Ground Level ± 13,500 SF Lower Level
Lot Size:	± 1.33 acres
Zoning:	City of Hailey - Commercial
Lease Rate:	\$ 17.50/SF NNN (Basement SF included at no charge)
Price:	\$4,900,000

COMMENTS:

- Former King's store with excellent visibility and curb appeal; Remodeled in 2016
- Corner location; two access points
- Lower level has ± 3,500 SF showroom; ± 10,000 SF storage
- Upgraded remodel including heated sidewalk
- Contact Agent for showing instructions

839 S. Bridgeway Place
Eagle, Idaho
P(208) 377-5700 F(208) 377-0035
www.markbottles.com

Dave Bohecker

Cell: (208) 230-3309 | Office: (208) 947-1081
dave@markbottles.com

COMMERCIAL BUILDING

For Sale or Lease



MARK BOTTLES
REAL ESTATE SERVICES



SITE PLAN

615 N MAIN ST, HAILEY, IDAHO

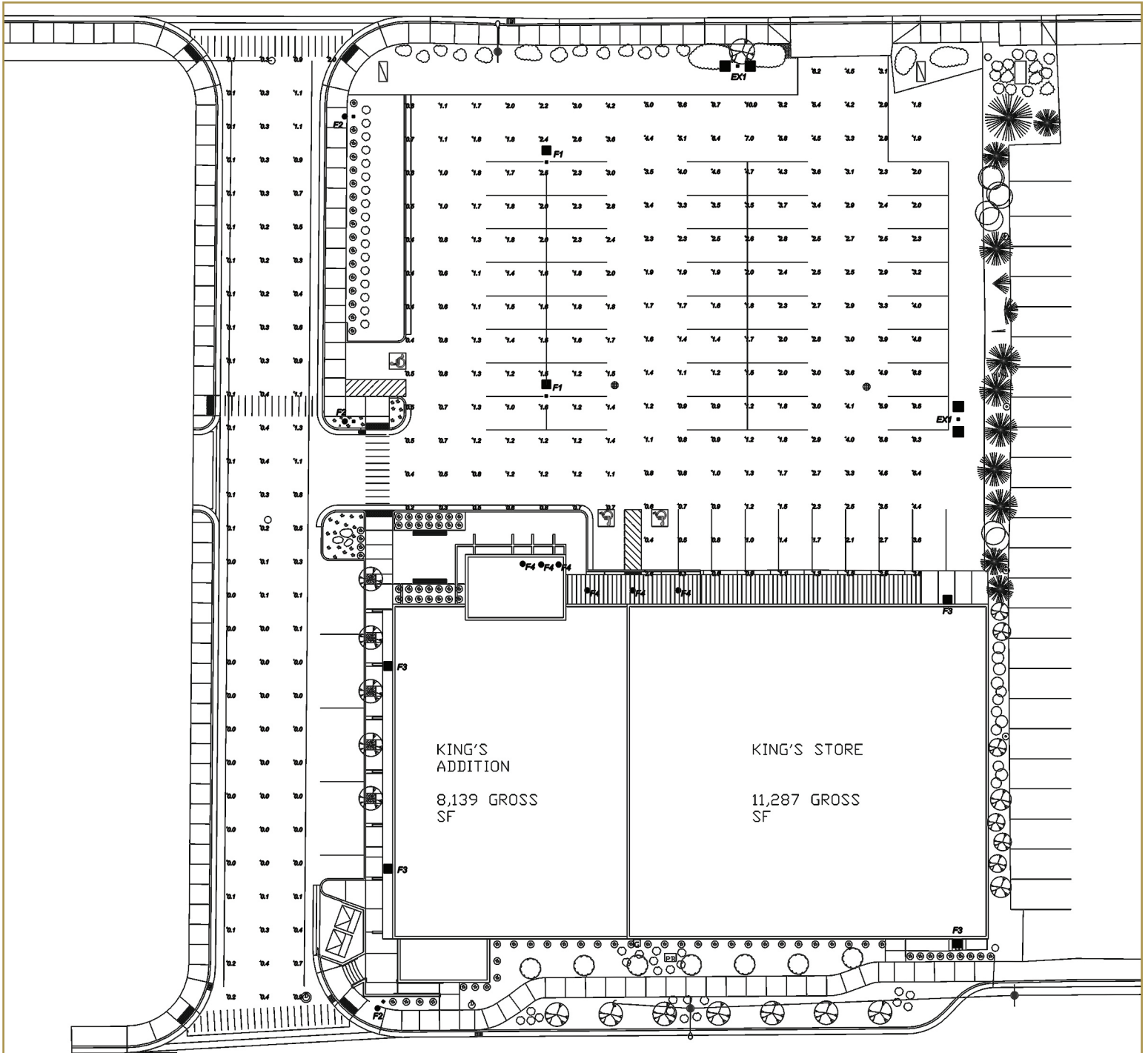

839 S. Bridgeway Place
Eagle, Idaho

P(208) 377-5700 F(208) 377-0035

www.markbottles.com

Dave Bohecker

Cell: (208) 230-3309 | Office: (208) 947-1081

dave@markbottles.com

COMMERCIAL BUILDING

For Sale or Lease



MARK BOTTLES
REAL ESTATE SERVICES



CLOSE AERIAL

615 N MAIN ST, HAILEY, IDAHO



839 S. Bridgeway Place
Eagle, Idaho

P(208) 377-5700 F(208) 377-0035

www.markbottles.com

Dave Bohecker

Cell: (208) 230-3309 | Office: (208) 947-1081

dave@markbottles.com

COMMERCIAL BUILDING

For Sale or Lease



MARK BOTTLES
REAL ESTATE SERVICES

MB WIDE AERIAL

615 N MAIN ST, HAILEY, IDAHO



N-MAIN ST
HAILEY



839 S. Bridgeway Place
Eagle, Idaho

P(208) 377-5700 F(208) 377-0035

www.markbottles.com

Dave Bohecker

Cell: (208) 230-3309 | Office: (208) 947-1081

dave@markbottles.com