

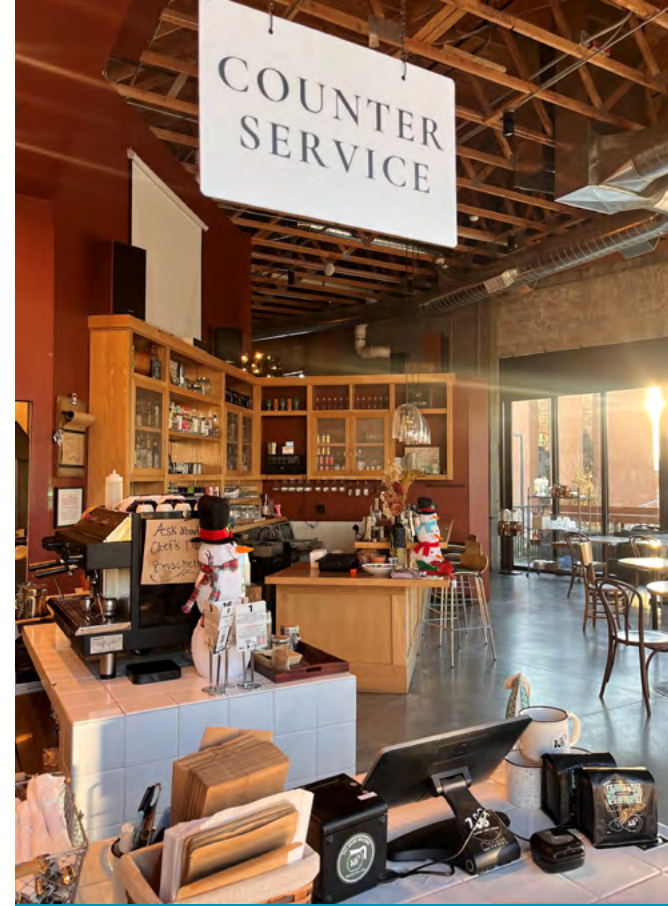

WB'S EATERY SUBLEASE

455 25TH STREET, OGDEN, UT 84401

TURN-KEY RESTAURANT & BAR FOR SUBLEASE



HIGHLIGHTS

- Size: 1,905 SF
- Lease Rate: \$16.88 PSF/NNN
- CAM: \$3.00 PSF
- Prime location on Historic 25th Street at the Monarch
- Sublease expires May 31st, 2025

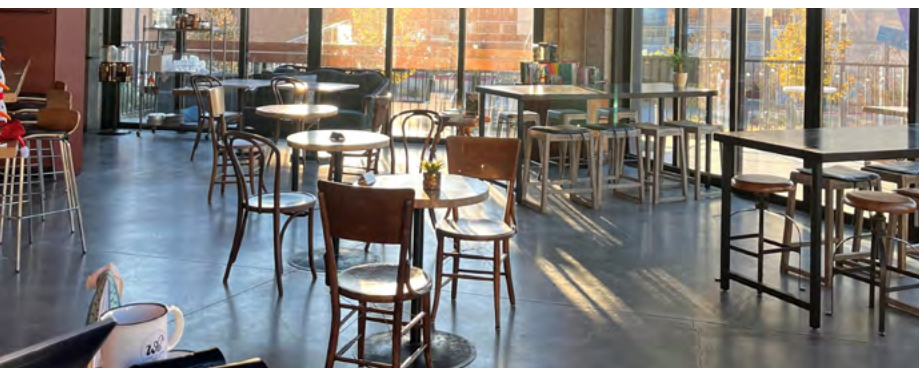

INDOOR AND OUTDOOR
PATIO SEATING



NEIGHBORHOOD DEMOGRAPHICS



POPULATION



AVERAGE
HOUSEHOLD INCOME



DAYTIME
POPULATION

1 Mile	17,952	\$63,582	25,888
3 Miles	84,400	\$79,425	104,979
5 Miles	161,023	\$90,215	184,803

ALL FURNITURE, FIXTURES & EQUIPMENT NEGOTIABLE



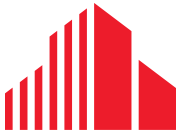
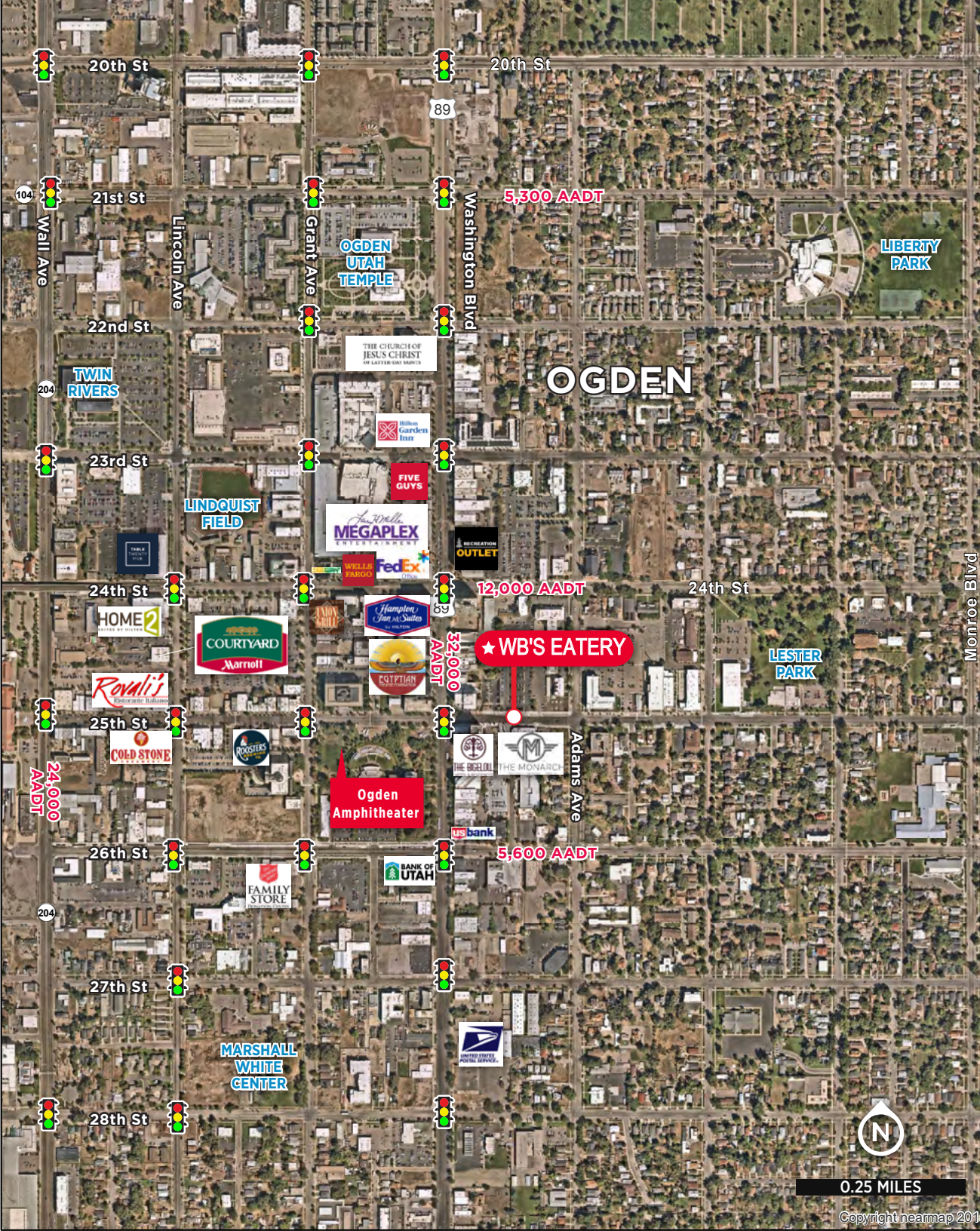

CUSHMAN & WAKEFIELD

TRACY FORSLING, MBA
Retail Specialist

170 South Main Street, Suite 1600
Salt Lake City, UT 84101
tracy.forsling@cushwake.com
+1 801 303 5515
cushmanwakefield.com

Rise Commercial Realty

ERIN MOORE
(806) 281-2950
ERIN@RISECOMMERCIALREALTY.COM
REAL BROKER LLC

©2021 Cushman & Wakefield. All rights reserved. The information contained in this communication is strictly confidential. This information has been obtained from sources believed to be reliable but has not been verified. NO WARRANTY OR REPRESENTATION, EXPRESS OR IMPLIED, IS MADE AS TO THE CONDITION OF THE PROPERTY (OR PROPERTIES) REFERENCED HEREIN OR AS TO THE ACCURACY OR COMPLETENESS OF THE INFORMATION CONTAINED HEREIN, AND SAME IS SUBMITTED SUBJECT TO ERRORS, OMISSIONS, CHANGE OF PRICE, RENTAL OR OTHER CONDITIONS, WITHDRAWAL WITHOUT NOTICE, AND TO ANY SPECIAL LISTING CONDITIONS IMPOSED BY THE PROPERTY OWNER(S). ANY PROJECTIONS, OPINIONS OR ESTIMATES ARE SUBJECT TO UNCERTAINTY AND DO NOT SIGNIFY CURRENT OR FUTURE PROPERTY PERFORMANCE.