



SEATAC CITY HALL

Exclusively represented by



THE ANDOVER COMPANY, INC.

C O R F A C I N T E R N A T I O N A L

Mike Hemphill

206-336-5325

mhemphill@andoverco.com

Mike Ewing

206-357-5483

mewing@andoverco.com

DISTINCTIVE AND MODERN!

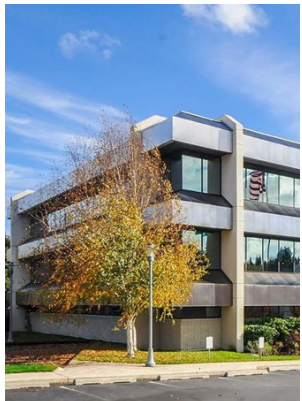

SEA TAC CITY HALL offers modern Class A office space immediately off Interstate 5 at the S 188th/Orillia interchange. Tenants will find this exceptional office building only five minutes from SeaTac Airport. This quality office building offers convenient, immediate access to I-5 for employees and customers.

HIGHLIGHTS

- Three-story *Class A* 105,000 SF office building
- Immediate access to both northbound and southbound I-5 via the S 188th Street interchange
- Large, efficient floor plates (35,000 SF) divisible to 2,000 square feet
- State-of-the-art telecommunications service and data transmission with CenturyLink and Comcast Business cable; fiber optic capability on site
- 20 minutes to Seattle; 20 minutes to Tacoma; 5 minutes to SeaTac International Airport
- Metro bus route to building
- Security system with proximity card key access
- Tremendous territorial views of Mount Rainier
- Multitude of hotels and restaurants within a 5 minute drive

FEATURES

- | | |
|-----------------------|--|
| Typical floor: | 35,000 SF |
| Parking: | Plentiful free parking |
| Year built: | 1978 |
| Structure: | Reinforced concrete and glass |
| Elevators: | One passenger elevator; one freight elevator |
| Zoning: | CB (SeaTac) |
| Transit: | <ul style="list-style-type: none">• Building is on Metro bus route 180 with transit stop adjacent to building• Just minutes away from Link light rail station at SeaTac International Airport |

SECOND FLOOR

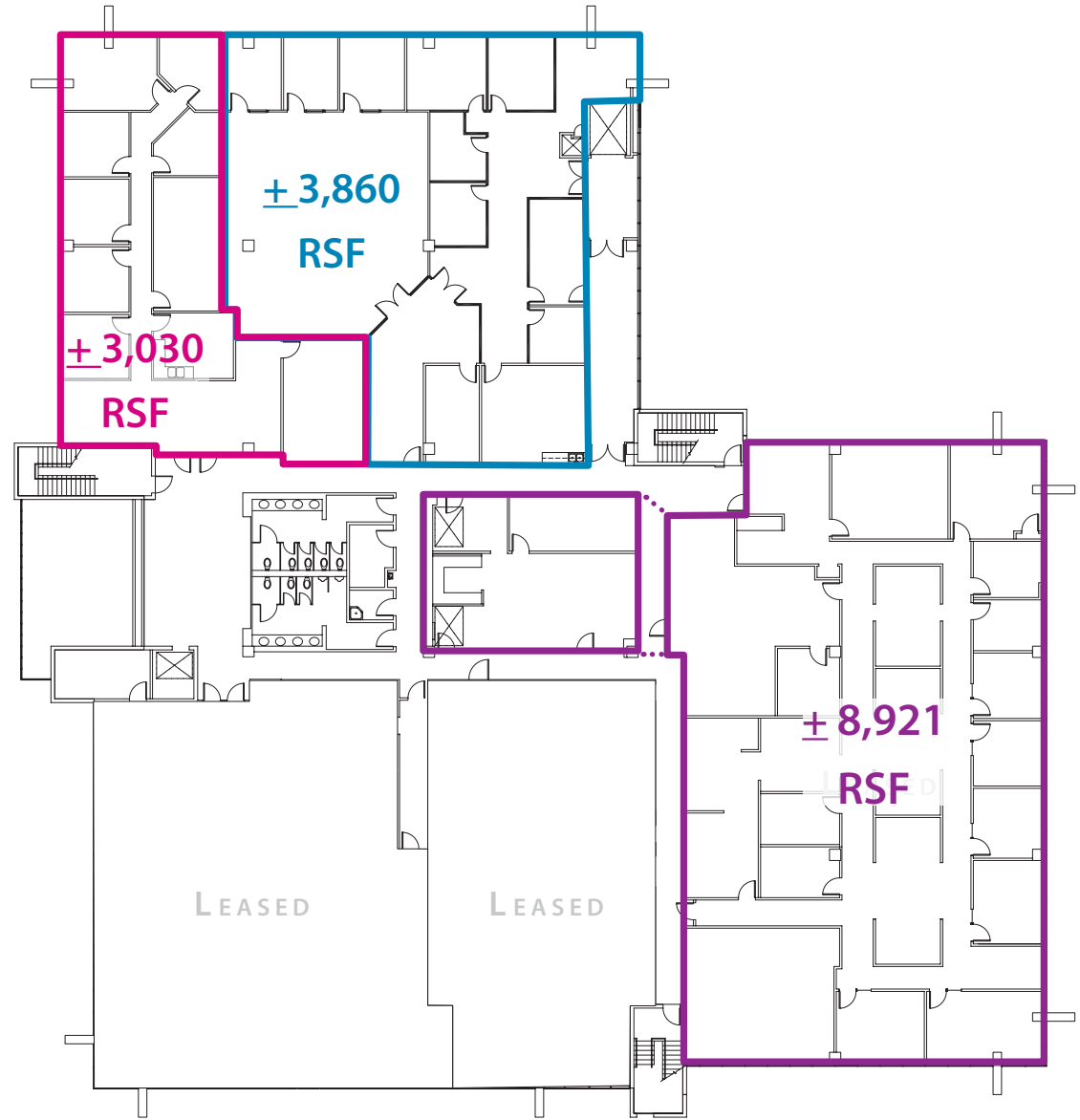

SECOND LEVEL FLOOR PLAN

NEIGHBORING AMENITIES



BIRD'S EYE VIEW

