



Click to Watch Video

# FOR LEASE

## PROMONTORY POINT

2323, 2401, 2525 & 2535 RIDGEPOINT DR. AUSTIN, TX 78754

### Property Highlights

- Shallow Bay Industrial
- Flex/Value Office/Life Science
- Ample Glass
- +/- 20' Clear Height
- Class A Construction & Finishes
- Immediate Access to Hwy 183 & Hwy 290
- 4:7:1,000 Parking
- Great Visibility/Signage Opportunity
- Close Proximity to the Domain, CBD, and Austin- Bergstrom International Airport

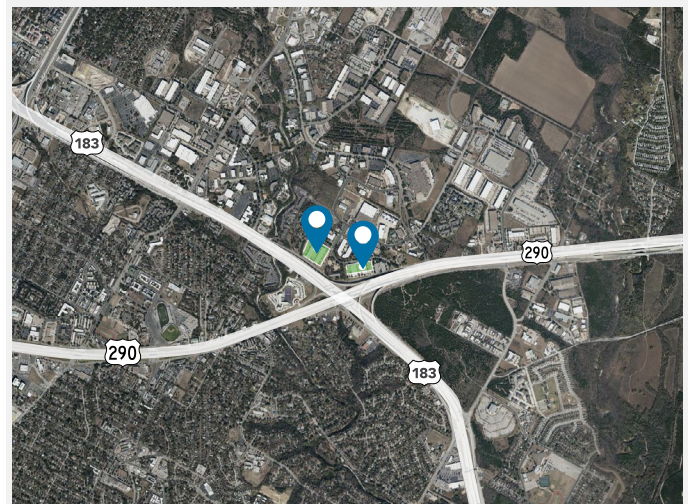

Northeast Submarket

### For Leasing Information:

Will Nichols  
C (512) 481-3009  
wnichols@streamrealty.com

Luke Watson  
C (806) 543-0320  
luke.watson@streamrealty.com

Bridger Gunderson  
C (224) 632-0194  
bridger.gunderson@streamrealty.com

Leased by:

**STREAM**

Owned by:

**BLP** BRIDGE LOGISTICS PROPERTIES

# FOR LEASE

## PROMONTORY POINT

2323, 2401, 2525 & 2535 RIDGEPOINT DR. AUSTIN, TX 78754

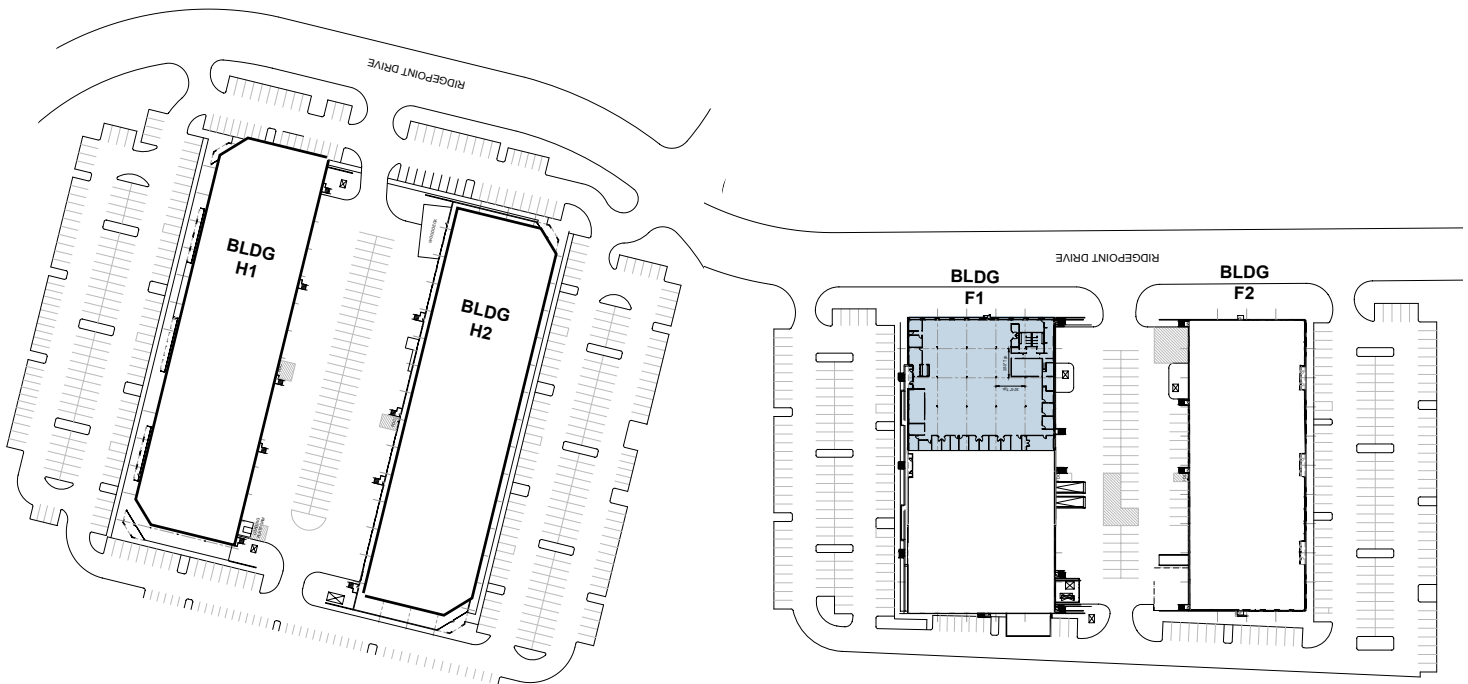

### For Leasing Information:

Will Nichols  
C (512) 481-3009  
wnichols@streamrealty.com

Luke Watson  
C (806) 543-0320  
luke.watson@streamrealty.com

Bridger Gunderson  
C (224) 632-0194  
bridger.gunderson@streamrealty.com

Leased by:

**STREAM**

Owned by:

**BLP** BRIDGE  
LOGISTICS  
PROPERTIES

# FOR LEASE

CLICK TO TOUR THE SPACE 

PROMONTORY POINT

2323, 2401, 2525 & 2535 RIDGEPOINT DR. AUSTIN, TX 78754

BLDG. F1, SUITE 100 - 20,278 SF

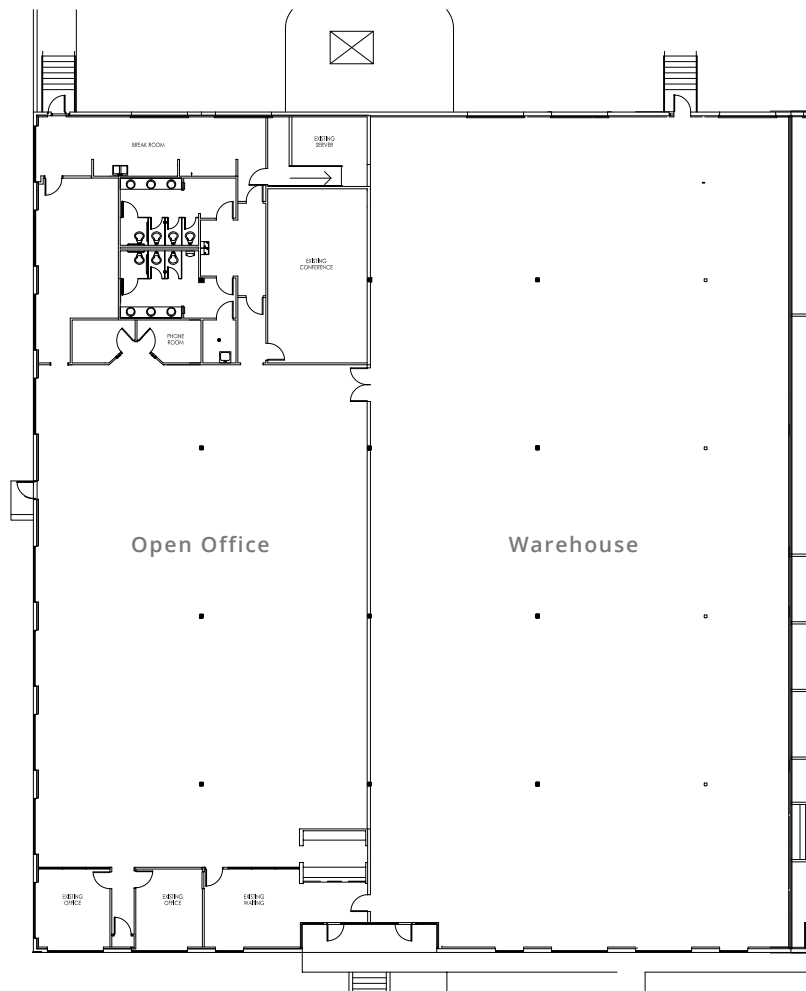
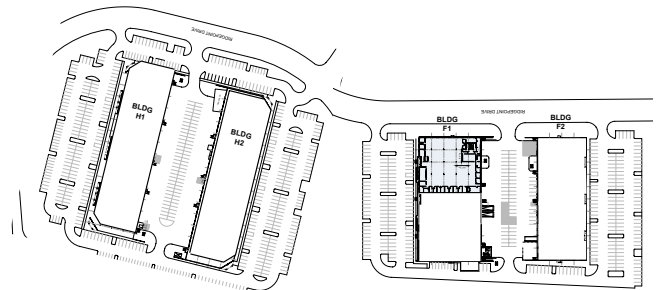

## For Leasing Information:

Will Nichols  
C (512) 481-3009  
wnichols@streamrealty.com

Luke Watson  
C (806) 543-0320  
luke.watson@streamrealty.com

Bridger Gunderson  
C (224) 632-0194  
bridger.gunderson@streamrealty.com

Leased by:

  
**STREAM**

Owned by:

 **BRIDGE  
LOGISTICS  
PROPERTIES**