



3.43 acres

Aerial View — 4.13 Acres / 3 Parcels

PROPERTY HIGHLIGHTS

- 4.13 Acres Total**
Three separate parcels — combined redevelopment opportunity
- Priced at \$1,199,000**
All three parcels sold together as an assemblage
- Mixed Zoning**
2 parcels Residential + 1 parcel Industrial zoning
- 46,000 SF Industrial Building**
Large older structure on 1734 E MLK — demolish or repurpose
- City Planning Support**
High Point Planning Dept has expressed support for Multifamily Residential conversion
- Just Off Hwy 74**
Immediate access to US-74 — minutes from Downtown High Point
- Railroad Frontage**
Adjacent to active rail corridor — strong visibility
- Guilford County, NC**
High Point — growing market with strong multifamily demand

PROPERTY DETAILS

Asking Price
\$1,199,000
Total Acreage
4.13 Acres
Parcels
3 (sold together)
Industrial Bldg
46,000 SF
Zoning
Mixed Res. & Industrial
Railroad
Yes — adjacent
Highway Access
US-74 / Hwy 74
County
Guilford County
City
High Point, NC

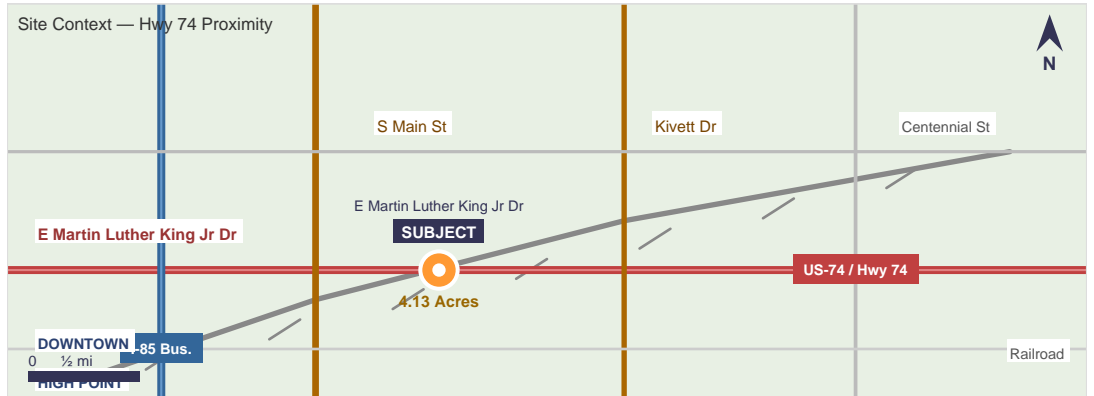

Rare 3-parcel, 4.13-acre assemblage on E Martin Luther King Jr Dr, High Point — 46,000 SF industrial building, mixed Residential & Industrial zoning. City of High Point Planning has expressed support for Multifamily Residential redevelopment. Priced at \$1,199,000.