

# ***AVALON OFFICE PARK***

## ***NEW OFFICE CONSTRUCTION***

**7806 E. 106th Street - Tulsa, OK**  
(E. 106th St. & S. Memorial Dr.)



| Demographics:  |           |           |          |
|----------------|-----------|-----------|----------|
| 2016           | 1 Mile    | 3 Miles   | 5 Miles  |
| Population     | 8,845     | 63,128    | 167,893  |
| Households     | 3,472     | 24,421    | 65,895   |
| Avg. HH Income | \$130,278 | \$119,639 | \$97,463 |

### Available Space:

**1,439 sq. ft.      706 sq. ft.**  
**Suite 205           Suite 204**

**Total Available: 2,145 sq. ft.**

- Great South Tulsa Location
- Signal Light access to S. Memorial
- Convenient to Shopping & Restaurants
- Immediately North of Lifetime Fitness

*Contact:*  
**Doug Bauer, CCIM**  
**918-665-1210**



**BAUER & ASSOCIATES, REALTORS**  
*"A Leader in Tulsa Commercial Real Estate Since 1979"*  
COMMERCIAL, INDUSTRIAL, INVESTMENT PROPERTY & PROPERTY MANAGEMENT  
4821 South Sheridan, Suite 201, Tulsa, Oklahoma 74145  
Phone (918) 665-1210 Fax (918) 665-6462 www.bauertulsa.com

All statements herein are for information purposes only and are believed to be reliable; however, no warranty or representation is made as to the accuracy thereof and the same is submitted subject to errors, omissions, change of price, terms, conditions and prior sale or lease.

**AVALON OFFICE PARK**  
**7806 E. 106th Street**  
**Tulsa, Oklahoma**

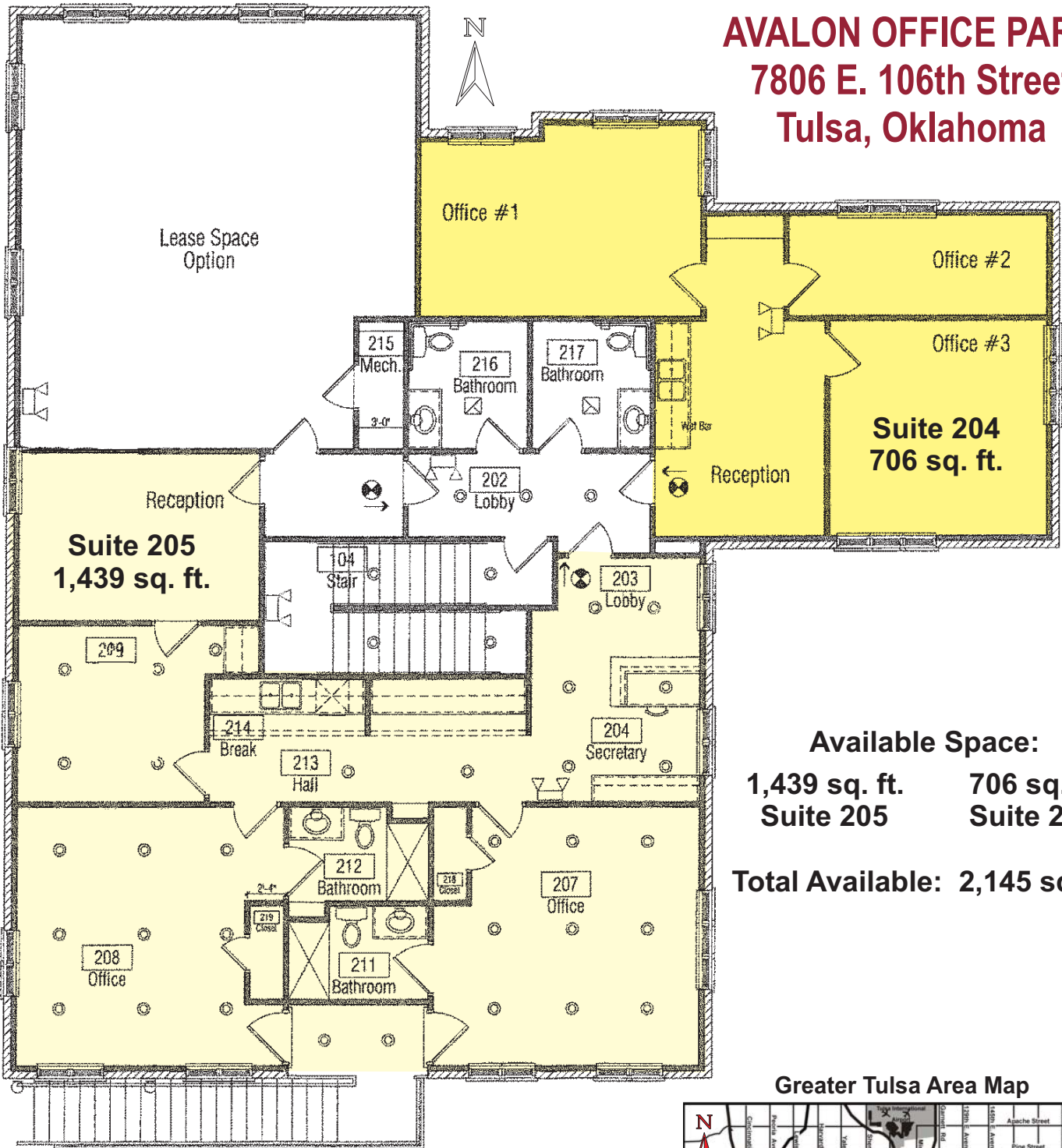

**Available Space:**  
**1,439 sq. ft.      706 sq. ft.**  
**Suite 205           Suite 204**  
**Total Available: 2,145 sq. ft.**

**Contact**  
**Doug Bauer, CCIM**  
**918-665-1210**

**BAUER & ASSOCIATES, REALTORS**  
**"A Leader in Tulsa Commercial Real Estate Since 1979"**  
**COMMERCIAL, INDUSTRIAL, INVESTMENT PROPERTY & PROPERTY MANAGEMENT**  
**4821 South Sheridan, Suite 201, Tulsa, Oklahoma 74145**  
**Phone (918) 665-1210      Fax (918) 665-6462      www.bauertulsa.com**

All statements herein are for information purposes only and are believed to be reliable; however, no warranty or representation is made as to the accuracy thereof and the same is submitted subject to errors, omissions, change of price, terms, conditions and prior sale or lease.

**Greater Tulsa Area Map**

