

Schnucks-Anchored with Long-Term Lease

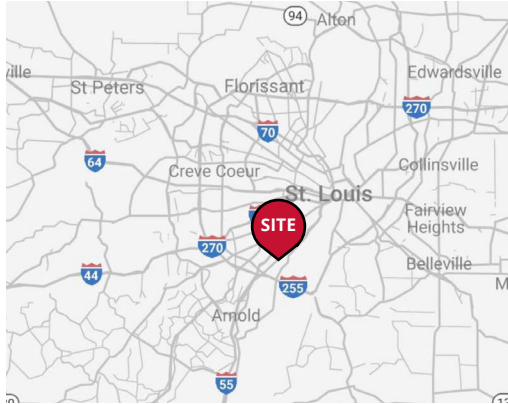

2025 DEMOGRAPHICS

1 Mile | 3 Miles | 5 Miles



Population

12,761 | 84,603 | 239,491



Daytime Population

7,253 | 48,471 | 142,333



Median Household Income

\$71,578 | \$70,954 | \$73,238

INLINE SPACE FOR LEASE | OUTLOT FOR SALE OR LEASE

Lemay Ferry Shopping Center

1032 Lemay Ferry Road | St. Louis, Missouri 63125

Inline Space Available: 6,400 SF (can be demised) | Lease Rate: Call for Details

Land Available: +/- 0.80 Acres | Call for Details

PROPERTY DETAILS

Grocery-anchored by Schnucks with long-term lease in place & recent renovation

Excellent population density

Inline space for lease

Outlot available for lease or sale

Richie Chappuis

314.785.7615

rchappuis@paceproperties.com

Lauren Berry, CCIM

314.785.7632

lberry@paceproperties.com

Ashley Krekovich

314.785.7613

akrekovich@paceproperties.com

PACEPROPERTIES.COM | 314.968.9898

1401 South Brentwood Boulevard, Suite 900 | St. Louis, Missouri 63144

The information contained herein is not warranted, although it has been obtained from the owner/landlord of the subject property or from other sources that Pace Properties, Inc. deems reliable, and is subject to change without notice. Owner/landlord and Pace Properties, Inc. make no representations as to the environmental condition of the subject property and recommend tenant's independent investigation.

Site Plan

Space	Status	SF
1	Schnucks	56,198
2	Fire Grill	1,629
3	ZaZa Smoke Shop	1,020
4	Dollar General	10,500
5	China King	1,600
6	AVAILABLE	6,400
7	Jackson Hewitt	1,200
8	Cricket	1,200

Click or scan to view virtual tours!



Space 6

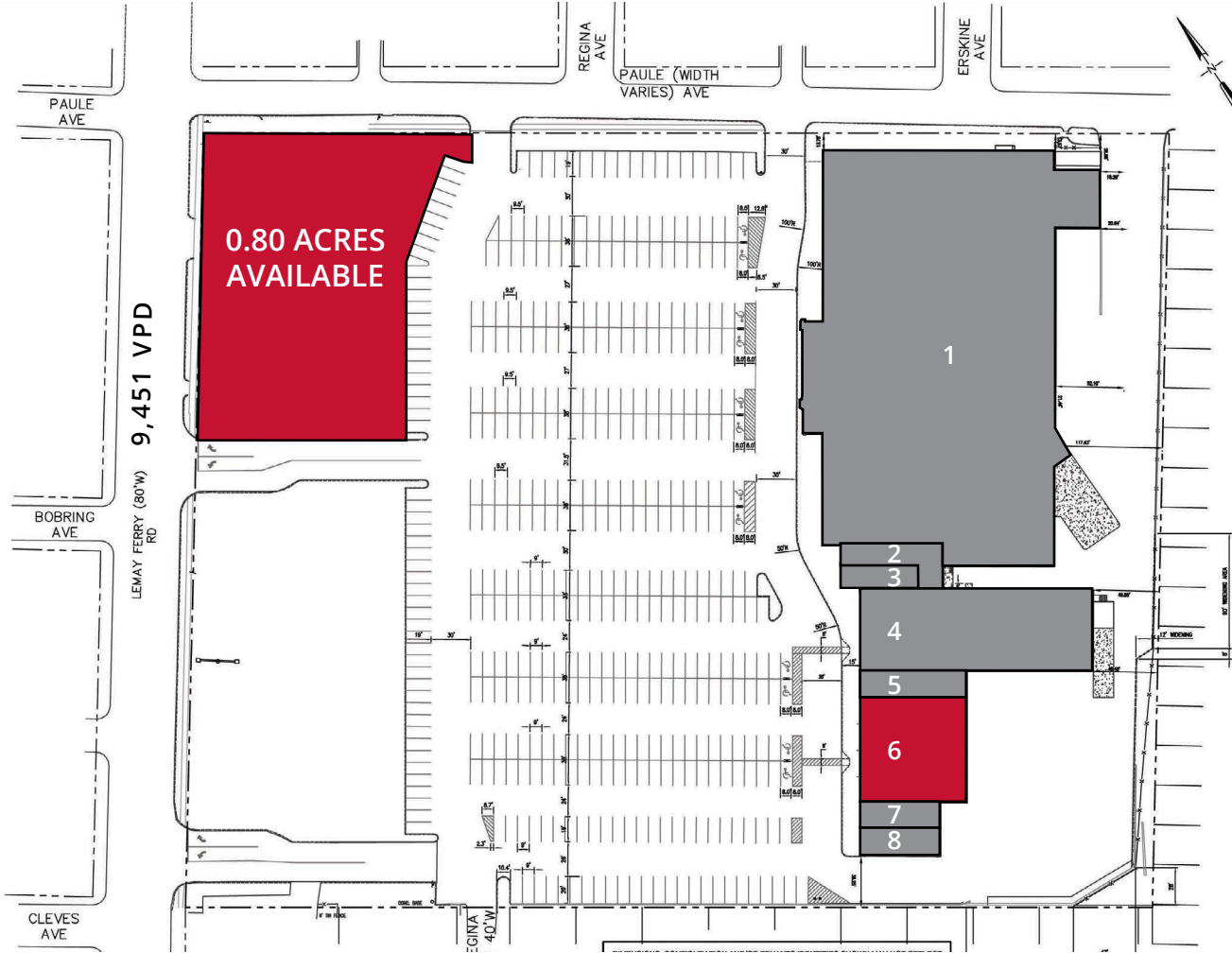

Land Available



PACEPROPERTIES.COM | 314.968.9898

1401 South Brentwood Boulevard, Suite 900 | St. Louis, Missouri 63144

The information contained herein is not warranted, although it has been obtained from the owner/landlord of the subject property or from other sources that Pace Properties, Inc. deems reliable, and is subject to change without notice. Owner/landlord and Pace Properties, Inc. make no representations as to the environmental condition of the subject property and recommend tenant's independent investigation.