

U.S. Highway 64

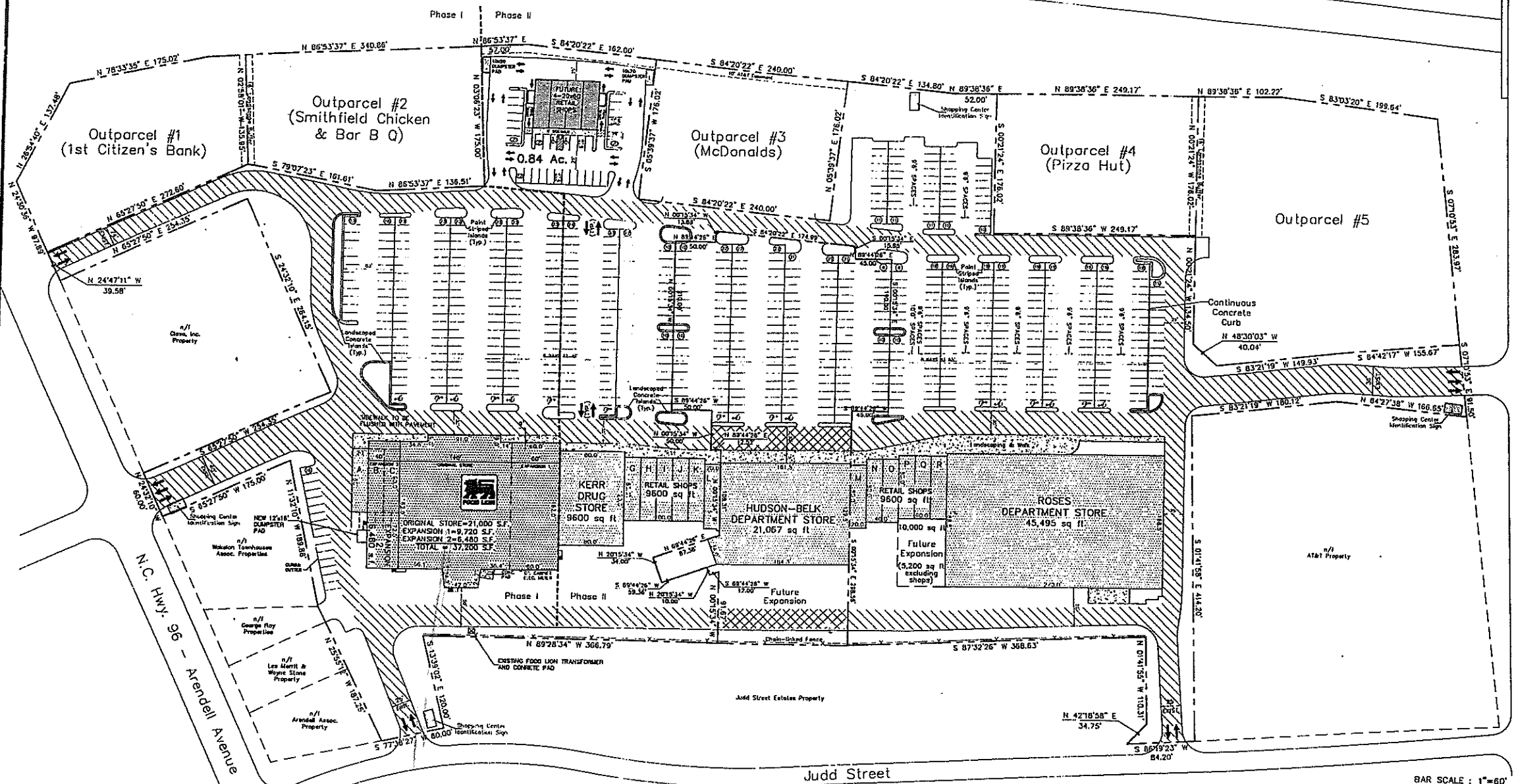

Gannon Avenue

N.C. Hwy. 96 - Arendell Avenue

Judd Street

**Notes:**  
 -The property described on this survey does not lie within a special flood hazard area as defined by the Federal Emergency Management Agency. The property lies within Zone X of the Flood Insurance Rate map identified as Community Panel #37183C0409E, bearing an effective date of March 3, 1992.  
 -Boundary information taken from map entitled Property survey for Bailey & Associates, Inc., dated November 25, 1985 surveyed by Williams, Pearce & Associates. Recorded in book of maps 1085 page 225R

Phase I	
Food Lion	- 21,000 sq ft
Expansion 1	- 9,720 sq ft
Expansion 2	- 6,480 sq ft
<b>Total</b>	<b>- 37,200 sq ft</b>
Parking Provided	185 spaces
Parking Ratio	5 sp/1,000 sq ft

Phase II	
Future Expansion	5,200 sq ft (excluding shops)

Total Development (Phase I & II)	
GLA Building Area	- 134,162 sq ft
Parking Provided	- 721 spaces
Parking Ratio	- 5.4 sp/1,000 sq ft

PERPETUAL EASEMENT GRANTED BY BAILEY & ASSOCIATES

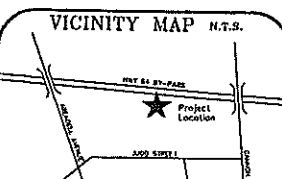

BAR SCALE : 1"=60'

# Triangle East Centre

Town of Zebulon  
 Wake County North Carolina  
 Date: April 3, 1999 Scale: 1"=60'

A Leasing Plan For:  
 Railey and Associates

REVISION 4 : 11-29-00 FOOD LION COMMENTS  
 REVISION 3 : 1-07-00 CORRECT BUILDING DIMENSIONS  
 REVISION 2 : 12-13-99 MODIFY FOOD LION ADDITION  
 REVISION 1 : 11-22-99 MODIFY FOOD LION ADDITION