

N104000
W36000

G3

GU 342

G4

U1

GU 121

GU 561

U1

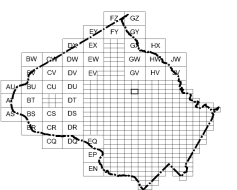
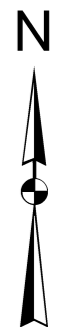
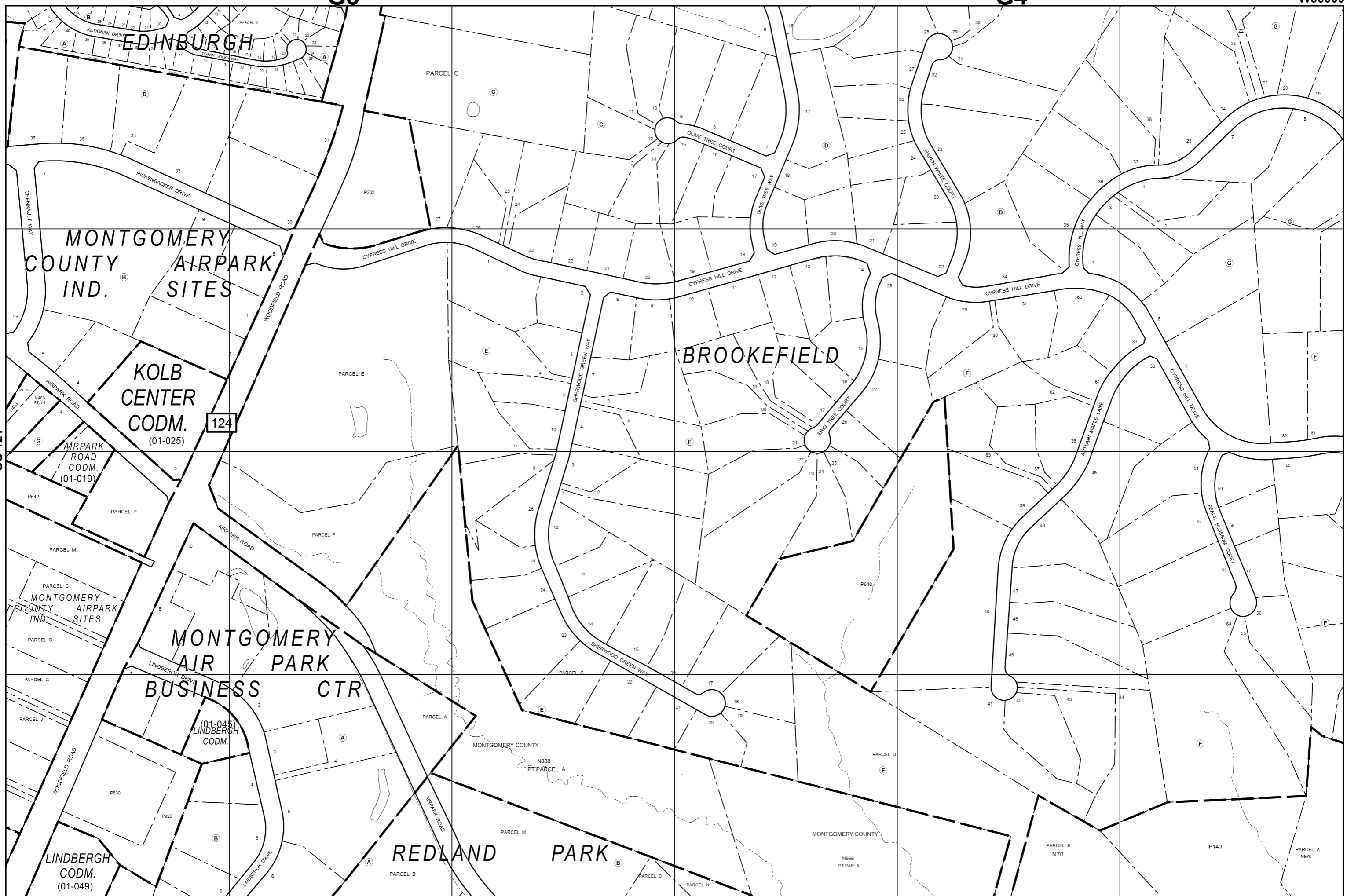

N100000
W42000

G3

GT 343

G4

COPYRIGHT - 1992 BY THE STATE OF MARYLAND. ALL RIGHTS RESERVED.

THESE MAPS ARE PROTECTED BY COPYRIGHT. THEY MAY NOT BE COPIED OR REPRODUCED IN ANY FORM INCLUDING ELECTRONIC MEANS SUCH AS DIGITIZING, SCANNING, VECTORING, IMAGE PROCESSING, OR BY ANY SYSTEM NOW KNOWN OR TO BE INVENTED WITHOUT PERMISSION IN WRITING FROM THE MARYLAND DEPARTMENT OF PLANNING.

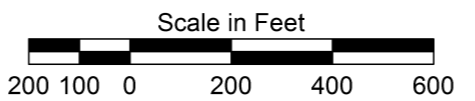

Compiled by: Maryland Department of Planning Property Mapping Section <small>The information shown on this map has been compiled from deed descriptions and plats and is not an actual survey. It should not be used for legal descriptions. Users noting errors are urged to notify the Maryland Department of Planning, Property Mapping Section, Room 1101, 301 W. Freston St., Baltimore, MD, 21201. Revised: AUG '15 RAM</small>	PROPERTY LINE SUBDIVISION MUNICIPAL BOUNDARY PRIVATE ROAD STREAM LINE CONTRIBUTING OWNERSHIP <small>PARCEL NUMBERING - P ### (ASSIGNED TO IDENTIFY OWNERSHIP MUST BE PRECEDED BY A MAP NUMBER)</small> 1 inch = 200 Feet (RF 1:2400)
--	---



MONTGOMERY COUNTY,
Maryland

MAP GU 341
W.S.S.C. 226 NW 07
Location: BROOKFIELD