

9,965 SF FOR LEASE IN 2-TENANT FREESTANDING BUILDING

NEC OF LOOP 101 & BELL RD | GLENDALE, AZ

JENNIFER HILL

Vice President of Leasing and Sales
602.616.4477
jhill@gpsaz.com

GREG SALTZ

President
480.231.3473
gsaltz@gpsaz.com



PROPERTY HIGHLIGHTS

- A+ Site on Dense Retail Corridor – Highly Desired Trade Area
- Pad located in front of Arrowhead Towne Center, 3rd highest volume regional mall in Arizona
- Outparcel shared with Skechers
- Excellent access from Loop 101, Bell Road and 75th Ave.
- Heavily trafficked with over 50,000 VPD at 77th Ave & Bell Rd.
- Major Retailers in the area include: Costco, Dick's Sporting Goods, Target, AMC Theatres, Nordstrom Rack, Ethan Allen

2023 DEMOS (5-MILE RADIUS)

| | |
|--------------------|----------------|
| TOTAL POPULATION | 299,755 |
| DAYTIME POPULATION | 279,763 |

TRAFFIC COUNTS

| | |
|-------------|--------------------|
| BELL ROAD | 50,740 VPD |
| 75TH AVENUE | 17,880 VPD |
| LOOP 101 | 104,649 VPD |

(ADOT '23)

9,965 SF FOR LEASE IN 2-TENANT FREESTANDING BUILDING
NEC OF LOOP 101 & BELL RD | **GLENDAL, AZ**



SITE AERIAL

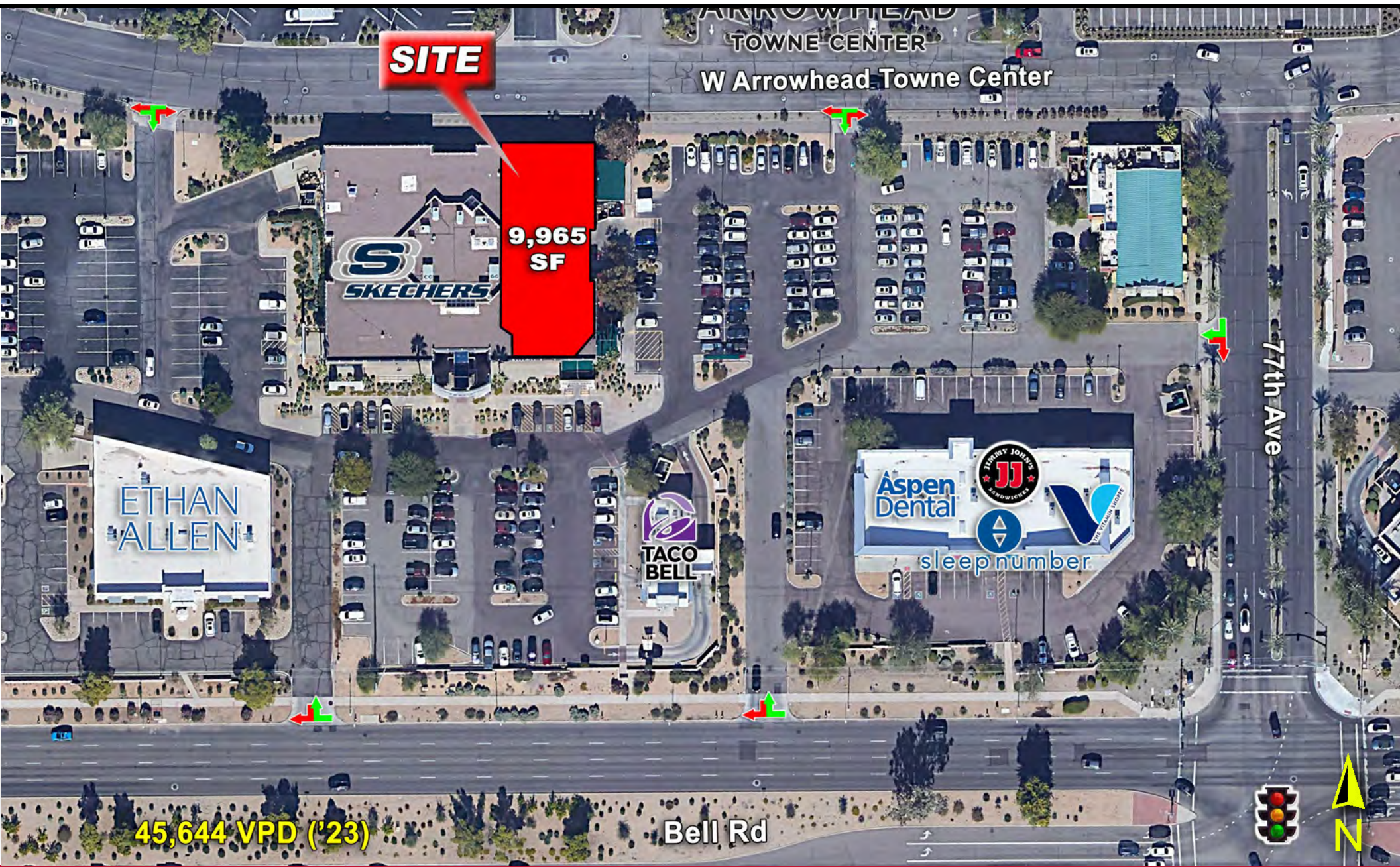

9,965 SF FOR LEASE IN 2-TENANT FREESTANDING BUILDING
NEC OF LOOP 101 & BELL RD | **GLENDALÉ, AZ**

PROPERTY PHOTOS

FLOOR PLAN

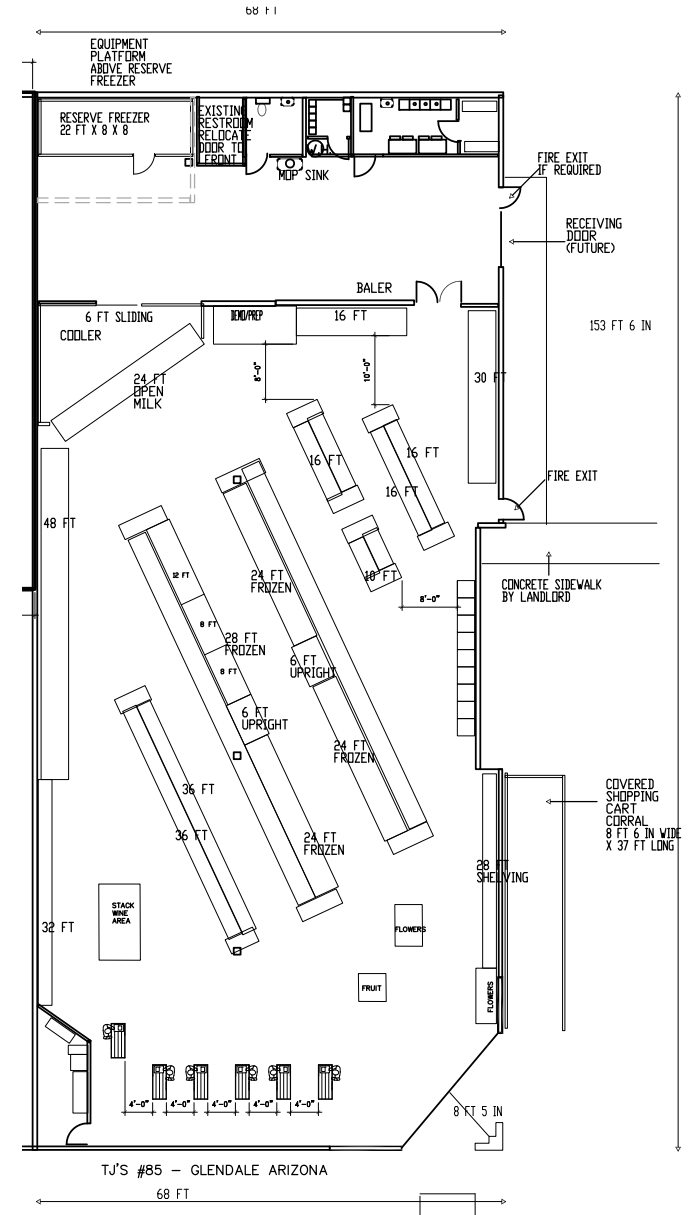

9,965 SF FOR LEASE IN 2-TENANT FREESTANDING BUILDING

NEC OF LOOP 101 & BELL RD | **GLENDALE, AZ**



DRONE VIEW



Peoria Sports Complex

Arrowhead Crossing

Bell Rd

50,740 VPD ('23)

TACO BELL

ETHAN ALLEN

TRADER JOE'S

SKECHERS

SITE

104,649 VPD ('22)

SPRINGHILL SUITES MARRIOTT

9,965 SF FOR LEASE IN 2-TENANT FREESTANDING BUILDING

NEC OF LOOP 101 & BELL RD | **GLENDALÉ, AZ**



DRONE VIEW



9,965 SF FOR LEASE IN 2-TENANT FREESTANDING BUILDING

NEC OF LOOP 101 & BELL RD | **GLENDALÉ, AZ**



INTERSECTION AERIAL

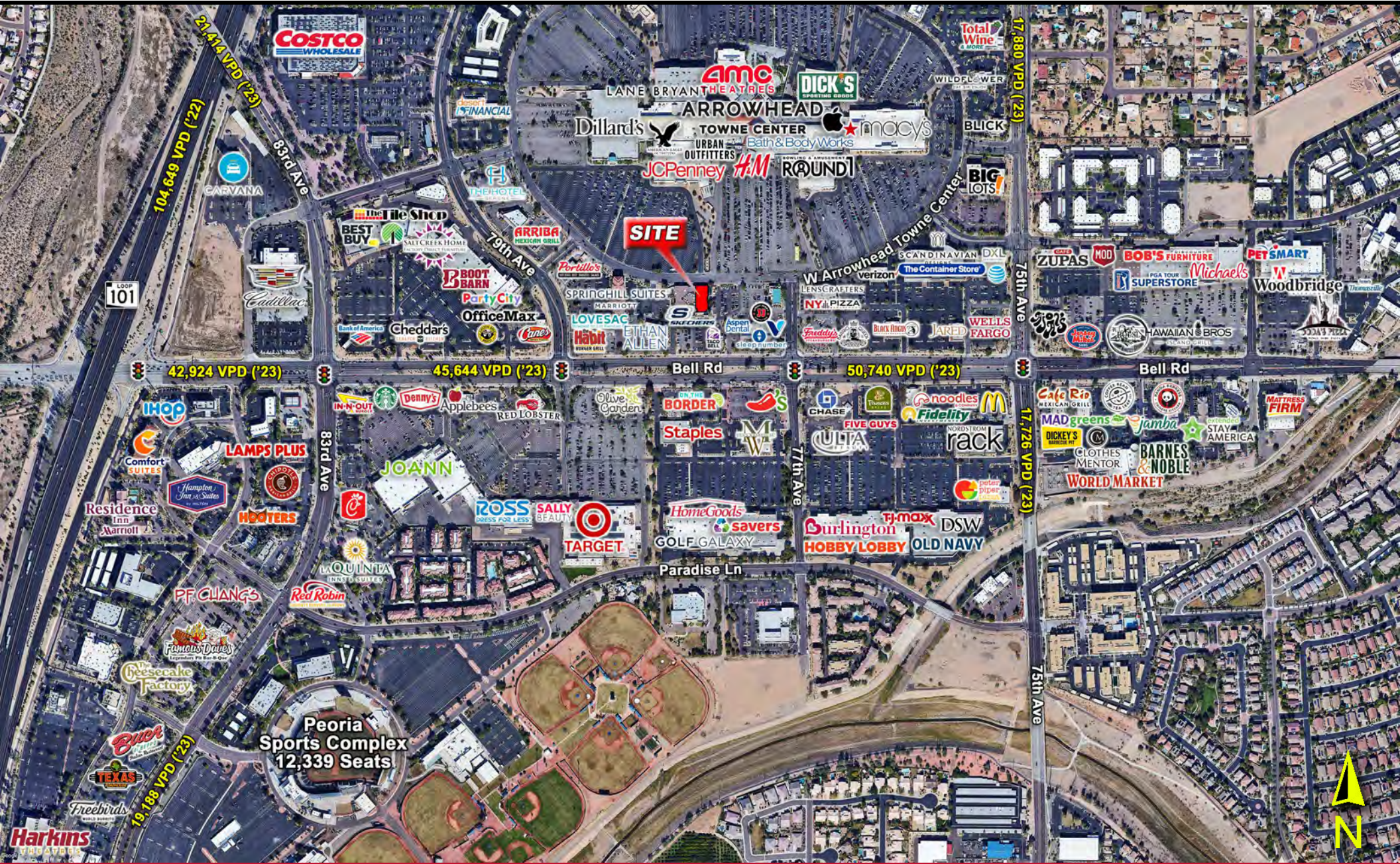

9,965 SF FOR LEASE IN 2-TENANT FREESTANDING BUILDING

NEC OF LOOP 101 & BELL RD | GLENDALE, AZ

DEMOGRAPHIC SNAPSHOT



| | 1 MILE | 3 MILE | 5 MILE |
|-----------------------|--------|---------|---------|
| 2023 Total Population | 9,638 | 111,642 | 299,755 |
| Daytime Population | 20,272 | 114,911 | 279,763 |



| | 1 MILE | 3 MILE | 5 MILE |
|-------------------|-----------|-----------|-----------|
| Average HH Income | \$104,209 | \$106,596 | \$101,382 |
| Median HH Income | \$81,123 | \$81,514 | \$76,782 |



| | 1 MILE | 3 MILE | 5 MILE |
|-------------------|--------|--------|---------|
| Daytime Employees | 15,896 | 58,186 | 119,751 |
| Daytime Residents | 4,376 | 56,725 | 160,012 |



| | 1 MILE | 3 MILE | 5 MILE |
|-----------------|--------|--------|---------|
| 2023 Households | 4,088 | 45,928 | 120,624 |
| 2028 Households | 4,093 | 46,370 | 121,004 |



| | 1 MILE | 3 MILE | 5 MILE |
|-------------------------|--------|--------|--------|
| Owner Occupied Housing | 40.4% | 64.4% | 68.9% |
| Renter Occupied Housing | 52.0% | 28.0% | 24.4% |



| | 1 MILE | 3 MILE | 5 MILE |
|-----------------|--------|--------|--------|
| 2023 Median Age | 36.4 | 45.8 | 45.7 |
| 2028 Median Age | 37.0 | 46.2 | 46.0 |

9,965 SF FOR LEASE IN 2-TENANT FREESTANDING BUILDING
 NEC OF LOOP 101 & BELL RD | **GLENDAL, AZ**

