



W. 14TH STREET

DAISY AVENUE

# Industrial Building FOR SUBLEASE

1350 Daisy Avenue | Long Beach, CA 90813

## FEATURES

- > AVAILABLE WAREHOUSE SPACE:
  - +/- 1,892 SF; or
  - +/- 1,954 SF; or
  - +/-3,374 SF; or
  - +/- 5,328 SF Warehouse Space
- > LOCATION: Near Ports of Long Beach and Los Angeles
- > LOCATION: Easy Access to 710 Freeway
- > POWER: 3 Phase, 120-240 Volts, 400 AMPS
- > CLEARANCE: 18'
- > Potential to Lease Office Space
- > Ground Level Doors: 1 - 3
- > Dock High Doors: 1

Lease Rate:

# \$0.95 Gross

*Utilities are shared. Location & number & type of loading doors depends on which part of property Tenant occupies.*



Contact us:

**Lary Carlton**

Senior Vice President  
DIR 562 547 8994  
lary.carlton@colliers.com

**Clint McMorris**

Senior Vice President  
DIR 310 321 1810  
clint.mcmorris@colliers.com  
Lic. No. 00414186



Colliers International  
2121 Rosecrans Ave | Suite 3301  
El Segundo, CA 90245  
P: +1 310 787 1000  
Lic. No. 01908231

This document has been prepared by Colliers International for advertising and general information only. Colliers International makes no guarantees, representations or warranties of any kind, expressed or implied, regarding the information including, but not limited to, warranties of content, accuracy and reliability. Any interested party should undertake their own inquiries as to the accuracy of the information. Colliers International excludes unequivocally all inferred or implied terms, conditions and warranties arising out of this document and excludes all liability for loss and damages arising there from. This publication is the copyrighted property of Colliers International and/or its licensor(s). ©2017. All rights reserved.

# SITE PLAN

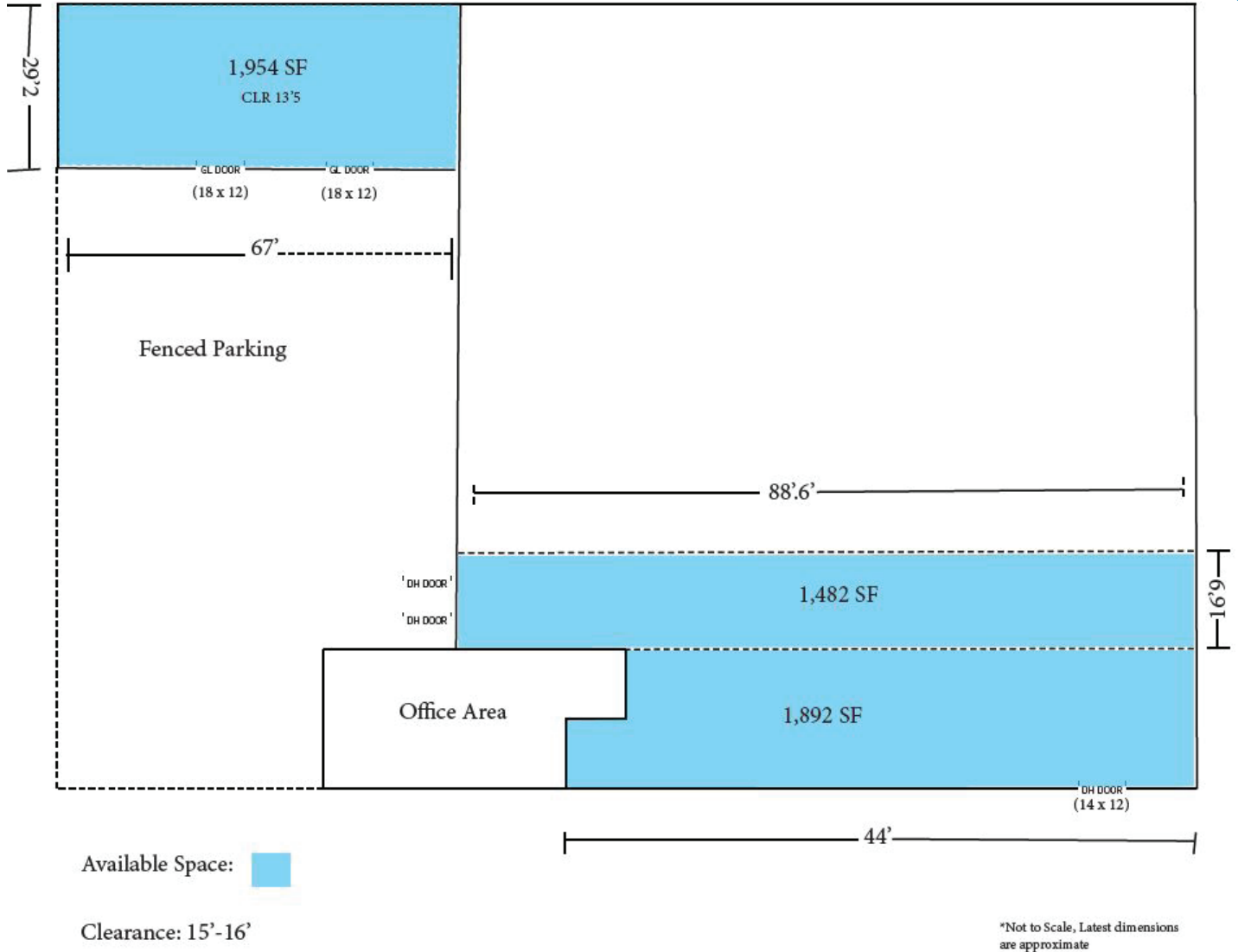

## Lary Carlton

Senior Vice President  
DIR 562 547 8994  
lary.carlton@colliers.com  
Lic. No. 01222308

## Clint McMorris

Senior Vice President  
DIR 310 321 1810  
clint.mcmorris@colliers.com  
Lic. No. 00414186

Colliers International  
2121 Rosecrans Avenue | Suite 3301  
El Segundo, CA 90245  
P: +1 310 787 1000  
Lic. No. 01908231

## Accelerating success.

This document has been prepared by Colliers International for advertising and general information only. Colliers International makes no guarantees, representations or warranties of any kind, expressed or implied, regarding the information including, but not limited to, warranties of content, accuracy and reliability. Any interested party should undertake their own inquiries as to the accuracy of the information. Colliers International excludes unequivocally all inferred or implied terms, conditions and warranties arising out of this document and excludes all liability for loss and damages arising there from. This publication is the copyrighted property of Colliers International and/or its licensor(s). ©2017. All rights reserved.



LONG BEACH  
AIRPORT

SITE

PORT OF  
LOS ANGELES

PORT OF  
LONG BEACH



**Lary Carlton**

Senior Vice President  
DIR 562 547 8994  
lary.carlton@colliers.com  
Lic. No. 01222308

**Clint McMorris**

Senior Vice President  
DIR 310 321 1810  
clint.mcmorris@colliers.com  
Lic. No. 00414186

**Colliers International**  
2121 Rosecrans Avenue | Suite 3301  
El Segundo, CA 90245  
P: +1 310 787 1000  
Lic. No. 01908231

**Accelerating success.**

This document has been prepared by Colliers International for advertising and general information only. Colliers International makes no guarantees, representations or warranties of any kind, expressed or implied, regarding the information including, but not limited to, warranties of content, accuracy and reliability. Any interested party should undertake their own inquiries as to the accuracy of the information. Colliers International excludes unequivocally all inferred or implied terms, conditions and warranties arising out of this document and excludes all liability for loss and damages arising there from. This publication is the copyrighted property of Colliers International and/or its licensor(s). ©2017. All rights reserved.