

AUGUSTA POB II SPEC SUITE 305 | 2,065 USF

818 SEBASTIAN WAY
AUGUSTA, GA 30901



SCAN TO LEARN MORE ABOUT THIS LISTING

Seafoam

LEASE THIS MODERN, MOVE-IN READY MEDICAL SUITE

Lease Your Move-In Ready SPEC Suite Today

Our SPEC suites combine convenience and quality in one perfect package. With sleek, modern finishes already in place, these suites are designed to be fully operational as soon as you move in. **Skip the hassle and delays of construction and permitting**—just move in and start seeing patients!

IMAGE IS A REPRESENTATION. ACTUAL SUITE MAY DIFFER.



FOR LEASING INFORMATION, CONTACT:

REGIONAL LEASING DIRECTOR: Erreca White | erreca.white@lillibridge.com / 706.373.2889

SPEC SUITE - SEAFOAM FINISH PALETTE

SUITE 305 | 2,065 USF
AUGUSTA POB II

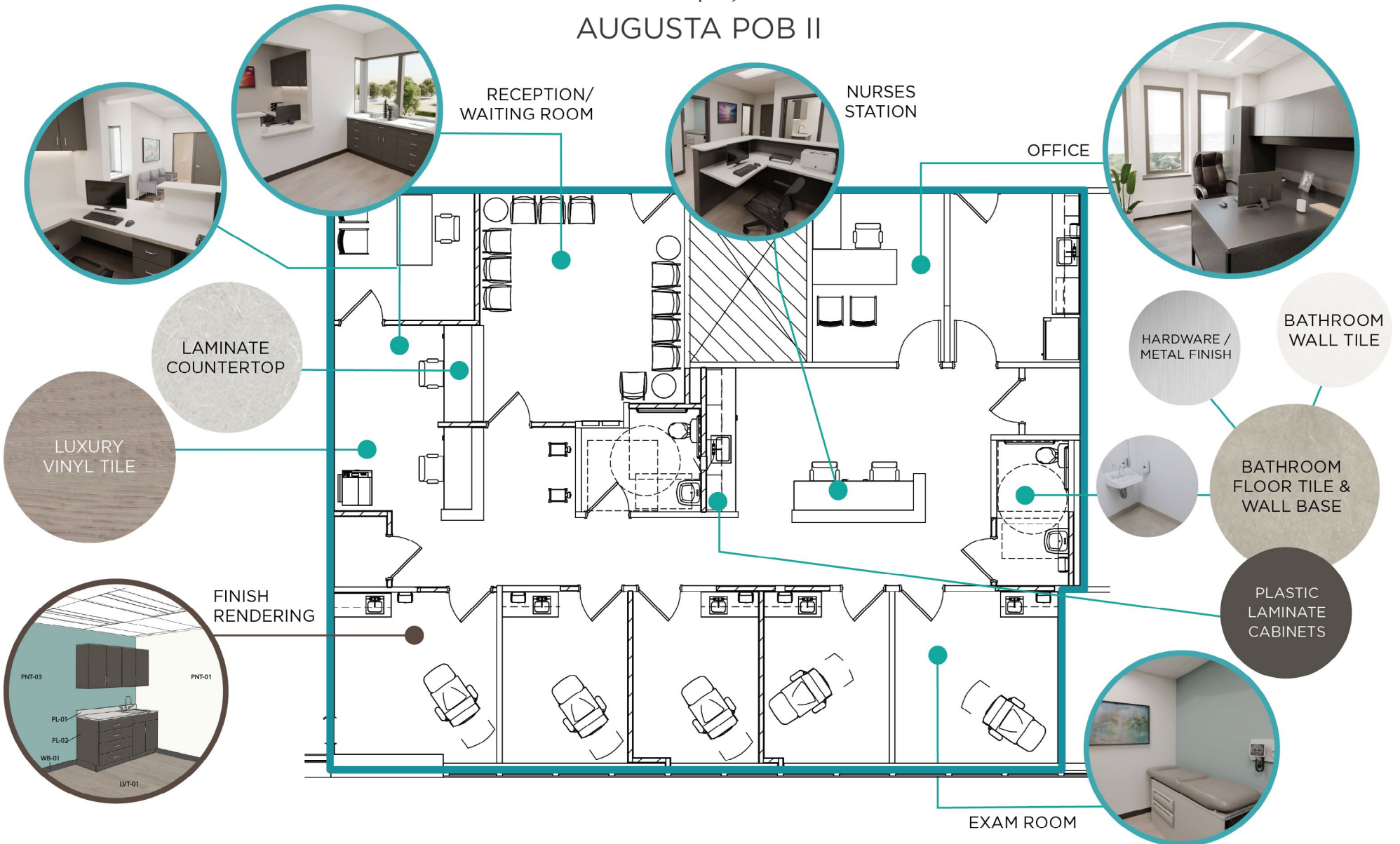

COLOR PALETTE

PNT-01:
OVERALL PAINT

PNT-02:
ACCENT PAINT - OFFICE

PNT-03:
ACCENT PAINT - PATIENT ROOM

PNT-04:
DOOR FRAME PAINT

PHOTOS AND RENDERINGS DEPICT FINISHES AND COLOR SCHEME, NOT THE ACTUAL SUITE.