



Envision
PHYSICIAN SERVICES

5380

Sublease

Bay Vista Pavilion - Tower I

5380 Tech Data Drive
Clearwater, FL 33760



Bay Vista Pavilion - Tower I

5380 Tech Data Drive
Clearwater, FL 33760

**Full building, up to 70,353 SF
available for sublease**

- Floor 1: 23,326 SF
- Floor 2: 22,553 SF
- Floor 3: 24,474 SF
- Sublease through 04/30/2028
- Available immediately
- Furniture negotiable
- Recent build-out

Tower I sublease includes:

- Ground floor fitness center, cafe and training center
- Conference rooms
- Private rooms
- Collaboration areas

Building features and amenities:

- Two-story atrium/lobby
- Back-up generators
- 5.00/1,000 SF parking ratio
- Close proximity to two airports

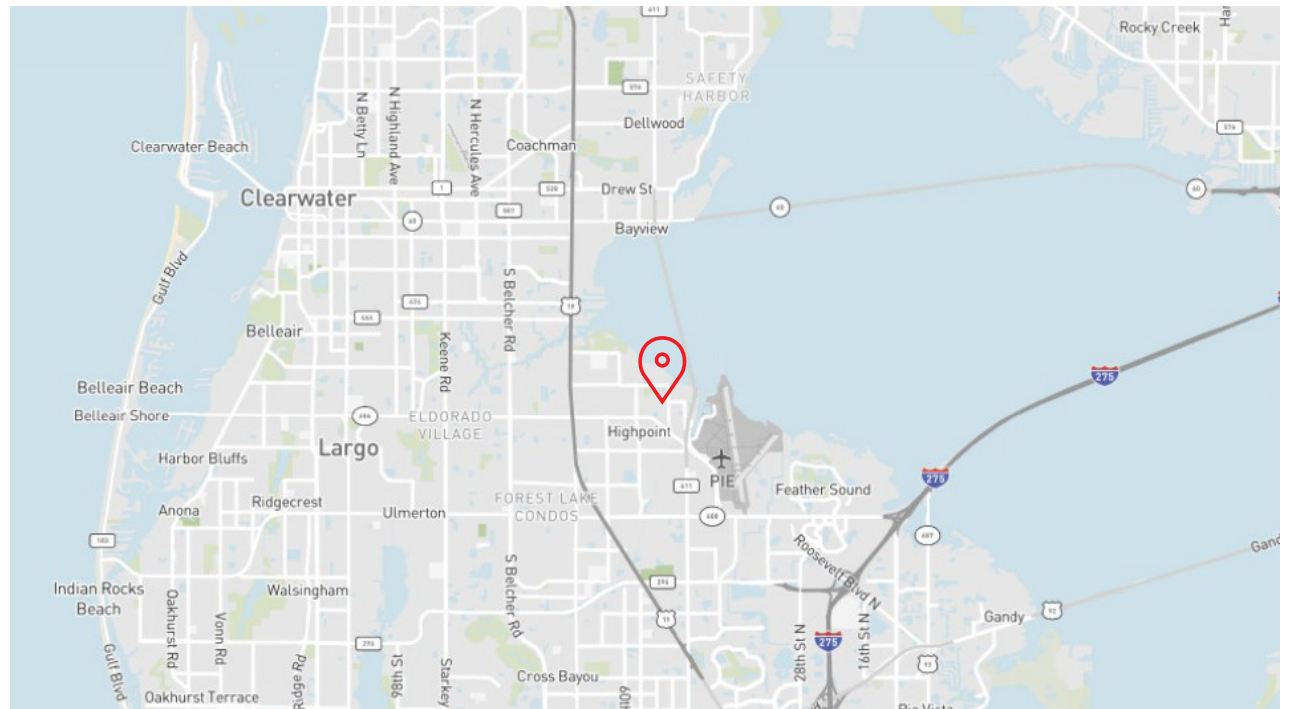



Bay Vista Pavilion - Tower I

5380 Tech Data Drive
Clearwater, FL 33760





Bay Vista Pavilion - Tower I

5380 Tech Data Drive
Clearwater, FL 33760

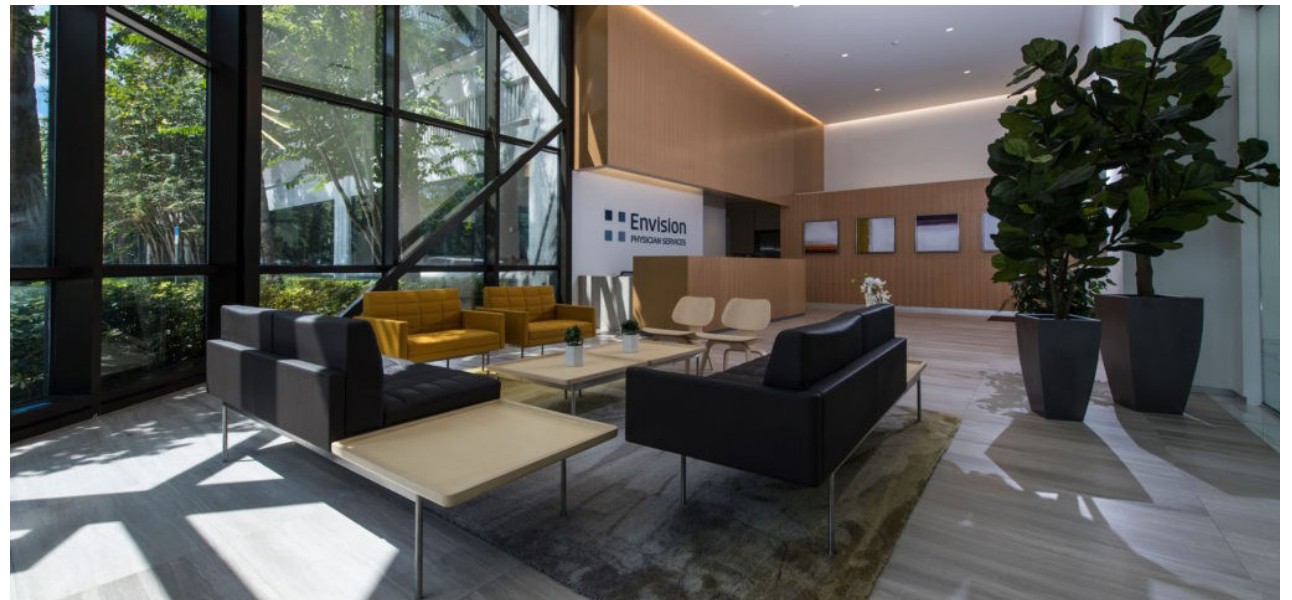



Bay Vista Pavilion common area

5380 Tech Data Drive
Clearwater, FL 33760

Hans Kaunath

Vice President

+1 813 387 1309

Hans.Kaunath@am.jll.com

Lisa Coulter

Vice President

+1 813 387 1319

LisaA.Coulter@am.jll.com



DISCLAIMER Jones Lang LaSalle Brokerage, Inc., a licensed real estate broker

Although information has been obtained from sources deemed reliable, JLL does not make any guarantees, warranties or representations, express or implied, as to the completeness or accuracy as to the information contained herein. Any projections, opinions, assumptions or estimates used are for example only. There may be differences between projected and actual results, and those differences may be material. JLL does not accept any liability for any loss or damage suffered by any party resulting from reliance on this information. If the recipient of this information has signed a confidentiality agreement with JLL regarding this matter, this information is subject to the terms of that agreement. Images courtesy of CoStar. ©2022. Jones Lang LaSalle Brokerage, Inc. All rights reserved.

** The outbreak of the COVID-19 virus (novel coronavirus) since the end of January 2020 has resulted in market uncertainty and volatility. While the economic impact of a contagion disease generally arises from the uncertainty and loss of consumer confidence, its impact on real estate values is unknown at this stage. Given the prevailing domestic and global uncertainty arising from the Coronavirus, we recommend that the intended recipients of this information regularly seek our guidance.