



# Mill Lane Trade Park

LIVERPOOL - L13 4BF



# TO LET

INDUSTRIAL/WAREHOUSE  
UNITS FROM 500 SQFT  
TO 2,000 SQFT

## Introduction

Mill Lane Trade Park is a new development offering a range of individual units. The scheme is self contained within a secure fenced yard and will be managed to a high standard.

## Specification and Key Features

- Constructed in mainly two terraces with car parking in front on vehicle circulation yards.
- High standard construction with part brick and part clad elevations.
- Jumbo stud party walls.
- Varying eaves heights from 4.00 metres to 6.50 metres.
- Steel roller shutter doors.
- 3 Phase electricity capacity.
- Fully fitted accessible toilet.





# M

## Mill Lane Trade Park

Mill Lane Trade Park is very conveniently located opposite Rathbone Hospital on Wylam Road, Old Swan, Liverpool. There is easy access to Liverpool City centre via Edge Lane or to the wider region via the M62 motorway which is about half a mile away.

**Sat Nav reference:**  
**L13 4BF**

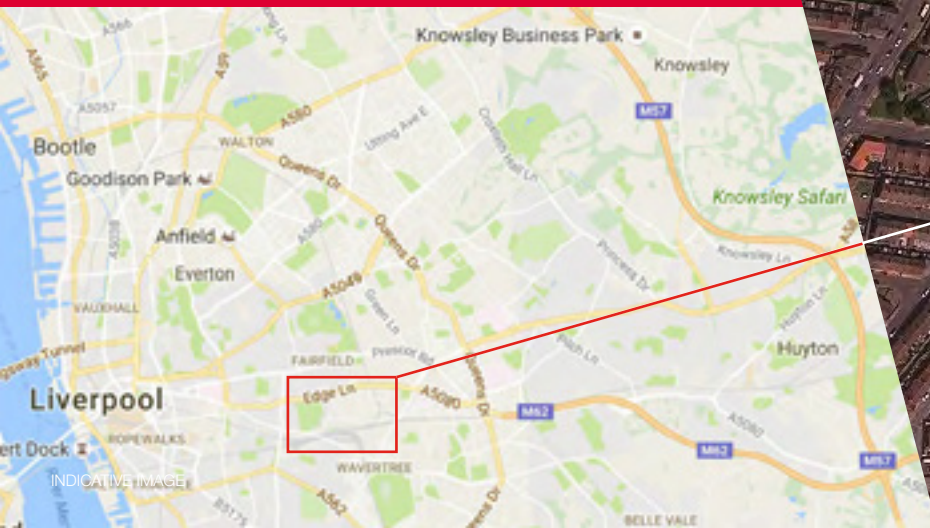

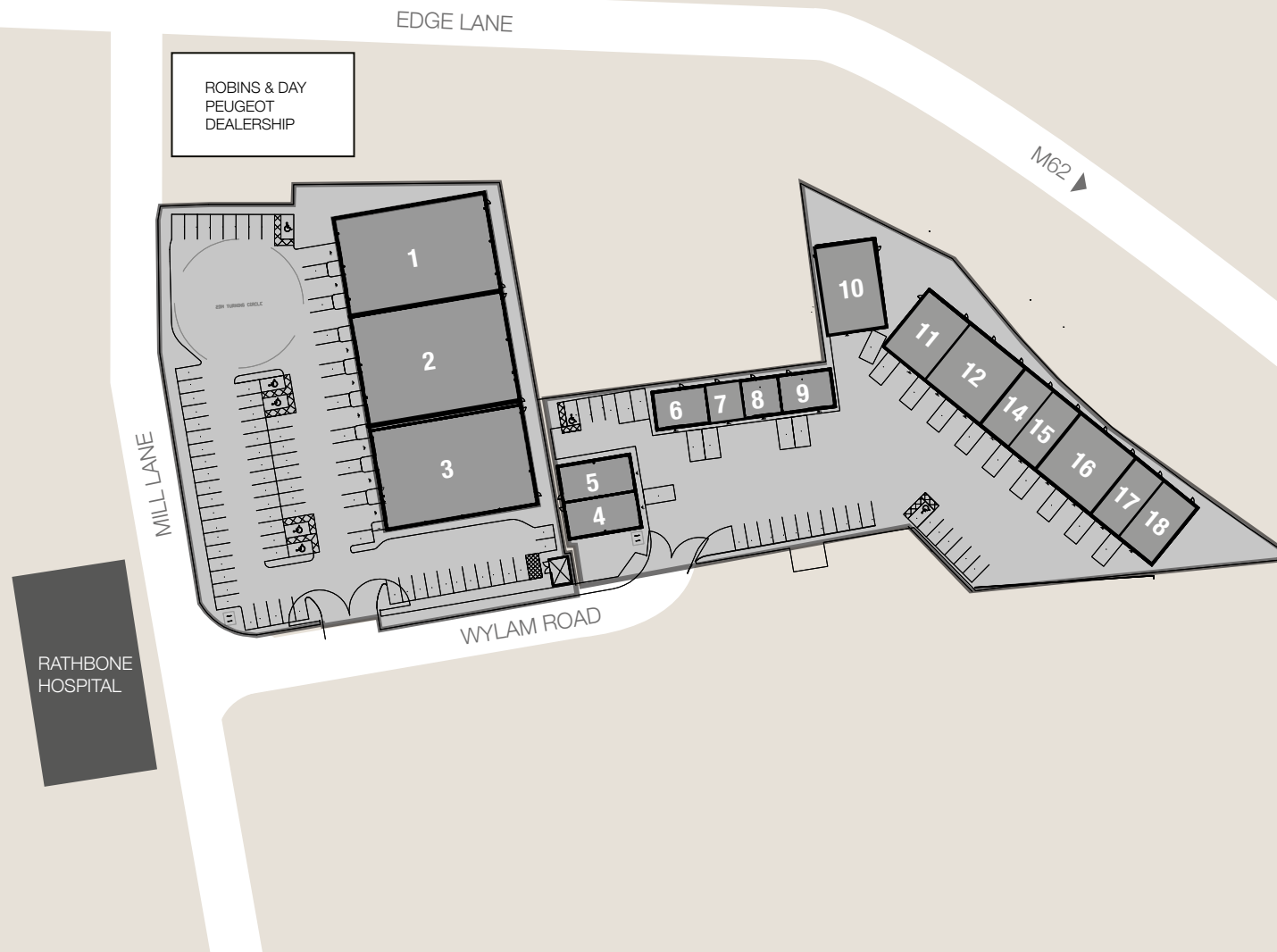



# M

## Mill Lane Trade Park

For enquiries and further  
information please contact:

Graeme Wood  
Stratos pdi Consultants  
T: 01565 632 482  
E: [graeme@stratospdi.com](mailto:graeme@stratospdi.com)

stratos<sub>pdi</sub>

01565 632 482

Owned by



0161 703 7992

Managed by



0845 838 7627



TERMS  
Units are available on a  
new FRI lease on a term  
to be agreed.

RENT  
Upon application.

PROPERTY MISDESCRIPTIONS ACT: At the time of printing the contents of this brochure were believed to be correct but cannot be guaranteed and are expressly excluded from any contract. November 2016.