

KEY NOTES	
1.0 FLOOR PLANS	
1.1 SUITE PLACQUE T.O.P. @ 66" A.F.F.	
1.2 CHART RACK T.O.P. @ 60" A.F.F.	
1.3 COAT HOOK T.O.H. @ 72" A.F.F.	
1.4 SHELVES: 5 ADJ. MELAMINE SHELVES 16" DEEP U.N.O.	
1.5 SHELF & ROD: MELAMINE	
1.6 SHELF & ROD: PLASTIC LAMINATE	
1.7 SPECMAN PASS-THRU	
1.8 ALIGN SURFACE WITH ADJACENT SURFACE	
1.9 FURN. QTY. AS SHOWN	
1.10 CROWN: 2" DIAMETER U.N.O.	
1.11 HEADER: FIN. GYP. BD. HEADER @ 6'-10" A.F.F. U.N.O.	
1.12 SOFFIT: FIN. GYP. BD. SOFFIT-SEE PLAN FOR HT.	
1.13 6" STUD WALL	
1.14 TELEPHONE BACKBOARD: 2" W. x 4" H. 3/4" FRUITRATED AC PLYWOOD w/BTL @ 2" A.F.F. PAINT TO MATCH ADJ. WALL COLOR	
1.15 GRAB BARS: INSTALL PER LOCAL HCP. BLDG. CODE	
1.16 CURTAIN TRACKS: SEE PLAN FOR SIZE & TYPE	
1.17 ELECTRICAL PANEL: SEE SHEET A-233.1 FOR PANELBOARD SCHEDULE	
2.0 INTERIOR ELEVATIONS	
2.1 COUNTERTOP: PLASTIC LAMINATE	
2.2 APRON: PLASTIC LAMINATE (CONT.)	
2.3 CLEAT: WOOD (CONT.)	
2.4 BACKSLASH: 4" PLASTIC LAMINATE (CONT.)	
2.5 END PANEL: PLASTIC LAMINATE	
2.6 FILLER PANEL: PLASTIC LAMINATE	
2.7 BRACKET: 10" x 18" PLASTIC LAMINATE	
2.8 RUBBER CODE BASE: SEE FINISH SCHEDULE	
2.9 SLIDING GLASS WINDOW: SEE SPECIFICATIONS	
2.10 MIRROR: SEE SPECIFICATIONS	
2.11 UNDER COUNTER REFRIGERATOR SPACE	
2.12 FINISHED GYP. BD. OPENING	
2.13 TYPewriter DROP: 24" W. @ 27" A.F.F. U.N.O.	
2.14 WRITING SURFACE: 12" W. PLASTIC LAMINATE CENTER ON WALL @ 42" A.F.F.	
2.15 SHELVES: 12" W. PLASTIC LAMINATE w/MTL STANDARDS	
2.16 SHELVES: 12" W. PLASTIC LAMINATE w/PLASTIC LAMINATE CLEAT & APRON	
2.17 LOCKS: FOR CABINETS (SHEET 2 KEYS)	
3.0 MISCELLANEOUS	
3.1 RECESS MOUNTED VIEW BOX: SUPPLIED & INSTALLED BY OWNER	
3.2 FLOOR DRAIN: JR. SMITH #2010-A-F37 OR EQUAL DOES NOT EXCEED 75" AND BE AT 48" A.F.F.	

NOTES:  
1. MODIFY SPRINKLER SYSTEM AS NECESSARY TO COMPLY WITH N.F.P.A. 13.  
2. PROVIDE ONE 2A10BC FIRE EXTINGUISHER, FIRE EXTINGUISHER SHALL BE MOUNTED SO THAT TRAVEL DISTANCE FROM ANY POINT IN THE SUITE DOES NOT EXCEED 75' AND BE AT 48" A.F.F.

**GENERAL NOTES**

- DIMENSIONS IN PLAN ARE FROM FACE TO FACE OF FINISHED WALL AND DIMENSIONS IN ELEVATION ARE FROM FACE TO FACE OF FINISHED MATERIAL U.N.O.
- SEE KEY PLAN BELOW AND BASE BUILDING FLOOR PLAN SHEET A-2 FOR SUITE LOCATION.
- SEE SUITE TITLE SHEET FOR WALL TYPES & CONSTRUCTION.
- SEE SUITE TITLE SHEET FOR DOOR TYPES.
- SEE SUITE TITLE SHEET FOR ABBREVIATIONS & SYMBOLS.
- SEE INTERIOR FINISH KEY ON SUITE TITLE SHEET FOR STANDARD FINISH DESIGNATIONS.
- SEE BASE BUILDING SPECIFICATIONS FOR STANDARD UMB REQUIREMENTS.
- PLUMBING FIXTURE TYPES ARE INDICATED ON PLAN. SEE SPEC FOR TYPES INDICATED. PROVIDE A COMPLETE OPERATING SYSTEM, COMPLYING WITH WATER DEPARTMENT REQUIREMENTS & LATEST EDITION OF STATE & LOCAL CODES.
- LIGHT FIXTURE TYPES ARE INDICATED ON REFLECTED CEILING LIGHTING PLAN. SEE SPEC FOR TYPES INDICATED.
- O.C. TO NOTIFY UMB DURING CONSTRUCTION IF THE LOCATION OF EXISTING OR PROPOSED PARTITIONS VARIES BY MORE THAN 1" FROM THE DIMENSIONS SHOWN.
- O.C. TO INSTALL BLOCKING FOR ALL CABINETS, WALL-HUNG ACCESSORIES & EQUIPMENT, AND ALL OWNER SUPPLIED ITEMS AS SHOWN ON THE DRAWINGS OR AS REFERRED TO IN THE SPECIFICATIONS.
- CONTINUOUS PLASTIC LAMINATE BACKSLASHES SHALL BE INSTALLED ON ALL BASE CABINETS CONTAINING SINKS, AND SHALL RETURN AT ALL CONDITIONS WHERE COUNTERTOP ABUTTS A WALL.
- WHERE REQUIRED BY CODE, FIRE EXTINGUISHERS SHALL BE PROVIDED & INSTALLED BY THE TENANT.
- ALL CASEWORK CONFIGURATIONS ARE PER UMB STANDARDS, OR PER 'CASE SYSTEMS' MANUFACTURER.
- CABINET MAKER TO FIELD VERIFY ALL DIMENSIONS. IN THE EVENT OF ANY DISCREPANCIES, NOTIFY UMB PRIOR TO FABRICATION.
- ALL NEW D.W.V. PIPING TO BE METAL, NO PLASTIC.

NOTE:  
ALL RECEPTACLES IN ALL ROOMS WHERE PATIENTS RECEIVE CARE SUCH AS EXAMS, TREATMENT ROOMS, ETC. SHALL BE GROUNDED IN ACCORDANCE WITH NEC 517-13. ROOM NUMBERS: 203, 204, 205, 207, 209, 215, 218 & 219.

ROOM FINISH SCHEDULE												
NO.	ROOM NAME	FLOOR	WALLS				CEILING		CABINETS		NOTES	
			FINISH	BASE	NORTH	SOUTH	EAST	WEST	FINISH	H'GHT		C'TOP
201	WAITING	C-	RB-	WC-	WC-	WC-	CF-2					
202	WORK ROOM	VT-		P-1	P-1	P-1	CF-2	PL-	PL-	PL-		
203	PHONES	C-		WC-	WC-	WC-	CF-2	PL-	PL-	PL-		
204	INSURANCE	C-		WC-	WC-	WC-	CF-2	PL-	PL-	PL-		
205	CORRIDOR	C-		WC-	WC-	WC-	CF-2					
206	COPY ROOM	C-		P-1	P-1	P-1	CF-2	PL-	PL-	PL-		
207	CHECK-IN	C-		WC-	WC-	WC-	CF-2	7'-3"	PL-	PL-	PL-	
208	FILES	C-		WC-	WC-	WC-	CF-2					
209	CHECK-OUT	C-		WC-	WC-	WC-	CF-2					
210	SCHEDULING	C-		WC-	WC-	WC-	CF-2	7'-3"	PL-	PL-	PL-	
211	CORRIDOR	C-		WC-	WC-	WC-	CF-2					
212	NURSE STATION	VT-		WC-	WC-	WC-	CF-2	7'-3"	PL-	PL-	PL-	
213	CORRIDOR	C-		WC-	WC-	WC-	CF-2					
214	ASST. OFFICE MGR.	C-		WC-	WC-	WC-	CF-2					
215	PATIENT TOILET	CT-	CT-	AP-1	AP-1	AP-1	CF-2					*WAINSCOT CT- TO 52" AFF
216	OFFICE MGR.	C-	RB-	WC-	WC-	WC-	CF-2					
217	MEDICINES	VT-		WC-	WC-	WC-	CF-2	PL-	PL-	PL-		
218	CONFERENCE	C-		WC-	WC-	WC-	CF-2					
219	TOILET	CT-	CT-	AP-1	AP-1	AP-1	CF-2					*WAINSCOT CT- TO 52" AFF
220	CONSULT	C-	RB-	WC-	WC-	WC-	CF-2					
221	SUPPLY	VT-		P-1	P-1	P-1	CF-2					
222	NURSE STATION	VT-		WC-	WC-	WC-	CF-2	PL-	PL-	PL-		
223	CORRIDOR	C-		WC-	WC-	WC-	CF-2					
224	CONSULT	C-		WC-	WC-	WC-	CF-2					
225	ECHO VIEWING	VT-		P-1	P-1	P-1	CF-2	PL-	PL-	PL-		
226	COAT CLOSET	VT-		WC-	WC-	WC-	CF-2					
227	CONSULT	C-		WC-	WC-	WC-	CF-2					
228	CONSULT	C-		WC-	WC-	WC-	CF-2					
229	STAFF LOUNGE	VT-		P-1	P-1	P-1	CF-2	PL-	PL-	PL-		
230	COAT CLOSET	VT-		P-1	P-1	P-1	CF-2					
231	COAT CLOSET	VT-		P-1	P-1	P-1	CF-2					
232	SUPPLY	VT-		P-1	P-1	P-1	CF-2					
233	SUPPLY/EXAM	VT-		P-1	P-1	P-1	CF-2	PL-	PL-	PL-		
234	CORRIDOR	C-		WC-	WC-	WC-	CF-2					
235	EXAM	VT-		P-1	P-1	P-1	CF-2	PL-	PL-	PL-		
236	EXAM	VT-		P-1	P-1	P-1	CF-2	PL-	PL-	PL-		
237	EXAM	VT-		P-1	P-1	P-1	CF-2	PL-	PL-	PL-		
238	EXAM	VT-		P-1	P-1	P-1	CF-2	PL-	PL-	PL-		
239	SUPPLY	VT-		P-1	P-1	P-1	CF-2					
240	SUPPLY	VT-		P-1	P-1	P-1	CF-2					
241	CORRIDOR	C-		WC-	WC-	WC-	CF-2					
242	EXAM	VT-		P-1	P-1	P-1	CF-2	PL-	PL-	PL-		
243	EXAM	VT-		P-1	P-1	P-1	CF-2	PL-	PL-	PL-		
244	EXAM	VT-		P-1	P-1	P-1	CF-2	PL-	PL-	PL-		
245	PATIENT EDUCATION	C-		WC-	WC-	WC-	CF-2					
246	SUB-WAIT	C-		WC-	WC-	WC-	CF-2					
247	TOILET	CT-	CT-	AP-1	AP-1	AP-1	CF-2					*WAINSCOT CT- TO 52" AFF
248	HOLTER PREP.	VT-	RB-	WC-	WC-	WC-	CF-2	PL-	PL-	PL-		
249	HOLTER VIEWING	VT-		P-1	P-1	P-1	CF-2	PL-	PL-	PL-		
250	FILM FILES	VT-		P-1	P-1	P-1	CF-2					
251	NON-INV. LAB	VT-		WC-	WC-	WC-	CF-2	PL-	PL-	PL-		
252	NON-INV. LAB	VT-		WC-	WC-	WC-	CF-2	PL-	PL-	PL-		
253	CORRIDOR	C-		WC-	WC-	WC-	CF-2					

Handwritten calculations:  
 $7'5\frac{1}{2} \times 1'6" = 11.19$   
 $10' \times 20'8" = 17.16$   
 $9' \times 6" = 4.5$   
 $11.19 + 17.16 - 4.5 = 32.85$   
 32'-3 1/2"  
 1024  
 21' x  
 78'-5"  
 4'-9"  
 11'-5 1/2"  
 53'-7 1/2"

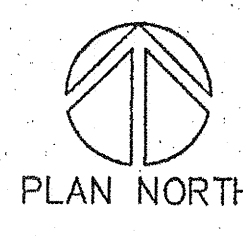
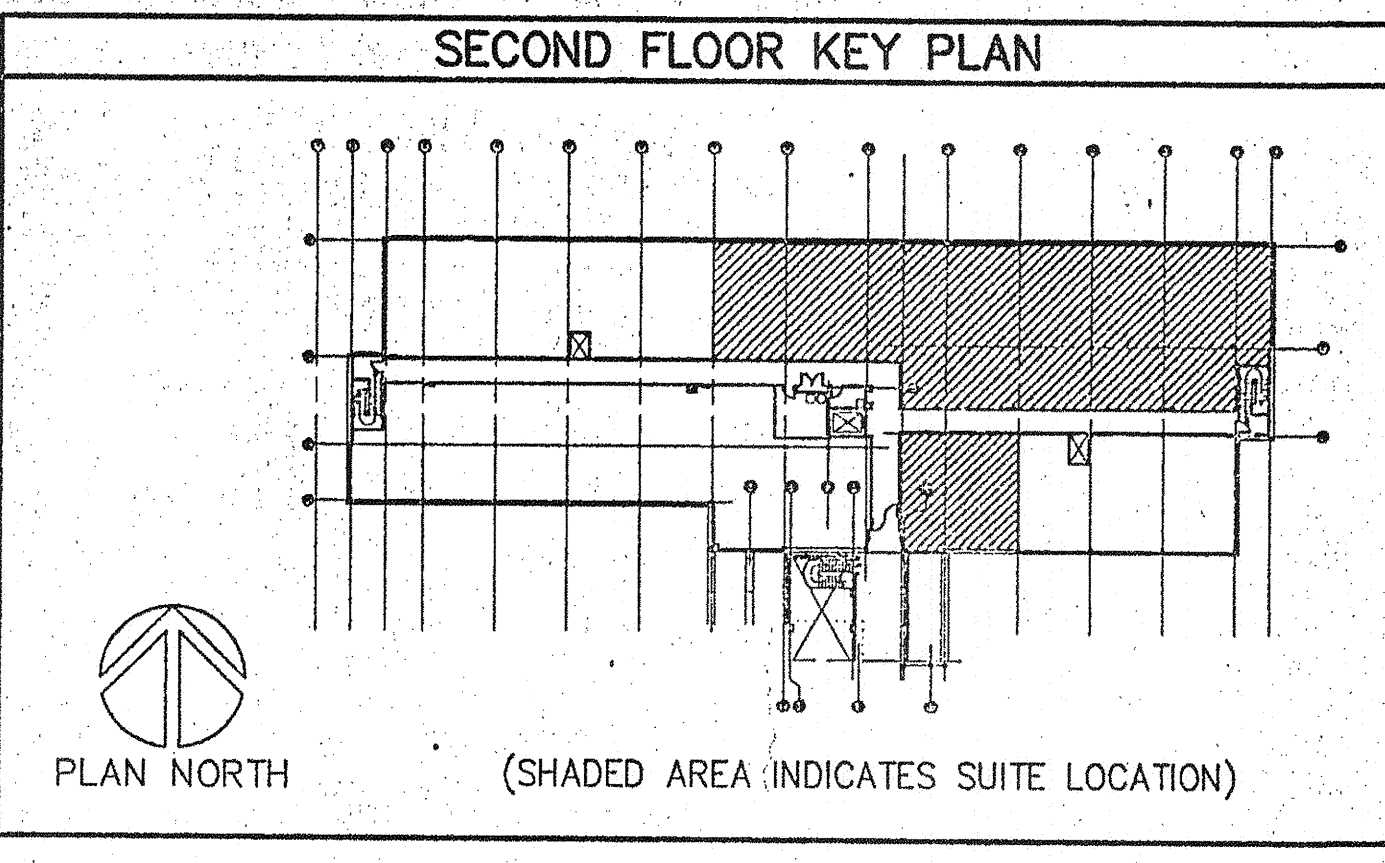

(SHADED AREA INDICATES SUITE LOCATION)

Revisions

Sheet Title

**STANISLAUS CARDIOLOGY**

SUITE #230

**SECOND FLOOR**

Project Title  
**MEDICAL OFFICE BUILDING II**

**MEMORIAL HOSPITALS ASSOCIATION**

**MODESTO, CA**

Date  
20 APRIL 1992

Project No.  
2350

Sheet No.  
**A-230**