



EQUITY RETAIL BROKERS

DELAWARE VALLEY  
UNIVERSITY

LEASING OPPORTUNITY

2100 Lower State Road  
Doylestown, PA 18901

[VIEW PROPERTY TOUR](#) ►

## THE OPPORTUNITY

Equity Retail Brokers is pleased to present the opportunity to partner with Delaware Valley University to create a unique experience for Tenant and Customers.

## PROPERTY FEATURES

- > 7,400 SF Free Standing Building:
  - ±5,000 SF Main Sales Floor
  - ±2,400 SF back of house Kitchen / Bakery / Receiving
- > 3 Exterior Box Coolers and Freezer
- > Large Covered Patio
- > 2,400 SF Greenhouse
- > 6,000 SF Outdoor Garden / Meeting Area
- > 58 Existing Paved Parking

### Floor Plan

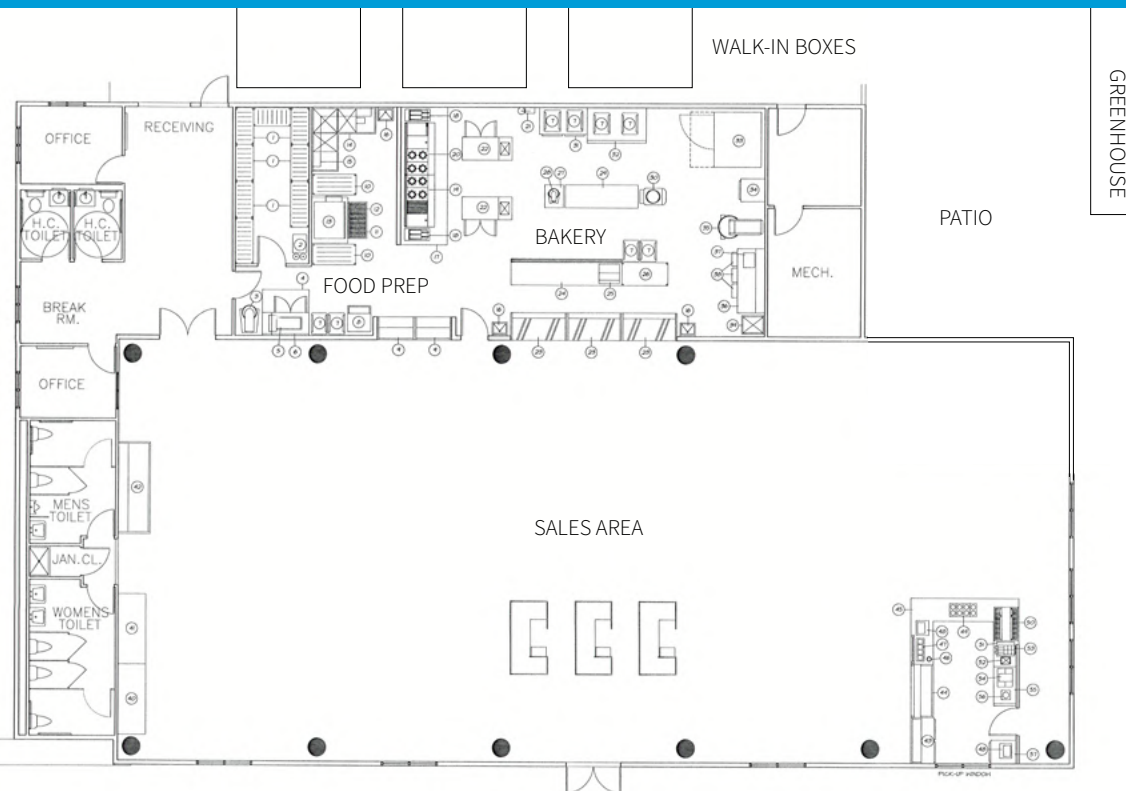

Sales Floor



Patio & Greenhouse

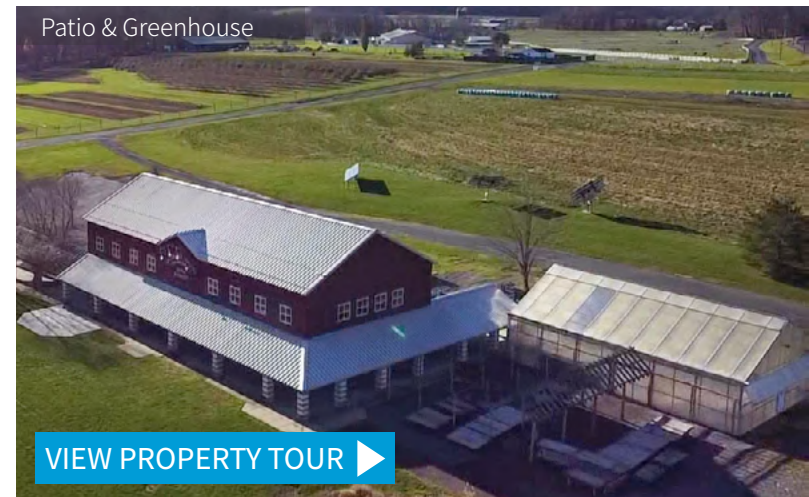

[VIEW PROPERTY TOUR](#) ▶

## LOCATION DETAILS

- > Easy Access Route 202 and Route 202 Business.  
1,000' to the intersection of 202 & Lower State Road
- > Close proximity to Delaware Valley University, Doylestown Hospital, Borough of Doylestown, Central Bucks West HS
- > An engaged population seeking involvement for community patronage
- > Traffic Counts:
  - Lower State Road: 5,261 ADT
  - Route 202: 19,235 ADT
  - Business Route 202: 15,035 ADT
  - 611 Bypass: 35,674 ADT

## Demographics

|                             | 1 Mile    | 3 Miles   | 5 Miles   | 10 Miles  |
|-----------------------------|-----------|-----------|-----------|-----------|
| Population                  | 4,513     | 39,067    | 105,028   | 408,448   |
| Average HHI                 | \$141,863 | \$144,630 | \$156,351 | \$136,815 |
| Adj Daytime Demos (16 yrs+) | 8,166     | 50,170    | 88,242    | 336,828   |

Demographic Data Source: Applied Geographic Solutions, 2020 (REGIS)

## CONTACT

Ken McEvoy

610.645.7700 x126

kmcevoy@equityretailbrokers.com

Keith Seymour

610.645.7700 x149

kseymour@equityretailbrokers.com

David Goodman

610.645.7700 x119

dgoodman@equityretailbrokers.com

EQUITY RETAIL BROKERS

Within one mile:

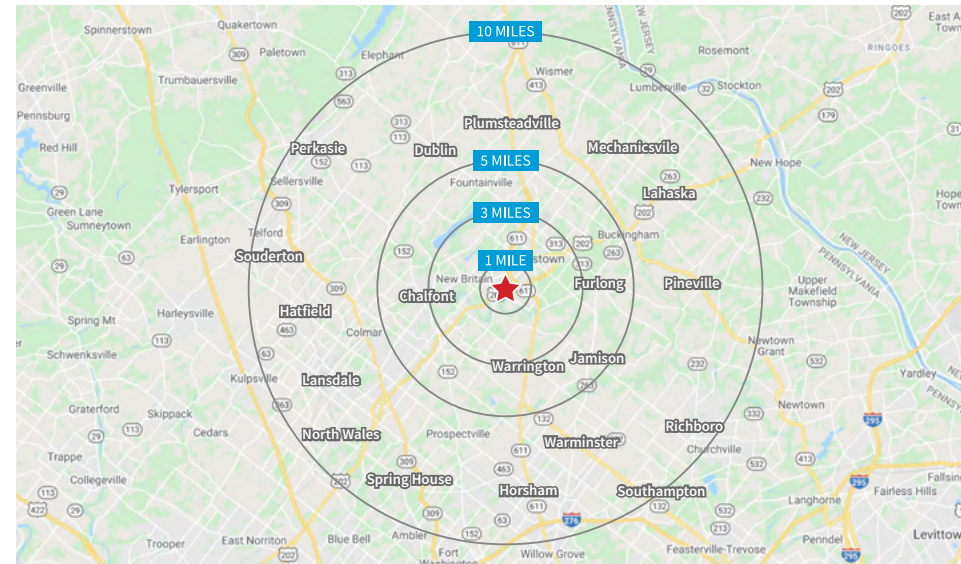

Information concerning this offering is from sources deemed reliable but no warranty is made to the accuracy thereof and it is submitted subject to errors, omissions, changes of price or other conditions, prior to sale or lease or withdrawal without notice. Equity Retail Brokers is licensed in PA, NJ, & DE. Ken McEvoy, David Goodman, and Keith Seymour are licensed salespersons in PA & NJ.

# DOYLESTOWN RETAIL MARKET

2100 Lower State Road | Bucks County, PA



Aerial Source: Google Earth Pro & Traffic Count Source: PA DOT ('17-'20)

Compliments of:  
 Equity Retail Brokers ■ 531 W. Germantown Pike, Ste 103 ■ Plymouth Meeting, PA 19462 ■ 610.645.7700 ■ www.equityretailbrokers.com

