

FOR LEASE

# AVIATOR BUSINESS PARK LOT 8

INTERSTATE 270 & N. LINDBERGH BOULEVARD

ST. LOUIS (HAZELWOOD), MISSOURI 63042

**222,715 SF State-of-the-Art Warehouse/Distribution Facility**



**Available 2019 | 25 Year Tax Abatement**



## PROPERTY FEATURES

- + 222,715 SF proposed state-of-the-art warehouse/distribution facility
- + Divisible to 50,000 ± SF
- + Excellent visibility on Lindbergh Blvd.
- + 32' minimum clear height
- + LED High Bay Lighting
- + Office built to suit
- + 32 docks (expandable)
- + 2 drive-ins
- + ESFR
- + 50' x 50' column spacing (60' speed bay)
- + 25-year real estate tax abatement with \$0.18 PSF initial taxes
- + 312 car parking (expandable)
- + 66 trailer parking
- + Heavy electric



**PANATTONI**  
INTERNATIONAL VISION. LOCAL FOCUS.



## CONTACT US

### KATIE HAYWOOD

Vice President  
314 655 5838  
katie.haywood@cbre.com

### CBRE, INC.

190 Carondelet Plaza  
Suite 1400  
St. Louis, MO 63105

[www.cbre.us/stlouis](http://www.cbre.us/stlouis)

**CBRE**

FOR LEASE  
**AVIATOR BUSINESS PARK**  
**LOT 8**

**INTERSTATE 270 &  
N. LINDBERGH  
BOULEVARD**

ST. LOUIS (HAZELWOOD), MISSOURI 63042



**SITE PLAN**

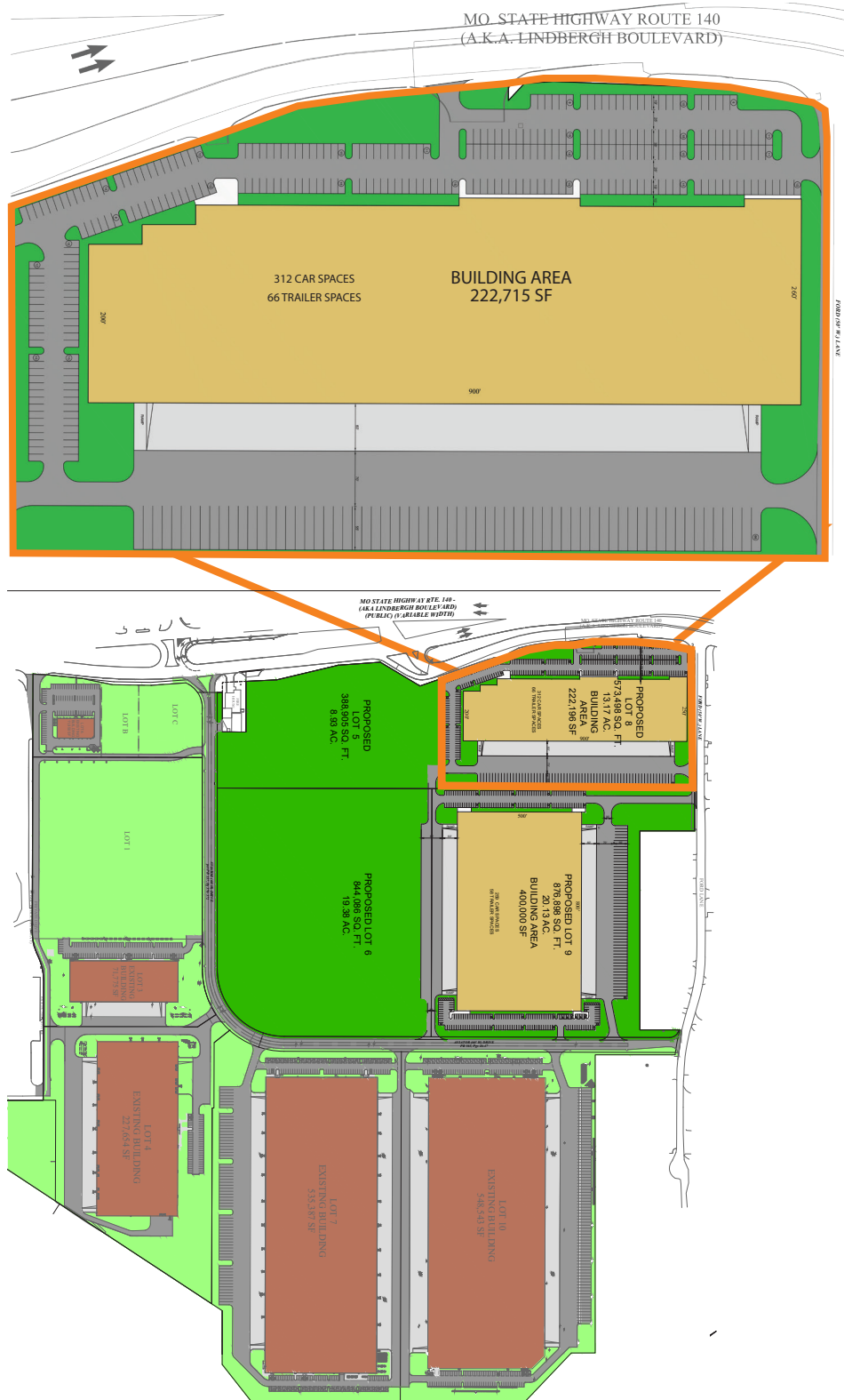



# FOR LEASE AVIATOR BUSINESS PARK LOT 8

INTERSTATE 270 &  
N. LINDBERGH  
BOULEVARD

ST. LOUIS (HAZELWOOD), MISSOURI 63042



## AERIAL MAP



© 2018 CBRE, Inc. This information has been obtained from sources believed reliable. We have not verified it and make no guarantee, warranty or representation about it. Any projections, opinions, assumptions or estimates used are for example only and do not represent the current or future performance of the property. You and your advisors should conduct a careful, independent investigation of the property to determine to your satisfaction the suitability of the property for your needs. Photos herein are the property of their respective owners and use of these images without the express written consent of the owner is prohibited. CBRE and the CBRE logo are service marks of CBRE, Inc. and/or its affiliated or related companies in the United States and other countries. All other marks displayed on this document are the property of their respective owners.

[www.cbre.us/stlouis](http://www.cbre.us/stlouis)

**CBRE**