



APPROXIMATELY 155 SQ FT

## Description

Situated in this historic market town, the subject premises form part of the Castle Courtyard complex, which fronts the Market Place in central Knaresborough. This particular unit is 155 sq ft and would suit a variety of small retailers.

This provides an opportunity to lease a ground floor retail unit within the covered mall of the complex. The centre provides shared toilet facilities and a utility area for the various occupiers. There are a number of local and national retailers within the scheme, including 'Country 2 Western', The Beanery and Subway to name but a few.

**GROUND FLOOR RETAIL  
UNIT**

**£5,200**  
Per annum

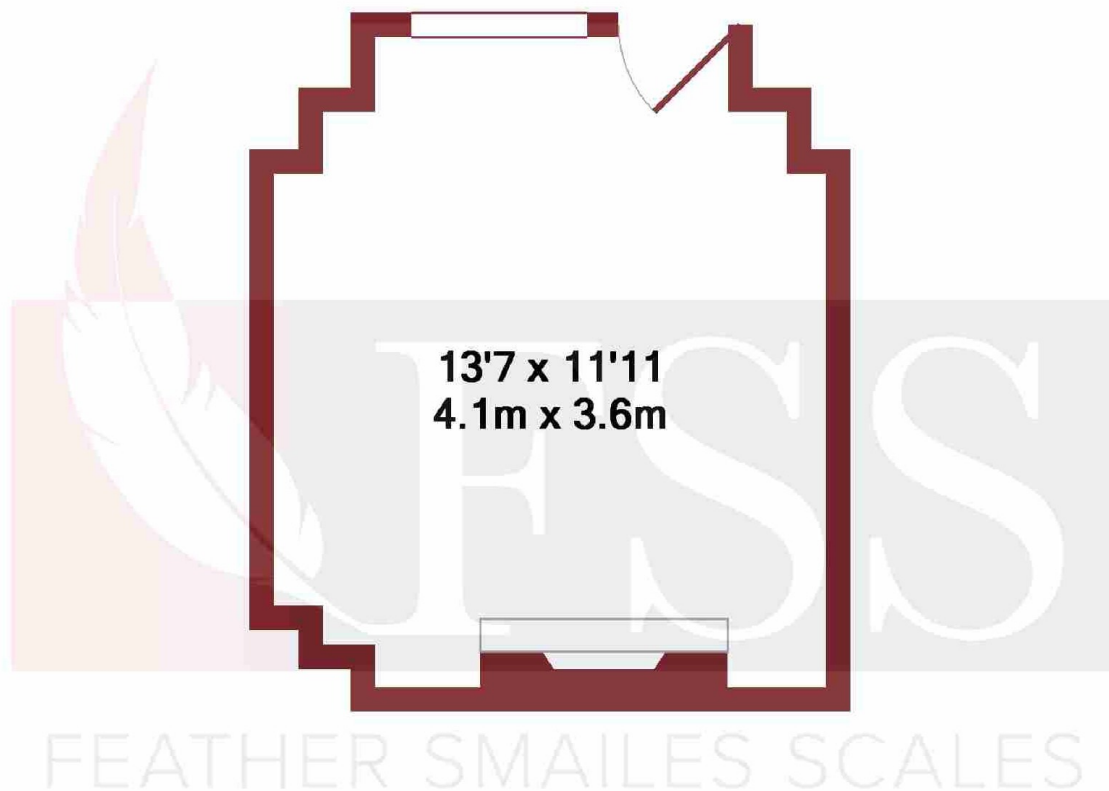

TOTAL APPROX. FLOOR AREA 147 SQ.FT. (13.7 SQ.M.)  
Made with Metropix ©2017

### Location

Located in the heart of Knaresborough the courtyard is accessed just off the Market Place. Knaresborough is an historic North Yorkshire market town which serves the local community and is also a popular tourist destination. The town benefits from good road and rail links, being on the York to Leeds railway line.

### Tenure

The premises are available on a new lease the terms of which are to be negotiated.

### Rateable Value

Rateable Value: £3,750

Uniform Business Rate for 2017/17 £0.479.

Small business rate relief may be available to some occupiers. Further enquiries should be directed to HBC 01423 500600

### VAT

All figures quoted are deemed exclusive of VAT where applicable.

### Costs

Unless expressly stated all parties will be responsible for their own legal costs in connection with this

transaction.

### Planning

Interested parties are advised to make their own enquiries of the local planning authority in respect of planning proposals if any change of use is envisaged.

### Viewing

Strictly by appointment with the agent Tel: 01423 501211.

### Services

All mains services are connected to the property.

**IMPORTANT NOTICE: 1. Particulars:** These particulars are not an offer of contract, nor part of one. You should rely on Statements by Feather Smailes Scales LLP in the particulars or by word of mouth or in writing ("information") as being factually accurate about the property, its condition or its value. Neither Feather Smailes Scales or any joint agent has any authority to make any representations about the property, and accordingly any information given is entirely without responsibility on the part of the agents, seller(s) or lessor(s). **2. Photos etc:** The measurements and distances given are approximate only and maps and plans displayed are for illustration purposes only. photographs show only certain parts of the property as they appeared at the time they were taken. Areas, **3. Regulations etc:** Any reference to alterations to, or use of, any part of the property does not mean that any necessary planning, building regulations or other consent has been obtained. A buyer or lessee must find out by inspection or in other ways that these matters have been properly dealt with and that all information is correct. **4. VAT:** The VAT position relation to the property may change without notice. Viewing by appointment only. Feather Smailes & Scales is a limited liability registered in England with registered number OC308783. Our registered office is 8 Raglan Street, Harrogate, North Yorkshire, HG1 1LE, where you may look at a list of members' names.

**01423 501 211**

[www.fssproperty.co.uk](http://www.fssproperty.co.uk)

[info@fssproperty.co.uk](mailto:info@fssproperty.co.uk)

8 Raglan Street, Harrogate,

North Yorkshire, HG1 1LE