



HESKETT

N 34°00'00"W 400.00'

1.930 ACRES

SQUARE
PEG FD

S 34°00'00"E 401.46'

LONGMORE AVENUE

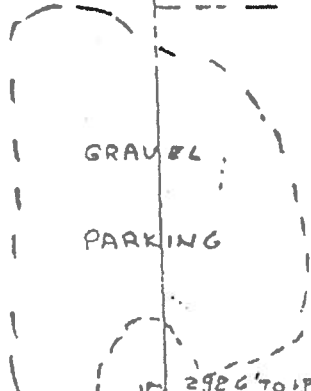
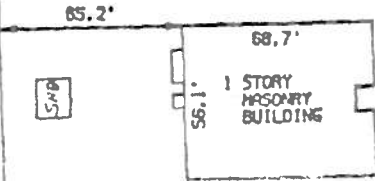

GRAVEL
PARKING

MON FD 44.9' S 58°00'00"W 209.95'

2986'90" PP
PC HELEN DR

LAND OF
BRAINARD T. & REBECCA S. COFFEY

&
BRUCE E. & THELMA R. RING
FORK DISTRICT
WARREN COUNTY, VIRGINIA

ROUTE 619

FURSTENAU SURVEYING

STEPHENS CITY, VIRGINIA 22655

SCALE: 1"=60'

DATE: JULY 29, 1988