

AVAILABLE FOR SALE OR LEASE

FREESTANDING RESTAURANT

1580 DEBORAH RD

RIO RANCHO, NM 87144

RETAIL



AVAILABLE

- + Approximately 2,500± SF on 0.56± Acres
- + For Sale: \$500,000
- + For Lease: \$15.00/SF NNN

PLEASE DO NOT DISTURB TENANT

PROPERTY BENEFITS

- + Restaurant located in underserved Rio Rancho trade area
- + Located directly off Hwy 528 at signalized intersection
- + Ample off -street parking
- + 40,900 VPD on NM 528

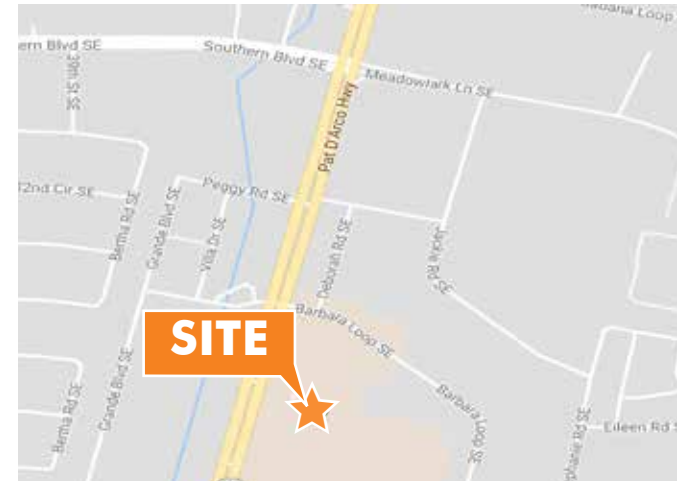

CONTACT US

KYLA STOKER

Associate
+1 505 837 4927
kyla.stoker@cbre.com

LIA ARMSTRONG, CCIM

Vice President
+1 505 837 4951
lia.armstrong@cbre.com

JIM DOUNTAS

First Vice President
+1 505 837 4955
jim.dountas@cbre.com

www.cbre.com/abq

CBRE

AVAILABLE FOR SALE OR LEASE

FREESTANDING RESTAURANT

1580 DEBORAH RD

RIO RANCHO, NM 87144

RETAIL



AVAILABLE FOR SALE OR LEASE

FREESTANDING RESTAURANT

1580 DEBORAH RD

RIO RANCHO, NM 87144

RETAIL



AVAILABLE FOR SALE OR LEASE

FREESTANDING RESTAURANT

1580 DEBORAH RD

RIO RANCHO, NM 87144

RETAIL

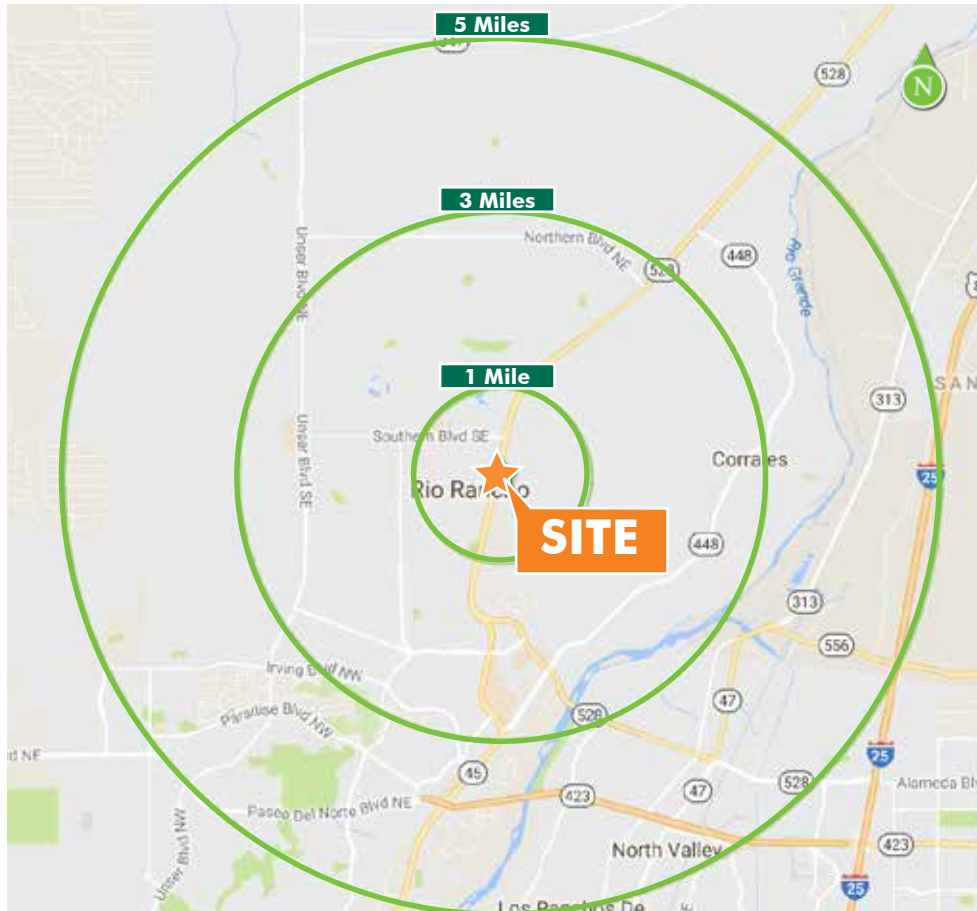

Not to scale

	1 MILE	3 MILES	5 MILES
POPULATION			
2017 Population - Current Year Estimate	7,826	72,801	140,880
2022 Population - Five Year Projection	7,907	76,773	147,992
2010 Population - Census	7,841	66,994	130,848
2000 Population - Census	6,889	47,717	91,106
2010-2017 Annual Population Growth Rate	-0.03%	1.15%	1.02%
2017-2022 Annual Population Growth Rate	0.21%	1.07%	0.99%
HOUSEHOLDS			
2017 Households - Current Year Estimate	3,541	28,315	53,419
2022 Households - Five Year Projection	3,571	29,696	55,818
2010 Households - Census	3,569	26,378	50,147
2000 Households - Census	2,993	18,333	34,066
2010-2017 Annual Household Growth Rate	-0.11%	0.98%	0.88%
2017-2022 Annual Household Growth Rate	0.17%	0.96%	0.88%
2017 Average Household Size	2.16	2.56	2.63
HOUSEHOLD INCOME			
2017 Average Household Income	\$68,477	\$82,579	\$80,483
2022 Average Household Income	\$76,579	\$92,051	\$89,921
2017 Median Household Income	\$47,415	\$64,016	\$62,442
2022 Median Household Income	\$51,564	\$70,705	\$68,468
2017 Per Capita Income	\$30,730	\$32,081	\$30,677
2022 Per Capita Income	\$34,216	\$35,552	\$34,079
HOUSING UNITS			
2017 Housing Units	3,902	30,089	56,698
2017 Vacant Housing Units	361 9.3%	1,774 5.9%	3,279 5.8%
2017 Occupied Housing Units	3,541 90.7%	28,315 94.1%	53,419 94.2%
2017 Owner Occupied Housing Units	2,201 56.4%	19,953 66.3%	39,351 69.4%
2017 Renter Occupied Housing Units	1,340 34.3%	8,362 27.8%	14,068 24.8%
EDUCATION			
2017 Population 25 and Over	5,900	50,154	95,680
HS and Associates Degrees	3,988 67.6%	30,206 60.2%	57,686 60.3%
Bachelor's Degree or Higher	1,403 23.8%	17,137 34.2%	32,255 33.7%
PLACE OF WORK			
2017 Businesses	519	2,582	4,273
2017 Employees	7,320	29,006	46,522

Source: Esri

CONTACT US

KYLA STOKER

Associate
+1 505 837 4927
kyla.stoker@cbre.com

LIA ARMSTRONG, ccim

Vice President
+1 505 837 4951
lia.armstrong@cbre.com

JIM DOUNTAS

First Vice President
+1 505 837 4955
jim.dountas@cbre.com

© 2017 CBRE, Inc. All rights reserved. This information has been obtained from sources believed reliable, but has not been verified for accuracy or completeness. You should conduct a careful, independent investigation of the property and verify all information. Any reliance on this information is solely at your own risk. Photos herein are the property of their respective owners and use of these images without the express written consent of the owner is prohibited. CBRE and the CBRE logo are service marks of CBRE, Inc. and/or its affiliated or related companies in the United States and other countries. All other marks displayed on this document are the property of their respective owners. Updated 08/2017