

INDUSTRIAL PROPERTY

3450 WEST SPENCER STREET GRAND CHUTE, WISCONSIN



Clean, heated warehouse space with easy access to College Avenue and Highway 41. New parking lot in 2016 and updated receiving office/reception area. Plenty of parking for cars & trucks.

Available Space: 28,356 square feet

Date Available: May 1, 2017

Lease Rate: \$3.25/square foot annually

Ceiling Height: 14 feet

HVAC: Suspended Unit Heaters

Dock Doors: 1 - 9' wide x 10' high with leveler
1 - 9' wide x 10' high
3 - 8' wide x 8' high

NNN Charges: \$1.62/square foot annually



Showings are to be arranged through Rollie Winter & Associates, Ltd., by appointment only. This information was obtained from sources deemed to be accurate and reliable, but is not guaranteed and is subject to correction.

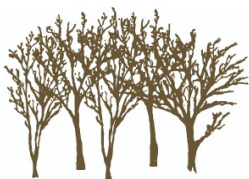

**ROLLIE WINTER &
ASSOCIATES, LTD.**

*Brokers and Consultants to the Business
Community*

3315A North Ballard Road
Appleton, WI 54911

Phone (920) 739-0101 Fax (920) 739-1366

3450 WEST SPENCER STREET APPLETON, WISCONSIN





COLLEGE CENTRE
APPLETON, WISCONSIN

Electric (Parking Lot Lights)	\$35,000.00
Snow Removal	15,000.00
Repair & Maintenance (To parking lot, lights, roof, etc.)	20,000.00
Insurance (on building)	14,890.00
Water & Sewer	13,000.00
Lawn & Landscape	2,500.00
2016 Real Estate Taxes	92,097.00
TOTAL OPERATING EXPENSES	\$192,487.00

This is the approximate total cost to operate the center for 2016 including real estate taxes.

$\$192,487.00 / 118,768$ square feet = apx \$1.62 per square foot.

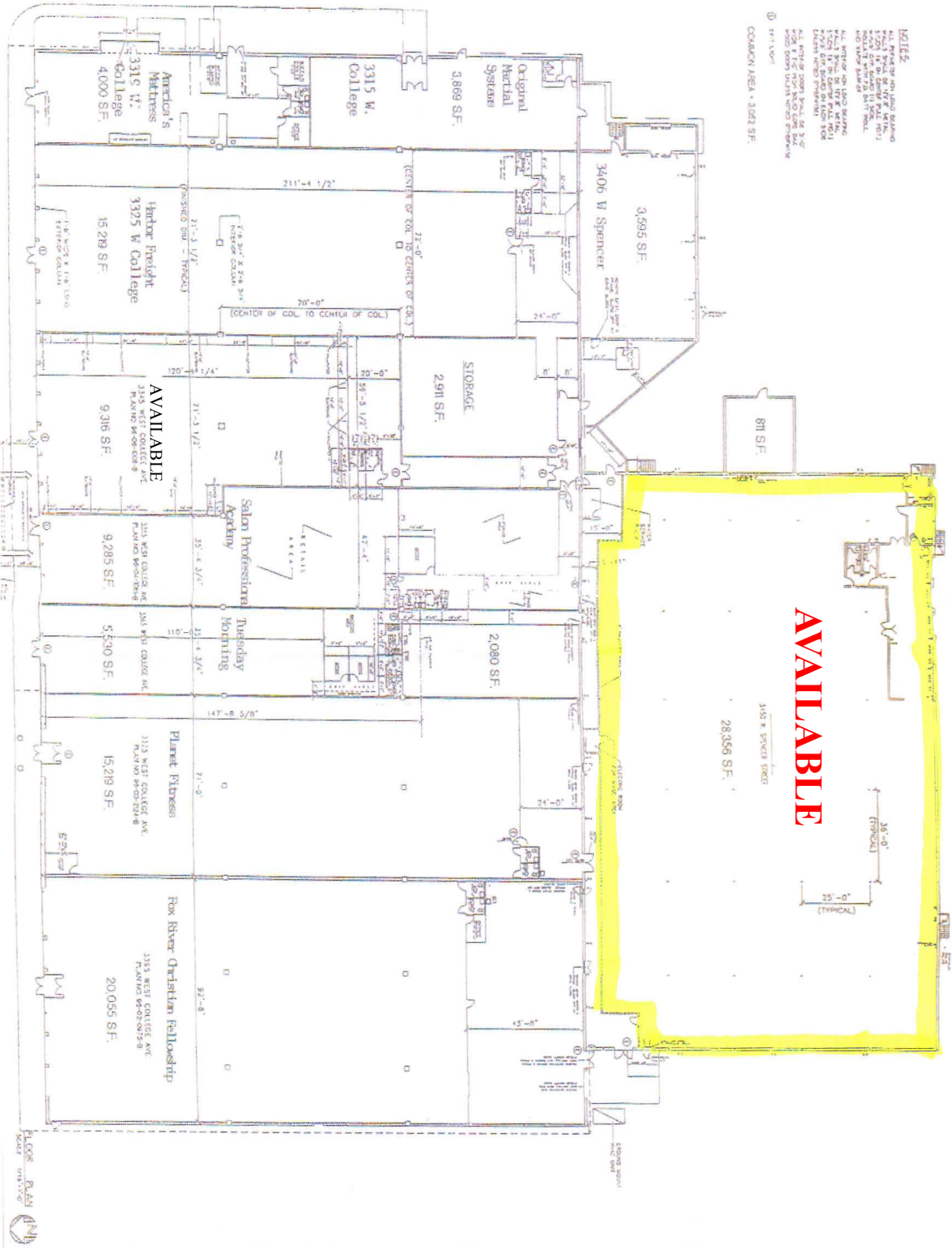

AVAILABLE

NOTE:
 ALL FINISHES ARE TO BE DETERMINED BY THE OWNER. THE OWNER SHALL BE RESPONSIBLE FOR OBTAINING ALL NECESSARY PERMITS AND APPROVALS FROM THE LOCAL AND STATE AUTHORITIES. THE CONTRACTOR SHALL BE RESPONSIBLE FOR OBTAINING ALL NECESSARY PERMITS AND APPROVALS FROM THE LOCAL AND STATE AUTHORITIES. THE CONTRACTOR SHALL BE RESPONSIBLE FOR OBTAINING ALL NECESSARY PERMITS AND APPROVALS FROM THE LOCAL AND STATE AUTHORITIES.

DATE		REVISION	BY	CHKD BY	DATE
DESIGNED BY: CONSOLIDATED CONSTRUCTION COMPANY INC. PREPARED FOR: ROLLIE WINTER & ASSOCIATES LTD. GRAND CAUSE WISCONSIN DRAWN BY: CONSOLIDATED CONSTRUCTION COMPANY INC. ESTABLISHED 1950 1300 N. ROCKWOOD SUITE 100, MILWAUKEE, WI 53215 PHONE (414) 728-3223 FAX (414) 728-3833 WWW.CONSOLIDATEDCONSTRUCTION.COM COPYRIGHT © 1993					

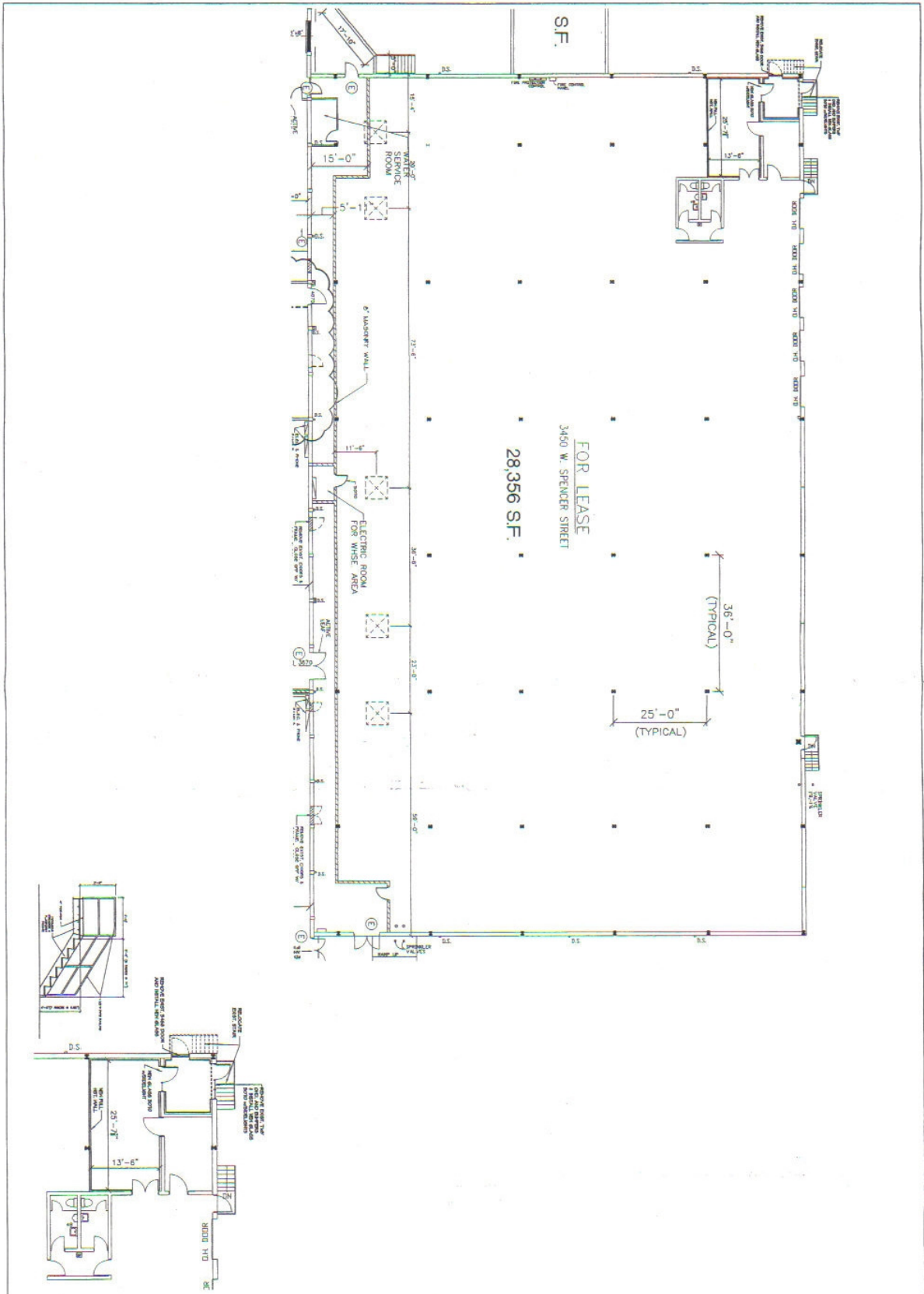

SCALE: AS SHOWN
 DRAWING SHEET DATE:
 SHEET NO. 20
 FILE NO.

DESIGNED BY • CONSOLIDATED CONSTRUCTION COMPANY INC. •
 PROPOSED BUILDING FOR:
PRELIMINARY DESIGN #22214
 DESIGNERS • GENERAL CONTRACTORS • BUILDERS

ESTABLISHED 1950
Consolidated Construction Company, Inc.
 4300 N. RICHMOND ST.
 APPLETON, WI 54913-9704
 PHONE (920) 739-3058
 W. WANTS (920) 842-8774
 FAX (920) 739-3933
 E-mail: ccoinc@comp.com
 COPYRIGHT 2005

A2

BROKER DISCLOSURE TO NON-RESIDENTIAL CUSTOMERS

1 Prior to negotiating on your behalf the Broker must provide you the following disclosure statement:

2 **BROKER DISCLOSURE TO CUSTOMERS**

3 You are a customer of the broker. The broker is either an agent of another party in the transaction or a subagent of another broker
4 who is the agent of another party in the transaction. The broker, or a salesperson acting on behalf of the broker, may provide
5 brokerage services to you. Whenever the broker is providing brokerage services to you, the broker owes you, the customer, the
6 following duties:

- 7 ■ The duty to provide brokerage services to you fairly and honestly.
- 8 ■ The duty to exercise reasonable skill and care in providing brokerage services to you.
- 9 ■ The duty to provide you with accurate information about market conditions within a reasonable time if you request it, unless
10 disclosure of the information is prohibited by law.
- 11 ■ The duty to disclose to you in writing certain material adverse facts about a property, unless disclosure of the information is
12 prohibited by law (See Lines 47-55).
- 13 ■ The duty to protect your confidentiality. Unless the law requires it, the broker will not disclose your confidential information or the
14 confidential information of other parties (See Lines 22-39).
- 15 ■ The duty to safeguard trust funds and other property the broker holds.
- 16 ■ The duty, when negotiating, to present contract proposals in an objective and unbiased manner and disclose the advantages and
17 disadvantages of the proposals.

18 Please review this information carefully. A broker or salesperson can answer your questions about brokerage services, but if you
19 need legal advice, tax advice, or a professional home inspection, contact an attorney, tax advisor, or home inspector.
20 This disclosure is required by section 452.135 of the Wisconsin statutes and is for information only. It is a plain-language summary of
21 a broker's duties to a customer under section 452.133 (1) of the Wisconsin statutes.

22 **CONFIDENTIALITY NOTICE TO CUSTOMERS**

23 BROKER WILL KEEP CONFIDENTIAL ANY INFORMATION GIVEN TO BROKER IN CONFIDENCE, OR ANY INFORMATION
24 OBTAINED BY BROKER THAT HE OR SHE KNOWS A REASONABLE PERSON WOULD WANT TO BE KEPT CONFIDENTIAL,
25 UNLESS THE INFORMATION MUST BE DISCLOSED BY LAW OR YOU AUTHORIZE THE BROKER TO DISCLOSE PARTICULAR
26 INFORMATION. A BROKER SHALL CONTINUE TO KEEP THE INFORMATION CONFIDENTIAL AFTER BROKER IS NO LONGER
27 PROVIDING BROKERAGE SERVICES TO YOU.

28 THE FOLLOWING INFORMATION IS REQUIRED TO BE DISCLOSED BY LAW:

- 29 1. MATERIAL ADVERSE FACTS, AS DEFINED IN SECTION 452.01 (5g) OF THE WISCONSIN STATUTES (SEE LINES 47-55).
- 30 2. ANY FACTS KNOWN BY THE BROKER THAT CONTRADICT ANY INFORMATION INCLUDED IN A WRITTEN INSPECTION
31 REPORT ON THE PROPERTY OR REAL ESTATE THAT IS THE SUBJECT OF THE TRANSACTION.

32 TO ENSURE THAT THE BROKER IS AWARE OF WHAT SPECIFIC INFORMATION YOU CONSIDER CONFIDENTIAL, YOU MAY LIST
33 THAT INFORMATION BELOW (SEE LINES 35-36). AT A LATER TIME, YOU MAY ALSO PROVIDE THE BROKER WITH OTHER
34 INFORMATION YOU CONSIDER TO BE CONFIDENTIAL.

35 **CONFIDENTIAL INFORMATION:** _____

36 _____

37 **NON-CONFIDENTIAL INFORMATION** (The following information may be disclosed by Broker): _____

38 _____

39 (INSERT INFORMATION YOU AUTHORIZE THE BROKER TO DISCLOSE SUCH AS FINANCIAL QUALIFICATION INFORMATION.)

40 **CONSENT TO TELEPHONE SOLICITATION**

41 I/We agree that the Broker and any affiliated settlement service providers (for example, a mortgage company or title company) may
42 call our/my home or cell phone numbers regarding issues, goods and services related to the real estate transaction until I/we
43 withdraw this consent in writing. List Home/Cell Numbers: _____

44 **SEX OFFENDER REGISTRY**

45 Notice: You may obtain information about the sex offender registry and persons registered with the registry by contacting the
46 Wisconsin Department of Corrections on the Internet at: <http://offender.doc.state.wi.us/public/> or by phone at 608-240-5830.

47 **DEFINITION OF MATERIAL ADVERSE FACTS**

48 A "material adverse fact" is defined in Wis. Stat. § 452.01(5g) as an adverse fact that a party indicates is of such significance, or that
49 is generally recognized by a competent licensee as being of such significance to a reasonable party, that it affects or would affect
50 the party's decision to enter into a contract or agreement concerning a transaction or affects or would affect the party's decision
51 about the terms of such a contract or agreement. An "adverse fact" is defined in Wis. Stat. § 452.01(1e) as a condition or occurrence
52 that a competent licensee generally recognizes will significantly and adversely affect the value of the property, significantly reduce
53 the structural integrity of improvements to real estate, or present a significant health risk to occupants of the property; or information
54 that indicates that a party to a transaction is not able to or does not intend to meet his or her obligations under a contract or
55 agreement made concerning the transaction.

No representation is made as to the legal validity of any provision or the adequacy of any provision in any specific transaction.

Copyright 2007 by Wisconsin REALTORS® Association