



PRICE: \$21.00 SF/YR

# 507 N MARIENFELD ST

Midland, TX 79701

John Elphick, CCIM  
432.553.9253  
john@moriahgroup.net

PRICE: \$21.00 SF/YR

# 507 N MARIENFELD ST

Midland, TX 79701

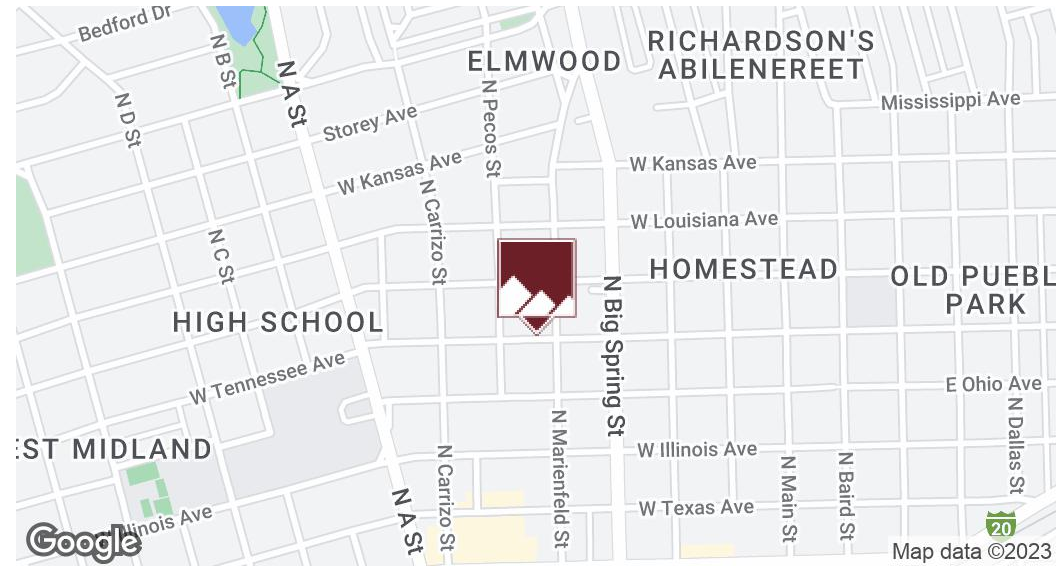

## Property Description

This two-story building offers a unique opportunity for any size company to office in the downtown area. The office space is thoughtfully divided into different zones, including private offices, meeting rooms and communal areas. This property also offers covered parking and is in close proximity to the Central Business District.

### Offering Summary

Lease Rate:	\$21.00 SF/yr (Full Service)
Available SF:	427 - 6,000 SF

## Location Description

Claim your spot in this Downtown Midland building for lease. Located within walking distance to restaurants, entertainment, Centennial Park, Petroleum Club and the Midland County Library.

Spaces	Lease Rate	Space Size
1ST FLOOR - 100	\$21.00 SF/yr	6,000 SF
1ST FLOOR - 101	\$21.00 SF/yr	427 SF
1ST FLOOR - 130	\$21.00 SF/yr	517 SF
2ND FLOOR - 200	\$21.00 SF/yr	917 SF
2ND FLOOR - 201	\$21.00 SF/yr	1,004 SF
2ND FLOOR- 203	\$21.00 SF/yr	1,225 SF
2ND FLOOR - 208	\$21.00 SF/yr	1,028 SF

John Elphick, CCIM

432.553.9253

john@moriahgroup.net



PRICE: \$21.00 SF/YR

# 507 N MARIENFELD ST

Midland, TX 79701



John Elphick, CCIM  
432.553.9253  
john@moriahgroup.net

**MORIAH**  
BROKERAGE SERVICES, LLC

PRICE: \$21.00 SF/YR

# 507 N MARIENFELD ST

Midland, TX 79701



John Elphick, CCIM  
432.553.9253  
john@moriahgroup.net

**MORIAH**  
BROKERAGE SERVICES, LLC



PRICE: \$21.00 SF/YR

# 507 N MARIENFELD ST

Midland, TX 79701

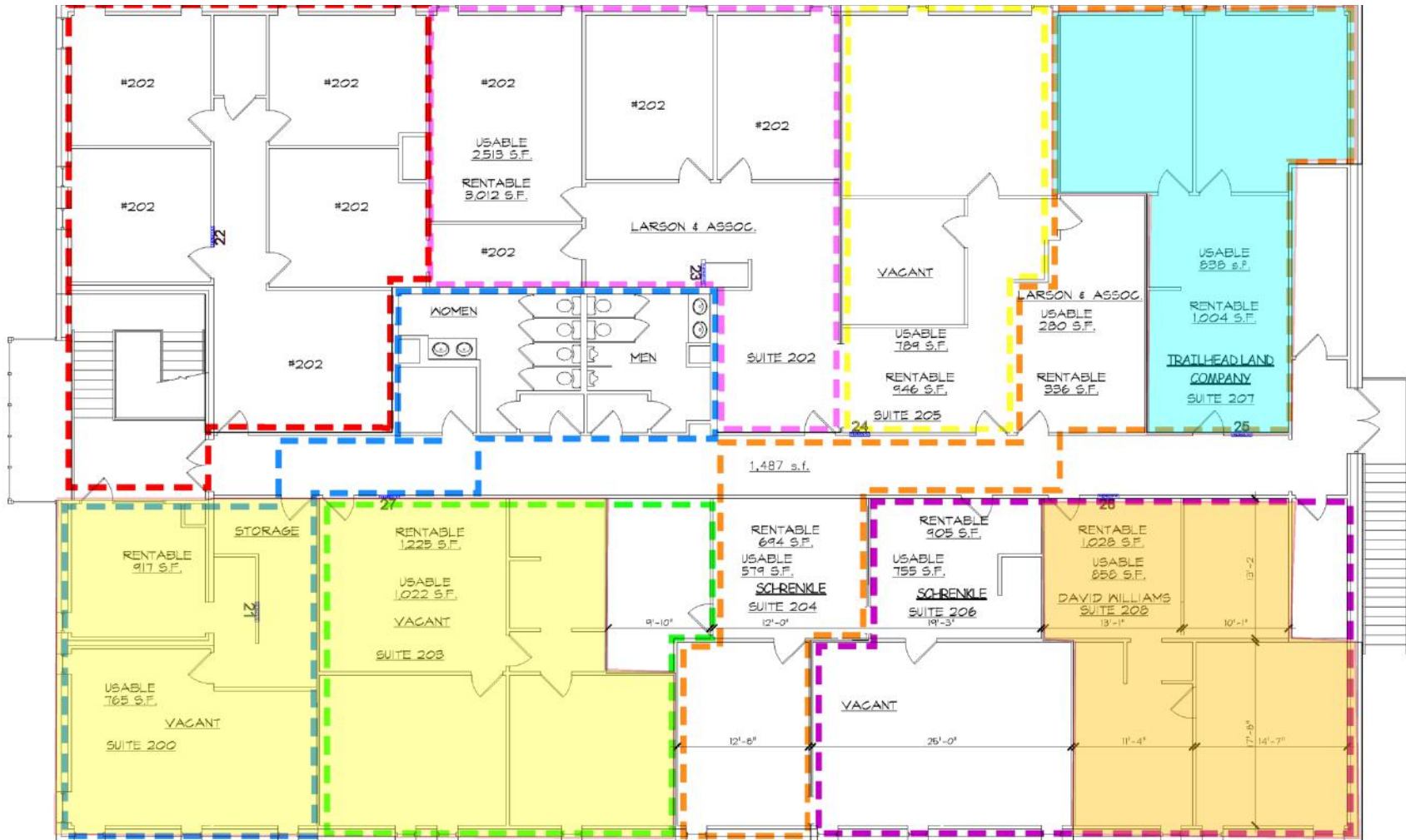

PREPARED BY:  
**JM DRAFTING & DESIGN**  
AS-BUILT DRAWINGS FOR:  
**MORINSON BUILDING**  
507 NORTH MARIENFELD  
2ND FLOOR

© COPYRIGHT, J M DRAFTING & DESIGN  
2019. FEDERAL COPYRIGHT PROTECTION, EXTENDING TO DERIVATIVE PLANS, IS APPLICABLE TO INTENTIONAL AND UNINTENTIONAL INFRINGEMENTS AND PROVIDES FOR SPECIFIC AND CRIMINAL UNAUTHORIZED REPRODUCTION IN ANY FORM IS STRICTLY PROHIBITED AND FORBIDDEN.

DATE:  
OCT. 1, 2019

(A) AS-BUILT FLOOR PLAN  
scale: 1/8" = 1'-0"

John Elphick, CCIM  
432.553.9253  
john@moriahgroup.net

**MORIAH**  
BROKERAGE SERVICES, LLC

PRICE: \$21.00 SF/YR

# 507 N MARIENFELD ST

Midland, TX 79701

Population	0.25 Miles	0.5 Miles	1 Mile
Total Population	640	2,263	10,089
Average Age	31.3	34.1	34.1
Average Age (Male)	23.5	28.6	32.6
Average Age (Female)	36.9	39.4	36.2

Households & Income	0.25 Miles	0.5 Miles	1 Mile
Total Households	233	850	3,611
# of Persons per HH	2.7	2.7	2.8
Average HH Income	\$67,362	\$70,837	\$70,828
Average House Value	\$132,938	\$132,394	\$143,811

\* Demographic data derived from 2020 ACS - US Census

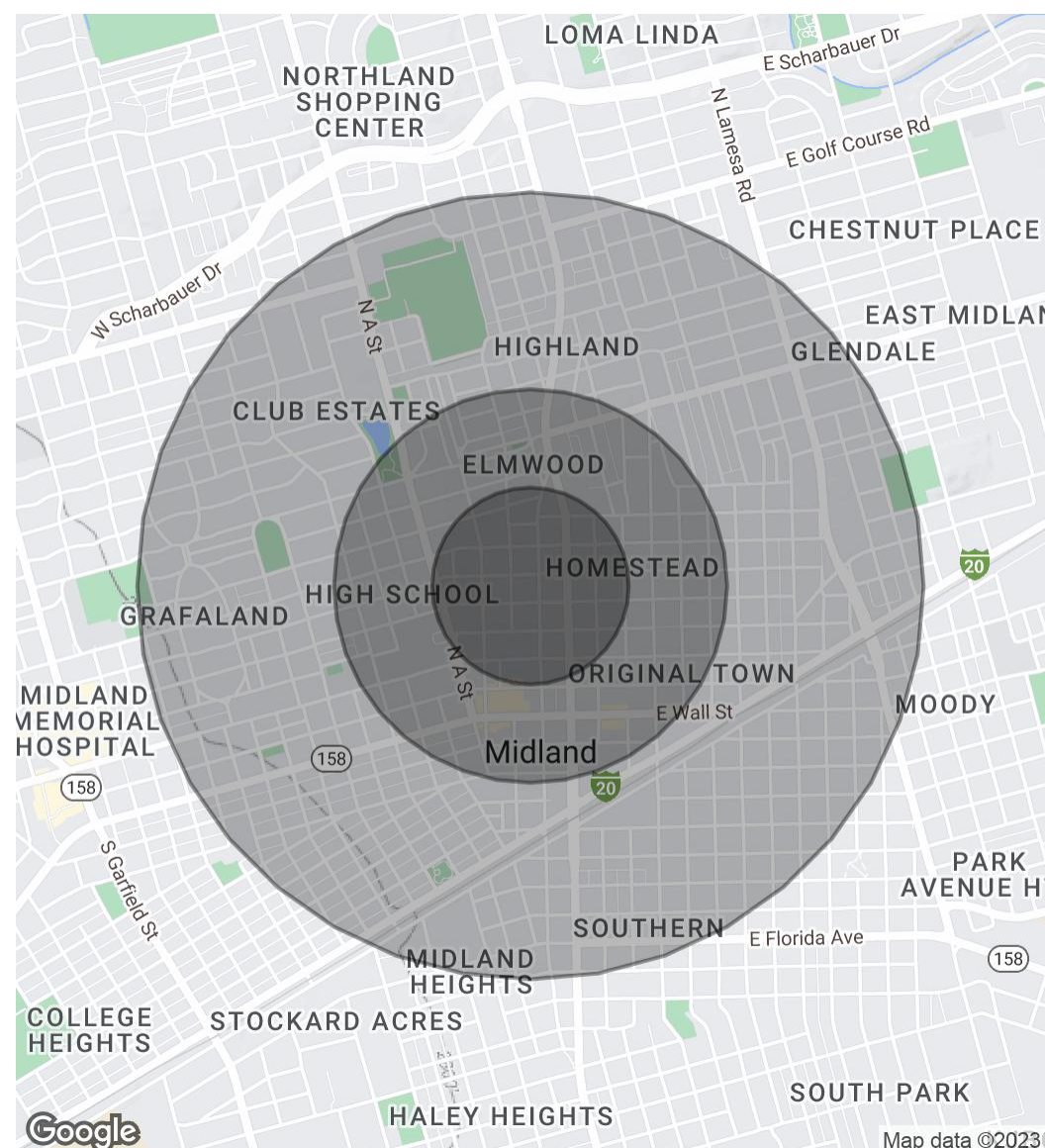

John Elphick, CCIM  
432.553.9253  
john@moriahgroup.net

**MORIAH**  
BROKERAGE SERVICES, LLC

507 N MARIENFELD ST

Midland, TX 79701



Contact Broker:

**John Elphick, CCIM**

432.553.9253

john@moriahgroup.net



303 West Wall Street, Midland, TX 79701

432.682.2510 | moriahbrokerageservices.com