

FOR SALE

ON BEHALF OF THE MUIR GROUP

MITCHELSTON INDUSTRIAL ESTATE

STRATEGIC DEVELOPMENT SITE OF 79 ACRES
KIRKCALDY, FIFE, SCOTLAND



< TO GLENROTHES

KIRKCALDY TOWN CENTRE

A92 DUAL CARRIAGEWAY TO M90 >

MITCHELSTON INDUSTRIAL ESTATE



STRATEGIC DEVELOPMENT SITE OF 79 ACRES KIRKCALDY, FIFE, SCOTLAND

The site is strategically well situated to service Kirkcaldy, Glenrothes, Dunfermline and Central Scotland in general via the motorway network

Location

Mitchelston Industrial Estate is situated to the north of Kirkcaldy town centre and benefits from direct access onto the A92 dual carriageway which joins Kirkcaldy and Glenrothes with the M90 (Edinburgh – Perth/Aberdeen) motorway.

Existing occupiers on Mitchelston Industrial Estate include Bank of Scotland, Asda, Edmundson Electrical, City Electrical Factors and United Freight Distribution. There are also several car dealerships including BMW, Mazda, Volkswagen and Nissan.

Site

The property comprises a substantial development opportunity totalling 31.84 hectares (79 acres) or thereby.

The site has frontage onto the A92 and there are a number of access points from estate roads within Mitchelston Industrial Estate.

The building which is currently on site was occupied by Strand Lighting and totals 10,395 sq m (111,895 sq ft) of factory/distribution space. This building could be sub-divided to suit occupier requirements.

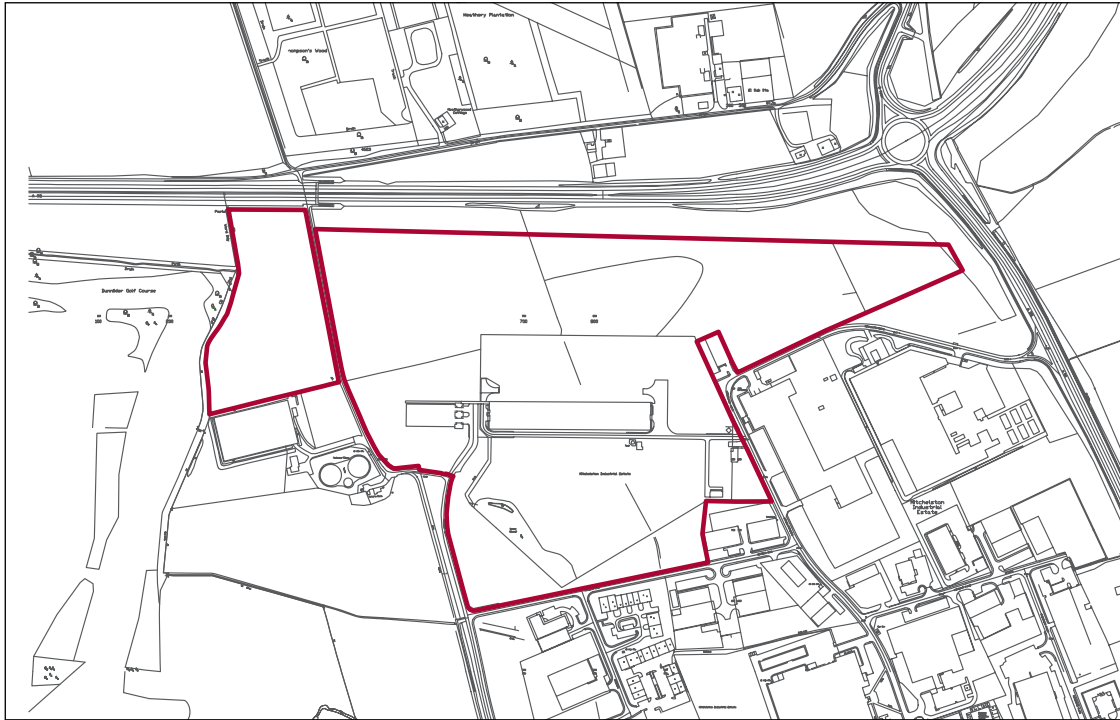

The Building

Situated on the site is a substantial factory building which was last occupied by Strand Lighting. The building totals 10,395 sq m (111,895 sq ft) and is arranged internally to provide mainly production or distribution space with two storey offices, canteen and reception facilities towards the eastern side. The building could be sub-divided as needed and has plenty of car parking and circulation space.

Planning

This land is in an area currently zoned for industrial and employment uses. We would strongly recommend that interested parties contact Fife Council Planning Department direct for further information. Their contact number is 01592 412900.

Sale

Offers are invited to purchase this land and for details on the price required, please do not hesitate to contact the selling agents Ryden or Hardies as detailed below.

We would strongly recommend to all interested parties that they formally note their interest in the site to ensure future notification of a closing date for offers.

MITCHELSTON INDUSTRIAL ESTATE

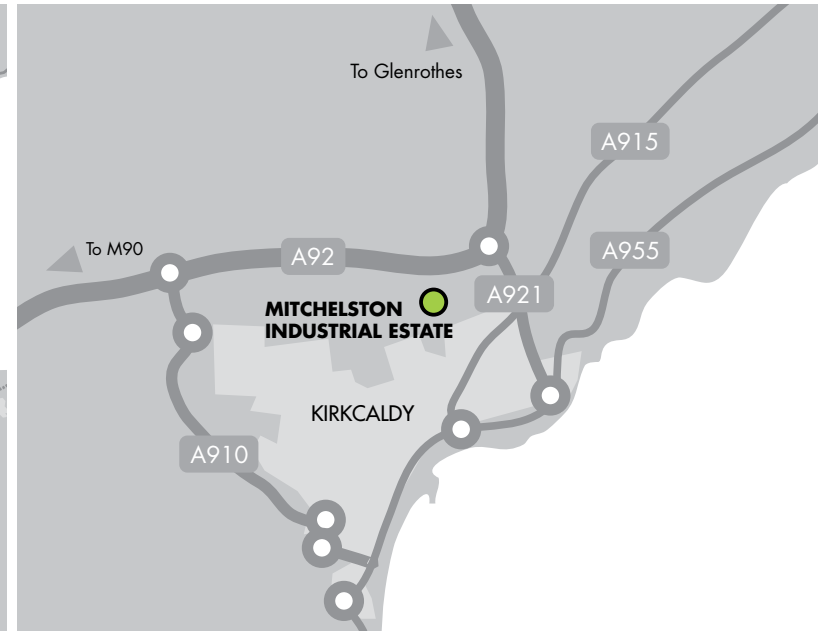
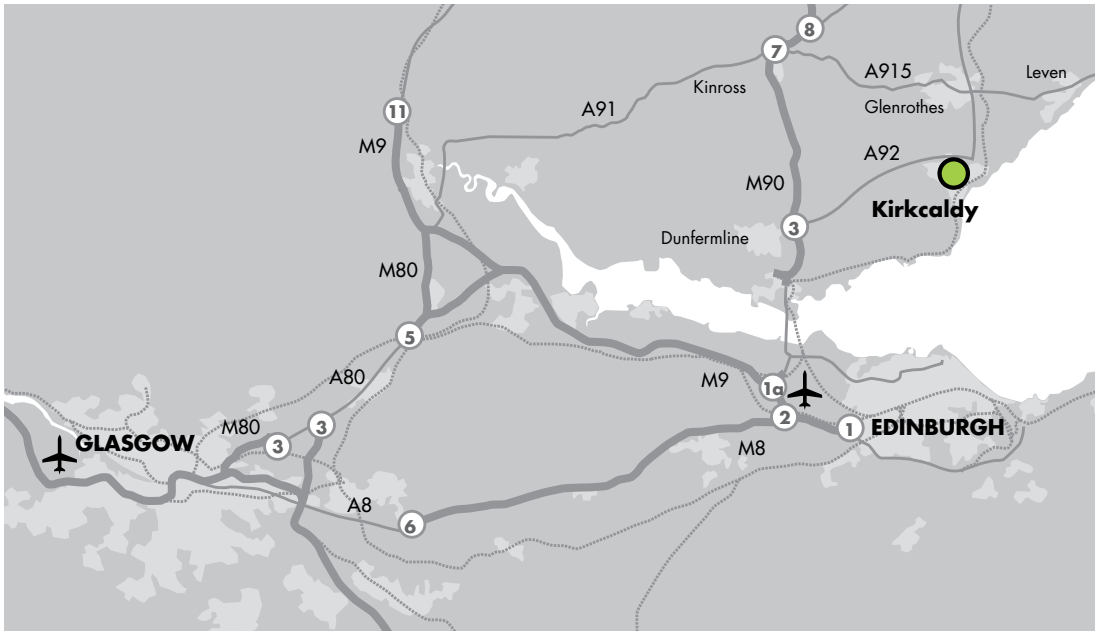

Further Information and Viewing Arrangements

By contacting the selling agents:-

Ryden
46 Castle Street
EDINBURGH
EH2 3BN

Tel No. 0131 225 6612
Fax No. 0131 225 5766

Email: neil.mcallister@ryden.co.uk
alan.herriot@ryden.co.uk
gordon.archibald@ryden.co.uk

Hardies
Property & Construction Consultants
18C Dickson Street
DUNFERMLINE
Fife
KY12 7SL

Tel: 01383 731841
Fax: 01383 739714

Email: ken.young@hardies.co.uk
david.marr@hardies.co.uk
elaine.blackadder@hardies.co.uk

Ryden.co.uk
0131 225 6612

Hardies
PROPERTY & CONSTRUCTION CONSULTANTS
01383 731841

Messrs Ryden and Hardies Property and Construction Consultants for themselves and for vendors or lessors of this property whose agents they are give notice that: (i) the particulars are set out as a general outline only for the guidance of intended purchasers or lessees, and do not constitute, nor constitute part of, an offer or contract; (ii) all descriptions, dimensions, reference to condition and necessary permissions for use and occupation, and other details are given without responsibility and any intending purchasers or tenants should not rely on them as statements or representations of fact but must satisfy themselves by inspection or otherwise as to the correctness of each of them; (iii) no person in the employment of Messrs Ryden and Hardies Property and Construction Consultants have any authority to make or give any representation or warranty whatever in relation to this property.

Date of publication: February 2007