

Parking Lot

Bay Door/Loading

Parking Entrance

15 Ton A/C

Elephant Doors

### STAGE A

65 x 50  
3250 Sq ft.

# Burbank EMPIRE STAGES

2919 Thornton Ave. Burbank CA 91504

**Heather Haase: 310.420.3394**

- 2 Stages (Over 4500 sq. ft.)
- 15 Ton A/C (Stage A)
- 5 Ton A/C (Stage B)
- Central A/C (Offices/Utility)
- 1 GB Wi Fi
- 24 Onsite Parking Spaces
- Parking Overflow available
- L&G Package available
- Screening Room (132" screen)
- 10 - 15 Offices
- 2 - 4 Dressing Rooms
- Utility Sinks
- 4 Bathrooms
- 2 Vanity Rooms
- Wardrobe
- Shower
- 2 Street Entrances
- Elephant Doors

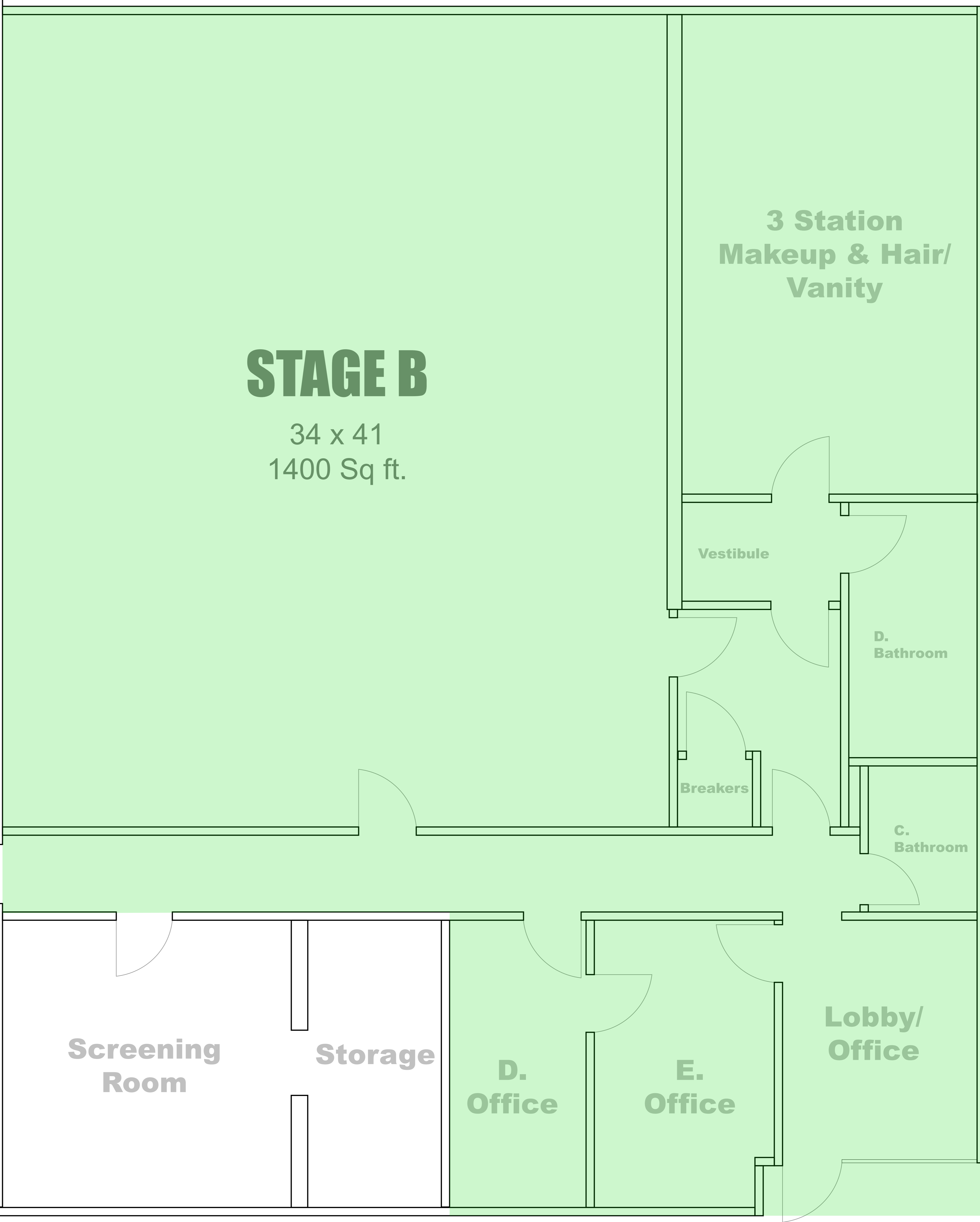


Thornton Ave - Street