

MONCRIEFF

BUSINESS CENTER

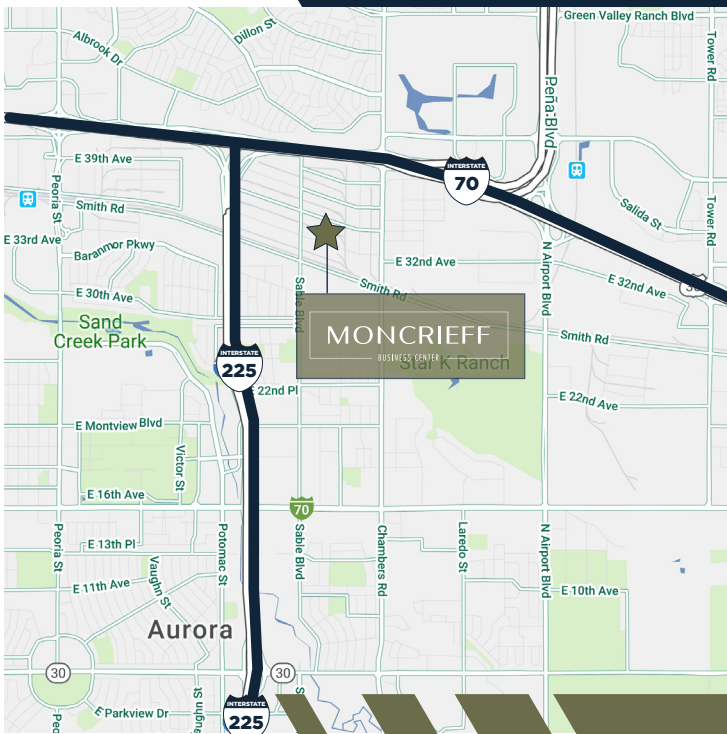

14603 E. MONCRIEFF PLACE, AURORA, CO 80011



PROPERTY FUNDAMENTALS

AVAILABLE: 57,142 SF

OFFICE: 12,210 SF

LOADING: 4 DOCK-HIGH DOORS, 1 DRIVE-IN DOOR, 4 RAIL DOORS

CLEAR HEIGHT: 22' – 24'

COLUMN SPACING: 42' X 32'

SPRINKLERS: ESFR

HEAVY POWER: UP TO 1,600 AMPS, 480 VOLT, 3 PHASE
(TO BE VERIFIED)

PARKING RATIO: 0:89 PER 1,000 SF

ZONING: M-1 INDUSTRIAL

LEASE RATE: NEGOTIABLE

NNN EXPENSES (2018): ±\$2.27



New LED lights throughout



Existing solar shades in office



±14,700 SF Yard Available



New carpet and paint in office



Prime location near I-70 & I-225

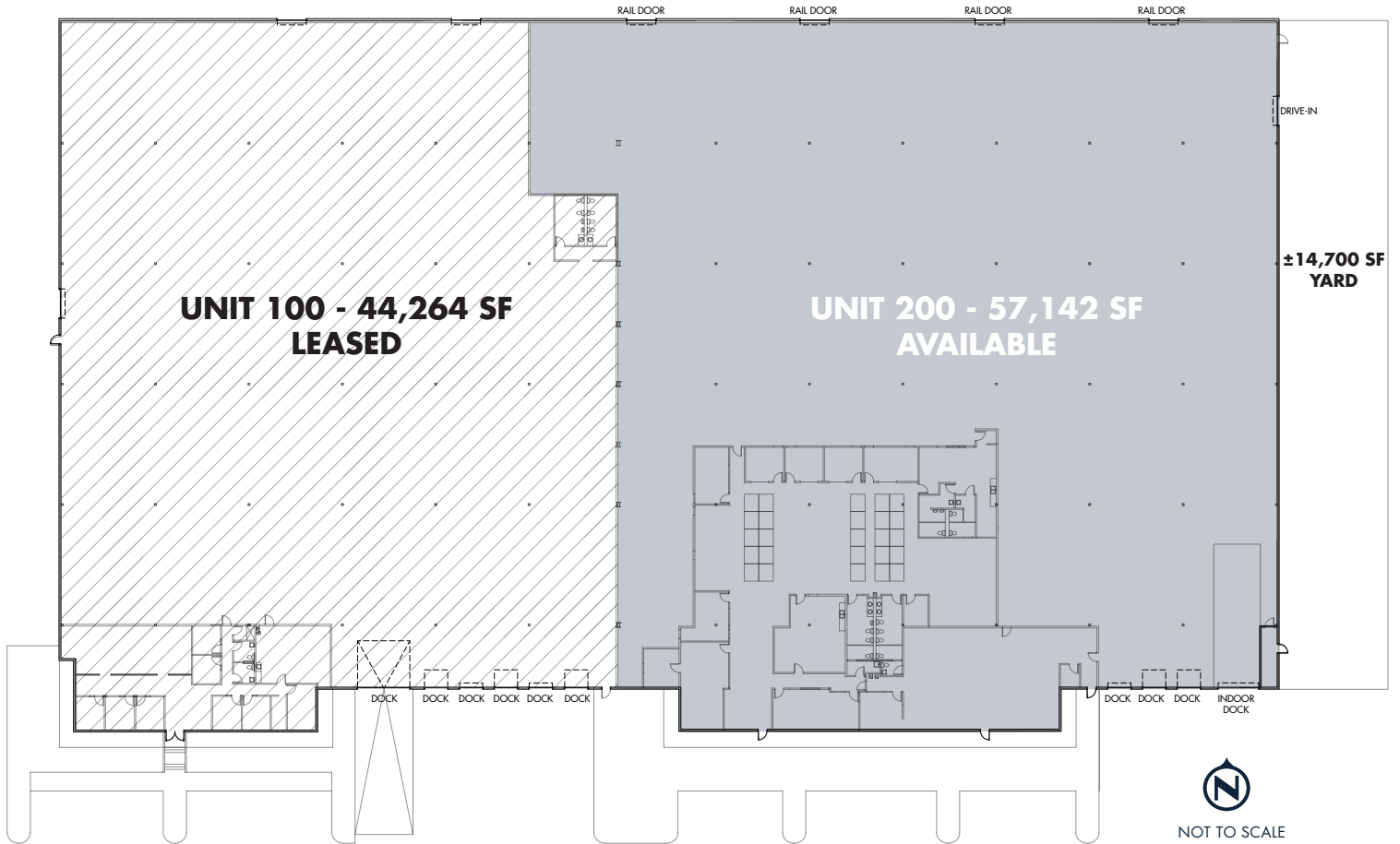

CONTACTS

Tyler Carner

Senior Vice President
+1 303 264 1903
tyler.carner@cbre.com

Jeremy Ballenger

Senior Vice President
+1 303 264 1902
jeremy.ballenger@cbre.com

Jim Bolt

Executive Vice President
+1 720 528 6310
james.bolt@cbre.com



© 2019 CBRE, Inc. All rights reserved. This information has been obtained from sources believed reliable, but has not been verified for accuracy or completeness. Any projections, opinions, or estimates are subject to uncertainty. The information may not represent the current or future performance of the property. You and your advisors should conduct a careful, independent investigation of the property and verify all information. Any reliance on this information is solely at your own risk. CBRE and the CBRE logo are service marks of CBRE, Inc. All other marks displayed on this document are the property of their respective owners. Photos herein are the property of their respective owners. Use of these images without the express written consent of the owner is prohibited. PMSStudio_January2019