



TRANSWESTERN

REAL ESTATE
SERVICES

ONE SOUTHGATE

6892 South Yosemite Court, Centennial, CO 80112



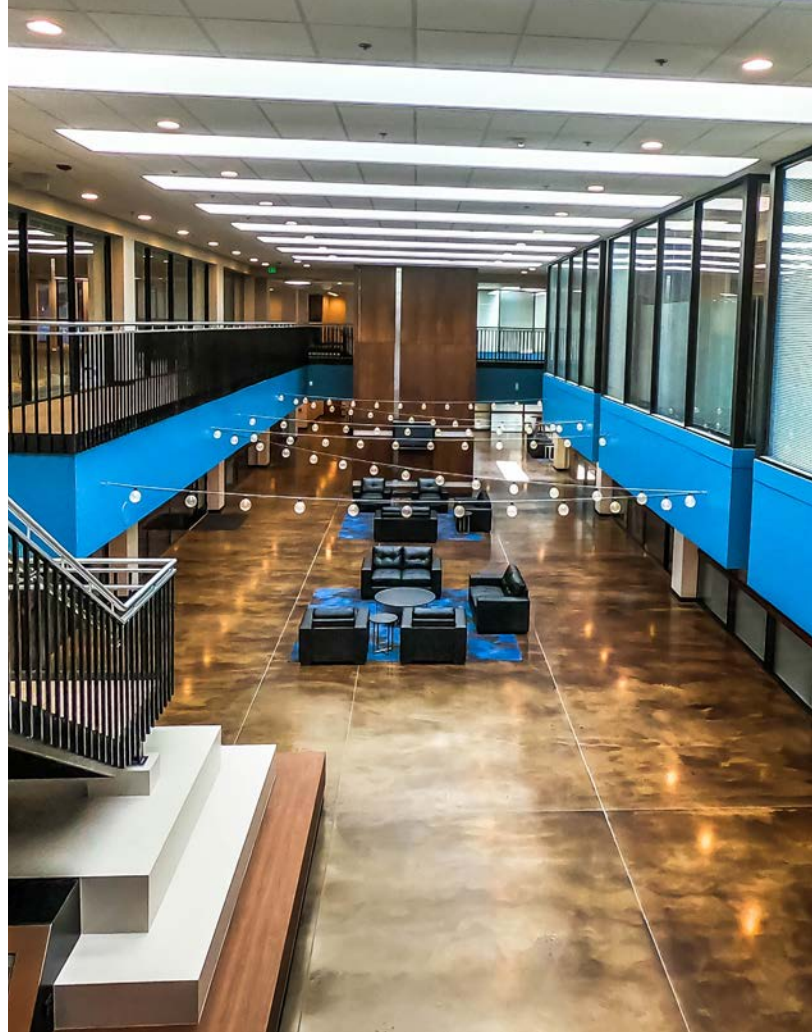

BUILDING FEATURES

- » Total building area is 70,154 RSF
- » Total building renovation
- » Building signage available for large tenant
- » Monument signage facing Yosemite
- » Parking ratio is 3/1,000 SF, surface
- » Limited Covered Parking available at 1/5,000 SF
- » Full-height exterior glass throughout
- » Comcast and Level 3 Fiber optics in building
- » Underground storage available
- » Great mountain views
- » Easy access off I-25 at Arapahoe Rd & Dry Creek Rd

CURRENT AVAILABILITIES

FLOOR	SUITE	RSF
First	1-105	3,947
Second	1-201	8,304
First	2-103	1,949
First	2-104	1,056
First	3-101	12,018



Contiguous Option
Suite 103 & 104
up to 3,005 SF



SOUTHGATE SHOPPING CENTER

- Twin Peaks
- Finn McCool's
- Madurai Mes Indian Cuisine
- Chocklo Latin Street Food
- Hong Kong Station
- First Watch

ARAPAHOE MARKETPLACE

- Sprouts
- Red Robin
- Papa Murphy's
- Modmarket
- Five Guys
- Torchy's Tacos
- Starbucks
- Poke City
- Teriyaki Madness
- Baker's Way
- Tocabe
- Benedict's
- Chuy's

OTHER

- Tokyo Joe's
- Sabroso
- My Favorite Muffin
- ViewHouse
- Landry's Seafood House
- Maggiano's Little Italy
- Eddie Merlot's
- Three Little Griddles
- Smashburger
- Marcos
- Metropolitan Grill
- Chipotle
- Jimmy John's
- Dairy Queen
- Einstein Bros Bagels
- Arby's
- McDonald's
- Papa John's
- Taco Bell
- Bono's Pit Bar-B-Q

ONE SOUTHGATE

Close proximity to numerous restaurants, hotels, daycares and stores



ONE SOUTHGATE

FOR LEASING INFORMATION CONTACT

DAVID SHAPIRO

303.407.1466

david.shapiro@transwestern.com

Notice to prospective real estate tenants: Transwestern and its agents will be acting as agents of Landlord with the duty to represent Landlord's interests, and will not be your agent. Transwestern does not offer subagency to outside brokers. The information provided herein was obtained from sources believed reliable; however, Transwestern makes no guarantees, warranties or representations as to the completeness or accuracy thereof. The presentation of this property is submitted subject to errors, omissions, change of price or conditions, prior to sale or withdrawal without notice. Copyright © 2021 Transwestern®.

 **TRANSWESTERN** REAL ESTATE SERVICES

5251 DTC PARKWAY, SUITE 1100, GREENWOOD VILLAGE, CO 80111