

AVAILABLE
LEASED

SOUTHWEST CANCER
TREATMENT CENTER
not a part - 95,369 SF

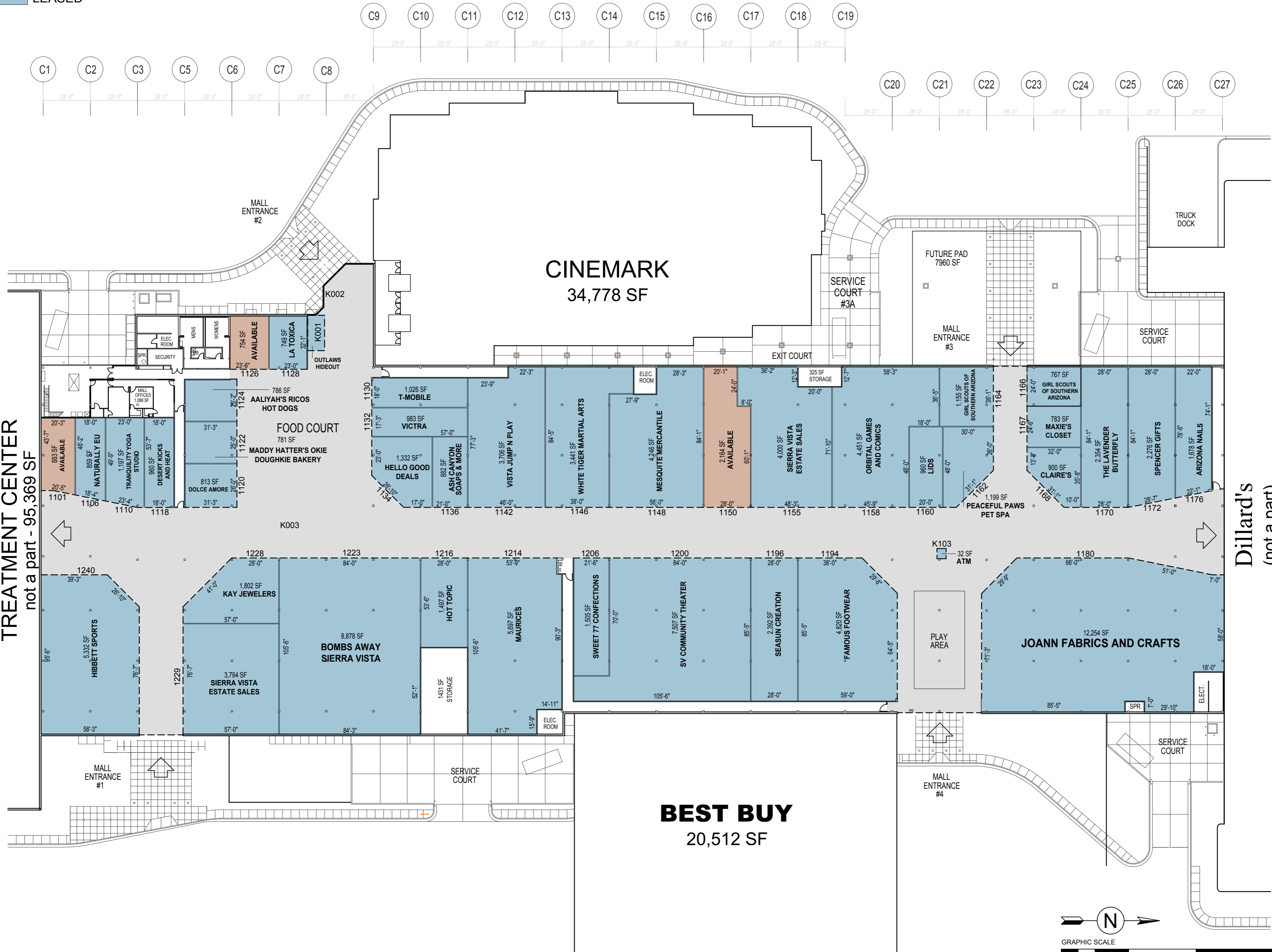

THE MALL AT SIERRA VISTA

2200 EL MERCADO LOOP
SIERRA VISTA, ARIZONA 85635

Dillard's
(not a part)
101,123 SF

BEST BUY
20,512 SF

TENANT NAMES SHOWN ON THIS PLAN REPRESENT LEASES WHICH ARE EXECUTED, OUT FOR SIGNATURE, OR IN NEGOTIATION. SPECIFIC NAMES, LOCATIONS, DIMENSIONS OF ANY STORE, ENTRANCE, OR IMPROVEMENT ARE SUBJECT TO CHANGE, MODIFICATION AND DELETION BY LANDLORD OR OTHER PARTIES, AND ARE NOT A REPRESENTATION OF, OR WARRANTY AS TO THE OPENING OR CONTINUED OPERATION OF ANY STORE NAMED OR DEPICTED ON THIS PLAN.

NOTWITHSTANDING THAT CERTAIN OF THE ELEMENTS, INCLUDING BUT NOT LIMITED TO THE TENANT NAMES, SHOWN ON THIS PLAN MAY BE INDICATED AS FUTURE OR PROPOSED, LANDLORDS MAKE NO REPRESENTATION THAT THE FUTURE DEVELOPMENT WILL OCCUR AS SHOWN.

ALL TENANT LEASE AREAS ARE MEASURED FROM THE CENTERLINE OF INTERIOR PARTITION, FROM THE OUTSIDE FACE OF EXTERIOR WALL, FROM THE FULL THICKNESS OF CORRIDOR AND SHAFT WALLS AND FROM THE EDGE OF SLAB AT ANCHOR STORE WALLS.

PROJECT NO: 021
DRAWN BY: JB
© SUMMIT PROPERTIES

DESCRIPTION
LEASE PLAN

SHEET NO.
LP1

DATE: February 2024

