

Trade Center V

Suite 300

2450 Esters Blvd
DFW Airport, Texas 76051

24,940 SF Available

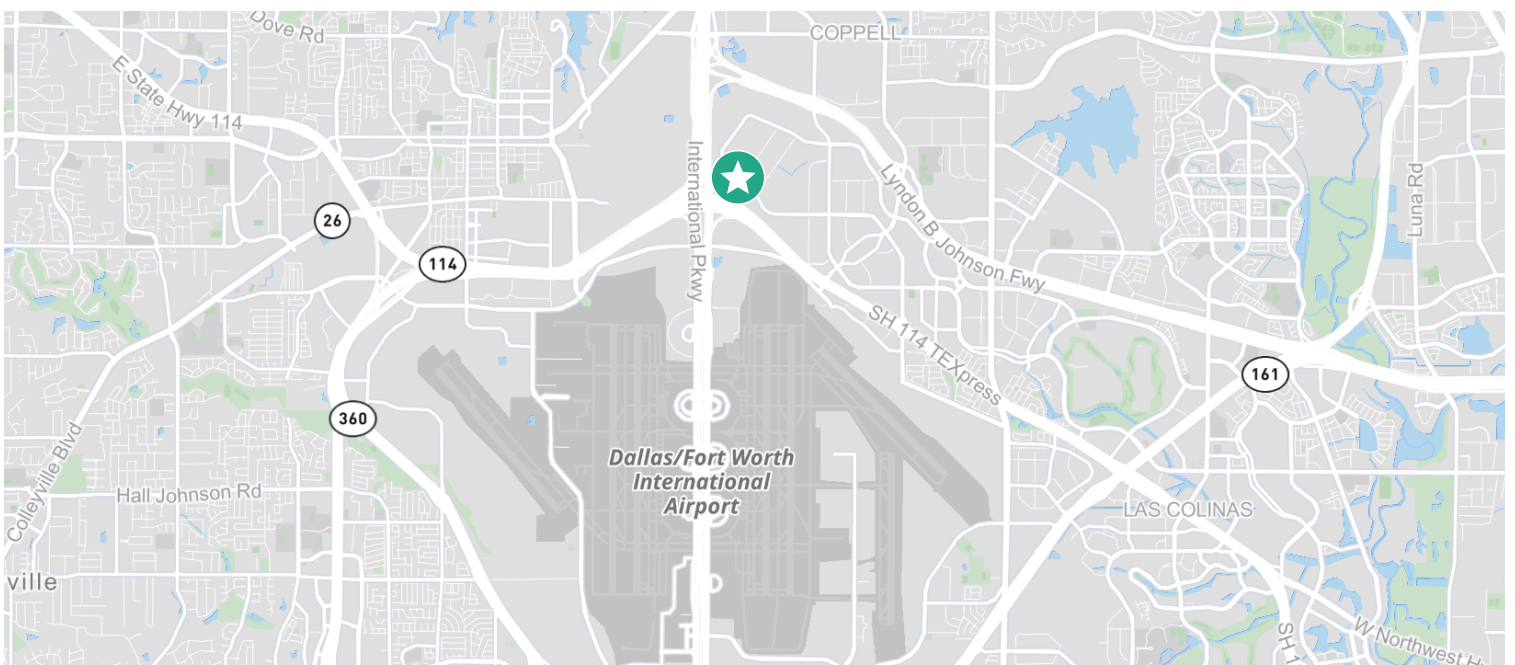

Trade Center V

2450 Esters Blvd | DFW Airport, Texas 76051

For Lease

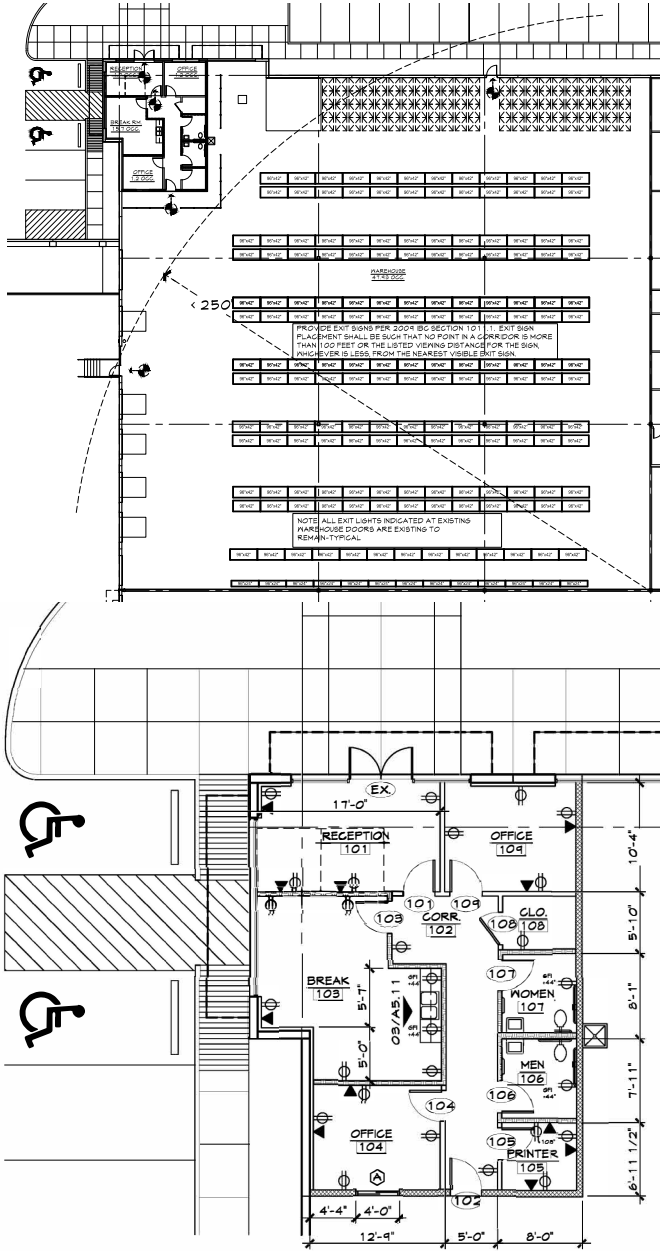

24,940 SF available



~ 1,400 SF office space



30' Clear Height



Front Load Configuration



(6) dock high loading doors, (5) pit levelers



(1) 12' x 14' ramped loading doors



50' x 50' typical column spacing,
60' deep staging bay



(6) Trailer Park Positions



4' x 8' skylights, every other bay



ESFR Sprinkler



Foreign Trade Zone



Triple Freeport

Contact Us

Steve Trese

Executive Vice President
+1 214 979 6534
steve.trese@cbre.com

Wilson Brown

Senior Vice President
+1 214 979 6582
wilson.brown@cbre.com

© 2025 CBRE, Inc. All rights reserved. This information has been obtained from sources believed reliable, but has not been verified for accuracy or completeness. You should conduct a careful, independent investigation of the property and verify all information. Any reliance on this information is solely at your own risk. CBRE and the CBRE logo are service marks of CBRE, Inc. All other marks displayed on this document are the property of their respective owners, and the use of such logos does not imply any affiliation with or endorsement of CBRE. Photos herein are the property of their respective owners. Use of these images without the express written consent of the owner is prohibited.

