

# FOR LEASE

1,250 SF | \$3.71/SF/MO. NNN

## Robal Road Village Retail Space

20504 Robal Ln, Bend, OR 97703



### PROPERTY DETAILS

- Avail. Space:** Suite 110 – 1,250 SF
- Sublease Rate:** \$3.71/SF/Mo. NNN
- CAMs:** Est. at \$0.62/SF/Mo.
- Bldg. Size:** 8,539 SF
- Year Built:** 2017
- Zoning:** Commercial General (CG)
- Parking:** Large onsite parking lot

### HIGHLIGHTS

- Class A shopping center located in Bend's Golden Triangle (Hwy 97/Hwy 20/Cooley Rd)
- Great tenant synergy
- Co-tenants include Chick-fil-A, Chipotle Mexican Grill, Kefi Mediterranean, Mud Bay, Mod Pizza, Ulta Beauty, Cracker Barrel and more
- Suite is located next door to Black Rock Coffee
- High traffic counts exceeding 40,765 AADT

Russell Huntamer, CCIM | Peter May, CCIM

600 SW Columbia St., Ste. 6100 | Bend, OR 97702

541.383.2444 | [www.CompassCommercial.com](http://www.CompassCommercial.com)

COMPASS  
COMMERCIAL

REAL  
ESTATE  
SERVICES

# FOR LEASE

## Robal Road Village Retail Space

20504 Robal Ln, Bend, OR 97703

1,250 SF | \$3.71/SF/MO. NNN

### FLOOR PLAN

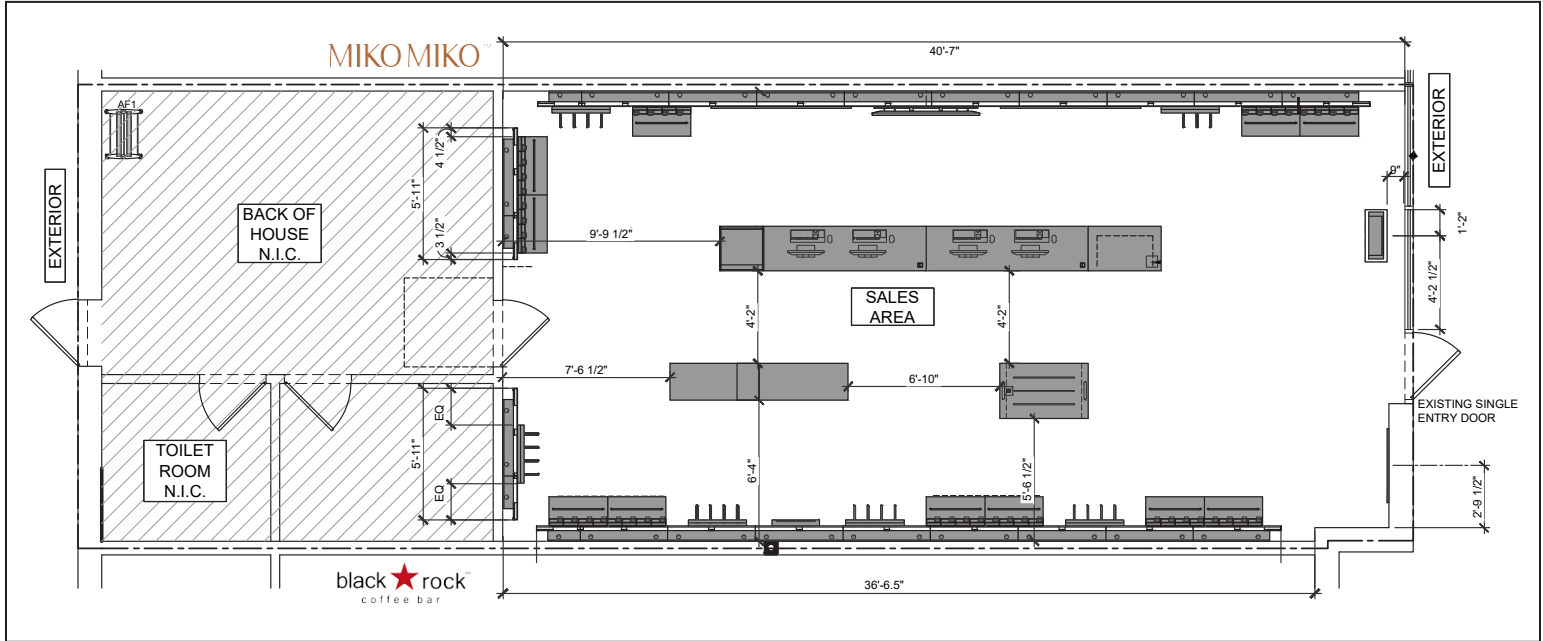

Brokers are licensed in the state of Oregon. This information has been furnished from sources we deem reliable, but for which we assume no liability. This is an exclusive listing. The information contained herein is given in confidence with the understanding that all negotiations pertaining to this property be handled through Compass Commercial Real Estate Services. All measurements are approximate.



**Russell Huntamer, CCIM**  
Partner, Principal Broker  
Cell 541.419.2634  
rh@compasscommercial.com



**Peter May, CCIM**  
Partner, Principal Broker  
Cell 541.408.3888  
pmay@compasscommercial.com

**COMPASS**  
COMMERCIAL

**REAL ESTATE**  
SERVICES