

FOR LEASE

High Image
Industrial Park
Corner Unit

Emerald Corporate Park

4104 C Street NE, Suite 100, Auburn, WA

Auburn industrial space with convenient proximity to major transportation routes.

PROPERTY HIGHLIGHTS

- + 30' clear height
- + 7 DH & 1GL (4 of 7 dock doors with levelers in place)
- + ESFR sprinkler system
- + Built in 2001
- + Corner unit with ample parking
- + Call for rates
- + Available immediately

ARIE SALOMON, SIOR, CCIM

Principal
+1 425 586 5636
asalomon@nai-psp.com

JEFF FORSBERG, CCIM

Principal
+1 425 586 5610
jforsberg@nai-psp.com

BRET MATYSIK

Partner
+1 425 586 5617
bmatysik@nai-psp.com



THE INFORMATION CONTAINED HEREIN HAS BEEN GIVEN TO US BY THE OWNER OF THE PROPERTY OR OTHER SOURCES WE DEEM RELIABLE, WE HAVE NO REASON TO DOUBT ITS ACCURACY, BUT WE DO NOT GUARANTEE IT. ALL INFORMATION SHOULD BE VERIFIED PRIOR TO PURCHASE OR LEASE.

TOTAL SF

38,628 SF

OFFICE SF

1,990 SF

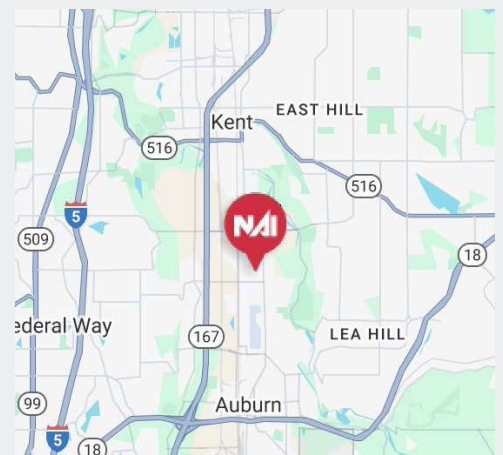

Floor Plan

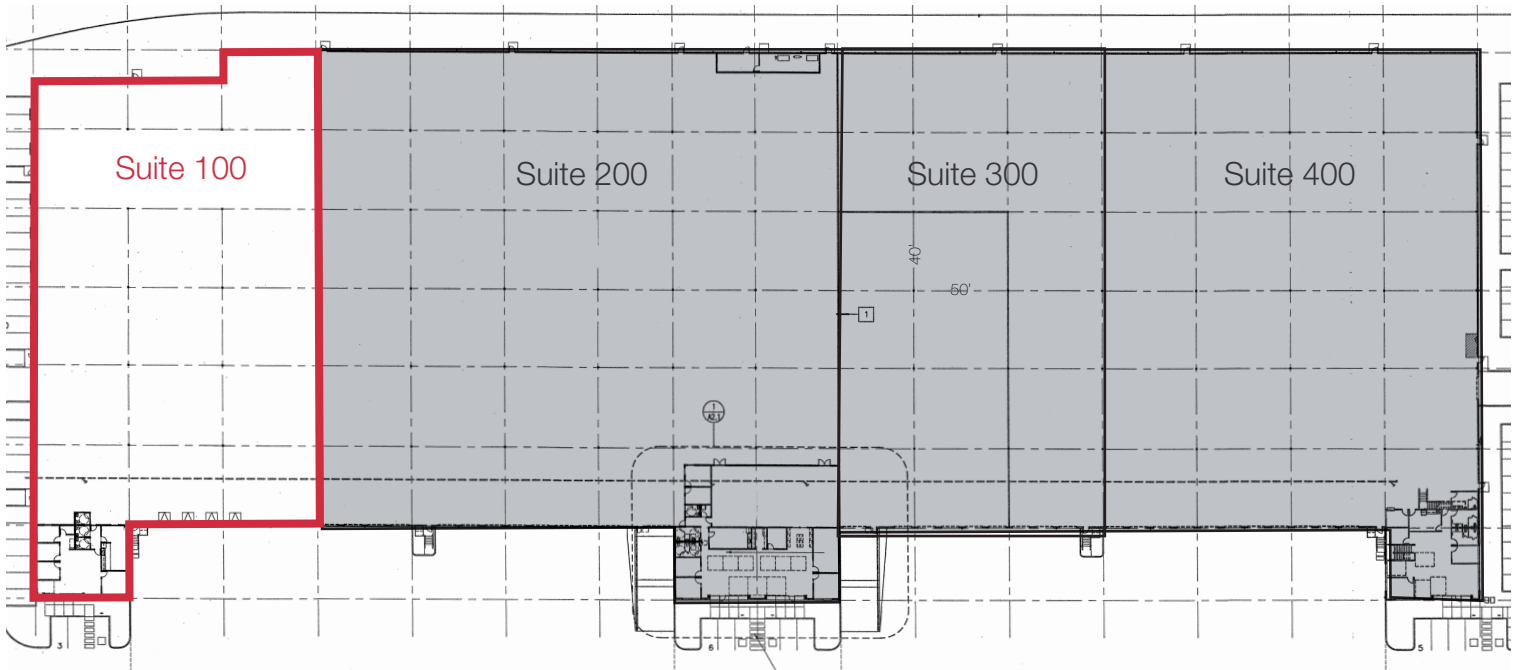
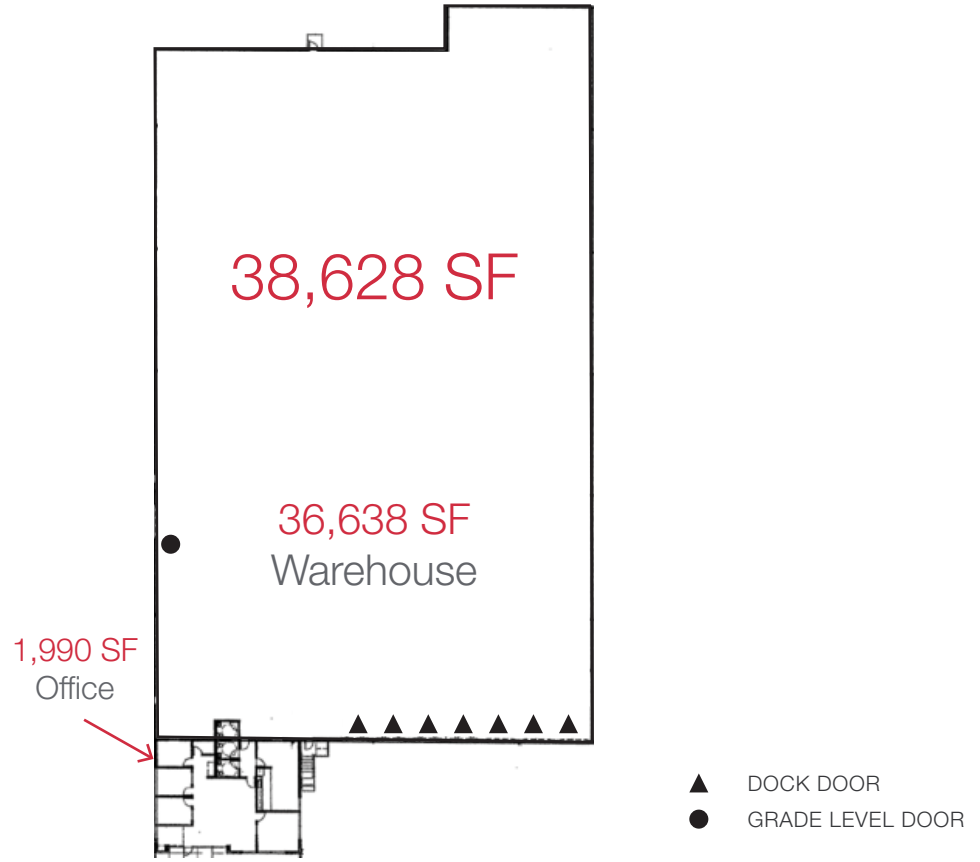

ARIE SALOMON, SIOR, CCIM
Principal
+1 425 586 5636
asalomon@nai-ppsp.com

JEFF FORSBERG, CCIM
Principal
+1 425 586 5610
jforsberg@nai-ppsp.com

BRET MATYSIK
Partner
+1 425 586 5617
bmatysik@nai-ppsp.com

