

Majestic Airport Center DFW
Bldg 2 Suite 100
 2730 Edmonds Lane
 Lewisville, Texas 75067

S.F. Summary

MAIN OFFICE AREA	12,132 SQ. FT.
MATERIALS STORAGE	1,904 SQ. FT.
WAREHOUSE STORAGE & CLIMATE CONTROLLED STORAGE	2,055 SQ. FT.
WAREHOUSE	52,601 SQ. FT.
GRAND TOTAL	68,692 SQ. FT.

Building Features

- 32' CLEAR HEIGHT
- FULLY SPRINKLERED
- (16) 9W x 10H O.H. DOCK HIGH DOORS; (6) WITH LEVELERS
- (6) WITH LEVELERS
- (1) 12W x 14H O.H. DOCK HIGH DOOR WITH RAMP
- AMPLE PARKING
- EASY ACCESS TO MAJOR THOROUGHFARES

For Leasing Information Contact:

Al Sorrels
 Email: asorrels@majesticrealty.com



131 E. Exchange Ave Suite 220 Fort Worth, TX 76164
 (972) 726-0700 Fax (972) 726-0710

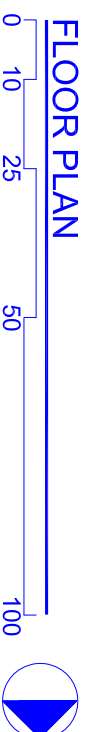
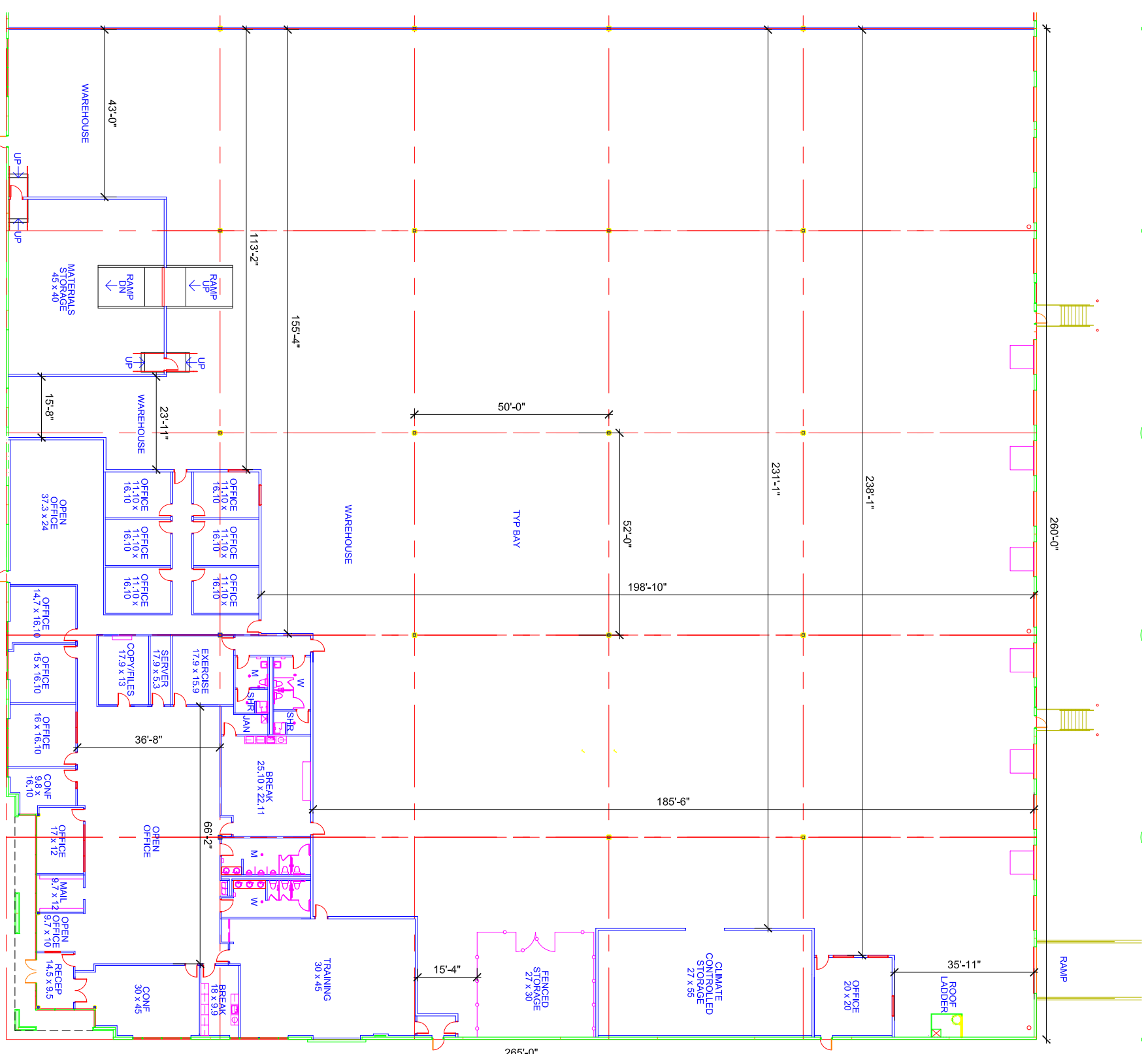

FLOOR PLAN