

Former Sears Flagship Woodfield Mall - Schaumburg, IL



For more information, please contact:

Brendan Reedy

+1 312.297.7614
 Brendan.Reedy@cbre.com

Sean McCourt

+1 312.297.7688
 Sean.Mccourt@cbre.com

Jimmy Danaher

+1 312.540.4601
 Jimmy.Danaher@cbre.com

Joe Parrott, CRRP, CRX, CLS

+1 312.297.7680
 Joe.Parrott@cbre.com

CBRE
 TRANSFORMCO

Site details

TRAFFIC

- #1 Shopping Destination in Illinois
- 17 Million Annual Visits
- 2 Million Square Feet

AFFLUENT DEMOGRAPHICS

- 1.4 Million Trade Area Population
- \$110,000 Average HH Income
- Nearly 1 million Employees

TOP SUBURBAN LOCATIONS-HOME TO

- 30 + hotels
- 30 Million SF of office, Industrial and retail space
- 200+ Restaurants
- \$2.9 Billion annual retail sales

EASY ACCESS

- Just off I-90, I-290 & IL-53
- 5+ traffic light entrances

RETAIL CO-TENANCY

- 280+ Brands
- Trend Ahead Brands
- Best In Class Brands
- Nordstrom, Apple, Sephora, Morphe, Michael Kors, Coach, Superdry



Proposed Outlot Configuration



Site plan

Level 1 Conceptual Demising Plan

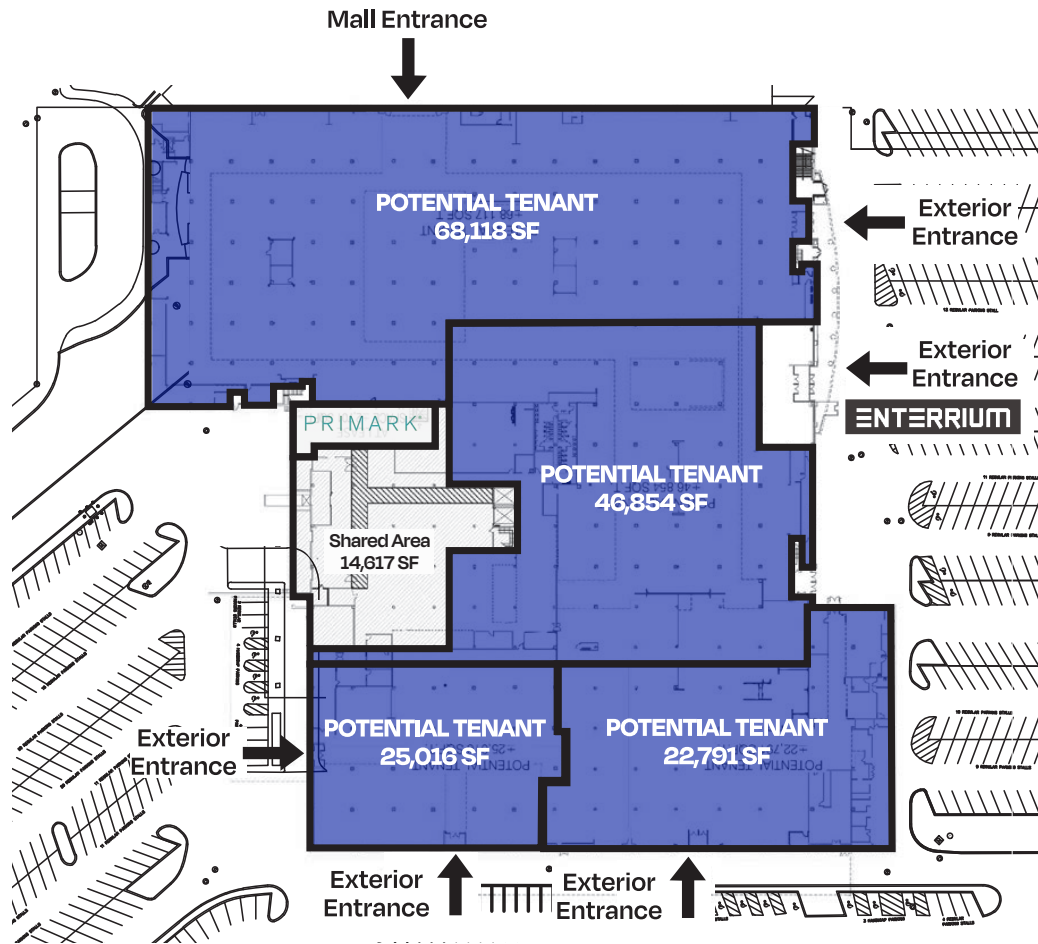

Level 2 Floor Plan

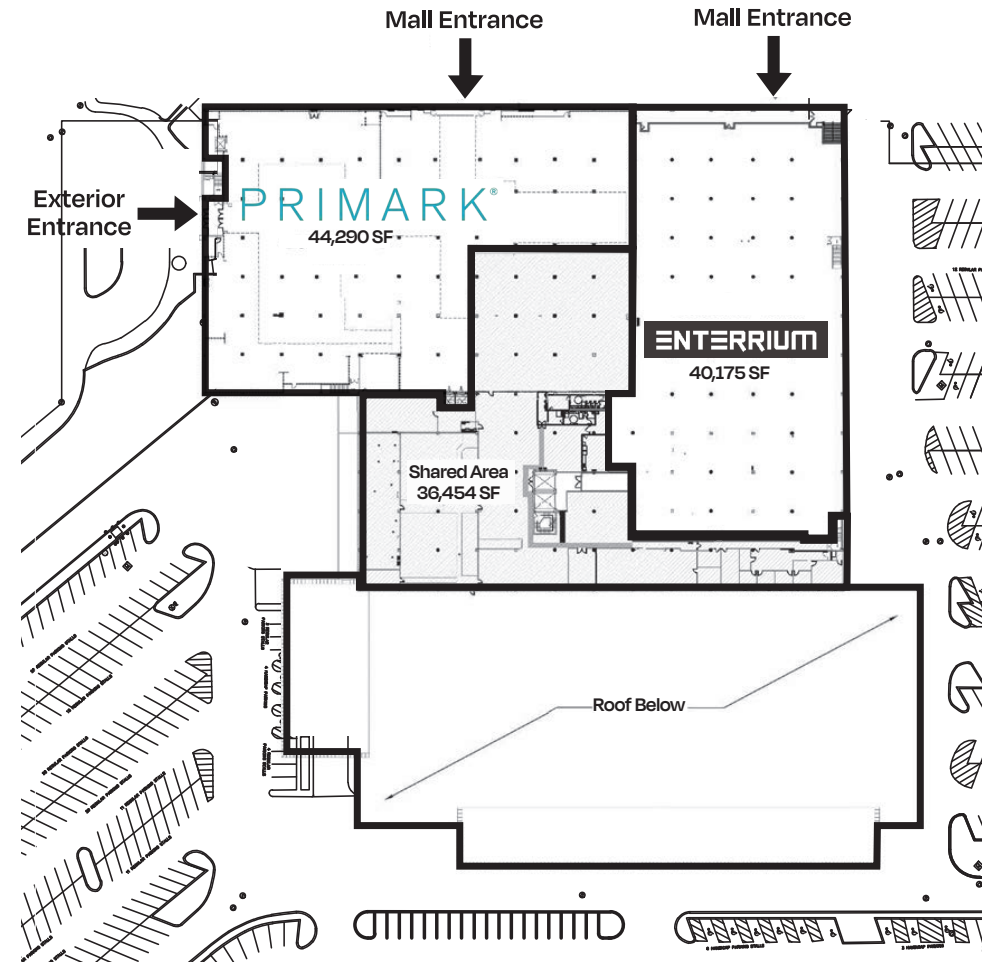

location overview





area demographics



Total
Population

81,609

3 MILE



Daytime
Population

131,816

3 MILE



Avg Household
Income

\$127,327

3 MILE



Consumer
Expenditure

\$170.8M

DINING - 3 MILE

\$96.1M

APPAREL - 3 MILE

Former Sears Flagship Woodfield Mall - Schaumburg, IL



For more information, please contact:

Brendan Reedy

+1 312.297.7614
 Brendan.Reedy@cbre.com

Sean McCourt

+1 312.297.7688
 Sean.Mccourt@cbre.com

Jimmy Danaher

+1 312.540.4601
 Jimmy.Danaher@cbre.com

Joe Parrott, CRRP, CRX, CLS

+1 312.297.7680
 Joe.Parrott@cbre.com

©2023 CBRE, Inc. All rights reserved. This information has been obtained from sources believed reliable, but has not been verified for accuracy or completeness. You should conduct a careful, independent investigation of the property and verify all information. Any reliance on this information is solely at your own risk. CBRE and the CBRE logo are service marks of CBRE, Inc. All other marks displayed on this document are the property of their respective owners, and the use of such logos does not imply any affiliation with or endorsement of CBRE. Photos herein are the property of their respective owners. Use of these images without the express written consent of the owner is prohibited.

CBRE
 TRANSFORMCO