



## NEARBY RETAILERS



## RETAIL PAD(S) FOR LEASE/ BTS

- Pad opportunities for Retail/Daycare
- Just off Rt 29 & Rt 198 interchange
- Right in, right out access & accessible to signalized intersection
- Dense Retail trade area with strong traffic counts

**BOB BROWNING**

bbrowning@klnb.com | 703-268-2717

**CHRIS O'BRIEN**

cobrien@trustpointcre.com | 240-418-9865

# LOCATION

# MD-198 & SANDY SPRING

Dino Drive, Burtonsville, MD 20866

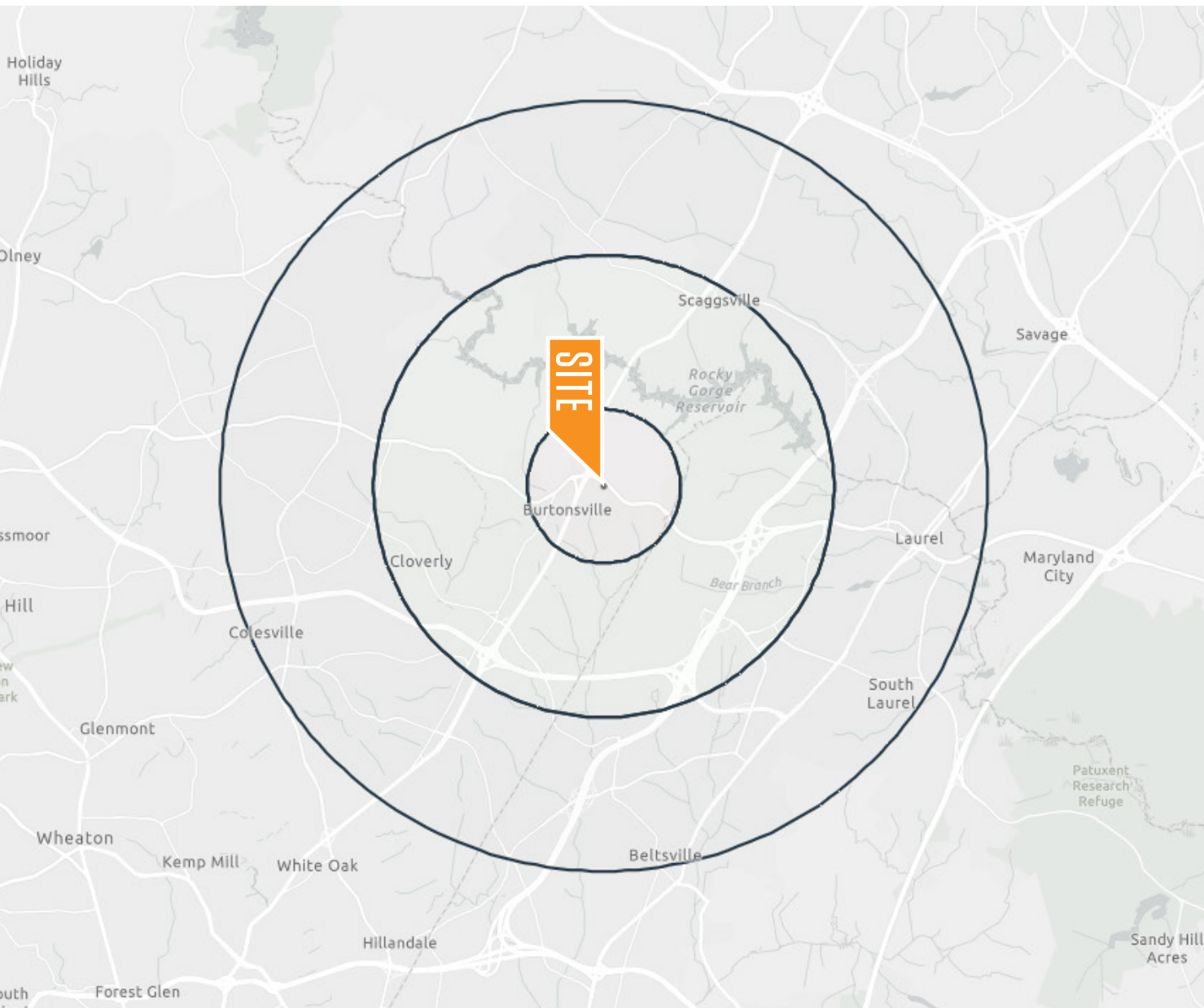

## DEMOGRAPHICS | 2025:

1-MILE	3-MILE	5-MILE
Population		
5,787	49,234	140,699
Daytime Population		
4,746	39,345	137,957
Households		
1,847	17,325	49,972
Average HH Income		
\$165,240	\$154,696	\$147,776

[CLICK TO DOWNLOAD DEMOGRAPHIC REPORT](#)

## TRAFFIC COUNTS | 2022:

Old Columbia Pike	38,222 ADT
Columbia Pike	63,963 ADT

**BOB BROWNING**

bbrowning@klnb.com | 703-268-2717

**CHRIS O'BRIEN**

cobrien@trustpointcre.com | 240-418-9865



# SITE PLAN

# MD-198 & SANDY SPRING

Dino Drive, Burtonsville, MD 20866

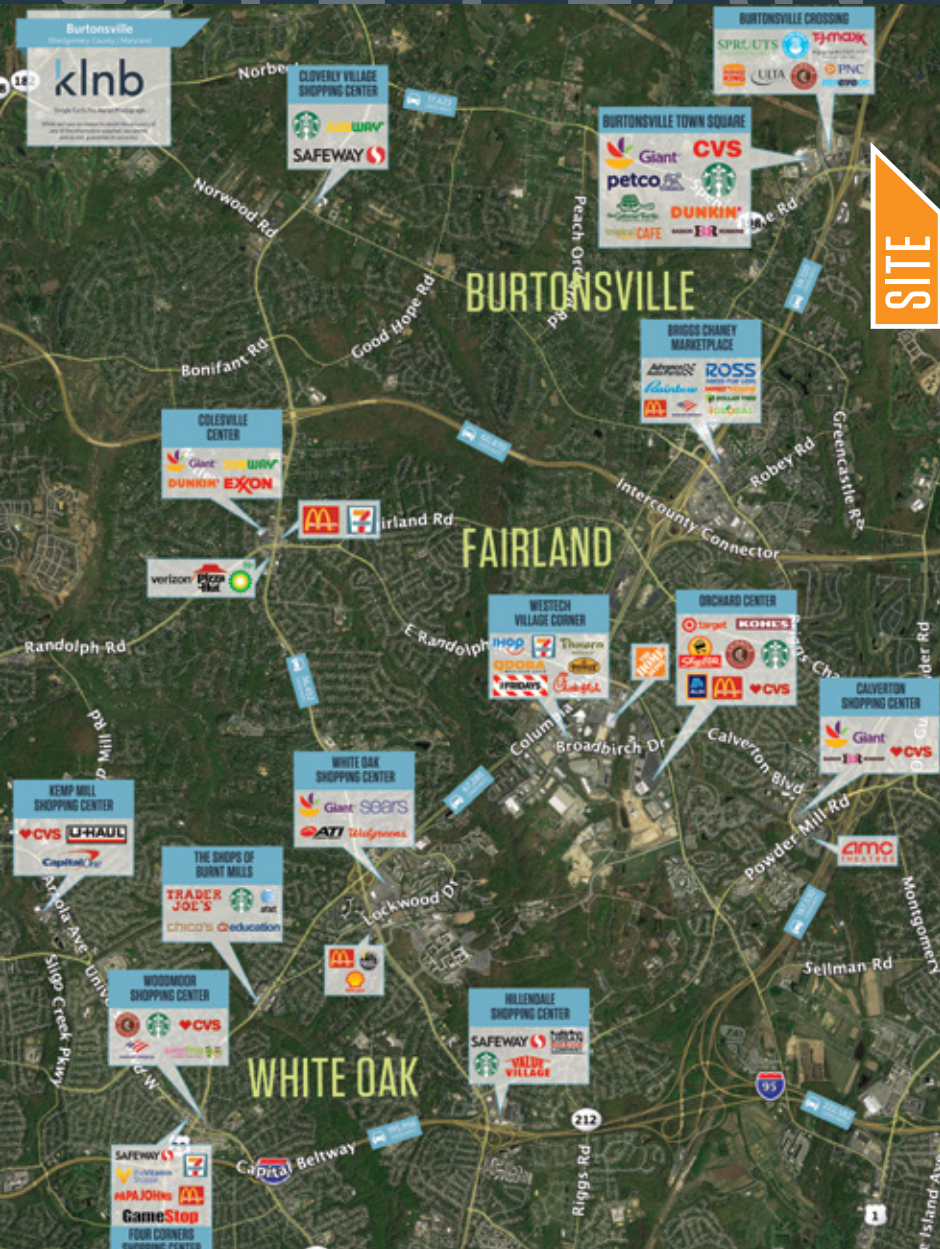

**SITE**

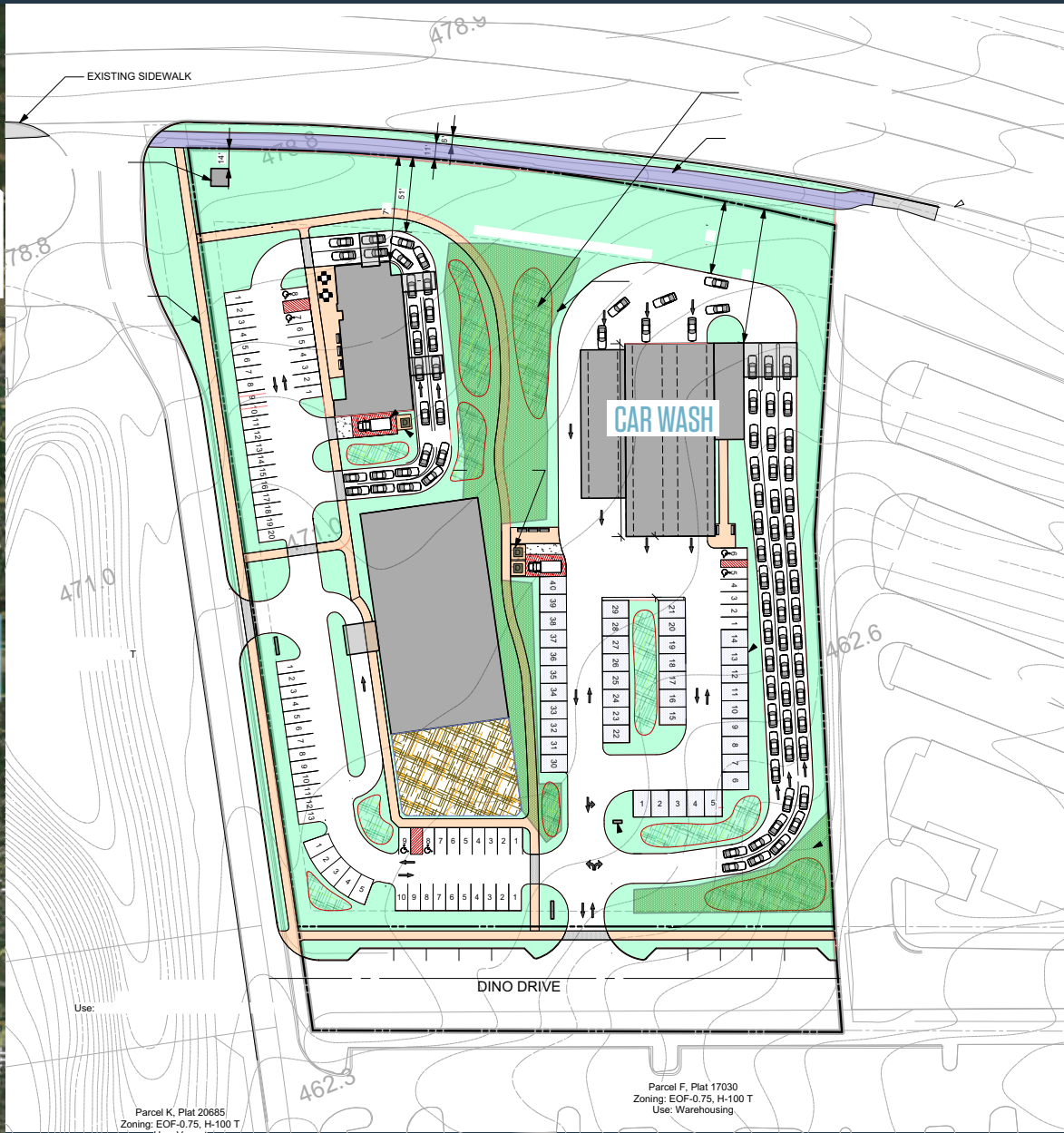

Parcel K, Plat 20685  
Zoning: EOF-0.75, H-100 T

Parcel F, Plat 17030  
Zoning: EOF-0.75, H-100 T  
Use: Warehousing

**BOB BROWNING**  
bbrowning@klnb.com | 703-268-2717

**CHRIS O'BRIEN**  
cobrien@trustpointcre.com | 240-418-9865



# CLOSEUP

# MD-198 & SANDY SPRING

Dino Drive, Burtonsville, MD 20866



**BOB BROWNING**

bbrowning@klnb.com | 703-268-2717

**CHRIS O'BRIEN**

cobrien@trustpointcre.com | 240-418-9865



# OVERVIEW

# MD-198 & SANDY SPRING

Dino Drive, Burtonsville, MD 20866



**BOB BROWNING**

bbrowning@klnb.com | 703-268-2717

**CHRIS O'BRIEN**

cobrien@trustpointcre.com | 240-418-9865





# MD-198 & SANDY SPRING

Dino Drive, Burtonsville, MD 20866

## FOR MORE INFORMATION, PLEASE CONTACT:

### **BOB BROWNING**

bbrowning@klnb.com  
703-268-2717

### **CHRIS O'BRIEN**

cobrien@trustpointcre.com  
240-418-9865

12435 Park Potomac Ave, Suite 250, Rockville, MD 20855

.....  
**klnb.com**



[instagram.com/klnbcre](https://www.instagram.com/klnbcre)



[linkedin.com/company/klnb](https://www.linkedin.com/company/klnb)



[facebook.com/KLNBCRE](https://www.facebook.com/KLNBCRE)

**CLICK TO VIEW PROPERTY WEBSITE**

While we have no reason to doubt the accuracy of any of the information supplied, we cannot, and do not, guarantee its accuracy. All information should be independently verified prior to a purchase or lease of the property. We are not responsible for errors, omissions, misuse, or misinterpretation of information contained herein and make no warranty of any kind, express or implied, with respect to the property or any other matters.