

# MIDBOX SPACE FOR LEASE FORMER SPORTS AUTHORITY

1301 N MILWAUKEE • BOISE, IDAHO 83704

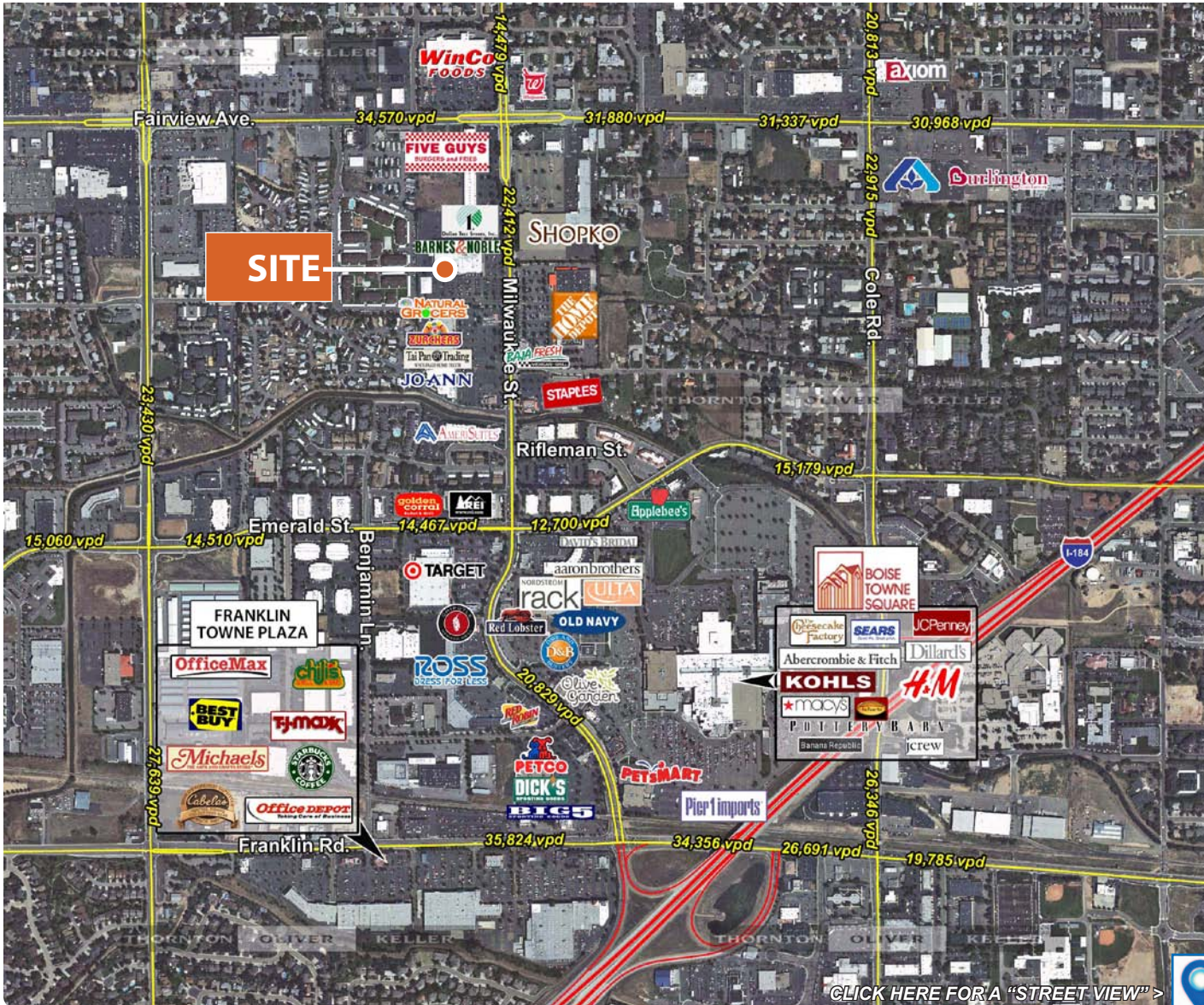

CLICK HERE FOR A "STREET VIEW" >



**AVAILABLE SPACE:**

RSF:	RATE:
45,000 SF	\$11.95/SF NNN

**LISTING COMMENTS:**

- Great mall area location.
- Top position on pylon sign.
- Immediate occupancy.
- 26' open ceiling.
- Shadow anchored by Home Depot, Natural Grocers, Tai Pan Trading and JoAnn Fabrics.

**CONTACT:**

**Mark Schlag, CCIM, CLS**  
 Ph: 208.947.0817  
 marks@tokcommercial.com



**Bob Mitchell, CSM**  
 Ph: 208.947.0836  
 bob@tokcommercial.com



# MIDBOX SPACE FOR LEASE FORMER SPORTS AUTHORITY

1301 N MILWAUKEE • BOISE, IDAHO 83704

## PROPERTY INFORMATION:

<b>Submarket:</b>	West Boise	<b>Zoning:</b>	C-2D
<b>Available:</b>	Immediately	<b>Lease Term:</b>	3 - 5 Years
<b>Bldg Type:</b>	Retail	<b>Lease Type:</b>	NNN
<b>Bldg Size:</b>	80,920 SF	<b>Est. NNN:</b>	\$4.60/SF
<b>Parking:</b>	Ample		

## DEMOGRAPHICS:

2016	1 Mi.	3 Mi.	5 Mi.
<b>Population:</b>	11,406	102,006	235,482
<b>Avg HH Income:</b>	\$51,498	\$59,248	\$69,194
<b>Employees:</b>	18,279	72,369	171,478



This information was obtained from sources believed reliable but cannot be guaranteed. Any opinions or estimates are used for example only.

# MIDBOX SPACE FOR LEASE FORMER SPORTS AUTHORITY

1301 N MILWAUKEE • BOISE, IDAHO 83704

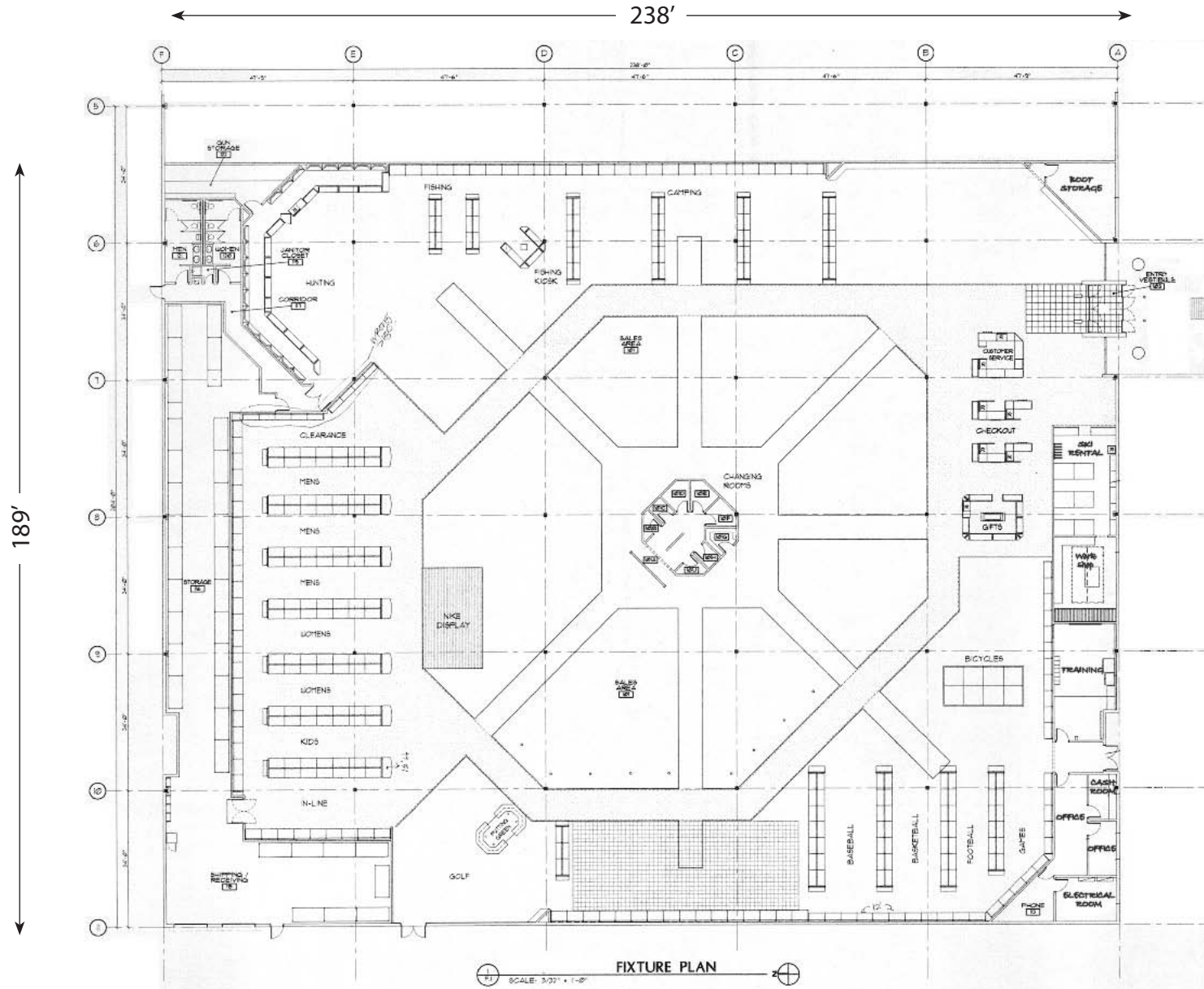

This information was obtained from sources believed reliable but cannot be guaranteed. Any opinions or estimates are used for example only.

Experience Results.

# MIDBOX SPACE FOR LEASE FORMER SPORTS AUTHORITY

1301 N MILWAUKEE • BOISE, IDAHO 83704



This information was obtained from sources believed reliable but cannot be guaranteed. Any opinions or estimates are used for example only.