

315 ODYSSEY SUITE B

Webster, TX 77598



LOCATION DESCRIPTION

Located within Odyssey Business Park, this office/warehouse suite offers convenient access to Clear Lake and the Gulf Freeway corridor. The suite includes a front load sectional door with front load sectional roll up doors for deliveries and loading. Other tenants include corporate and service companies.

PROPERTY HIGHLIGHTS

- Available for Lease
- 14' Front high bay loading door
- Clear span interior
- 16' Eave height
- 3+ year term

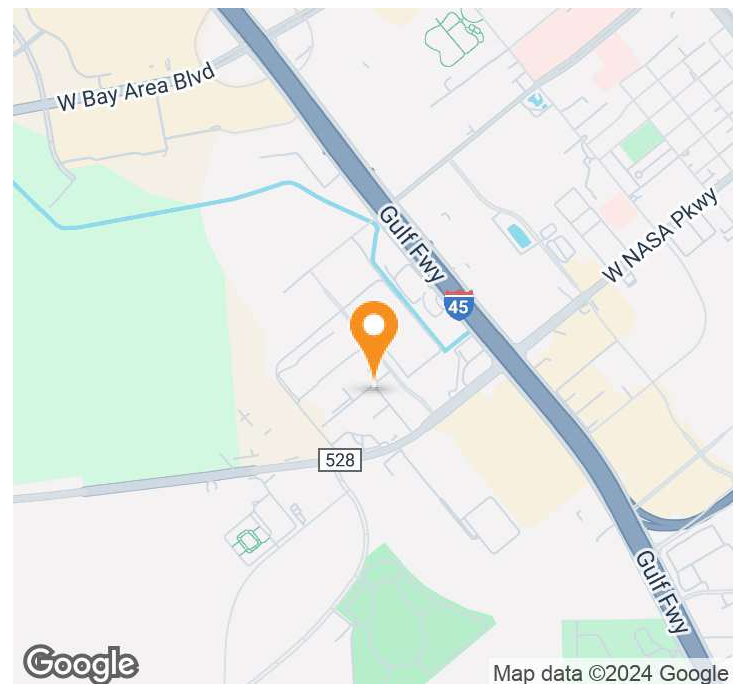

FOR MORE INFORMATION

Ross Wycoff | 281.332.0260 | ross@wycoffdevelopment.com

wycoffdevelopment.com | 281.332.0260

315 ODYSSEY SUITE B

Webster, TX 77598

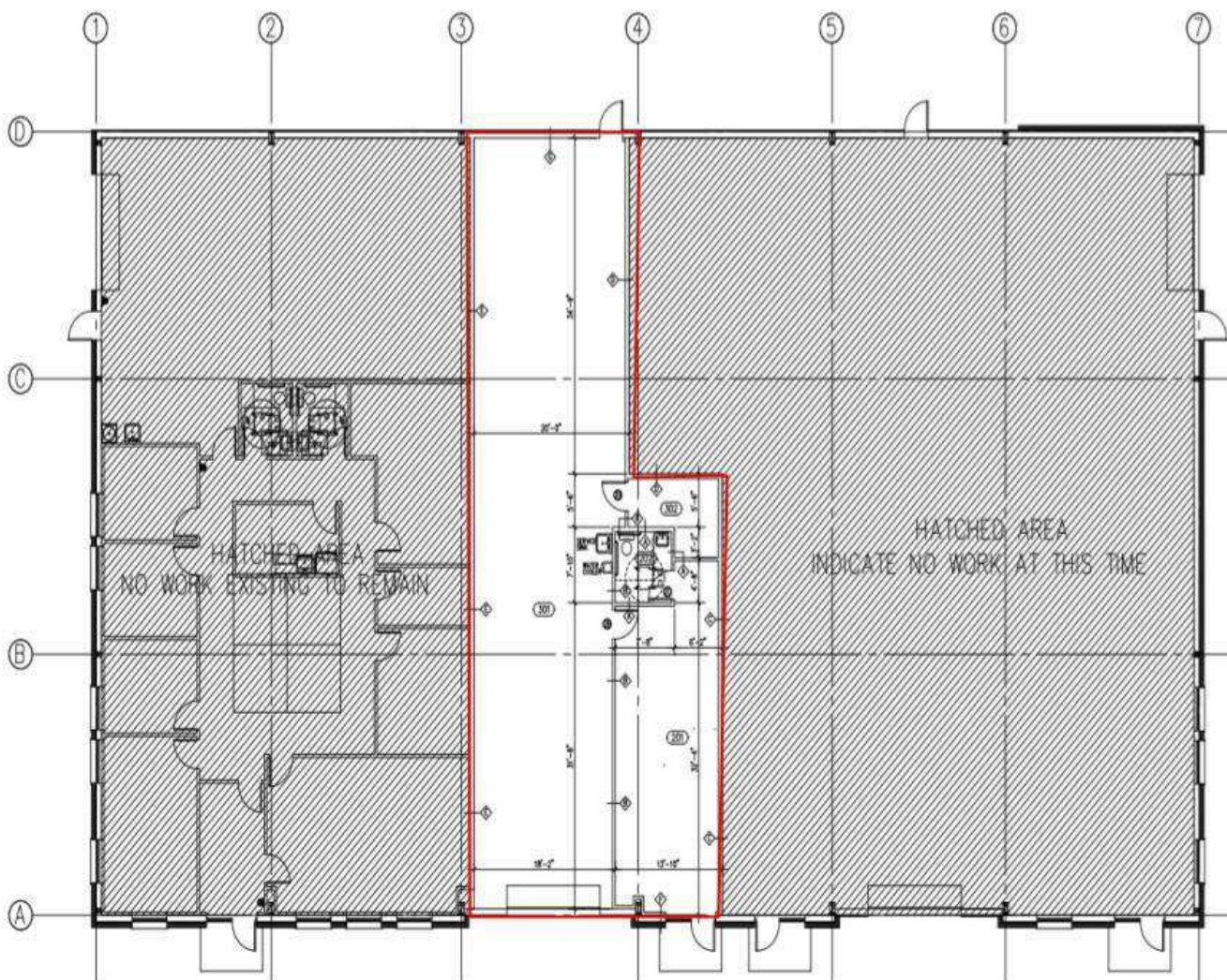

FOR MORE INFORMATION

wycoffdevelopment.com | 281.332.0260

Ross Wycoff | 281.332.0260 | ross@wycoffdevelopment.com