

2400 HUNTINGTON

HOFFMAN ESTATES, IL



THE FUTURE OF **INDUSTRY** ±104,598 SF
FOR SALE

KEITH PURITZ

Vice Chair
+1847 720 1366
keith.puritz@cushwake.com

BRETT KRONER

Vice Chair
+1847 720 1367
brett.kroner@cushwake.com

ERIC FISCHER

Vice Chair
+1847 720 1369
eric.fischer@cushwake.com

MARC SAMUELS

Senior Director
+1847 720 1368
marc.samuels@cushwake.com



A RARE OPPORTUNITY FOR **ADVANCED MANUFACTURING**

Designed for high-precision production and corporate operations, the property offers a unique combination of modern infrastructure, institutional quality construction, and premier access.

AVAILABLE SF

±104,598 SF
(expandable)

OFFICE SIZE

1st Floor: 25,989 SF
2nd Floor: 28,666 SF

SITE AREA

7.49 Acres

CLEAR HEIGHT

40'

EXTERIOR DOCKS

1

OVERHEAD DOORS

2

POWER

4000 Amps @480 Volts

CRANES

Two 25-ton Bridge
Cranes

HVAC

Fully Air-Conditioned

YEAR BUILT

2009
Fully Renovated Office
in 2024

FLOOR THICKNESS

Minimum 11"
Reinforced Concrete

PARKING

271 Cars (expandable)

INCENTIVES

6B Tax Abatement in Place
through 2032

PRICING

Subject to Offer

2025 RE TAXES

\$245,214 / \$2.34 PSF

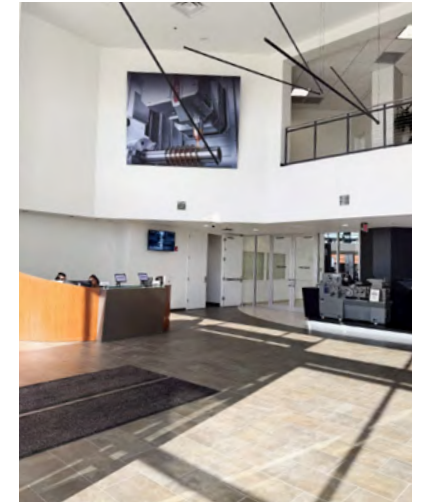

KEITH PURITZ

Vice Chair
+1 847 720 1366
keith.puritz@cushwake.com

BRETT KRONER

Vice Chair
+1 847 720 1367
brett.kroner@cushwake.com

ERIC FISCHER

Vice Chair
+1 847 720 1369
eric.fischer@cushwake.com

MARC SAMUELS

Senior Director
+1 847 720 1368
marc.samuels@cushwake.com

ENGINEERED FOR *PERFORMANCE*

The 7.49-acre site is thoughtfully configured to support both corporate headquarters presence and high-performance manufacturing operations. The building's layout, loading configuration, and circulation provide efficient flow for employees, materials, and logistics.

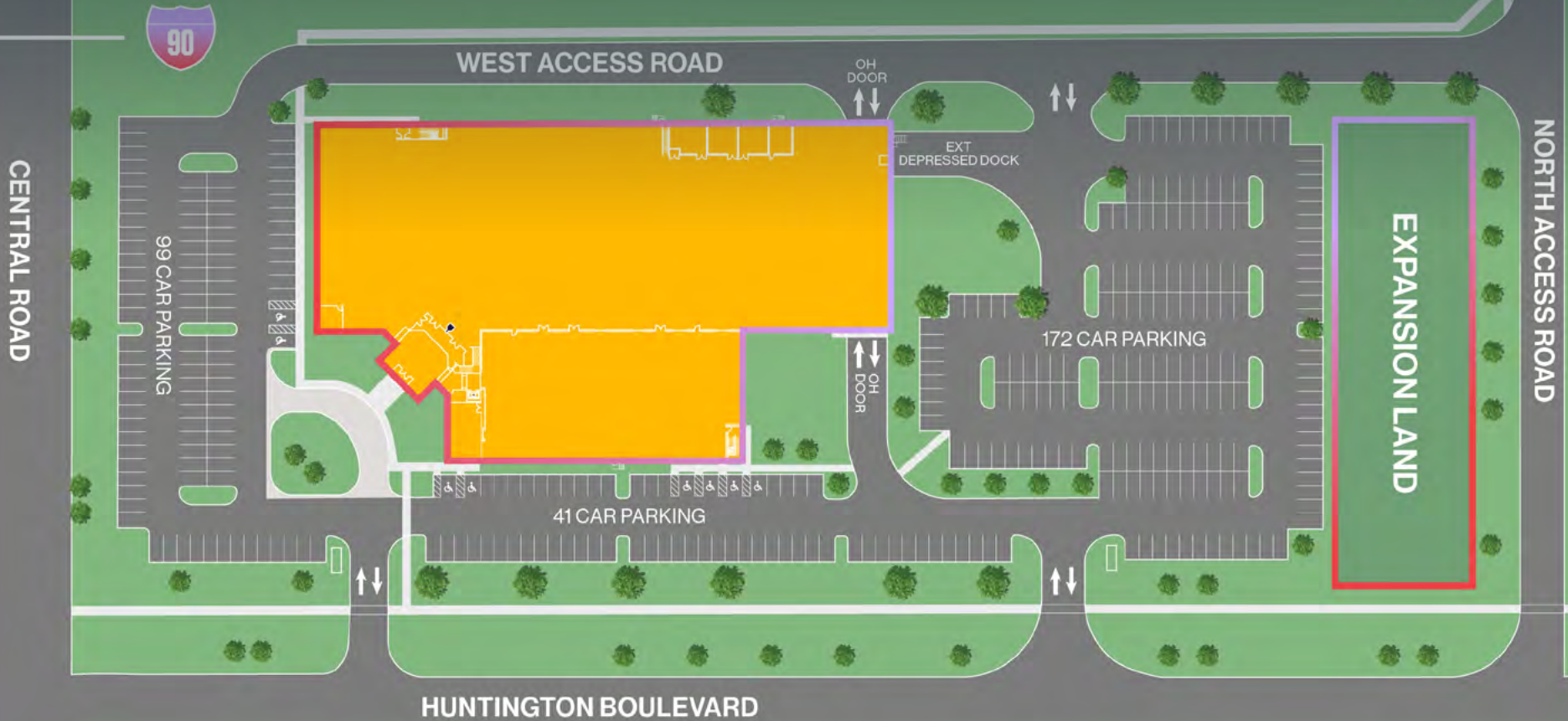

KEITH PURITZ

Vice Chair
+1 847 720 1366
keith.puritz@cushwake.com

BRETT KRONER

Vice Chair
+1 847 720 1367
brett.kroner@cushwake.com

ERIC FISCHER

Vice Chair
+1 847 720 1369
eric.fischer@cushwake.com

MARC SAMUELS

Senior Director
+1 847 720 1368
marc.samuels@cushwake.com

FIRST FLOOR PLAN

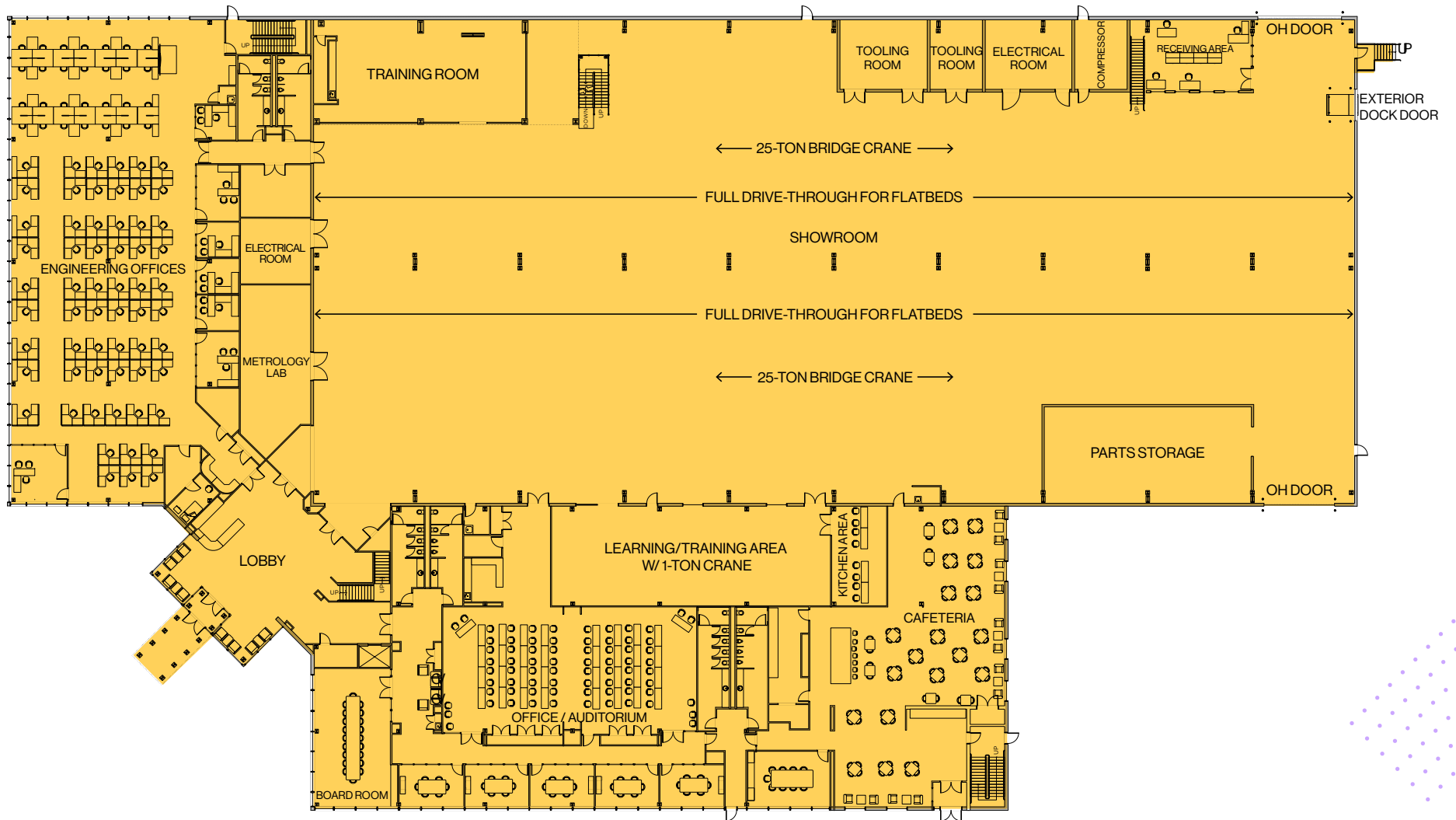

KEITH PURITZ

Vice Chair
+1 847 720 1366
keith.puritz@cushwake.com

BRETT KRONER

Vice Chair
+1 847 720 1367
brett.kroner@cushwake.com

ERIC FISCHER

Vice Chair
+1 847 720 1369
eric.fischer@cushwake.com

MARC SAMUELS

Senior Director
+1 847 720 1368
marc.samuels@cushwake.com

SECOND FLOOR PLAN

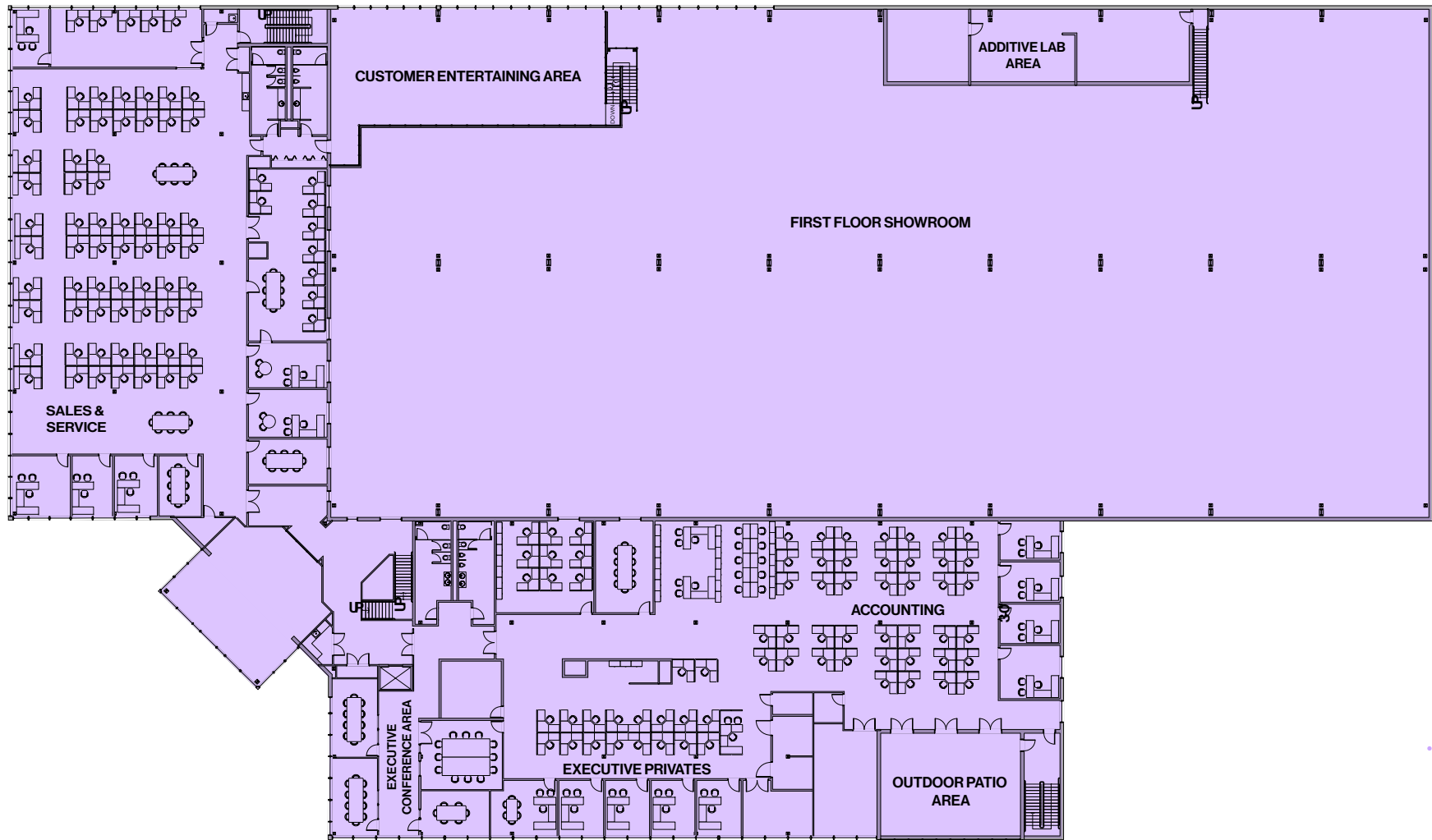

KEITH PURITZ

Vice Chair
+1 847 720 1366
keith.puritz@cushwake.com

BRETT KRONER

Vice Chair
+1 847 720 1367
brett.kroner@cushwake.com

ERIC FISCHER

Vice Chair
+1 847 720 1369
eric.fischer@cushwake.com

MARC SAMUELS

Senior Director
+1 847 720 1368
marc.samuels@cushwake.com

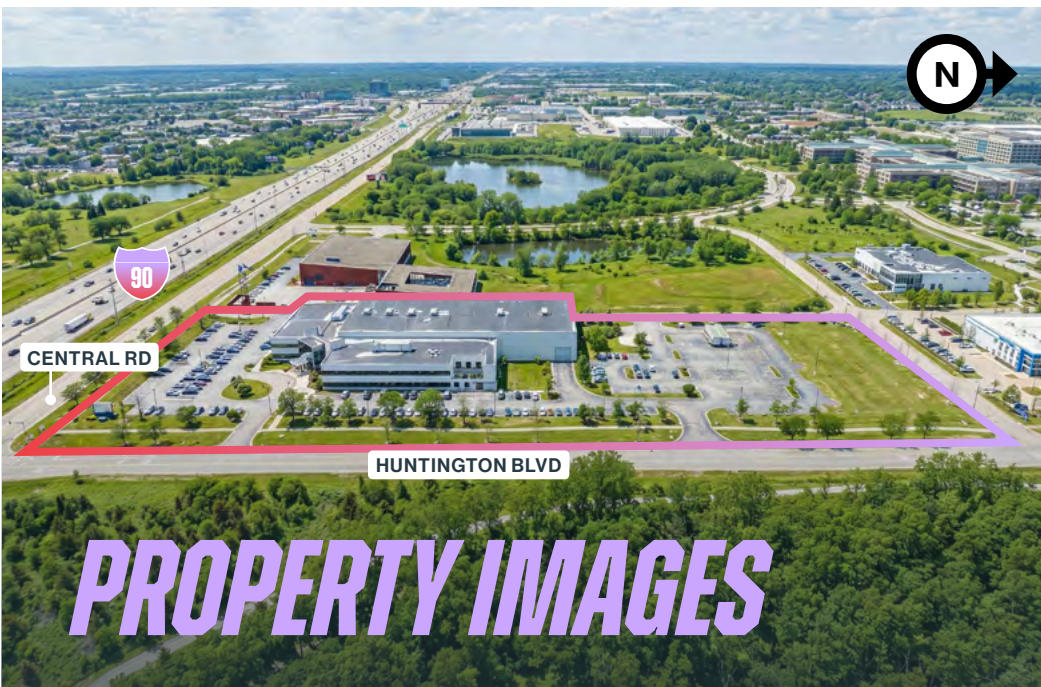

KEITH PURITZ

Vice Chair
+1 847 720 1366
keith.puritz@cushwake.com

BRETT KRONER

Vice Chair
+1 847 720 1367
brett.kroner@cushwake.com

ERIC FISCHER

Vice Chair
+1 847 720 1369
eric.fischer@cushwake.com

MARC SAMUELS

Senior Director
+1 847 720 1368
marc.samuels@cushwake.com

CONNECTED TO CHICAGO'S *KEY INFRASTRUCTURE*

2400 Huntington Blvd offers immediate access to Interstate 90 via a full four-way interchange at Barrington Road, providing seamless connectivity to O'Hare International Airport and the greater Chicago area.

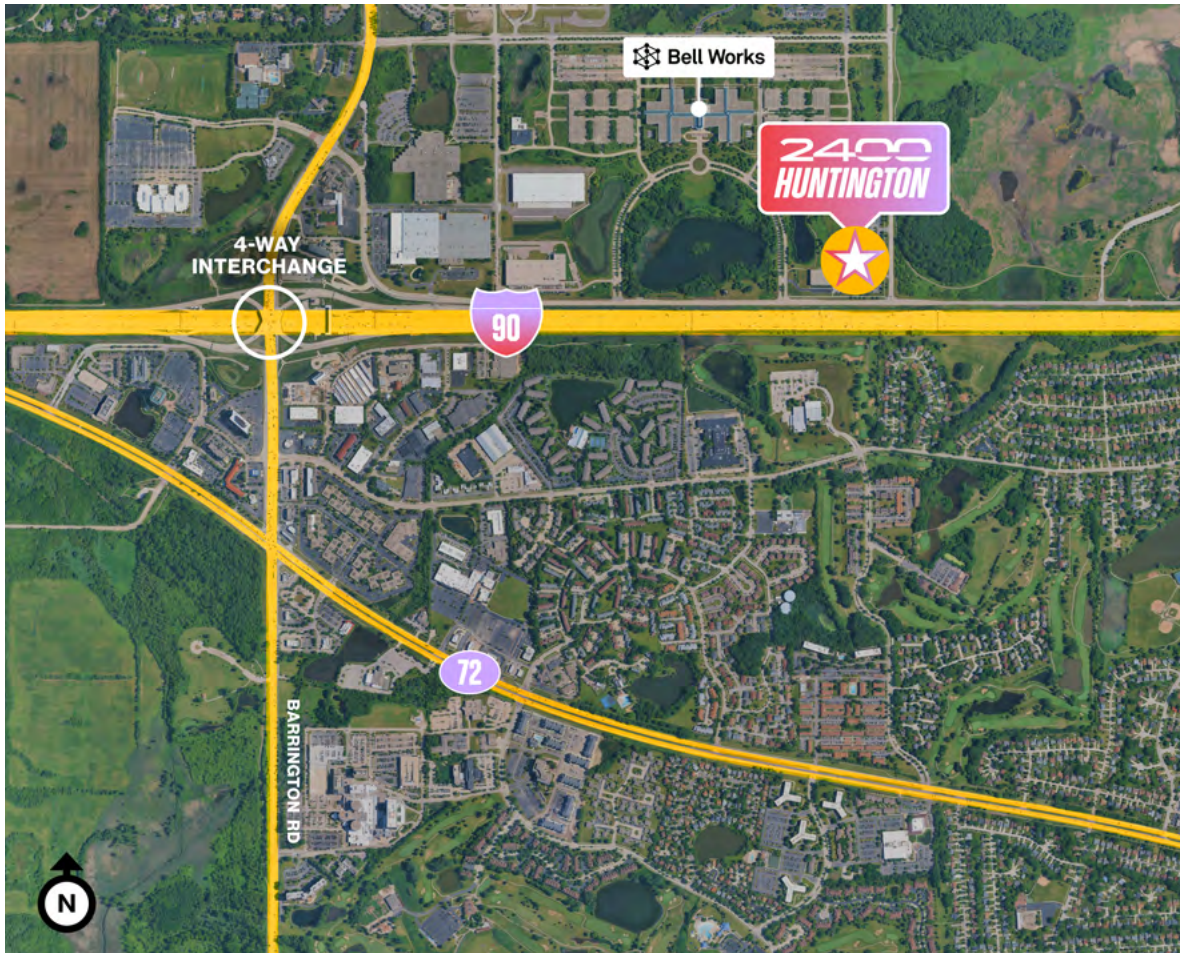

KEITH PURITZ

Vice Chair
+1 847 720 1366
keith.puritz@cushwake.com

BRETT KRONER

Vice Chair
+1 847 720 1367
brett.kroner@cushwake.com

ERIC FISCHER

Vice Chair
+1 847 720 1369
eric.fischer@cushwake.com

MARC SAMUELS

Senior Director
+1 847 720 1368
marc.samuels@cushwake.com

62

RALLY HOUSE **POTBELLY** **RUTH'S CHRIS STEAK HOUSE**

WHITE BLACK **LOFT** **COOPER'S HAWK** WINE & RESTAURANTS

L.L.Bean **CLUB PILATES** **SEPHORA**

chico's **DSW** **EVEREVE** **TALBOTS**

4.5 MI | 9 MINS

2400 HUNTINGTON

HOFFMAN ESTATES



HYATT HYATT PLACE REGENCY **FIRST WATCH** **BOON** **BARNES & NOBLE**

THE CAPITAL **ARRIS** **SHOE CARNIVAL** **J. CREW** **TORRID**

TRADER JOE'S **NORDSTROM**

Michaels **Marshalls** **HomeGoods**

ROLLING MEADOWS

COSTCO WHOLESALE **WALGREENS**

Residence INN BY MARRIOTT

SPRINGHILL SUITES MARRIOTT

53



90

Culver's **Red Robin** **PANDA** **Pizza Hut**

DOLLAR TREE **ROSS DRESS FOR LESS** **CHIPOTLE MEXICAN GRILL**

Orangetheory FITNESS **STRETCH ZONE** **JIMMY JOHN'S GOURMET SANDWICHES**

pure barre **TARGET** **HomeGoods** **PET SMART**

Burlington **maurices** **LANE BRYANT**

Woodfield Mall
6.5 MI | 12 MINS

FIVE GUYS **noodles & COMPANY**

RED LOBSTER

JOHNSON **Famous Footwear**



58

McDonald's **Chick-fil-A**

HOBBY LOBBY **Gordon**

59

Starbucks **BURGER KING** **CHIPOTLE** **MOD PIZZA** **SHAKE SHACK**

TEXAS & BRAZIL **KURA** **AMERICAN EAGLE** **GAP** **H&M** **lululemon**

Red Robin **GRANITE CITY** **PF CHANG'S** **URBAN OUTFITTERS** **charlotte russe**

WHITE BLACK **Hugoboss** **Tommy Bahama** **RALLY HOUSE** **UNI QLO** **JD** **Levi's** **Abercrombie & Fitch**

zumiez **DXL** **Lids** **Buckle** **CHAMPS**

ALDO **AÉROPOSTALE** **DSW** **NORDSTROM** **TILLY'S**

JCPenney **alo** **Eddie Bauer** **ANNA** **TUMI** **PRIMARK**

EARTHBOUND **ARITZIA** **DRY GOODS** **ANTHROPOLOGIE**

ATHLETA EXPRESS **MICHAEL KORS** **SKECHERS**

BOSS **francesca's** **HOLLISTER** **Jockey** **macys** **AKIRA**

HOLLISTER **WINDSOR** **Foot Locker** **gilly hicks** **AIX**

BIBIBOP **LA FITNESS**

HOME 2 **extended STAY AMERICA**

ROSS **Discovery**

SCHAUMBURG

Wendy's **Wendy's** **Wendy's**

MAGGIANO'S **BLW**

Seamless **Best Western**

LOFT **OMAHA STEAKS** **QUALITY**

290

AREA AMENITIES

KEITH PURITZ

Vice Chair
+1 847 720 1366
keith.puritz@cushwake.com

BRETT KRONER

Vice Chair
+1 847 720 1367
brett.kroner@cushwake.com

ERIC FISCHER

Vice Chair
+1 847 720 1369
eric.fischer@cushwake.com

MARC SAMUELS

Senior Director
+1 847 720 1368
marc.samuels@cushwake.com





JOIN A CORRIDOR BUILT FOR INNOVATION

Located within Chicago's renowned **"AUTOMATION ROW,"** the property is surrounded by a concentration of global manufacturing, technology, and logistics companies.

This established ecosystem fosters innovation, collaboration, and access to a highly skilled workforce tailored to advanced industrial users.

©2026 Cushman & Wakefield. All rights reserved. The information contained in this communication is strictly confidential. This information has been obtained from sources believed to be reliable but has not been verified. NO WARRANTY OR REPRESENTATION, EXPRESS OR IMPLIED, IS MADE AS TO THE CONDITION OF THE PROPERTY (OR PROPERTIES) REFERENCED HEREIN OR AS TO THE ACCURACY OR COMPLETENESS OF THE INFORMATION CONTAINED HEREIN, AND SAME IS SUBMITTED SUBJECT TO ERRORS, OMISSIONS, CHANGE OF PRICE, RENTAL OR OTHER CONDITIONS, WITHDRAWAL WITHOUT NOTICE, AND TO ANY SPECIAL LISTING CONDITIONS IMPOSED BY THE PROPERTY OWNER(S). ANY PROJECTIONS, OPINIONS OR ESTIMATES ARE SUBJECT TO UNCERTAINTY AND DO NOT SIGNIFY CURRENT OR FUTURE PROPERTY PERFORMANCE.

KEITH PURITZ

Vice Chair
+1 847 720 1366
keith.puritz@cushwake.com

BRETT KRONER

Vice Chair
+1 847 720 1367
brett.kroner@cushwake.com

ERIC FISCHER

Vice Chair
+1 847 720 1369
eric.fischer@cushwake.com

MARC SAMUELS

Senior Director
+1 847 720 1368
marc.samuels@cushwake.com