

# CHESTERFIELD COMMONS



MID-AMERICA®  
Real Estate-Michigan, Inc.

35000 23 Mile Road / Chesterfield, MI 48047

## FOR LEASE



RETAIL OPPORTUNITY

# CHESTERFIELD COMMONS



## Address

35000 23 Mile Road  
Chesterfield, MI 48047

## Features

Join Kroger in Chesterfield Commons which is located at the corner of 23 Mile and Altman Roads in Chesterfield Township, MI. The center is situated east of I-94 and serves as the dominant neighborhood, grocery anchored center. There are multiple points of ingress/egress on both roads serving the property along with ample parking. Small shop space available for lease.

## Availability

4,020 SF

## Area Tenants



## Demographics (2022)

	1 MILES	3 MILES	5 MILES
POPULATION	7,161	38,750	68,374
HOUSEHOLDS	2,907	14,489	25,117
AVG HOUSEHOLD INCOME	\$89,792	\$92,183	\$89,080
DAYTIME POPULATION	7,032	30,821	60,069

# CHESTERFIELD COMMONS

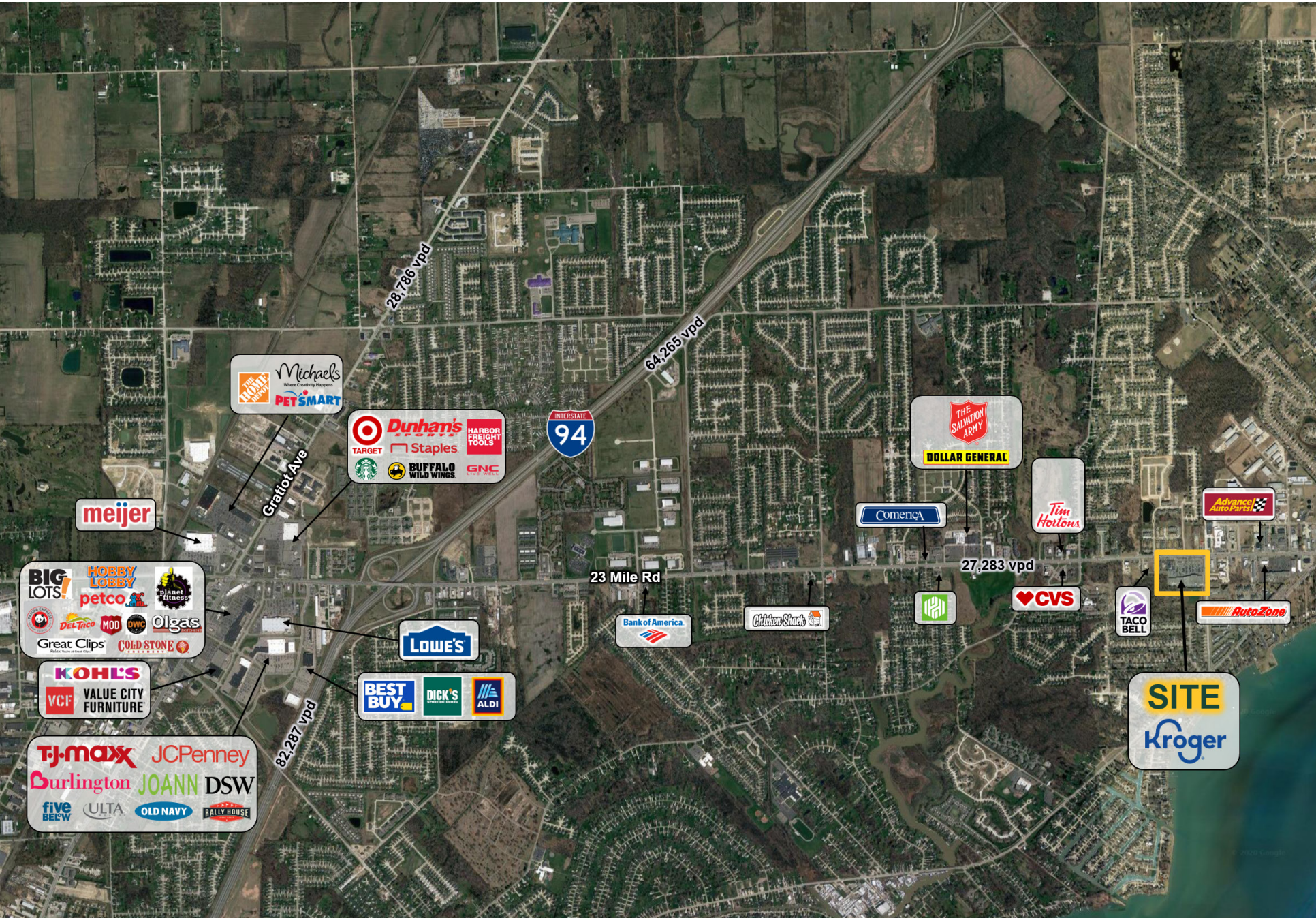

AERIAL

# CHESTERFIELD COMMONS

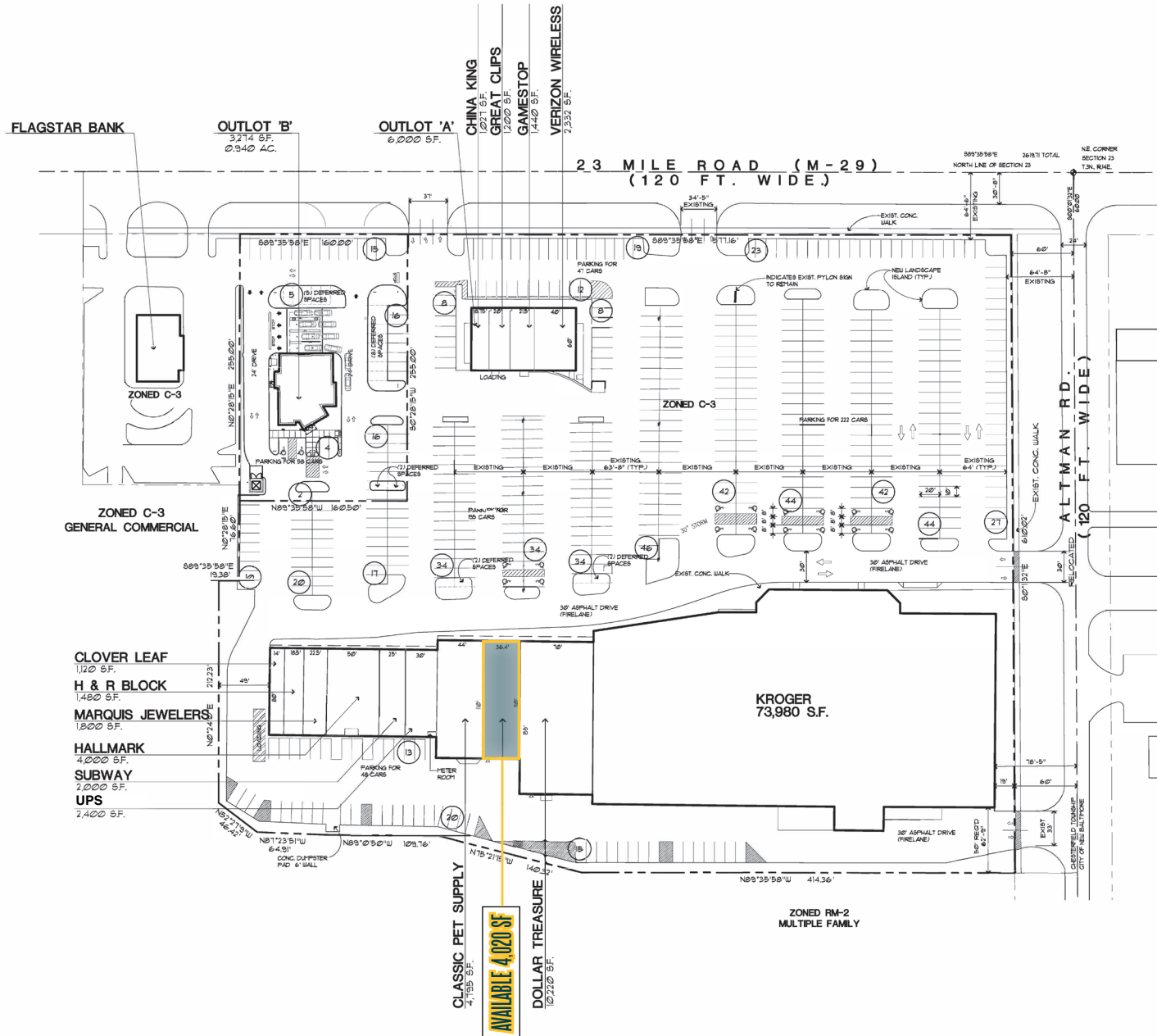

# CHESTERFIELD COMMONS



Eric  
Birnholtz

Mid-America Real Estate -  
Michigan, Inc.

T: 248.855.6800

**EBirnholtz@MidAmericaGrp.com**

Eric  
Unatin

Mid-America Real Estate -  
Michigan, Inc.

T: 248.855.6800

**EUnatin@MidAmericaGrp.com**



38500 Woodward Ave, Suite 100  
Bloomfield Hills, Michigan 48304  
248.855.6800

**MidAmericaGrp.com**

CONTACT