

821 PEPPER STREET

Columbia, South Carolina



AVAILABLE FOR LEASE

- ◆ 8,970 SF Available
 - 957 SF Office space
 - 8,021 SF Warehouse space
- ◆ Located in proximity to I-77 via Leesburg Road
- ◆ On 2.76 acre site with a large graded yard
- ◆ 2 Drive-in doors
- ◆ 3 Phase power
- ◆ Zoning: M-1 Light Industrial
- ◆ LEASE RATE: \$4.75 NNN

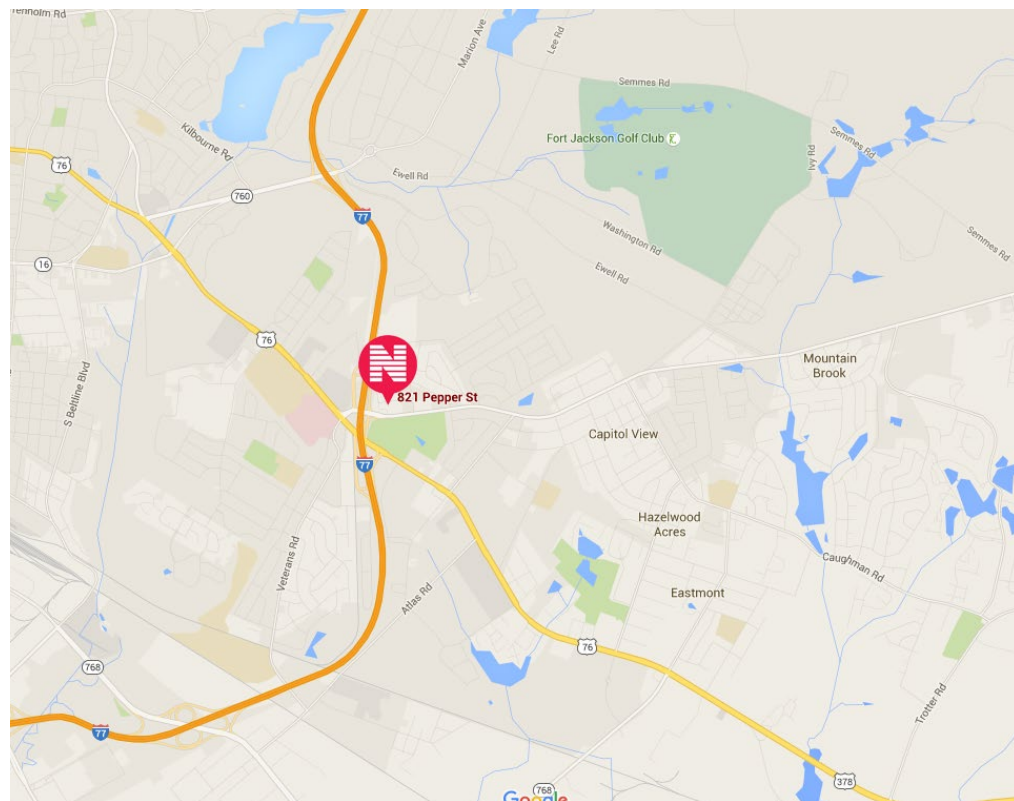

Newmark Grubb
Wilson Kibler

1111 Laurel Street, Columbia, SC 29201 T 803.779.8600 www.wilsonkibler.com

Coleman Davis

803.255.8653 cdavis@wilsonkibler.com

821 PEPPER STREET

Columbia, South Carolina

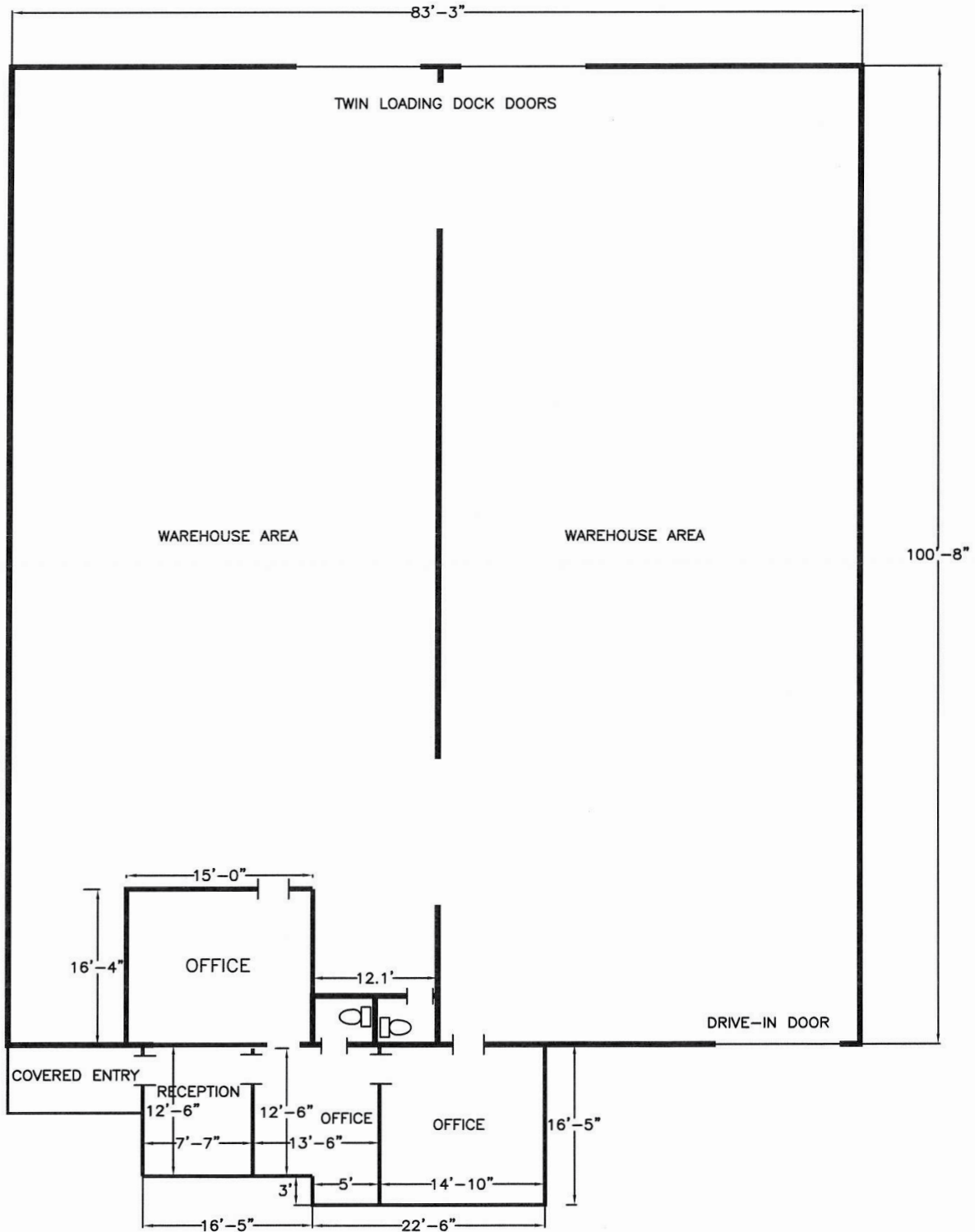

Newmark Grubb
Wilson Kibler

1111 Laurel Street, Columbia, SC 29201 T 803.779.8600 www.wilsonkibler.com

Coleman Davis
803.255.8653 cdavis@wilsonkibler.com

The information contained herein has been obtained from sources we believe to be reliable; however, Newmark Grubb Wilson Kibler has not conducted any investigation regarding these matters and makes no warranty or representation whatsoever regarding the accuracy or completeness of the information provided. Independently owned and operated.