

08 THRESHOLD AT DOOR 103
SCALE: 1:1

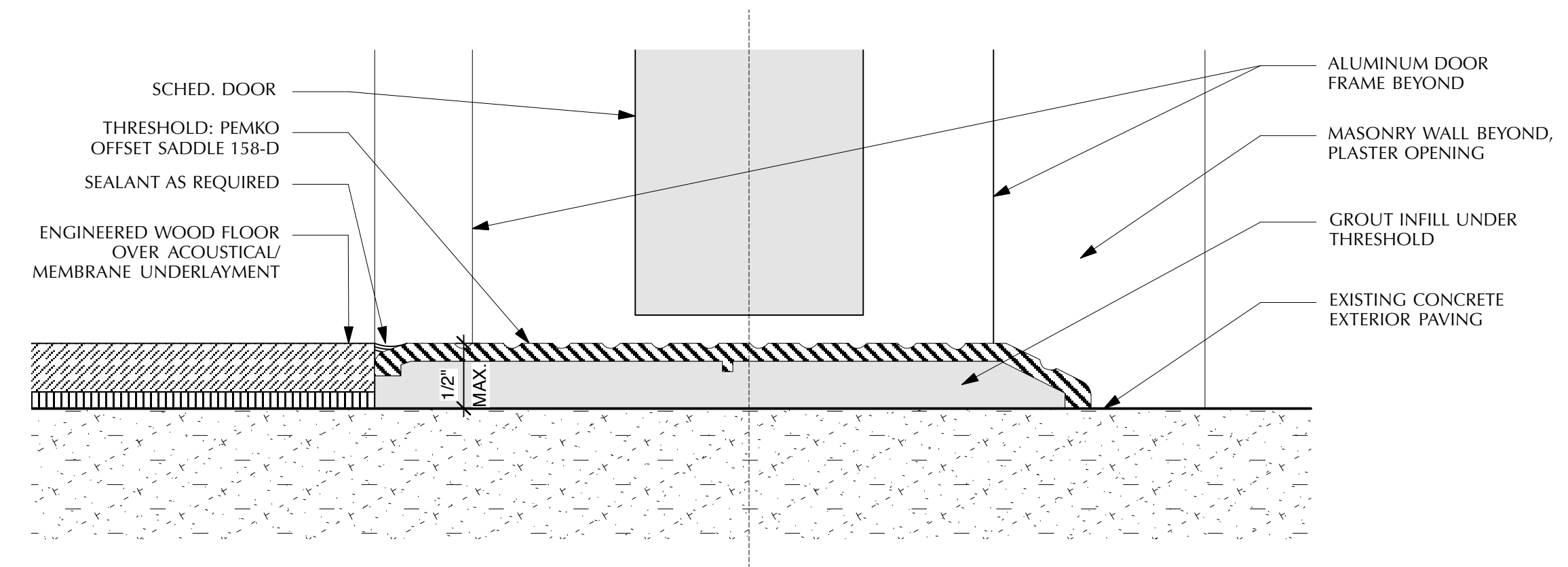

04 THRESHOLD AT DOORS 101 & 102
SCALE: 1:1

Project Number: 14008

Offices at 111 Nugent
111 North Nugent Avenue
Johnson City, Texas 78636



new leaf design
po box 1826, johnson city, tx 78636
kimberly@new-leaf.us 830/469-9677

MILLWORK DEFINITIONS & SCOPE

ABBREV.	LOCATION	MANUFACTURER	DESCRIPTION	COLOR	REMARKS
SS-1	COUNTERTOPS	CURAVA	RECYCLED GLASS COUNTERTOP	MOCHA WITH EASED EDGES	
PL-1	EXPOSED CABINETS	FORMICA	MATTE FINISH LAMINATE	8820-58 LEAF GREEN	
PL-2	CABINET LINERS	FORMICA	MATTE FINISH LAMINATE	85983 ALMOND	
WD-1	SOLID WOOD TRIM/TOE KICKS	-	STAIN GRADE WALNUT	CLEAR COAT	
WD-2	WOOD VENEER	-	STAIN GRADE WALNUT VENEER	CLEAR COAT	

FINISH SCHEDULE

OFFICE		FLOOR	BASE	NORTH	EAST	SOUTH	WEST	CEILING	REMARKS
101	OFFICE	NYRDEE	NONE	PLASTER, PTD-1	PLASTER, PTD-1	PLASTER, PTD-1	EXISTING STONE	EXPOSED TRUSSES	1,2
102	CONFERENCE	NYRDEE	NONE	PLASTER, PTD-1	EXISTING STONE	DRYWALL, PTD-2	PLASTER, PTD-1	EXPOSED TRUSSES	1,2
103	UNISEX RR	CT-1	CT-2	CT-2 / PTD-2	EXISTING STONE	CT-2 / PTD-2	CT-2 / PTD-2	DRYWALL, PTD-2	1,2,3
104	BREAKROOM	NYRDEE	NONE	-	DRYWALL, PTD-2	PLASTER, PTD-1, SS-1	PLASTER, PTD-1	EXPOSED TRUSSES	1,2,3

- GENERAL FINISH NOTES:**
- A. REFER TO RCP A4.0 FOR CEILING HEIGHTS & TRANSITIONS
 - B. REFER TO FINISH FLOOR PLAN A3.1 AND DETAILS ON A8.0 FOR TRANSITIONS AT FLOOR MATERIALS.
 - C. REFER TO FINISH FLOOR PLAN A3.1 AND ENLARGED RESTROOM PLANS/ELEVATIONS A7.0 FOR FLOOR AND WALL PATTERNS.
 - D. OUTLETS AND SWITCH PLATES ARE TO BE METAL GANG BOXES AT ALL MASONRY WALLS AND WHITE PATES AT DRYWALL WALLS, U.N.O. RE: ELECTRICAL.
 - E. PROVIDE BLOCKING IN WALL WHERE PANELS, TVs AND MILLWORK ARE SHOWN.
 - F. FINISH SCHEDULE DENOTES PREDOMINANT FINISH ONLY. REVIEW ALL DRAWINGS TO DETERMINE FULL EXTENT AND RANGE OF FINISH MATERIALS, ACCENT COLORS, MATERIAL CHANGES, ETC.
 - G. NOT IN USE
 - H. ALL EXPOSED NON-FACTORY FINISHED STRUCTURAL, MECHANICAL, OR ELECTRICAL COMPONENTS SHALL BE FIELD PAINTED PER ARCHITECT'S DIRECTION. ALLOW FOR ACCENT COLORS. TYPICAL FOR INTERIOR AND EXTERIOR LOCATIONS.
 - I. PROVIDE FOR SEALANT/ CAULK AT INTERSECTIONS OF DISSIMILAR MATERIALS AS PER SEALANT GUIDELINES AND AS REQUIRED AND/OR RECOMMENDED BY MANUFACTURERS.
 - J. REFER TO INTERIOR ELEVATIONS AND DETAILS FOR ADDITIONAL FINISH INFORMATION AND FINISH MATERIAL SHOWN IN ELEVATION OR SECTION SHALL BE PROVIDED AS NOTED OR DEPICTED ON THE DRAWINGS.
 - K. MOISTURE RESISTANT GYPSUM BOARD SHALL BE USED AT ALL TOILET ROOMS & JANITOR CLOSETS FOR WALLS AND CEILINGS DESIGNATED TO BE GYP. BD
 - L. NOT IN USE.
 - M. ALL COUNTERTOPS TO RECEIVE BACKSPASHES, IN THE SAME MATERIAL, UNLESS NOTED OTHERWISE.
 - N. NOT IN USE
 - O. ELECTRICAL RECEPTACLES ARE NOT TO BE INSTALLED BACK TO BACK
 - P. TRANSITION OF FLOOR MATERIALS TO OCCUR AT THE CENTERLINE OF CLOSED DOOR. PROVIDE APPROPRIATE TRANSITION STRIP, REDUCER STRIP, OR THRESHOLD.
 - Q. NOT IN USE
 - R. PROVIDE MOISTURE RESISTANT GYP. BOARD ALL ALL WET WALLS.

- REMARKS:**
1. SEE INTERIOR ELEVATION FOR EXTENT OF OTHER FINISHES AND TRIMS.
 2. SEE RCP FOR EXTENT OF OTHER FINISHES.
 3. WALLS TO BE MOISTURE RESISTANT WALL BOARD IN THIS AREA.

FINISH DEFINITIONS & SCOPE

ABBREV.	MATERIAL	MANUFACTURER	STYLE	SIZE	COLOR	REMARKS
FLOOR						
WD	ENGINEERED ACRYLIC IMPREGNATED WOOD FLOORING, GLUED DOWN	NYRDEE	COR	4"	GOTHIC	4" WIDE, RANDOM LENGTHS. INSTALL ECO-SILENCER UNDERLAYMENT
PT-1	PORCELAIN FIELD TILE	WALKER ZANGER / LATICRETE	GEOTECH	12"X24"	GEOWHITE-HONED	3/16" GROUT JOINTS, USE EPOXY GROUT
WALLS						
PTD-1	PAINTED PLASTER	USG/PLASTER/BENJAMIN MOORE	FLAT		LIMESICKLE 2145-50	SMOOTH PLASTER FINISH (PATCH ALL CRACKS & HOLES)
PTD-2	PAINTED DRYWALL	USG/BENJAMIN MOORE	FLAT		POTPURRI GREEN 2029-50	LEVEL 5 FLAT FINISH
PT-2	PORCELAIN FIELD TILE	WALKER ZANGER / LATICRETE	GEOTECH	12"X24"	GEOWHITE-HONED	3/16" GROUT JOINTS, USE EPOXY GROUT
CEILING						
STRUCT	EXPOSED EXISTING WOOD TRUSSES					
GWB	PAINTED DRYWALL	USG/BENJAMIN MOORE	FLAT		PTD-2	LEVEL 5 FLAT FINISH

Sheet Content:

Finish Schedule
Floor Transition Details

Scale: As Noted

File Name: 14008-A8.X Schedules.vwx

Drawn By: KNR

Checked By: KNR

Plot Date: May 15, 2015