

BUILDING LOCATION

N.T.S.

GROSS SQUARE FOOTAGE: 1,347 S.F.  
NET / USABLE SQUARE FOOTAGE: 1,249 S.F.

GROSS SQUARE FOOTAGE: 4,499 S.F.  
NET / USABLE SQUARE FOOTAGE: 4,257 S.F.

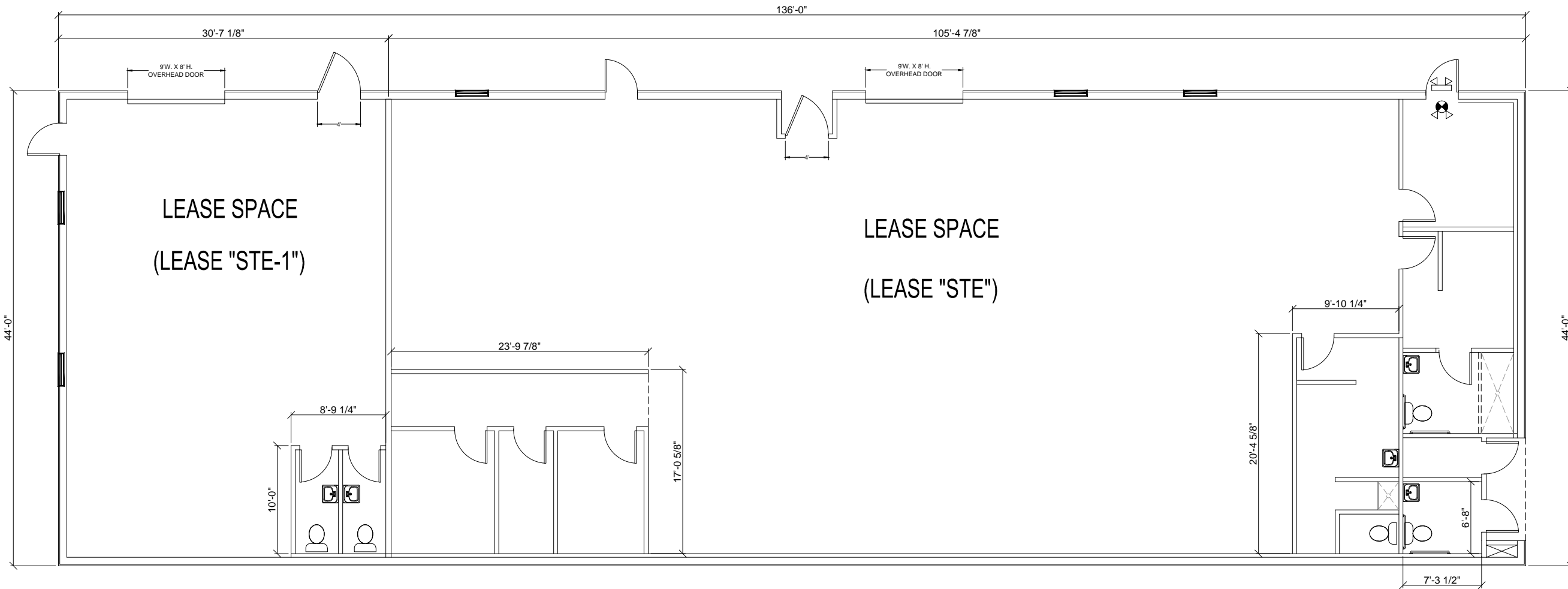

GROSS SQUARE FOOTAGE: 140 S.F.  
COMMON SPACE



Drawings Prepared By:  
Maloney Services  
832.257.4619  
maloneyservices@yahoo.com

**PLAZA ONE**  
**AS BUILT PLANS**  
11721-C - 11729 SPRING CYPRESS  
TOMBALL, TEXAS 77377

MALONEY SERVICES LLC 2025. THIS OFFICE ASSUMES NO LIABILITY FOR ERRORS OR OMISSIONS ON THESE PLANS. ALL INFORMATION MUST BE CONFIRMED PRIOR TO COMMENCEMENT OF CONSTRUCTION. IT IS THE OWNERS AND BUILDERS RESPONSIBILITY TO FULLY COMPLY WITH ALL GOVERNING CODE REQUIREMENTS FOR THE GEOGRAPHIC AREA IN WHICH THIS PROJECT IS TO BE CONSTRUCTED.

**Issue:**  
AS-BUILT DRAWINGS 10-27-2025

Date  
10-27-2025

Project Number  
08242025

Sheet Name  
BUILDING PLAN

Sheet Number  
**A1.10**

BUILDING PLAN

5,400 S.F. BUILDING  
SCALE: 3/32" = 1'-0" 1