

Industrial | For Lease

CBRE

3052 Shader Rd

Industrial Flex Space Available

3052 Shader Rd
Orlando, FL 32808

2,408 - 4,823 SF | 18' Clear Height | Oversized Doors



AVAILABLE FOR LEASE:

	SUITE A-2	SUITE B
Total SF	2,408 SF	2,415 SF
Office SF	100 SF / 1 restroom	150 SF / 1 restroom
Clear Height	17' - 18'	17' - 18'
Grade Level Doors	(1) 12'x14' (1) 12'x12'	(2) 12' x 12'
Power	3p	3p
Lease Rate PSF	\$15.00 PSF NNN	\$15.00 PSF NNN
Opex PSF	\$4.75 Opex	\$4.75 Opex
Monthly Rent	\$3,963	\$3,975

	SUITE A-2 + B
Total SF	4,823 SF
Office SF	200 SF / 1 restroom
Clear Height	17' - 18'
Grade Level Doors	(1) 12'x14' (3) 12'x12'
Power	3p
Lease Rate PSF	\$14.75 PSF NNN
Opex PSF	\$4.75 Opex
Monthly Rent	\$7,837

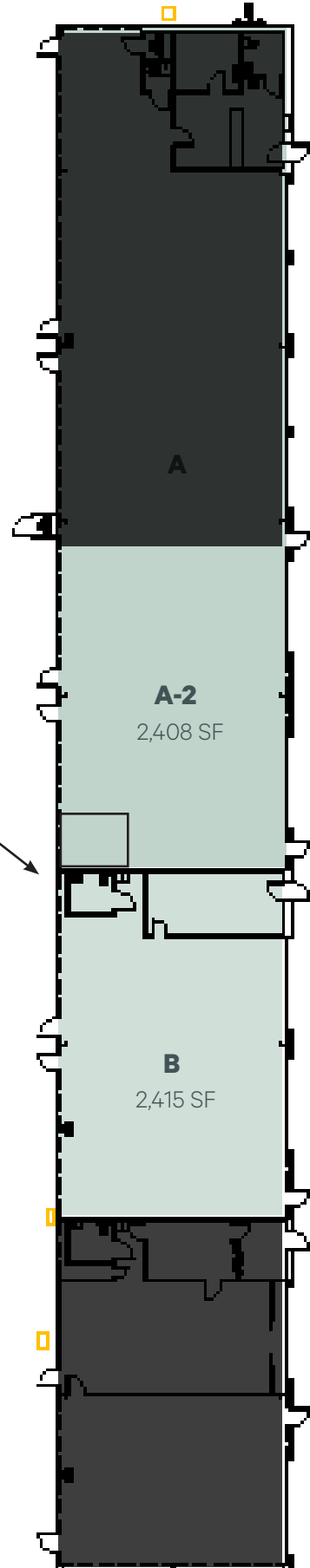
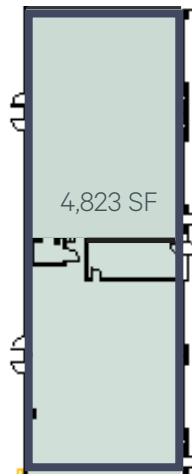

SUITE A2 + B

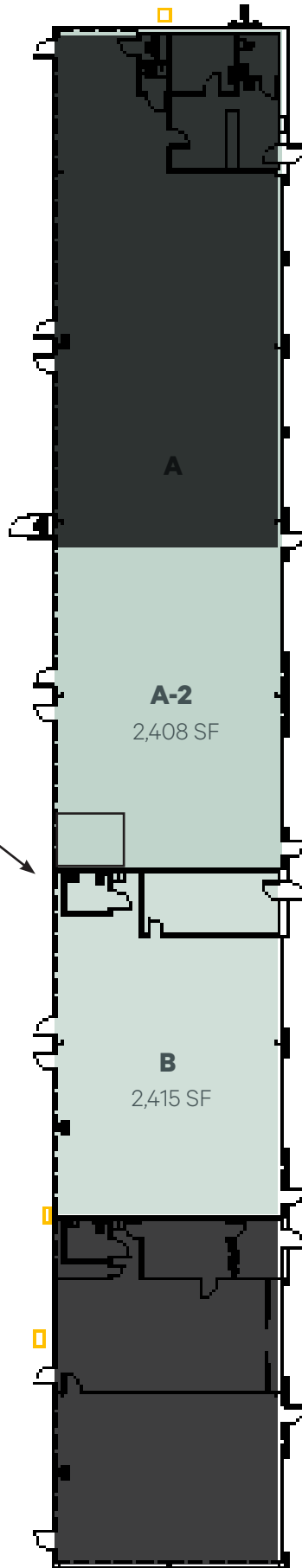
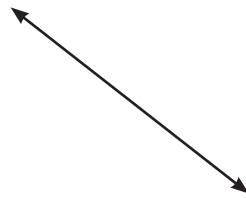
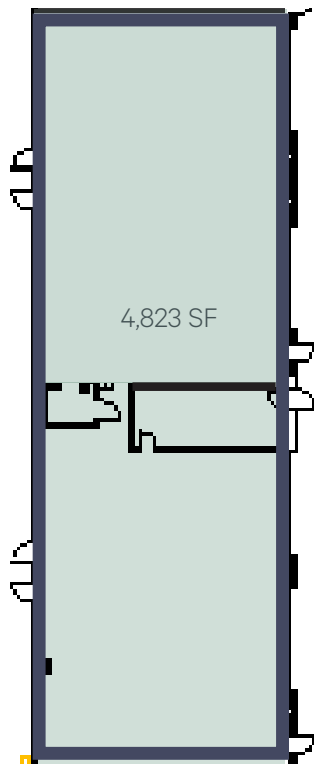

LOCATION

Distance to Key Hubs:

- + Easy Access to the Heart of Orlando: Located in the Packing District, providing convenient access to your customers and suppliers.
- + Benefit from quick access to major highways (408, I-4) for efficient distribution, regional reach, and seamless travel.

Strategically positioned to give your venture the edge it needs to flourish in the dynamic Orlando market. We understand the needs of innovators and entrepreneurs, and this location delivers.



Contact Us For Leasing

Cameron Thomas

Senior Associate

+1 407 404 5078

cameron.thomas@cbre.com

Alex Eastwood

Senior Associate

+1 850 356 823

alex.eastwood@cbre.com

Jose Rivera

Associate

+1 407 404 5067

jose.rivera1@cbre.com

Scan for:

- More Info

- Save

- Share



© 2026 CBRE, Inc. All rights reserved. This information has been obtained from sources believed reliable, but has not been verified for accuracy or completeness. You should conduct a careful, independent investigation of the property and verify all information. Any reliance on this information is solely at your own risk. CBRE and the CBRE logo are service marks of CBRE, Inc. All other marks displayed on this document are the property of their respective owners, and the use of such logos does not imply any affiliation with or endorsement of CBRE. Photos herein are the property of their respective owners. Use of these images without the express written consent of the owner is prohibited.

CBRE