

MISSION VIEJO COMMERCE PARK
23342 Madero, Suite F
Mission Viejo, CA

1,440 Square Feet
\$1.45 SF/MO
Triple Net

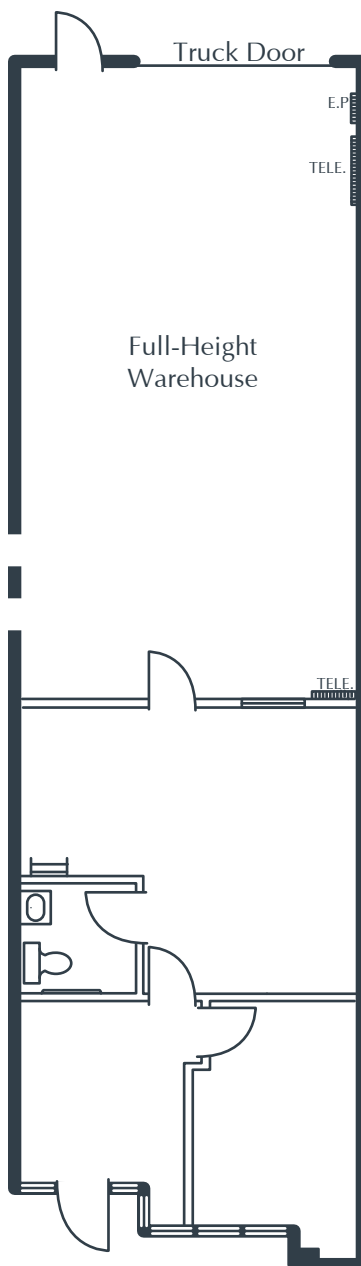

Notes:

- Reception
- Window Office
- Restroom
- Large Open Work Area
- Approximately 722 sq. ft. of Full-Height Warehouse with Ground-Level Truck Door
- Part of a Professionally Managed Business Park

CONTACT INFORMATION:

All rates, terms, floor plans and building facts subject to change without notice.

ea 07.30.2021

Muna Abu-Sada/Senior Leasing Director
Phone: 949.719.7259
Mobile: 949.244.8917
E-mail: mabusada@olenproperties.com

Olen Properties Corp.
Seven Corporate Plaza
Newport Beach, CA 92660
949.644.OLEN
www.olenproperties.com

