

CARTER PARK

DISTRIBUTION CENTER



6440 OAK GROVE & 6445 WILL ROGERS
CLASS A INDUSTRIAL PARK | 385,000 SF TOTAL AVAILABLE



OWNED BY:



LEASED BY:



CONTACT

Matt Carthey | 817.710.1111 | mcarthey@holtlunsford.com
Thomas Grafton | 817.632.6152 | tgrafton@holtlunsford.com
Canon Shoults | 972.280.8328 | cshoults@holtlunsford.com

CARTER PARK

DISTRIBUTION CENTER



6440 OAK GROVE | BUILDING C SITE PLAN

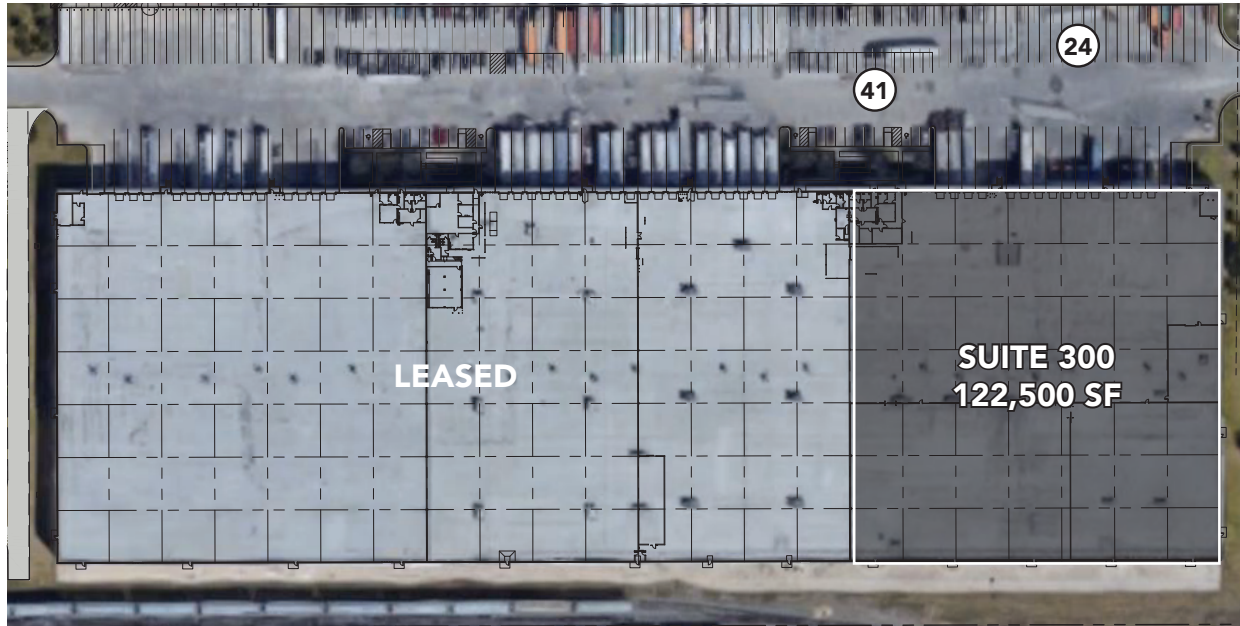

PROPERTY HIGHLIGHTS

- 385,000 SF Distribution Facility
- 122,500 SF Available – Suite 300
- 30' Clear Height
- 50'x50' Column Spacing
- 0.23/1,000 SF Parking Ratio (Ability to expand to 0.40/1,000 SF)
- 24 Trailer Parks
- Front Load Configuration
- ESFR Sprinkler System
- Rail Service Available
- Located 1 Mile from I-35 and I-20
- Triple Freeport Tax Exemption
- Foreign Trade Zone Designation Obtainable
- Institutionally Owned and Professionally Managed
- Strong Workforce Labor

OWNED BY:



LEASED BY:



CONTACT

Matt Carthey | 817.710.1111 | mcarthey@holtlunsford.com
Thomas Grafton | 817.632.6152 | tgrafton@holtlunsford.com
Canon Shoults | 972.280.8328 | cshoults@holtlunsford.com

CARTER PARK

DISTRIBUTION CENTER



6440 OAK GROVE | BUILDING C SUITE 300

- 122,500 SF Total
- 2,250 SF of Office
- 52,218 SF of Cooler Space
- Fourteen (14) Dock High Doors with Levelers
- One (1) 12'x14' Drive in Ramp
- Twenty-Four (24) Trailer Parks

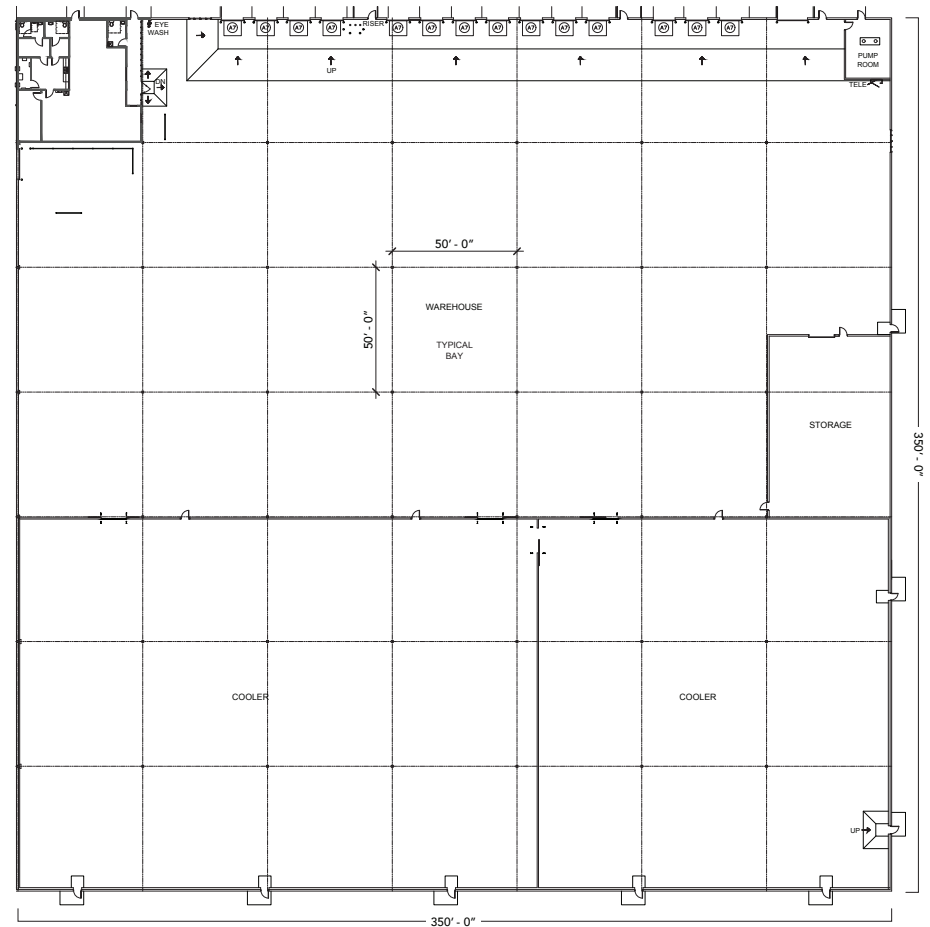
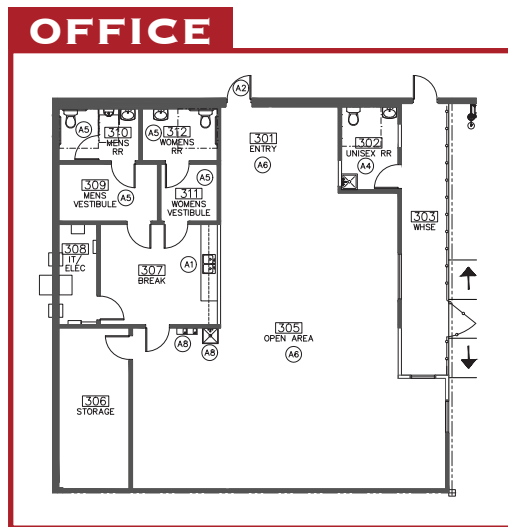

OWNED BY:



LEASED BY:



CONTACT

Matt Carthey | 817.710.1111 | mcarthey@holtlunsford.com
Thomas Grafton | 817.632.6152 | tgrafton@holtlunsford.com
Canon Shoults | 972.280.8328 | cshoults@holtlunsford.com

CARTER PARK

DISTRIBUTION CENTER



6445 WILL ROGERS | BUILDING A SITE PLAN



PROPERTY HIGHLIGHTS

- 385,000 SF Distribution Facility
- 262,500 SF Available – Suite 100 & 200
- Divisible to 122,500 SF
- 30' Clear Height
- 50'x50' Column Spacing
- 0.09/1,000 SF Parking Ratio (Ability to expand to 0.23/1,000 SF)
- Front Load Configuration
- ESFR Sprinkler System
- Rail Service by Union Pacific via Fort Worth & Western
- Located 1 Mile from I-35 and I-20
- Triple Freeport Tax Exemption
- Foreign Trade Zone Designation Obtainable
- Institutionally Owned and Professionally Managed
- Strong Workforce Labor

OWNED BY:



LEASED BY:



CONTACT

Matt Carthey | 817.710.1111 | mcarthey@holtlunsford.com
Thomas Grafton | 817.632.6152 | tgrafton@holtlunsford.com
Canon Shoults | 972.280.8328 | cshoults@holtlunsford.com

CARTER PARK

DISTRIBUTION CENTER



6445 WILL ROGERS | BUILDING A SUITE 100

- 122,500 SF Total
- 2,741 SF of Office Space
- 3 Phase 480V Service with 600 Amps
- Fourteen (14) Dock High Doors Equipped with Seals, Lights, Locks, and 32,000 Lbs. Mechanical Levelers
- One (1) 12'x14' Drive in Ramp

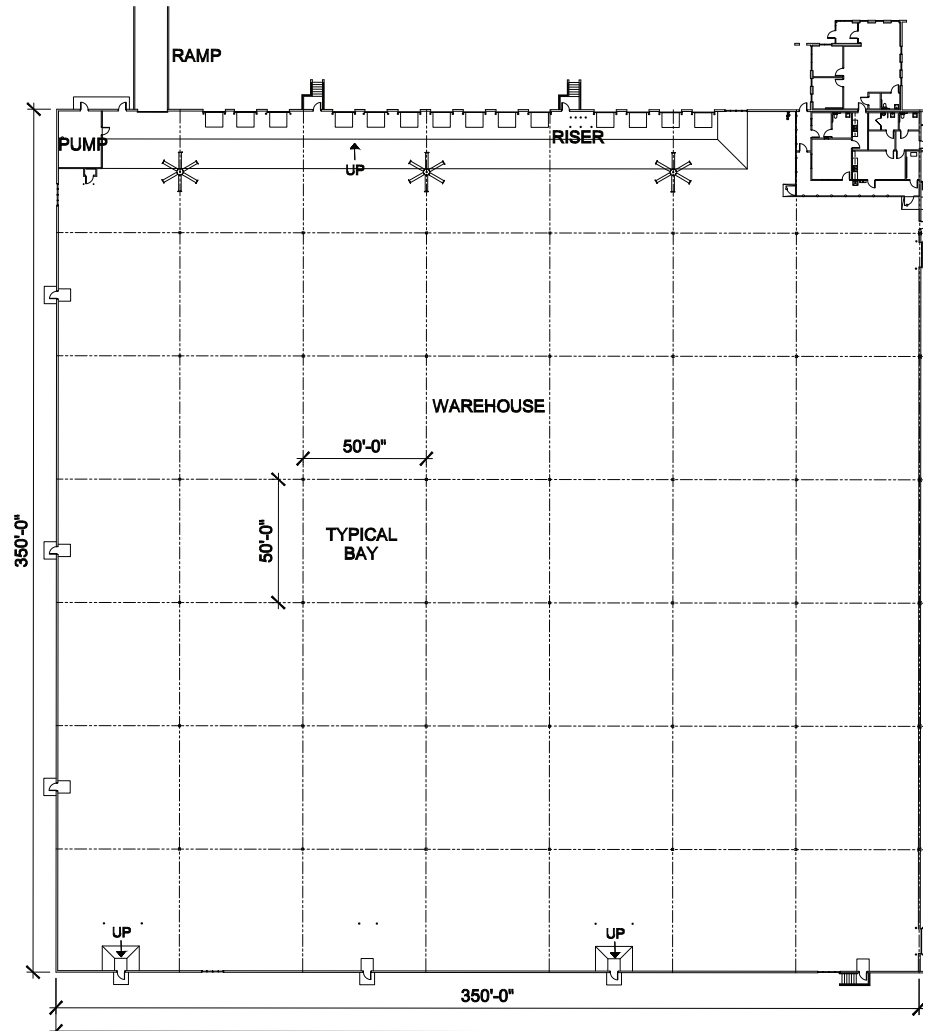
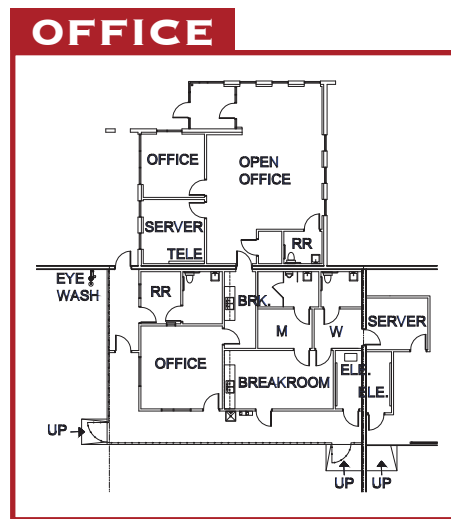

OWNED BY:



LEASED BY:



CONTACT

Matt Carthey | 817.710.1111 | mcarthey@holtlunsford.com
Thomas Grafton | 817.632.6152 | tgrafton@holtlunsford.com
Canon Shoults | 972.280.8328 | cshoults@holtlunsford.com

CARTER PARK

DISTRIBUTION CENTER



6445 WILL ROGERS | BUILDING A SUITE 200

- 140,000 SF Total
- 3 Phase 480V Service with 600 Amps
- Eighteen (18) Dock High Doors Equipped with Seals, Lights, Locks, and 32,000 Lbs. Mechanical Levelers
- Three (3) Rail Doors
- Rail Service by Union Pacific via Fort Worth & Western

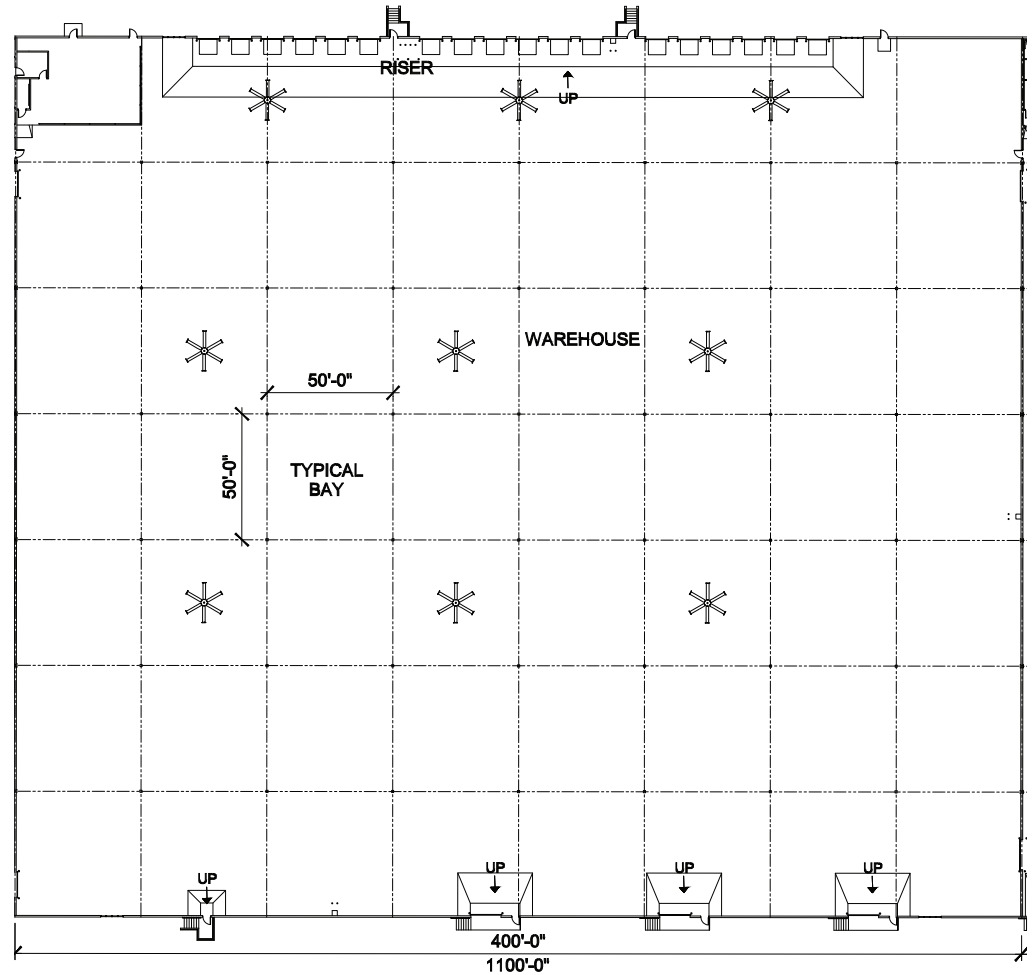

OWNED BY:



LEASED BY:



CONTACT

Matt Carthey | 817.710.1111 | mcarthey@holtlunsford.com
Thomas Grafton | 817.632.6152 | tgrafton@holtlunsford.com
Canon Shoults | 972.280.8328 | cshoults@holtlunsford.com

CARTER PARK DISTRIBUTION CENTER



OWNED BY:



LEASED BY:



CONTACT

Matt Carthey | 817.710.1111 | mcarthey@holtlunsford.com
 Thomas Grafton | 817.632.6152 | tgrafton@holtlunsford.com
 Canon Shoultz | 972.280.8328 | cshoultz@holtlunsford.com



Information About Brokerage Services

Texas law requires all real estate license holders to give the following information about brokerage services to prospective buyers, tenants, sellers and landlords.

11-2-2015



TYPES OF REAL ESTATE LICENSE HOLDERS:

- **A BROKER** is responsible for all brokerage activities, including acts performed by sales agents sponsored by the broker.
- **A SALES AGENT** must be sponsored by a broker and works with clients on behalf of the broker.

A BROKER'S MINIMUM DUTIES REQUIRED BY LAW (A client is the person or party that the broker represents):

- Put the interests of the client above all others, including the broker's own interests;
- Inform the client of any material information about the property or transaction received by the broker;
- Answer the client's questions and present any offer to or counter-offer from the client; and
- Treat all parties to a real estate transaction honestly and fairly.

A LICENSE HOLDER CAN REPRESENT A PARTY IN A REAL ESTATE TRANSACTION:

AS AGENT FOR OWNER (SELLER/LANDLORD): The broker becomes the property owner's agent through an agreement with the owner, usually in a written listing to sell or property management agreement. An owner's agent must perform the broker's minimum duties above and must inform the owner of any material information about the property or transaction known by the agent, including information disclosed to the agent or subagent by the buyer or buyer's agent.

AS AGENT FOR BUYER/TENANT: The broker becomes the buyer/tenant's agent by agreeing to represent the buyer, usually through a written representation agreement. A buyer's agent must perform the broker's minimum duties above and must inform the buyer of any material information about the property or transaction known by the agent, including information disclosed to the agent by the seller or seller's agent.

AS AGENT FOR BOTH - INTERMEDIARY: To act as an intermediary between the parties the broker must first obtain the written agreement of *each party* to the transaction. The written agreement must state who will pay the broker and, in conspicuous bold or underlined print, set forth the broker's obligations as an intermediary. A broker who acts as an intermediary:

- Must treat all parties to the transaction impartially and fairly;
- May, with the parties' written consent, appoint a different license holder associated with the broker to each party (owner and buyer) to communicate with, provide opinions and advice to, and carry out the instructions of each party to the transaction.
- Must not, unless specifically authorized in writing to do so by the party, disclose:
 - o that the owner will accept a price less than the written asking price;
 - o that the buyer/tenant will pay a price greater than the price submitted in a written offer; and
 - o any confidential information or any other information that a party specifically instructs the broker in writing not to disclose, unless required to do so by law.

AS SUBAGENT: A license holder acts as a subagent when aiding a buyer in a transaction without an agreement to represent the buyer. A subagent can assist the buyer but does not represent the buyer and must place the interests of the owner first.

TO AVOID DISPUTES, ALL AGREEMENTS BETWEEN YOU AND A BROKER SHOULD BE IN WRITING AND CLEARLY ESTABLISH:

- The broker's duties and responsibilities to you, and your obligations under the representation agreement.
- Who will pay the broker for services provided to you, when payment will be made and how the payment will be calculated.

LICENSE HOLDER CONTACT INFORMATION: This notice is being provided for information purposes. It does not create an obligation for you to use the broker's services. Please acknowledge receipt of this notice below and retain a copy for your records.

Holt Lunsford Commercial, Inc.	439776	hlunsford@holtlunsford.com	972-241-8300
Licensed Broker /Broker Firm Name or Primary Assumed Business Name	License No.	Email	Phone
Richard Holt Lunsford	359505	hlunsford@holtlunsford.com	972-241-8300
Designated Broker of Firm	License No.	Email	Phone
_____	_____	_____	_____
Licensed Supervisor of Sales Agent/ Associate	License No.	Email	Phone
_____	_____	_____	_____
Sales Agent/Associate's Name	License No.	Email	Phone

Buyer/Tenant/Seller/Landlord Initials

Date