

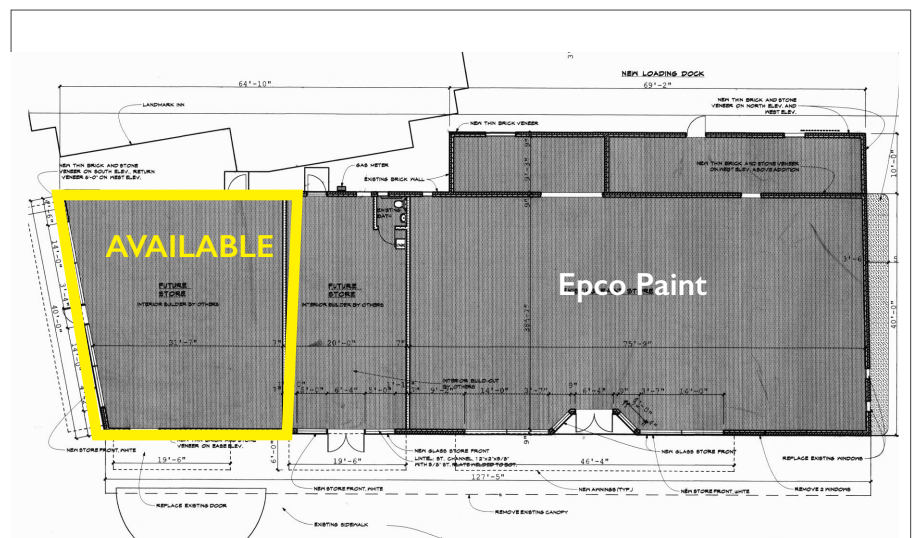

PROPERTY DESCRIPTION

Former yogurt shop available in the heart of downtown Northbrook. High Profile endcap space with excellent foot traffic and an abundant amount of parking available. Located next to the Northbrook Metra stop and across from Village Green Park

- **AVAILABLE SF**
1,340 SF
- **TRAFFIC COUNT**
15,000 VPD
- **SIGNAGE**
Excellent storefront signage available on two sides of the building



AERIAL



DEMOGRAPHICS

	1 MILE	3 MILES	5 MILES
■ POPULATION	10,373	62,073	188,125
■ HOUSEHOLDS	3,847	24,546	71,934
■ AVG. HH INCOME	\$165,907	\$152,024	\$148,671

CONTACT INFORMATION

Joe Goodman

Director of Leasing

847-906-5023

jgoodman@terraco realestate.com

Terraco Real Estate Development & Management

3201 Old Glenview Road | Suite 300

Wilmette, Illinois 60091

www.terraco realestate.com